

- INDEX OF SHEETS
1. TITLE SHEET
  2. QUANTITY SHEET
  3. ROW DETAIL SHEET
  4. ROW PLAN SHEET
  5. PLAN & PROFILE

STATE OF VERMONT  
AGENCY OF TRANSPORTATION



PROPOSED IMPROVEMENT  
BRIDGE PROJECT

TOWN OF BRADFORD  
COUNTY OF ORANGE

ROUTE NO: VT. 25 BRIDGE NO: 5

PROJECT LOCATION: ON VT. RTE. 25, 2.1 MILES NORTH OF THE  
JUNCTION OF VT. RTE. 25 AND VT. RTE. 25 B.

PROJECT DESCRIPTION: REMOVAL OF EXISTING SUPERSTRUCTURE,  
CONSTRUCTION OF A NEW PLATE GIRDER BRIDGE ON EXISTING  
SUBSTRUCTURE, REPAIR OF CONCRETE IN ABUTMENTS AND  
PIER, AND NECESSARY APPROACH WORK.

LENGTH OF STRUCTURE: 207.34 FEET  
LENGTH OF PARTICIPATION ROADWAY: 372.66 FEET  
LENGTH OF NON-PARTICIPATION ROADWAY: 0.00 FEET  
LENGTH OF PROJECT: 600.00 FEET  
LENGTH OF R.Q.W. PROJECT: 600.00 FEET

TRAFFIC DATA

1920 ADT = 2120  
1930 DHV = 295 D = 56% (WB)  
1990 ADT = 2570 T = 10% (DHV)  
1990 DHV = 365

DESIGN SPEED = 40 MPH

HYDRAULIC DATA

DRAINAGE AREA = 121.85 SQ. MI.  
Q<sub>10</sub> = 6500 CFS; HW ELEV. = 517.6;  
VELOCITY = 10.2 FPS  
Q<sub>15</sub> = 9000 CFS; HW ELEV. = 518.7;  
VELOCITY = 11.4 FPS  
Q<sub>50</sub> = 11,000 CFS; HW ELEV. = 519.7;  
VELOCITY = 12.3 FPS  
Q<sub>100</sub> = 14,000 CFS; HW ELEV. = 521.2;  
VELOCITY = 13.5 FPS  
TAILWATER ELEV. @ Q<sub>50</sub> = 519.3

CONVENTIONAL SIGNS

- COUNTY LINE
- TOWN LINE
- LIMITS OF ACCESS
- POINT OF ACCESS
- FENCE LINE
- STONE WALL
- TRAVELED WAY
- RAILROAD
- SURVEY LINE
- CULVERT
- POWER POLE
- TELEPHONE POLE
- TREES
- CONTROL OF ACCESS
- PROPERTY LINE
- ROW TAKING LINE
- SLOPE RIGHTS
- TOP OF CUT
- TOE OF SLOPE

BEGIN R.O.W. PROJECT  
BRF 031-1(5)S STA. 177+00

PI 177+54.45  
177+48.10  
Δ = 28° AT

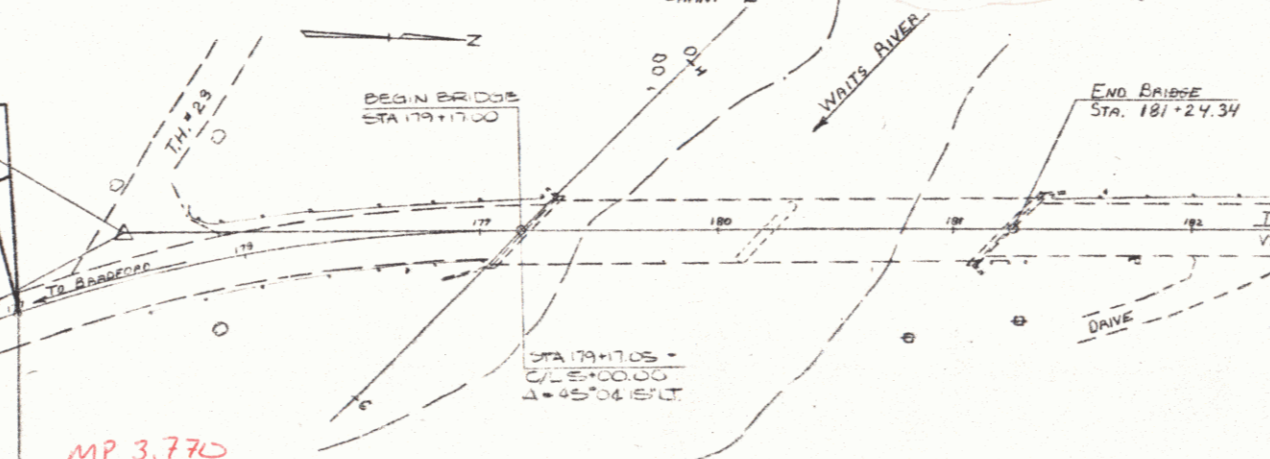

PLAN

SCALE IN FEET



LOCATION MAP

(TRACED FROM COUNTY MAP)

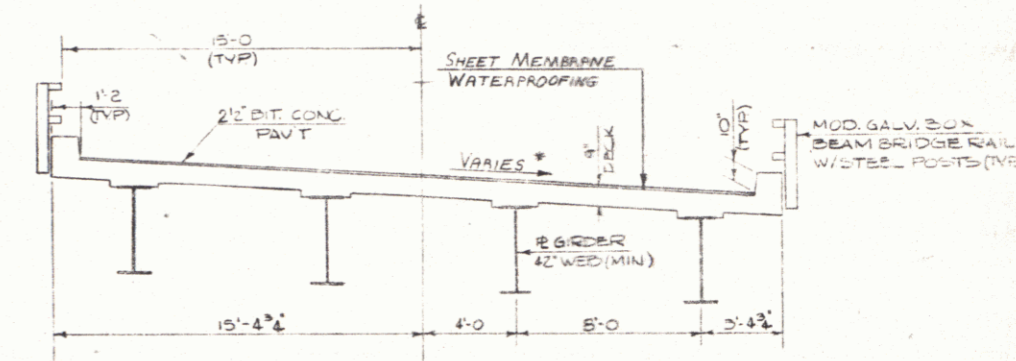
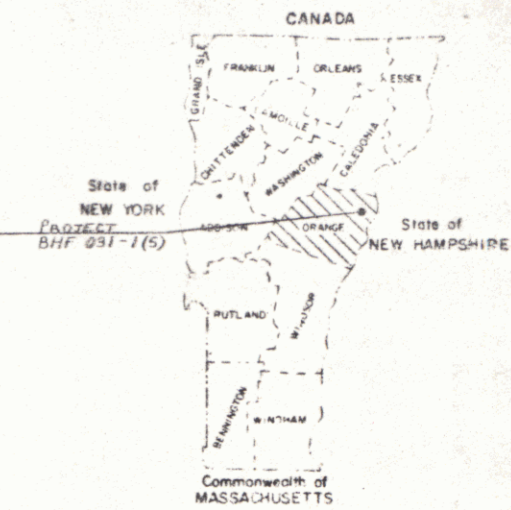

TYPICAL BRIDGE SECTION

SCALE: 1/4" = 1'-0"

SEE SUPERELEVATION DIAGRAM ON SHEET

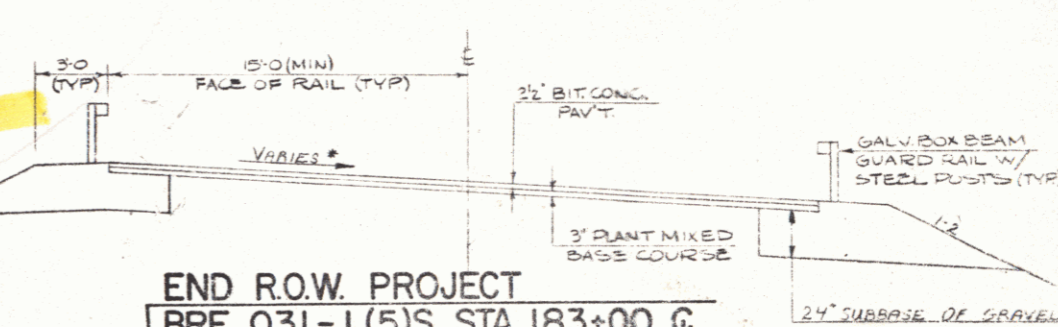

END R.O.W. PROJECT  
BRF 031-1(5)S STA. 183+00

SCALE: 1/4" = 1'-0"

PROJECT PROCESSED UNDER  
SECONDARY ROAD PLAN

APPROVED BY USER OF THE STATE TRANSPORTATION BOARD  
DATE OCT 7 1981  
DIR. OF ENGINEERING AND CONSTRUCTION

APPROVED DATE 10-7-81  
CHIEF, PROPERTY ADMINISTRATION

PROJECT BRADFORD # BRF 031-1(5)S  
SHEET 1 OF 3