

Drawn 11-05-01 dta

DAICHD 6/4/99

STATE OF VERMONT AGENCY OF TRANSPORTATION



PROPOSED IMPROVEMENT **TOWN OF TOPSHAM** COUNTY OF ORANGE **VT. RTE. 25** (BR. NO. 16) (F.A.P.)

BEGINNING AT A POINT ON VT. RTE. NO. 25 IN THE TOWN OF TOPSHAM 2.332 MI. NORTHERLY OF THE CORINTH-TOPSHAM TOWN LINE AND EXTENDING NORTHWESTERLY 0.402 MI.

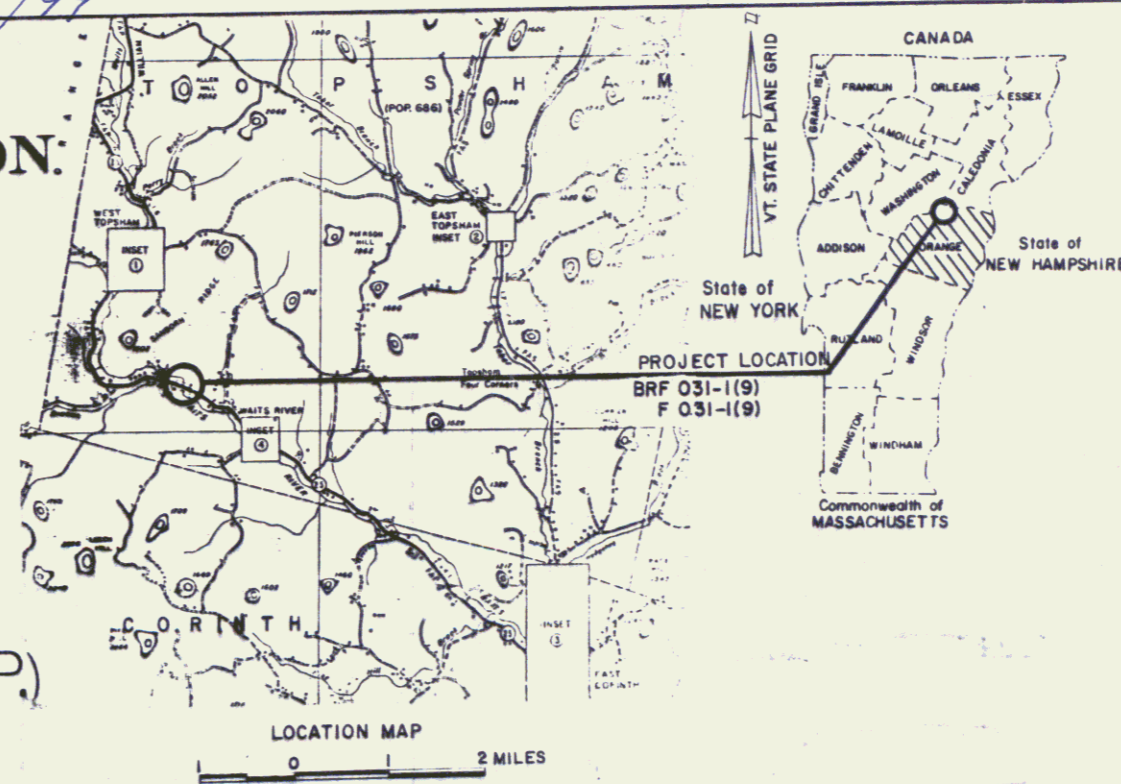

R.O.W. PLANS

BEGIN R.O.W. PROJECT
F BR 031-1(9) STA. 120+50 3' RT.

LENGTH OF ROADWAY 1983.87 FT. = 0.376 MILES
LENGTH OF BRIDGE 88.44 FT. = 0.017 MILES
LENGTH OF PROJECT 2072.31 FT. = 0.392 MILES
LENGTH OF R.O.W. PROJ. 2372.04 FT. = 0.449 MILES

PROJECT DESCRIPTION
PROJECT CONSISTS OF REPLACEMENT OF BRIDGE NO. 16 AND RECONSTRUCTION OF ROADWAY & APPROACHES INCLUDING GRADING, DRAINAGE AND PAVING ON IMPROVED ALIGNMENT AND GRADE.

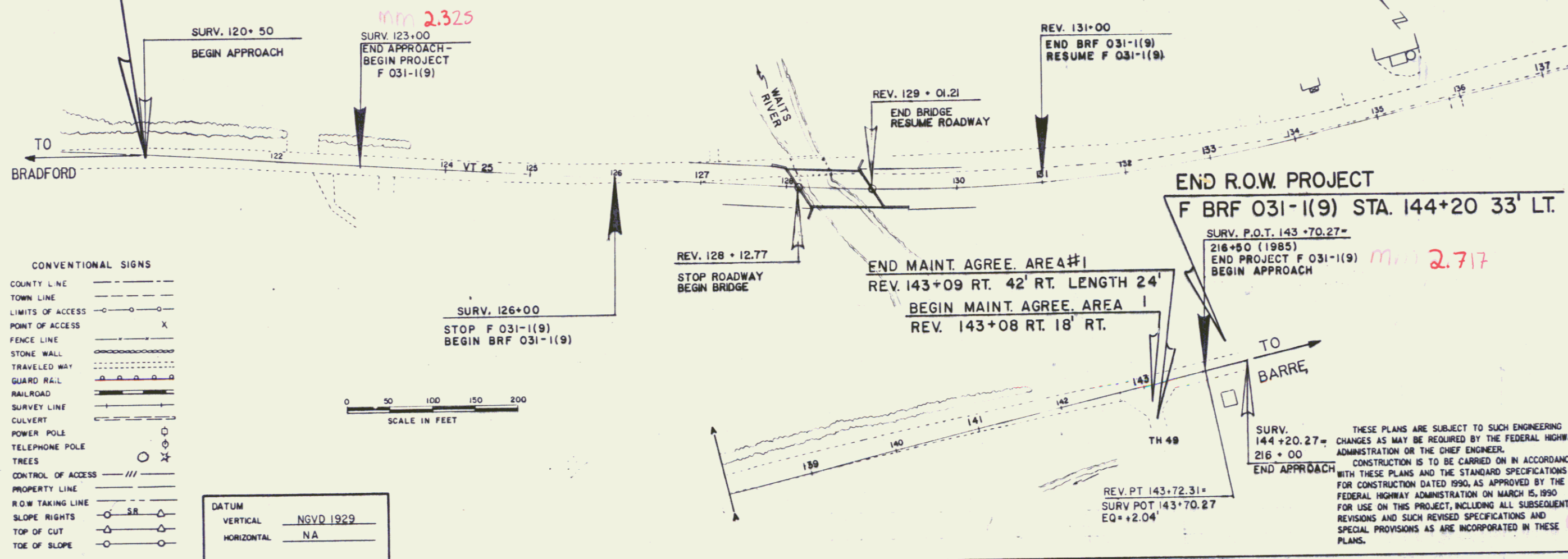

- CONVENTIONAL SIGNS
- COUNTY LINE
 - TOWN LINE
 - LIMITS OF ACCESS
 - POINT OF ACCESS
 - FENCE LINE
 - STONE WALL
 - TRAVELED WAY
 - GUARD RAIL
 - RAILROAD
 - SURVEY LINE
 - CULVERT
 - POWER POLE
 - TELEPHONE POLE
 - TREES
 - CONTROL OF ACCESS
 - PROPERTY LINE
 - R.O.W. TAKING LINE
 - SLOPE RIGHTS
 - TOP OF CUT
 - TOE OF SLOPE

DATUM
VERTICAL NGVD 1929
HORIZONTAL NA



Pin# 78F239

ALL DRIVES AS INDICATED ON PLANS ARE SUBJECT TO PERMITS PURSUANT TO TITLE 19 SECTION III, V.S.A.

JUN 19 1997

THESE PLANS ARE SUBJECT TO SUCH ENGINEERING CHANGES AS MAY BE REQUIRED BY THE FEDERAL HIGHWAY ADMINISTRATION OR THE CHIEF ENGINEER. CONSTRUCTION IS TO BE CARRIED ON IN ACCORDANCE WITH THESE PLANS AND THE STANDARD SPECIFICATIONS FOR CONSTRUCTION DATED 1990, AS APPROVED BY THE FEDERAL HIGHWAY ADMINISTRATION ON MARCH 15, 1990 FOR USE ON THIS PROJECT, INCLUDING ALL SUBSEQUENT REVISIONS AND SUCH REVISED SPECIFICATIONS AND SPECIAL PROVISIONS AS ARE INCORPORATED IN THESE PLANS.

APPROVED: *Scott B. MacArthur* DATE: 10/14/96
Dir., Dept of Planning & Reconstruction

APPROVED: *John N. Bane* DATE: 10/24/96
ES Chief, Property Administration

TOPSHAM
STP F BR 031-1(9)
R.O.W. SHEET 1 OF 12