

INDEX OF SHEETS

STATE OF VERMONT AGENCY OF TRANSPORTATION



PROPOSED IMPROVEMENT TOWN OF RANDOLPH COUNTY OF ORANGE VT. RTE. 14 F.A.S.

BEGINNING AT A POINT ON VT. RTE. 14 IN THE TOWN OF RANDOLPH 4.677 MILES
NORTHERLY OF THE BETHEL-RANDOLPH TOWN LINE AND EXTENDING NORTHERLY 0.066
MILES.

LENGTH OF ROADWAY 2920 FT. + 0.085 MILES
LENGTH OF BRIDGE 38.0 FT. + 0.011 MILES
LENGTH OF PROJECT 8600 FT. + 0.066 MILES
LENGTH OF R.O.W. PROJECT 550.0 FT. 0.104 MILES



PROJECT DESCRIPTION
WORK TO BE PERFORMED UNDER THIS PROJECT
INCLUDES REMOVAL OF EXISTING BRIDGE
AND CONSTRUCTION OF A NEW BRIDGE AND
APPROACHES ON IMPROVED GRADE. APPROACH
WORK CONSISTS OF GRADING, DRAINAGE, SUBBASE,
PAVEMENT, AND GUARD RAIL.

R.O.W. PLANS

BEGIN R.O.W. PROJECT
BRS 0147(11)S STA. 256+00 ☐

END R.O.W. PROJECT
BRS 0147(11)S STA. 261+50 ☐

- CONVENTIONAL SIGNS**
- COUNTY LINE
 - TOWN LINE
 - LIMITS OF ACCESS
 - POINT OF ACCESS
 - FENCE LINE
 - STONE WALL
 - TRAVELED WY
 - GUARD RAIL
 - RAILROAD
 - SURVEY LINE
 - CULVERT
 - POWER POLE
 - TELEPHONE POLE
 - TREES
 - CONTROL OF ACCESS
 - PROPERTY LINE
 - R.O.W. TAKING LINE
 - SLOPE RIGHTS
 - TOP OF CUT
 - TOE OF SLOPE

DATUM
VERTICAL NGVD 1929
HORIZONTAL N/A

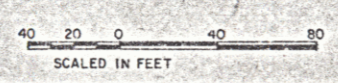

THESE PLANS ARE SUBJECT TO SUCH ENGINEERING
CHANGES AS MAY BE REQUIRED BY THE FEDERAL HIGHWAY
ADMINISTRATION OR THE CHIEF ENGINEER.
CONSTRUCTION IS TO BE CARRIED ON IN ACCORDANCE
WITH THESE PLANS AND THE STANDARD SPECIFICATIONS
FOR CONSTRUCTION DATED 1986, AS APPROVED BY THE
FEDERAL HIGHWAY ADMINISTRATION ON NOVEMBER 21, 1985
FOR USE ON THIS PROJECT, INCLUDING ALL SUBSEQUENT
REVISIONS AND SUCH REVISED SPECIFICATIONS AND
SPECIAL PROVISIONS AS ARE INCORPORATED IN
THESE PLANS.

Pin # 478 F 227
ALL DRIVES AS INDICATED ON
PLANS ARE SUBJECT TO PER-
MITS PURSUANT TO TITLE 19,
SECTION 43, V.S.A.

Approved: *Robert Jones* Date 6-1-87
Dir., Dept. of Planning & Construction

Approved: *John C. ...* Date 6/4/87
Chief, Property Administration

RANDOLPH
BRS 0147(11)S
SHEET 1 OF 8

STATE OF VERMONT
AGENCY OF TRANSPORTATION
RIGHT OF WAY PLANS
DETAIL SHEET

TABLE OF PROJECT PROPERTY ACQUISITION

PARCEL NO.	GRANTOR	SHEET NO.	BEGINNING STATION	ENDING STATION	TAKING	REM.	RIGHTS	TITLE TAKEN	DATE	TOWN OR CITY RECORDED	BK.	PG.	REMARKS	REVISION NO.	SHEET NO.	DESCRIPTION OF REVISION	DATE	MADE BY	APPROVED BY
1	CUNNINGHAM, RAYMOND K. & LOLAMAE	8	256+00 RT. 256+56 RT. 257+25 RT.	257+34 RT. 257+34 RT.	0.08 A±		ALL R. T. & I. DRIVE (T) SLOPE (T) (5 S.F. ±)	WD	1/22/88	RANDOLPH	96	292	VT. RTE. 14 (3350S. F. ±) 12' GRAVEL M.P. 0485	1	6	PARCEL NO. 9 FRYE. ADD SLOPE (T) STA. 260+31 LT. TO 260+50 LT. PER CO. NO. 6985	7-15-87	M.J.R.	<i>EGM</i>
2	STOVER, BRUCE A. & LINDA A.	8	256+14 LT.				DRIVE (T)	AGREE	10/22/87				12 PAVED M.P. 0484 ROW FOR PARCEL*3	2	5,8	PARCEL NO.1 COLLAR. CHANGE TITLE TO CUNNINGHAM, RAYMOND K. & LOLAMAE. PER C.O. NO. 7073	10-5-87	M.J.R.	<i>Sub</i>
3	FROST, WALLACE J. & MURIEL S.	8	256+14 LT.				DRIVE (T)	RELEASE					12 PAVED M.P. 0484 ROW OVER PARCEL 2	3	5	PARCEL NO.4 YOUNG. ADDED TO DETAIL, WATER-LINE AT STA. 257+65LT. ~ 257+90RT. PER CO. 7075	10-08-87	A.S.J.	<i>Sub</i>
4	YOUNG, DEANNA M.	8	256+58 LT. 257+20 LT. 257+50 LT. 257+65 LT. 257+65 LT.	257+65 LT. 257+65 LT. 257+90 RT.	0.06 A±		ALL R. T. & I. DRIVE (T) SLOPE (P) (30 S.F. ±) LANDSCAPE (T)	WD	1/21/88	RANDOLPH	96	289-90	VT. RTE. 14 (2675 SF ±) 16' GRAVEL M.P. 0486 ROSE BUSH WATERLINE	4	6,8	PARCEL NO. 9 FRYE-BOWEN. ADD DRIVE RT(T) AT STA. 261+38 LT. ALSO ADD DRIVE TO PLANS. PER CO. NO. 7009	10-9-87	M.J.R.	<i>EGM</i>
5	COLEMAN, WYATT W.	8	257+34 RT. 257+34 RT. 257+82 RT. 257+34 RT. 257+65 RT.	257+85 RT. 257+85 RT. 257+85 RT.	0.03 A±		ALL R. T. & I. SLOPE (T) (125 S.F. ±) CULVERT (P) CONST. EASE. (TK) (0.01 A±) INSTALL & MAINT. (P)	COND	5/19/88	RANDOLPH	97	110-III	VT. RTE. 14 (1250 SF ±) (500 SF ±) SIGN (6')	5	6,8	PARCEL NO. 8 BLAISDELL. ADD LEACH FIELD. ADD NEW RIGHTS REQUIRED FOR SIDEWALK. DELETE CHANNEL RIGHTS, CONST. EASE., LANDSCAPE (T). ADD NEW STRIP AND MOVE SIGN SOUTH. ADD INSTALL & MAIN. (P) FOR GUARDRAIL PER C.O. NO. 7172	1-28-88	M.J.R.	<i>EGM</i>
6A	EAST RANDOLPH GENERAL STORE INC.	8	258+55 RT. 257+86 RT. 258+51 RT. 258+50 RT. ± 258+50 RT. ± 258+58 RT. 258+57 RT.	259+03 RT. 258+51 RT. 258+55 RT. 258+81 RT. 258+95 RT.	0.02 A±		DRIVE (T) INSTALL & MAINT. (P) REMOVE & RESET (T) CHANNEL (P) (0.03 A±) CONST. EASE. (T) (0.02 A±) ALL R. T. & I.	COND	5/19/88	RANDOLPH	97	110-III	(800 SF ±) 65' PAVED M.P. 0488 GUARDRAIL FENCE (1210 SF ±) (710 SF ±) * MOBIL SIGN PERSONAL PROPERTY*	6	6,8	PARCEL NO. 8 BLAISDELL. ADDED TO PLANS ALL RIGHTS WHICH WERE DELETED UNDER CO. 7172. ADDED BC TO PLANS TO COVER RIGHTS NEEDED PER. CO. 7212	3-03-88	A.S.J.	<i>Sub</i>
6B		8	257+85 RT.	259+17 E	0.07 A±		ALL R. T. & I.	COND	5/19/88		97	110-III	VT. RTE. 14 (3175 SF ±)	7	6,8	PARCEL NO.9 FRYE. DELETED DRIVES AT STA. 261+38 LT. & VT. RTE. 66 10+87 RT. ADD DRIVE AT STA. 261+10 LT. PER CO. 7793	9-28-89	A.S.J.	<i>Sub</i>
														8	6,8	PARCEL NO. 9 FRYE. DELETE DRIVE AT STA. 261+10 LT. & CHANGE TO ORIGINAL STA. 261+38 LT. PER CO. 7946	7-6-90	C.C.P.	<i>LWB</i>

MADE BY: <u>A.S.J.</u> DATE <u>6-4-87</u> CHECKED BY: <u>F.J.M.</u> DATE <u>6-4-87</u> <small>PROP. ADM. 5-87 ZFAD:176.113RD/DET. DON LV11</small>	DR. RT.- DRAINAGE RIGHT DIT. RT.- DITCHING RIGHT CH. RT.- CHANNEL RT. DRIVE RT.- DRIVE RIGHT CUL. RT.- CULVERT RIGHT (D)- DEMOLITION OR REMOVAL (W)- WATER SOURCES	PRESENT R.O.W. TAKING WITHOUT ACCESS TAKING WITHOUT ACCESS ALONG PROPERTY LINE TAKING WITH ACCESS PERMANENT EASEMENT TEMPORARY EASEMENT	LEGEND --- CONST. EASE. --- SR SR CONSTRUCTION EASEMENT P SR SLOPE RIGHTS L PROPERTY LINE --- TOP OF CUT --- TOE OF SLOPE	APPROVED: <u>Lawrence Blin</u> DATE: <u>6-10-87</u> AGENT D, PLANS & TITLES	RANDOLPH BRS 0147(11)S SHEET <u>5</u> OF 8
--	--	--	---	--	--

TABLE OF PROJECT PROPERTY ACQUISITION

STATE OF VERMONT
AGENCY OF TRANSPORTATION
RIGHT OF WAY PLANS
DETAIL SHEET

PARCEL NO.	GRANTOR	SHEET NO.	BEGINNING STATION	ENDING STATION	TAKING	REM.	RIGHTS	TITLE TAKEN	DATE	TOWN OR CITY RECORDED	BK.	PG.	REMARKS	REVISION NO.	SHEET NO.	DESCRIPTION OF REVISION	DATE	MADE BY	APPROVED BY	
7A	EAST RANDOLPH FIRE DISTRICT #2	8	257+85 LT. 257+65 LT. 257+65 LT. 258+22 LT. ± 258+45 LT.	259+64 LT. 259+30 LT. 257+95 LT. 258+80 LT.	0.06 A±		EASE (T) (0.15A±) SLOPE (P) (205 SF±) DIT. & DR (P) CHANNEL (P) (390 SF±)	WD	1/19/88	RANDOLPH	96	278-79	(2750 S.F. ±) DETOUR & TEMP. BRIDGE							
7B		8	257+65 LT.	259+96 LT.	0.13A±		ALL R.T. & I.						VT. RTE. 14							
7C		8	259+61 LT.	259+98 LT.	0.01 A±		ALL R.T. & I.						VT. RTE. 66 (420 S.F. ±)							
8A	BLAISDELL, IRENE		258+87 RT. 258+87 RT. 259+00 RT. 259+22 RT. 259+47 RT. 259+53 RT. 260+09 RT.	259+53 RT. 259+62 RT. 259+28 RT. 259+56 RT. 260+00 RT.	0.03 A±		CONST. EASE(T) (004 A±) CHANNEL (P) (002 A±) LANDSCAPE (T) LANDSCAPE (T) SLOPE (P) (140 S.F±) DRIVE (T)	WD		RANDOLPH			(1100 S.F. ±) (1800 S.F. ±) (980 S.F. ±) SHRUB 2 LILAC TREES 16' GRAVEL MP 0492							
8B		8	259+03 RT. 259+66 RT. 259+70 RT. 260+62 RT.	261+35 RT.	0.13 A±		ALL R.T. & I. INSTALL & MAINT. (P) INSTALL & MAINT. (P) INSTALL & MAINT. (P)						VT. RTE. 14 SIGN (4') SIGN (4') SIGN (4')							
8C		8	259+53 RT. 259+53 RT. 259+90 RT.	260+00 RT. 259+99 RT.			SLOPE (P) (340 S.F.±) INSTALL & MAINT. (P) INSTALL & MAINT. (P)	WDOE	5/4/88			97	17 SIGN (4') GUARD RAIL							
9A	FRYE, CHERRIE L & BOWEN, PATTY	8	260+30 LT. 260+31 LT. 260+31 LT. 260+31 LT.	260+36 LT. 261+10 LT. 261+50 LT. 260+50 LT.	0.01 A±		CULVERT (P) LANDSCAPE (T) SLOPE (T) (105 S.F.±)	WD	1/13/88	RANDOLPH	96	271-72	(12 S.F. ±) 14- 1' CEDAR TREES							
9B		8	259+96 LT. 260+90 LT. 261+38 LT.	261+50 LT.	0.09 A±		ALL R.T. & I. INSTALL & MAINT. (P)						VT. RTE. 14 SIGN (6') 10' GRAVEL MP 0495							
9C		8	259+96 LT.	VT. RTE. 66 11+00 LT.	0.09 A±		ALL R.T. & I.						VT. RTE. 66 (3860 S.F. ±)							

MADE BY: A.S.J. DATE 6-4-87

CHECKED BY: F.J.M. DATE 6-4-87

PROP. ADMIN. 5-87 2742(170,111)R0M01.DWG L1*12

DR. RT.- DRAINAGE RIGHT
DIT. RT.- DITCHING RIGHT
CH. RT.- CHANNEL RT.
DRIVE RT.- DRIVE RIGHT
CUL. RT.- CULVERT RIGHT
⓪- DEMOLITION OR REMOVAL
Ⓜ- WATER SOURCES

PRESENT R.O.W.
TAKING WITHOUT ACCESS
TAKING WITHOUT ACCESS ALONG PROPERTY LINE
TAKING WITH ACCESS
PERMANENT EASEMENT
TEMPORARY EASEMENT

LEGEND
--- CONSL. EASE --- CONSTRUCTION EASEMENT
SR SR SLOPE RIGHTS
P --- PROPERTY LINE
L --- TOP OF CUT
--- TOE OF SLOPE

APPROVED: [Signature] DATE: 6-10-87
AGENT D. PLANS & TITLES

RANDOLPH
BRS 0147(11)S

SHEET (6) OF 8

STATE OF VERMONT
AGENCY OF TRANSPORTATION
RIGHT-OF-WAY PLANS
DETAIL SHEET

TABLE OF PROJECT PROPERTY ACQUISITION

PARCEL NO.	GRANTOR	SHEET NO.	BEGINNING STATION	ENDING STATION	TAKING	REM.	RIGHTS	TITLE TAKEN	DATE	TOWN OR CITY RECORDED	BK.	PG.	REMARKS
10A	WALLEN, RONALD A.	8	259 + 30 LT. 259 + 21 LT. 259 + 15 LT. 258 + 50 LT. 259 + 34 LT. VT. 66 10 + 39 LT.	259 + 65 LT. 259 + 70 LT. 259 + 21 LT. 259 + 71 LT. 259 + 43 LT. VT. 66 10 + 70 LT.	0.01 A±		CULVERT (P) DRAINAGE (P) EASE. (T) (0.05A±) CHANNEL (P) (1.60S.F.±) DRIVE (T)	WD	12/23/87	RANDOLPH	96	213	(215 S.F.±) DETOUR & TEMP. BRIDGE (2355 S.F.±) 31' GRAVEL MP 0761
10B		8	259 + 98 LT.	VT. 66 11 + 00 LT.	0.05 A±		ALL R.T. & I.						VT. RTE. 66 (2095 S.F.±)
11	CENTRAL VT. PUBLIC SERVICE CORP.												UTILITY
12	NEW ENGLAND TELEPHONE CO.												UTILITY

TABLE OF REVISIONS

REVISION NO.	SHEET NO.	DESCRIPTION OF REVISION	DATE	MADE BY	APPROVED BY

MADE BY: M.J.R. DATE 5-2-87
CHECKED BY: F.J.M. DATE 5-2-87

DR. RT. - DRAINAGE RIGHT
DIT. RT. - DITCHING RIGHT
CH. RT. - CHANNEL RIGHT
DRIVE RT. - DRIVE RIGHT
CUL. RT. - CULVERT RIGHT
⊙ - DEMOLITION OR REMOVAL
W - WATER SOURCES

PRESENT R.O.W.
/// - /// TAKING WITHOUT ACCESS
/// P - /// TAKING WITHOUT ACCESS ALONG PROPERTY LINES
- - - - - TAKING WITH ACCESS
(P) PERMANENT EASEMENT
(T) TEMPORARY EASEMENT

LEGEND
- - - - - CONST. EASE - - - - - CONST. EASEMENT
SR - SR - SLOPE RIGHTS
P - P - PROPERTY LINE
- Δ - Δ - Δ - TOP OF CUT
- O - O - O - TOE OF SLOPE

APPROVED Lester Blinn DATE 6-10-87
CHIEF OF PLANS & TITLES

PROJECT RANDOLPH
NO. BRS 0147(II)S
SHEET 7 OF 8

ROW

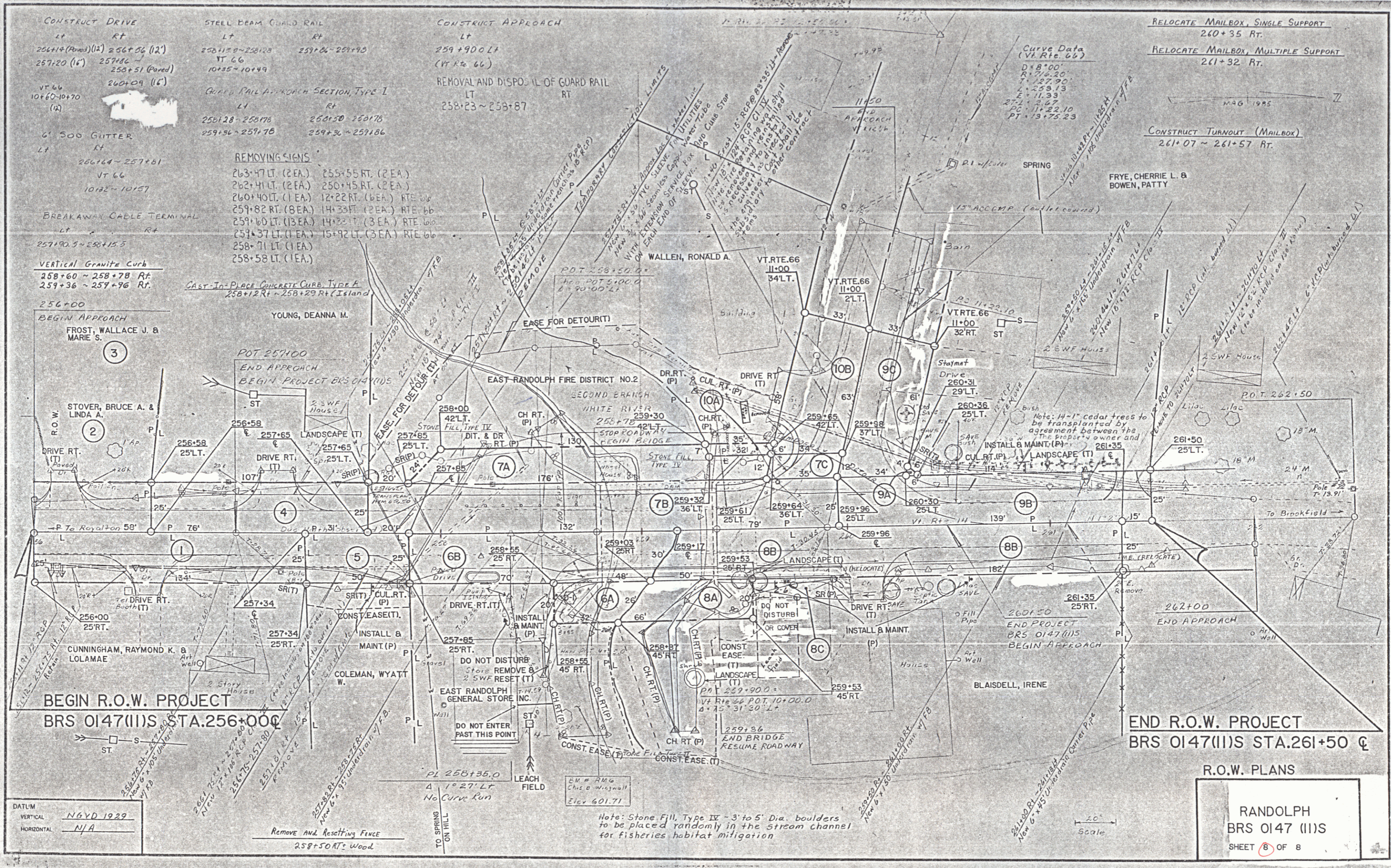

CONSTRUCT DRIVE
 LT RT
 256+14 (Paved) (12) 256+26 (12)
 257+20 (16) 257+66
 258+51 (Paved)
 260+09 (16)
 VT 66
 10+60-10+70
 (12)
 6" SOD GUTTER
 LT RT
 260+14 ~ 257+61
 VT 66
 10+82 ~ 10+57

STEEL BEAM GUARD RAIL
 LT RT
 258+11 ~ 258+18
 VT 66
 10+35 ~ 10+49
 GUARD RAIL APPROX. SECTION, TYPE I
 LT RT
 258+28 ~ 258+78
 259+30 ~ 259+78
 259+86 ~ 259+78
 259+86 ~ 259+86

CONSTRUCT APPROACH
 LT
 259+90 LT
 (VT Rte 66)
 REMOVAL AND DISPO. OF GUARD RAIL
 LT RT
 258+23 ~ 258+87

RELOCATE MAILBOX, SINGLE SUPPORT
 260+35 RT.
RELOCATE MAILBOX, MULTIPLE SUPPORT
 261+32 RT.
 M&G 1985
CONSTRUCT TURNOUT (MAILBOX)
 261+07 ~ 261+57 RT.

REMOVING SIGNS
 263+47 LT. (2EA.) 255+55 RT. (2EA.)
 262+41 LT. (2EA.) 250+45 RT. (2EA.)
 260+40 LT. (1EA.) 12+22 RT. (6EA.) RTE 66
 259+82 RT. (8EA.) 14+33 RT. (2EA.) RTE 66
 259+60 LT. (13EA.) 14+33 LT. (3EA.) RTE 66
 259+37 LT. (1EA.) 15+92 LT. (3EA.) RTE 66
 258+71 LT. (1EA.)
 258+58 LT. (1EA.)

BREAKAWAY CABLE TERMINAL
 LT RT
 257+90.3 ~ 258+15.5
VERTICAL Granite Curb
 258+60 ~ 258+78 RT
 259+36 ~ 259+96 RT.
 256+00
BEGIN APPROACH
 FROST, WALLACE J. & MARIE S.
 (3)

CAST-IN-PLACE CONCRETE CURB, TYPE A
 258+12 RT ~ 258+29 RT (Island)
 YOUNG, DEANNA M.

BEGIN PROJECT BRS 0147(II)S
 STA. 256+00

BEGIN R.O.W. PROJECT
 BRS 0147(II)S STA. 256+00

END R.O.W. PROJECT
 BRS 0147(II)S STA. 261+50

DATUM
 VERTICAL NGVD 1929
 HORIZONTAL N/A

R.O.W. PLANS
 RANDOLPH
 BRS 0147 (II)S
 SHEET 8 OF 8

POOR ORIGINAL COPY

5