

STATE OF VERMONT
AGENCY OF TRANSPORTATION

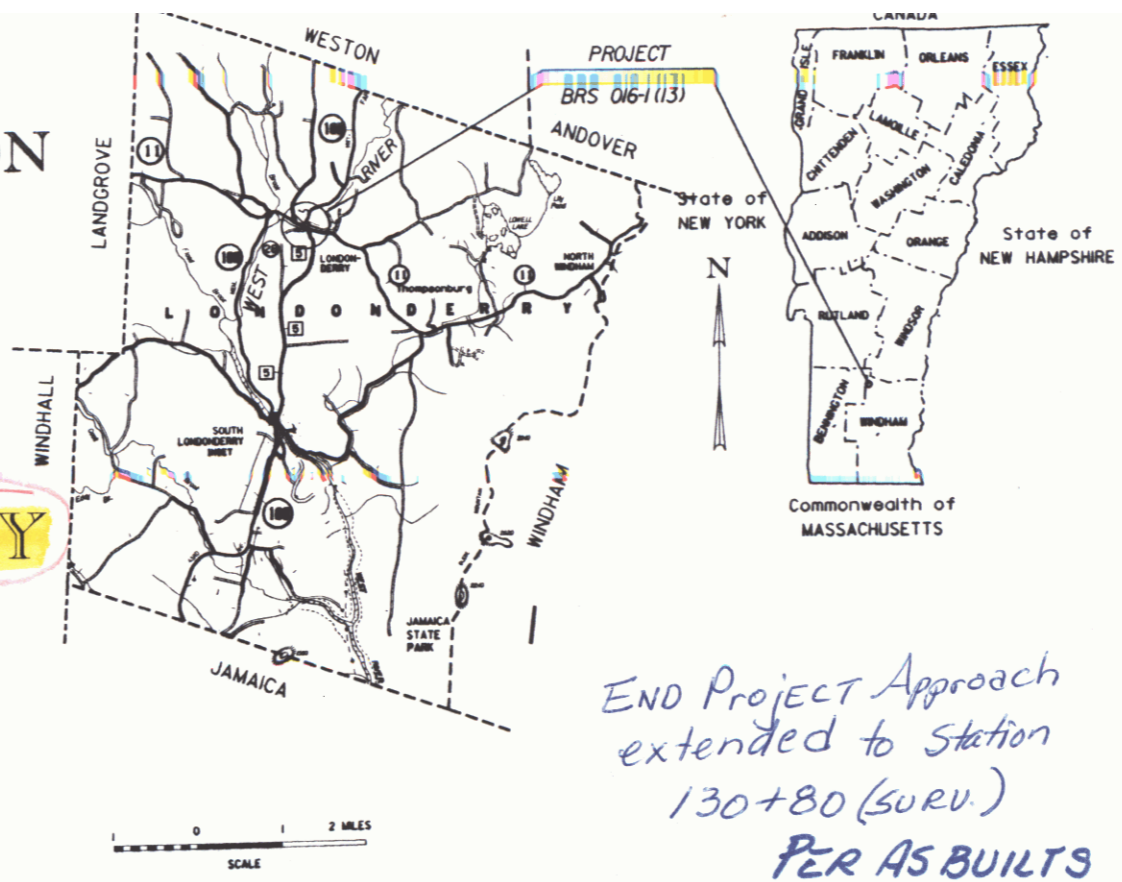

PROPOSED IMPROVEMENT
TOWN OF LONDONDERRY
COUNTY OF WINDHAM
VT RTE 11 (FAP)

BEGINNING AT A POINT ON VT RTE 11 APPROXIMATELY
100 FEET WESTERLY OF THE JUNCTION VT RTE 11
AND VT RTE 100 AND EXTENDING EASTERLY 0.095 MILES
LENGTH OF ROADWAY= 407.44 FEET= 0.077 MILES
LENGTH OF BRIDGE= 92.56 FEET= 0.018 MILES
LENGTH OF PROJECT= 500.00 FEET= 0.095 MILES
LENGTH OF R.O.W. PROJECT= 994.63 FEET= 0.188 MILES
WORK TO BE PERFORMED UNDER THIS PROJECT
CONSISTS OF REPLACING BRIDGE No 28 OVER
WEST RIVER AND NECESSARY ROADWAY
APPROACH WORK



END Project Approach
extended to station
130+80 (SURV.)
PER AS BUILTS
6/97

R.O.W. PLANS

BEGIN R. O. W. PLANS

BRF 016-1(13) STA. 121+22 CL

BEGIN MAINT. AGREE. AREA NO. 2
REV. 127+36 20' RT.

END MAINT. AGREE. AREA NO. 2
REV. 127+42 37' RT. LENGTH 18'

Pin# 78F213

END R. O. W. PROJECT

BRF 016-1(13) STA. 131+22 CL

MP 0229 ~ MP 0248

RIGHT-OF-WAY DIVISION
TOWN FILE

PERPETUAL
Town of Londonderry
(To Be Returned To R.O.W. Division)
Vt. Rte 11

ALL DRIVES AS INDICATED ON PLANS
ARE SUBJECT TO PERMITS PURSUANT
TO TITLE 19 SECTION III, V.S.A.

THESE PLANS ARE SUBJECT TO SUCH ENGINEERING
CHANGES AS MAY BE REQUIRED BY THE FEDERAL HIGHWAY
ADMINISTRATION OR THE AGENCY SECRETARY.
CONSTRUCTION IS TO BE CARRIED ON IN ACCORDANCE
WITH THESE PLANS AND THE STANDARD SPECIFICATIONS
FOR CONSTRUCTION DATED 1986, AS APPROVED BY THE
FEDERAL HIGHWAY ADMINISTRATION ON NOVEMBER 20, 1985
FOR USE ON THIS PROJECT, INCLUDING ALL SUBSEQUENT
REVISIONS AND SUCH REVISED SPECIFICATIONS AND
SPECIAL PROVISIONS AS ARE INCORPORATED IN THESE
PLANS.

APPROVED: *[Signature]* DATE: 7/22/97
Director of Engineering
APPROVED: *[Signature]* DATE: 7/22/97
Chief of Right-of-Way
LONDONDERRY
BRF 016-1(13)
R.O.W. SHEET (1) OF 13 SHEETS

CONVENTIONAL SIGNS

COUNTY LINE	---
TOWN LINE	- - - -
LIMITS OF ACCESS	○ ○ ○ ○
POINT OF ACCESS	X
FENCE LINE	— x — x —
STONE WALL	○ ○ ○ ○ ○ ○
TRAVELED WAY	— — — — —
GUARD RAIL	— — — — —
RAILROAD	— + — + — +
SURVEY LINE	— — — — —
CULVERT	— — — — —
BURNER POLE	⊕
PHONE POLE	⊕
TREES	●
CONTROL OF ACCESS	///
PROPERTY LINE	— — — — —
PAVING LINE	— — — — —
RIGHTS	△
TOP OF CUT	△
TOE OF SLOPE	○

BEGIN MAINT. AGREE. AREA NO. 1
REV. 126+62 20' RT.

END MAINT. AGREE. AREA NO. 1
REV. 126+61 44' RT. LENGTH 24'

DATUM
VERTICAL NGVD 1929
HORIZONTAL N/A

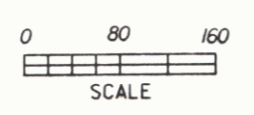

APR 21 1997

TYPICAL SECTIONS

MATERIAL ITEM	THICKNESS TOLERANCE
PAVEMENT	* 1/4"
BASE COURSE	* 1/2"
SUBBASE	* 1"
GRANULAR BORROW	* 1"
SAND BORROW	* 1"

4" BITUMINOUS CONCRETE PAVEMENT (1 3/4" TYPE III, OVER 2 1/4" TYPE II)
 6" BASE COURSE OF BITUMINOUS CONCRETE PAVEMENT (TYPE I)
 26" SUBBASE OF CRUSHED GRAVEL (FINE GRADED)
 18" SAND BORROW (IN CUTS)
 SHOULDERS : 1 1/4" BITUMINOUS CONCRETE PAVEMENT

SEEDING FORMULA URBAN AREAS

% WT.	LBS./A.	NAME	PUR %	GERM %
37.5	30	CREeping RED FESCUE	98	85
31.25	25	KENTUCKY BLUE GRASS	85	75
31.25	25	PERENNIAL RYE GRASS	95	90
100.00	80			

THE SEED MIXTURE SHALL NOT HAVE A WEED CONTENT EXCEEDING 0.40% BY WEIGHT AND SHALL BE FREE OF ALL NOXIOUS WEED SEED.
 SEED- TO BE APPLIED PER SEEDING FORMULA OR AS DIRECTED BY THE ENGINEER.
 FERTILIZER- FORMULA 10-20-10 TO BE USED WITH SEED, APPLIED AT THE RATE OF 500 LBS./ACRE.
 AGRICULTURAL LIMESTONE- TO BE APPLIED AT THE RATE OF 2 TONS/ACRE OR AS DIRECTED BY THE ENGINEER.
 HAY MULCH- TO BE PLACED ON EARTH SLOPES AT THE RATE OF 2 TONS/ACRE, OR AS DIRECTED BY THE ENGINEER.
 TOPSOIL- TO BE USED WITH SEED AS INDICATED ON THE PLANS, OR AS DIRECTED BY THE ENGINEER.
 SLOPE ROUNDING- ALL CUT SLOPES TO BE ROUNDED IN ACCORDANCE WITH STANDARD SHEET B-5.
 PAY LIMITS OF SAND BORROW WHEN USED IN CONJUNCTION WITH UNDERDRAIN- SEE STANDARD SHEET D-2.
 FOR SIDELINE TYPICAL SECTIONS
 SEE SIDELINE CROSS-SECTIONS

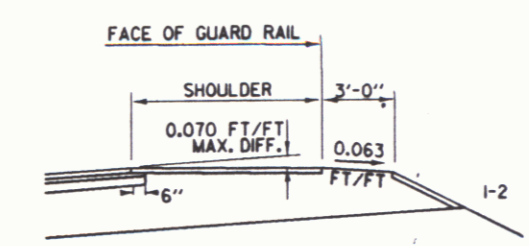
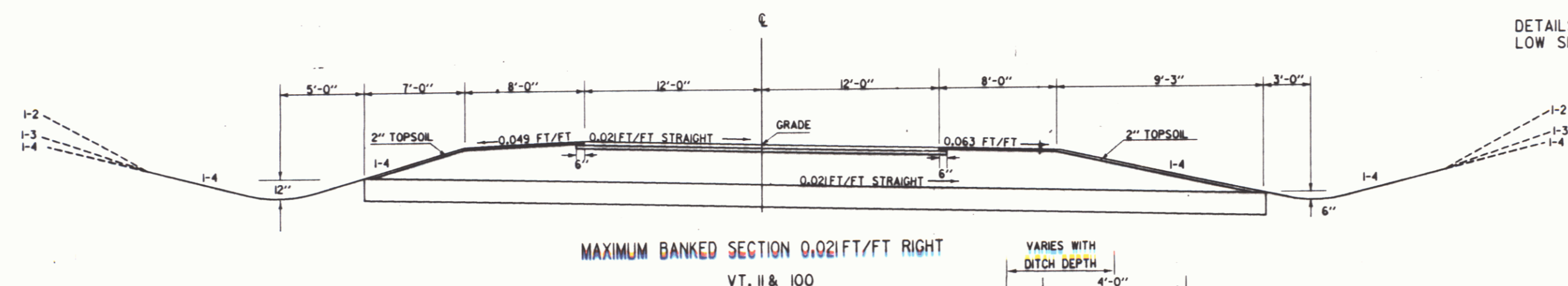
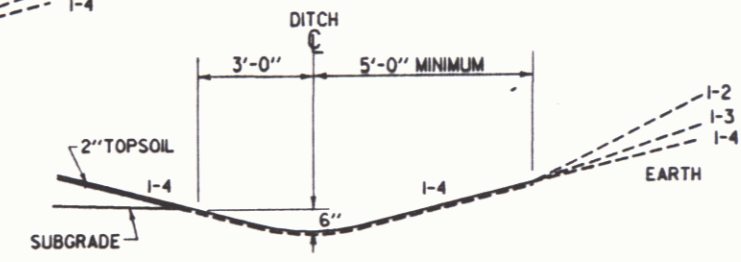
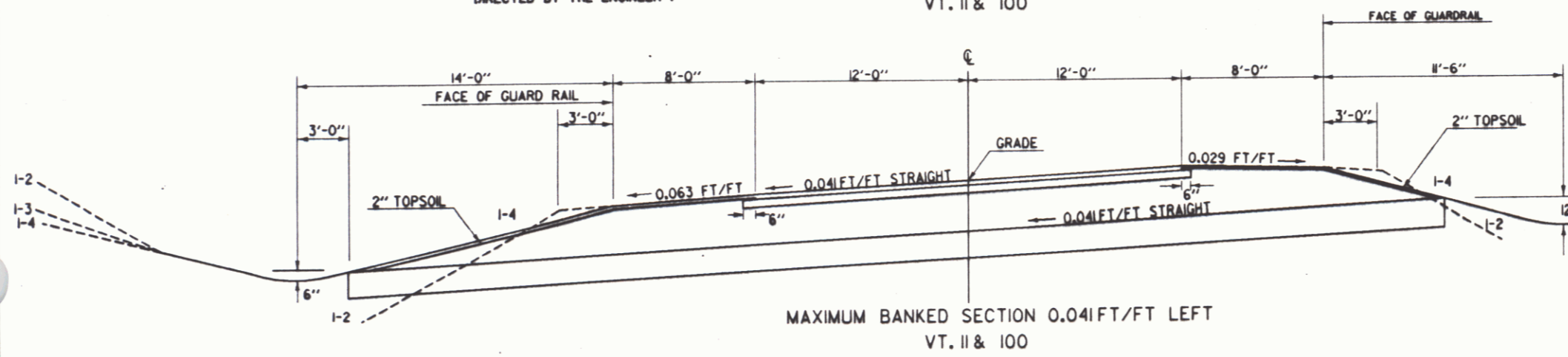
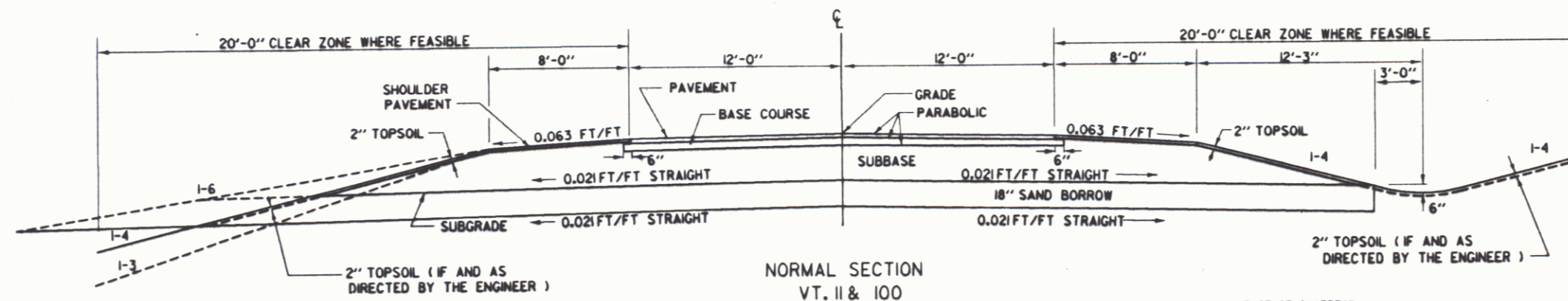

FOR SLOPES IN SOLID ROCK EXCAVATION
AND DRILLING AND BLASTING OF SOLID
ROCK SUBGRADE, SEE STANDARD SHEET A-62.

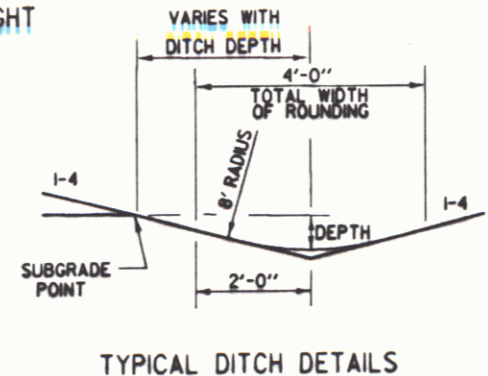
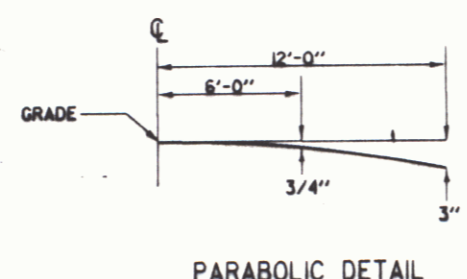

SURVEYED BY	FANTOM	DATE	3/95
DRAWN BY	HELMER	DATE	12/98
SQUAD LEADER	HEGOS		
DESIGN FILE NO.	2FAD50471	DATE	19-JUN-1998
	T8723	PLOTTED	
LONDONDERRY			
BRF 016-1(13)			
ROW SHEET (2) OF 13			

DATUM
 VERTICAL _____
 HORIZONTAL _____

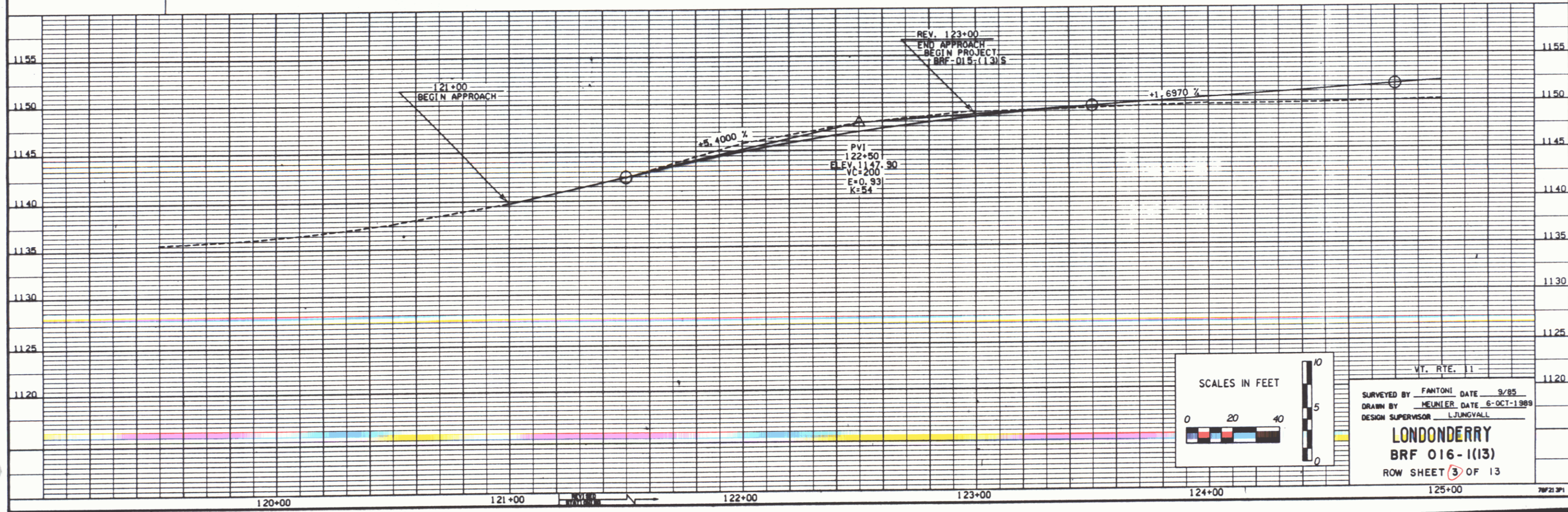

DATUM
 VERTICAL _____
 HORIZONTAL _____

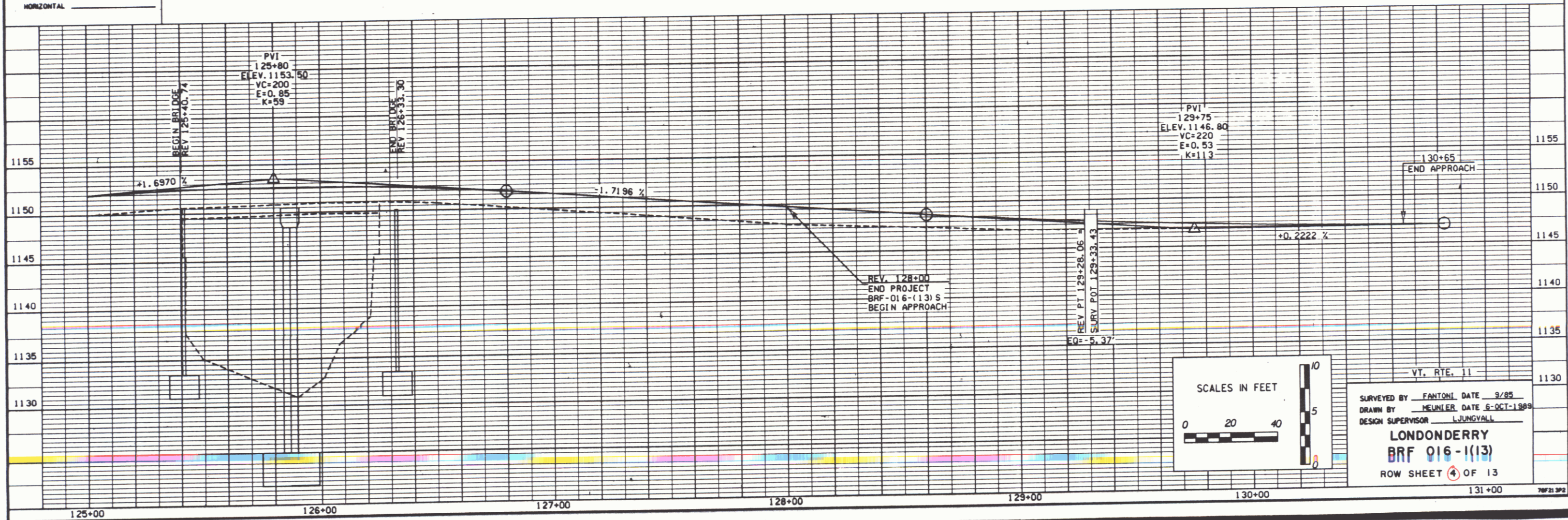

APR 21 1997

DATUM
 VERTICAL _____
 HORIZONTAL _____

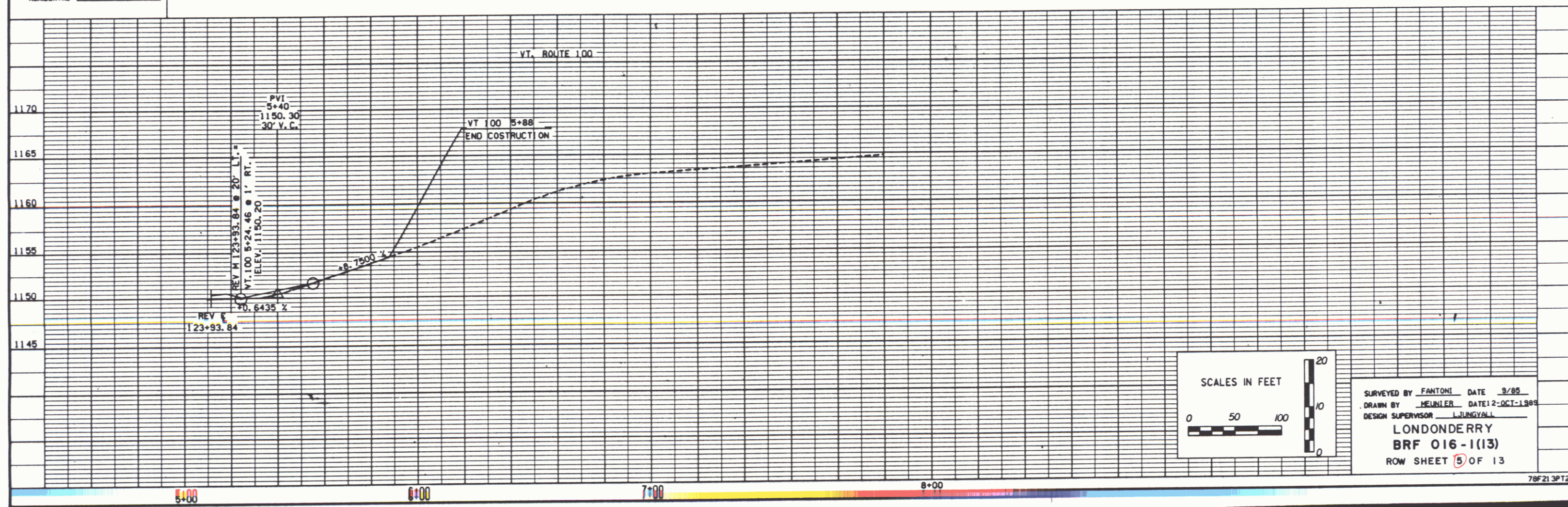

APR 21 1997

DATUM
 VERTICAL _____
 HORIZONTAL _____

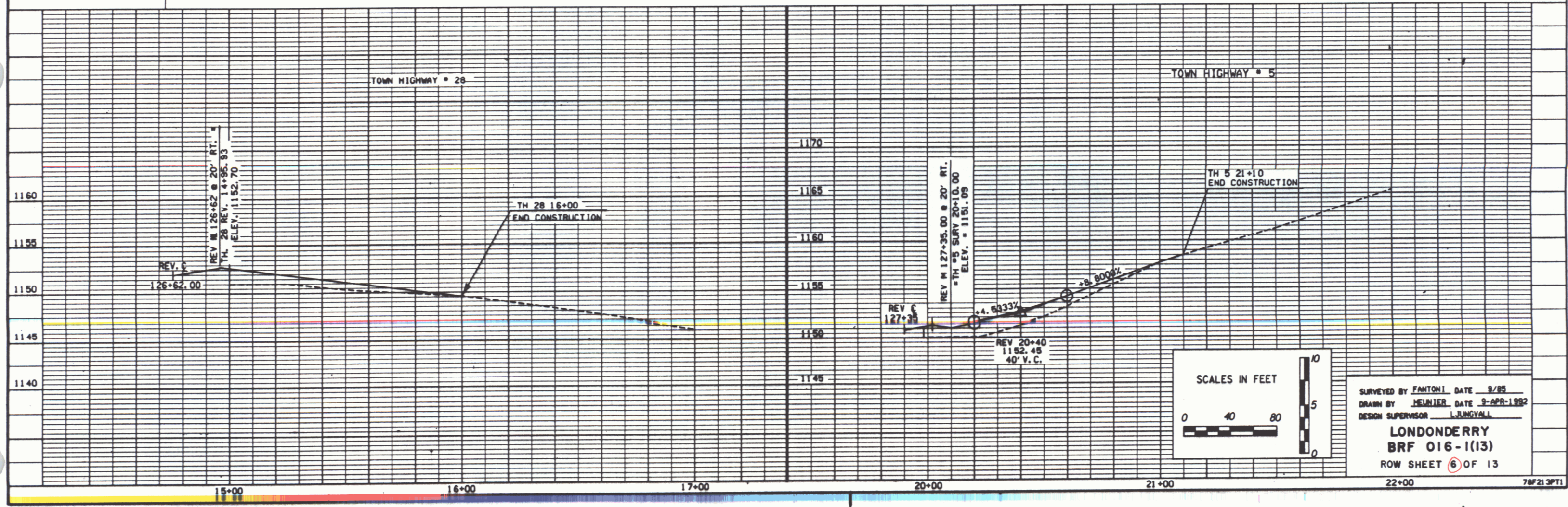

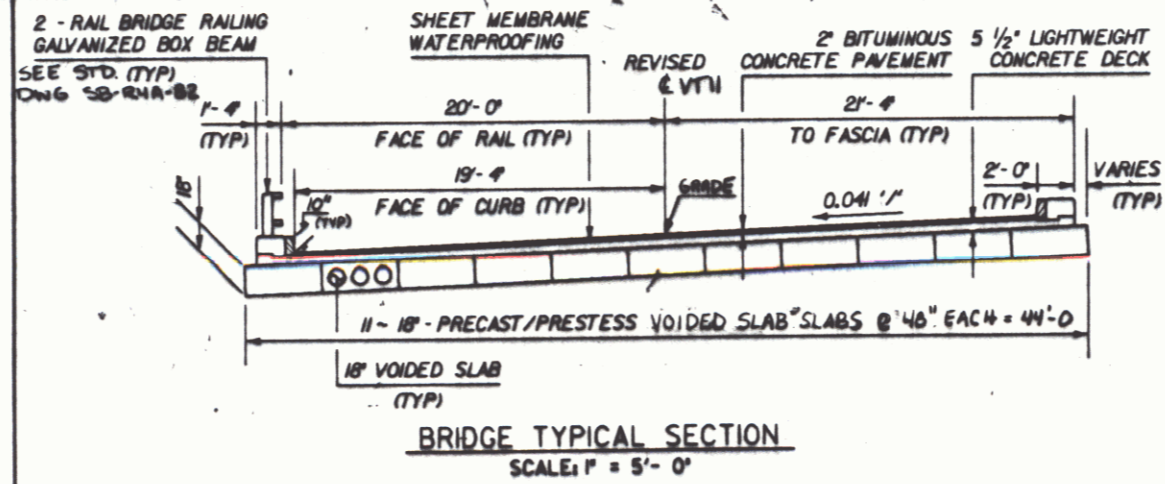

BRIDGE TYPICAL SECTION
SCALE 1/4" = 5'-0"

EXISTING STRUCTURE

1. STRUCTURE TYPE STEEL TRUSS OVERALL LENGTH 85' INVENTORY RATING 117
 2. SPAN LENGTH S1 CENTER TO CENTER OF BEARINGS _____
 3. CLEAR SPAN LENGTH S2 NORMAL TO STREAM 85'
 4. WATERWAY AREA OF FULL OPENING (NORMAL TO STREAM) 1288 S.F. VERTICAL CLEARANCE ABOVE STREAMBED 12.00 FT
 5. WATER SURFACE ELEVATION @ 0.25 C.F.S. 1145.58 WATER SURFACE ELEVATION @ 0.50 1146.58
 6. WATER SURFACE ELEVATION AT FLOOD OF RECORD _____ YEAR 1972 ESTIMATED DISCHARGE _____
 7. DOES ALL WATER PASS THROUGH EXISTING STRUCTURE? NO IF NOT, AT WHAT FREQUENCY AND ELEVATION DOES RELIEF OCCUR? 0.48 +/- 1985.88
 8. TYPE OF SUBSTRUCTURE FOUNDATION MATERIAL _____
 9. DISPOSITION OF STRUCTURE REPAIR

NEW STRUCTURE

STRUCTURE GEOMETRY:
 1. STRUCTURE TYPE 2 SPAN PRECAST/PRESTRESS VOIDED CONCRETE SLAB
 2. SPAN LENGTH S1 CENTER TO CENTER OF BEARINGS 76.85 ALONG REVISED CENTER LINE
 3. VERTICAL CLEARANCE ABOVE STREAMBED OR ROAD UNDER 18.50
 4. CLEAR SPAN LENGTH S2 NORMAL TO STREAM 82'
 5. WATERWAY AREA OF FULL OPENING (NORMAL TO STREAM) 1288 S.F.
 6. ARE PROVISIONS TO BE MADE FOR PUBLIC UTILITIES? _____

NORMALIC DATA:

1. 0.25 C.F.S.	WATER ELEVATION	1145.58	VELOCITY	1.28 F.P.S.
0.50 C.F.S.	WATER ELEVATION	1146.58	VELOCITY	3.38 F.P.S.
0.75 C.F.S.	WATER ELEVATION	1147.58	VELOCITY	5.28 F.P.S.
1.00 C.F.S.	WATER ELEVATION	1148.58	VELOCITY	6.98 F.P.S.
1.25 C.F.S.	WATER ELEVATION	1149.58	VELOCITY	8.48 F.P.S.

2. DRAINAGE AREA 38.17 SQ. MI. CHARACTER OF TERRAIN HILLY TO MOUNTAINOUS
 3. ARE THERE OBJECTIONS TO A PIER IN THE STREAM? NO IS ORDINARY RISE RAPID? YES
 4. DOES STREAM REACH ITS MINIMUM HIGH WATER ELEVATION RAPIDLY? YES ICE MODERATE
 5. NATURE OF NATURAL STREAMBED _____ COMMENT ON DRIFT SLIGHT
 6. ESTIMATED SCOUR DEPTH _____
 7. WILL ALL WATER PASS THROUGH NEW STRUCTURE? NO IF NOT, WHAT FREQUENCY AND ELEVATION WILL RELIEF OCCUR? 0.48 +/- 1985.88
 8. VERTICAL CLEARANCE ABOVE 0 _____
 9. ALLOWABLE WATER SURFACE ELEVATION 1188.88 LIMITED BY BOTTOM OF SLAB
 10. IS DESIGN STAGE AFFECTED BY UPSTREAM OR DOWNSTREAM CONDITIONS? YES IF YES, REFER TO SLICE NOTE BELOW
 11. AVERAGE DAILY LOW FLOW 0.25 C.F.S. DEPTH 4.20 AVERAGE DAILY HIGH FLOW 125 C.F.S. DEPTH 3.80
 12. STREAMBANK OR CHANNEL PROTECTION REQUIRED STONE FILL, TYPE II
 13. DISTANCE TO EXISTING UPSTREAM STRUCTURE 5000' SPAN 44' WATERWAY AREA OF FULL OPENING _____
 14. DISTANCE TO EXISTING DOWNSTREAM STRUCTURE 5000' SPAN 220' WATERWAY AREA OF FULL OPENING _____

ALLOWABLE STRESSES:
 1. DESIGN LIVE LOAD MS-25 ON LEDGE 18 K. S.F.
 2. ALLOWABLE LOAD FOR SPREAD FOOTINGS ON SOIL 4 K. S.F. TYPE _____ ESTIMATED LENGTH _____
 3. ALLOWABLE LOAD FOR FILLING _____
 4. ALLOWABLE STRESS FOR STRUCTURAL STEEL ASHTO M 222 33/8 TENSION 33/8
 5. ALLOWABLE STRESS FOR REINFORCING STEEL GRADE 60 TENSION 60000 P.S.I. COMPRESSION 24000 P.S.I.
 6. ALLOWABLE STRESS FOR CONCRETE CLASS A 15 3000 COMPRESSIVE 1400
 CLASS B 14 2800 COMPRESSIVE 1300
 CLASS C 13 2400 COMPRESSIVE 1200

TRAFFIC MAINTENANCE:
 1. IS TRAFFIC TO BE MAINTAINED? YES IF YES, ON EXISTING STRUCTURE NO OR ON TEMPORARY BRIDGE YES
 2. TEMPORARY BRIDGE REQUIREMENTS: ONE OR TWO WAY ONE TRAFFIC CONTROL SIGNALS REQUIRED YES
 MINIMUM CLEAR SPAN 80 MINIMUM CLEAR HEIGHT 21 ARE SIDEWALKS REQUIRED? _____ IF SO, ON WHAT SIDE _____

*A 30' CONCRETE DAM IS JUST DOWNSTREAM OF THE BRIDGE, WHICH CONTROLS THE HEAD-WATER ELEVATIONS

ADDITIONAL DESIGN CONSIDERATIONS

PRESTRESSING STEEL
 1/2" Ø, 270 KSI, SEVEN WIRE STRAND, LOW RELAXATION

STRESS LEVELS	LOAD RATING (TONS)			
	H	HR	362	6 ANGLE (3A, STR. HA, STR. BA, BEH)
INVENTORY 0.55 P _y				
POSTED 0.87 P _y				
OPERATING 0.79 P _y				

STATE OF VERMONT
 AGENCY OF TRANSPORTATION

Town of LONDONDERRY Bridge No. 28
 Highway No. VT. 11 Log Sta. 125+27
 Rev. Sta. 125+87.02

PRELIMINARY INFORMATION
VT. 11 OVER THE WEST RIVER
 Designed By C.W. MEUNIER Drawn By K.S. CLARKE

LONDONDERRY
 BRF 016-1(13)
 ROW SHEET 7 OF 13

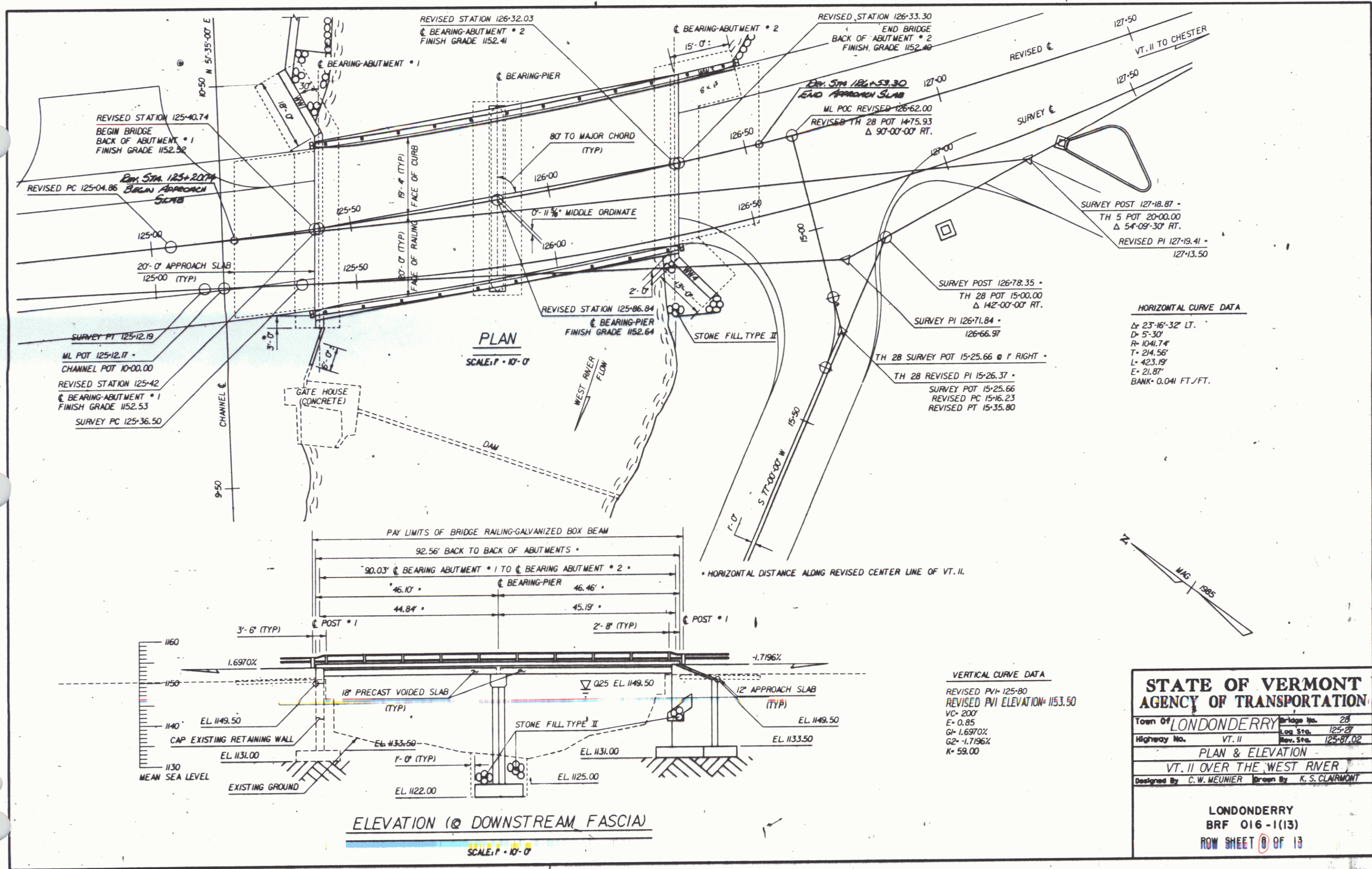

APR 21 1997

TABLE OF PROJECT PROPERTY ACQUISITION

STATE OF VERMONT
AGENCY OF TRANSPORTATION
RIGHT OF WAY PLANS
DETAIL SHEET

PARCEL NO.	GRANTOR	SHEET NO.	BEGINNING STATION	ENDING STATION	TAKING	REM.	RIGHTS	TITLE TAKEN	DATE	TOWN OR CITY RECORDED	BK.	PG.	REMARKS	REVISION NO.	SHEET	DESCRIPTION OF REVISION	DATE	MADE BY	APPROVED BY
1	STATE OF VERMONT	13	SUR. 129+36 LT. SUR. 129+36 LT.	131+22 LT. 131+22 CL.				MD	10-28-87	LONDONDERRY	45	141-142	FORMERLY SKELDON	1	11A 13	PARCEL NO. 1 STATE OF VERMONT. ADD FLAG AT 131+22 25' LT. ADD BOTH MAINTENANCE AGREE. AREAS TO LAST DETAIL SHEET. PER C.O. 8256.	09-01-92	M. J. R.	L. W. B.
2A	BRESSLER, BARRY & TIFFT, MARION L.	13	REV. 127+42 LT.	129+35 LT.	0.13A±	NONE		MD		LONDONDERRY			TOTAL TAKE	2	13	PARCEL NO. 8 BRANDIMARTE. MOVE LOCATION OF SPRUCE TREES TO NORTHERLY SIDE OF FENCE. ADD NOTE FOR THEIR REMOVAL. PER C.O. 8265.	10-29-92	M. J. R.	L. W. B.
2B		13	REV. 127+50 LT.	129+35 LT.	0.10A±		ALL R.T. & I.						VT. RTE. 11	3	11A 13	PARCEL NO. 11 HERMAN UNDER PARCEL 11A. 'BY OPTION ONLY'. ADD THE FOLLOWING RIGHTS: A) CUL (P), REV. 128+92 RT. ~ 129+55 RT. B) EASEMENT (T), 129+55 RT.±, TO HOOK UP SUMP PUMP LINES(S) TO D. I. C) SLOPE (T), 129+55 RT. ~ 129+74 RT., 0.01A±, 12 S.F.± D) RESET (T), REV. 128+95 RT., LARGE ROCK. PER C.O. 8346.	04-07-93	C. C. P.	L. W. B.
3	STATE OF VERMONT	13	REV. 126+37 LT. REV. 126+26 RT.	REV. 127+50 LT. REV. 127+53 RT.	0.08A± 0.07A±	NONE	ALL R.T. & I.	MD	01-17-90	LONDONDERRY	47	496-497	FORMERLY SALAFIA, JAMES R. & BOZEMAYER, CARL P., VT. RTE. 11 (3025 S.F.±)						
4A	GENSER, WALTER R. & BETTE L.	12	REV. 123+60 LT. REV. 123+00 LT. REV. 123+41 LT. REV. 123+41 LT. REV. 123+50 LT.	REV. 123+71 LT. REV. 123+45 LT. REV. 123+74 LT. REV. 123+70 LT.	0.01A±		DRIVE (T) CULVERT (P) DITCH (P) EASEMENT (T)	MD		LONDONDERRY			40 S.F.± 30' PAVED MP. 0232 PAVED 175 S.F.± RESET BOULDERS	4	11A 13	PARCEL NO. 9 ROWLEY. ADD DRIVE (T) @ STA. REV. 128+10 RT., M.P. 0245 TO LAYOUT AND DETAIL SHEET. PER C.O. 8347.	04-07-93	C. C. P.	L. W. B.
4B		12	122+00 CL.	REV. 124+21 LT.	0.13A±		ALL R.T. & I.						VT. RTE. 11	5	11A 11B	ADD NEW DETAIL SHEET 11B TO PROJECT AND CHANGE SHEET 11 TO 11A. PER C.O. 8355.	04-08-93	C. C. P.	L. W. B.
5A	GENSER, WALTER R. & BETTE L.	12	REV. 123+50 RT. REV. 123+62 RT. REV. 123+73 RT.	REV. 123+84 RT. REV. 123+85 RT. REV. 123+85 RT.	0.01A±		SLOPE (T) CULVERT (P)	MD		LONDONDERRY			34 S.F.± 65 S.F.±	6	13	GENERAL REVISION. PLOT NEW SHEET TO SHOW REVISED T.H. 28 & T.H. 5 INTERSECTION. PER C.O. 8419.	08-03-93	C. C. P.	L. W. B.
5B		12	123+26 CL.	REV. 123+84 LT.	0.03A±		ALL R.T. & I.						VT. RTE. 11 1450 S.F.±			MYLARS TO DESIGN 11-05-93			

03-3025 1805 78F213
ACCT.pr.op
/p/prop/78f213/rf2134.dgn
DATE PLOTTED 03-AUG-93
78f213.dwg

DR. (P)- DRAINAGE RIGHT
DIT. (P)- DITCHING RIGHT
CH. (P)- CHANNEL RT.
DRIVE (T)- DRIVE RIGHT
CUL. (P)- CULVERT RIGHT
[W]- WATER SOURCES

PRESENT R.O.W.
TAKING WITHOUT ACCESS
TAKING WITHOUT ACCESS ALONG PROPERTY LINE
TAKING WITH ACCESS
PERMANENT EASEMENT
TEMPORARY EASEMENT

LEGEND
--- CZ (P) --- CLEAR ZONE
--- CONST. (T) --- CONSTRUCTION EASEMENT
SR SR SLOPE RIGHTS
P PROPERTY LINE
TOP OF CUT
TOE OF SLOPE

REVISED 08-03-93
APPROVED: LAWRENCE M. BLISS DATE: 7-22-92
AGENT D. PLANS & TITLES

R. O. W. PLANS
LONDONDERRY
BRF 016-1(13)
SHEET 9 OF 13

**STATE OF VERMONT
AGENCY OF TRANSPORTATION
RIGHT OF WAY PLANS
DETAIL SHEET**

PARCEL NO.	GRANTOR	SHEET NO.	BEGINNING STATION	ENDING STATION	TAKING	REM.	RIGHTS	TITLE TAKEN	DATE	TOWN OR CITY RECORDED	BK.	PG.	REMARKS	REVISION NO.	SHEET	DESCRIPTION OF REVISION	DATE	MADE BY	APPROVED BY	
6A	TOWN OF LONDONDERRY	12.13	REV. 123+84 RT. REV. 123+85 RT. REV. 123+85 RT. REV. 124+00 RT. REV. 124+02 RT. REV. 124+81 RT. REV. 125+15 RT. REV. 125+20 RT. REV. 125+35 RT. TH28 15+85 RT. TH28 15+90 RT. REV. 126+29 RT. REV. 124+00 RT. REV. 125+02 RT. REV. 124+36 RT.	REV. 125+27 RT. REV. 124+50 RT. REV. 125+33 RT. REV. 126+33 RT. REV. 125+15 RT. REV. 125+20 RT. REV. 125+40 RT. TH28 15+90 RT. REV. 126+40 RT. REV. 125+15 RT. REV. 125+22 RT.	0.01A±		CULVERT (P) SLOPE (T) 0.06A± EASEMENT (T) 0.22A± INSTALL & MAINTAIN (P) CULVERT (P) DITCH (P) DRAINAGE (P) INSTALL & MAINTAIN (P) CULVERT & DITCH (P) DRAINAGE (P) SLOPE (P) 0.01A± DRIVE (T) INSTALL & MAINTAIN (P) REMOVE & RESET (T)	MD	11-22-93	LONDONDERRY	51	10-8	235 S.F. ± 2650 S.F. ± TEMPORARY BRIDGE DETOUR SIGN BRIDGE WING WALL 65 S.F. ± 115' PAVED AREA MP. 0235 GUARDRAIL STONE							
6B		12.13	REV. 123+84 LT. REV. 126+62 RT. REV. 127+35 RT.	REV. 127+63 RT.	0.22A±		ALL R. T. & I. APPROACH (T) APPROACH (T)						VT. RTE. 11 TH 28 TH 5							
7A	GENSER, WALTER R.	12.13	REV. 125+10 LT. REV. 124+21 LT. REV. 124+23 LT. REV. 124+27 LT. REV. 124+37 LT. REV. 124+90 LT. REV. 125+27 LT. REV. 125+40 LT. REV. 125+42 LT.	REV. 125+52 LT. REV. 124+45 LT. REV. 124+35 LT. REV. 124+72 LT. REV. 125+10 LT. REV. 125+70 LT. ±	0.02A±		SLOPE (T) 0.01A± DITCH (P) 0.01A± WALK (T) CULVERT (P) DRIVE (T) INSTALL (T) INSTALL & MAINT. (P)	MD		LONDONDERRY			700 S.F. ± 80 S.F. ± PAVED 30 S.F. 30' PAVED MP. 0236 SEPTIC TANK ACCESS RETAINING WALL SIGN							
7B		12.13	REV. 124+21 LT.	REV. 126+37 LT.	0.10A±		ALL R. T. & I.						VT. RTE. 11							
7C		13	REV. 125+44 LT.	REV. 126+93 LT.	0.07A±		ALL R. T. & I.						WEST RIVER 3100 S.F. ±							
8	BRANDIMARTE, JAMES R. & ANDREA M.	12.13	CHANNEL 11+50 RT. CHANNEL 11+55 LT.	CHANNEL 11+53 LT. CHANNEL 11+55 RT.			INSTALL & MAINT. (P) REMOVE & RESET (T)	MD		LONDONDERRY			RETAINING WALL FENCE							

03-3025 1805 78F213
ACCT. lparm
/usr/zfal/070070.dlr/78123d.dgn
DATE PLOTTED 16-JUL-1992

DR. (P)- DRAINAGE RIGHT
DIT. (P)- DITCHING RIGHT
CH. (P)- CHANNEL RT.
DRIVE (T)- DRIVE RIGHT
CUL. (P)- CULVERT RIGHT
[W]- WATER SOURCES

PRESENT R.O.W.
TAKING WITHOUT ACCESS
TAKING WITHOUT ACCESS ALONG PROPERTY LINE
TAKING WITH ACCESS
PERMANENT EASEMENT
TEMPORARY EASEMENT

LEGEND . . . CZ (P) CLEAR ZONE
CONST. (T) CONSTRUCTION EASEMENT
SR SLOPE RIGHTS
P PROPERTY LINE
L TOP OF CUT
O TOE OF SLOPE

APPROVED: *[Signature]* DATE: 7/16/92
AGENT D. PLANS & TITLES

R. O. W. PLANS
LONDONDERRY
BRF 016-1(13)
SHEET 10 OF 13

TABLE OF PROJECT PROPERTY ACQUISITION

STATE OF VERMONT
AGENCY OF TRANSPORTATION
RIGHT OF WAY PLANS
DETAIL SHEET

PARCEL NO.	GRANTOR	SHEET NO.	BEGINNING STATION	ENDING STATION	TAKING	REM.	RIGHTS	TITLE TAKEN	DATE	TOWN OR CITY RECORDED	BK.	PG.	REMARKS	REVISION NO.	SHEET	DESCRIPTION OF REVISION	DATE	MADE BY	APPROVED BY		
9A	ROWLEY, ROLLIN C. JR.	13	REV. 127+63 RT. REV. 127+67 RT. REV. 128+10 RT.	REV. 127+68 RT. REV. 127+88 RT.	0.01A±		SLOPE (T) 0.01A± DRIVE (T)	MD	12-01-03	LONDONDERRY	51	98-7	6 S.F.± 80 S.F.± 12' PAVED M.P. 0245								
9B		13	REV. 127+58 RT.	REV. 128+49 RT.	0.05A±		ALL R. T. & I.						2250 S.F.± VT. RTE. 11								
10	LONDONDERRY GRANGE NO. 508	13	REV. 128+49 RT. REV. 128+85 RT. REV. 128+84 RT. REV. 128+90 RT. REV. 128+62 RT.	REV. 128+92 RT. REV. 128+92 RT.	0.02A±		ALL R. T. & I. INSTALL & MAINTAIN (P) CONST. (T) 0.01A± CULVERT (P) WALK (T)	MD	10-30-03	LONDONDERRY	51	51-2	VT. RTE. 11 1075 S.F.± SIGN 95 S.F.± 4' CONCRETE								
11	HERMAN, WILLIAM F. JR. & VIRGINIA P.	13	REV. 128+92 RT. REV. 128+92 RT. REV. 128+05 RT. REV. 128+17 RT. REV. 128+92 RT.	129+74 CL. REV. 128+98 RT. 129+74 RT.	0.04A±		ALL R. T. & I. CONST. (T) 0.01A± DRIVE (T) RESET (T) RESET (T)	MD	11-03-03	LONDONDERRY	51	57-0	VT. RTE. 11 1900 S.F.± 20 S.F.± 12' PAVED M.P. 0244 FENCE FENCE								
11A		13	REV. 128+92 RT. REV. 128+95 RT. 129+55 RT.± 129+55 RT.	129+55 RT. 129+74			CULVERT (P) RESET (T) EASEMENT (T) SLOPE (T) 0.01A±	OPTION ONLY					LARGE ROCK TO HOOK UP SUMP PUMP LINE(S) TO D. I. 12 S.F.±								
12	LAMLER, TRAUOGTT & MARGARET	13	129+74 CL. 129+96 RT. 130+44 RT. 129+74 RT.	130+70 CL. 130+54 RT. 130+57 RT. 130+70 RT.	0.05A±		ALL R. T. & I. SLOPE (T) 0.01A± CONST. (T) 0.01A± RESET (T)	MD	01-25-04	LONDONDERRY	51	173-174	VT. RTE. 11 2425 S.F.± 85 S.F.± 40 S.F.± FENCE								
13	BROWN, EDWARD J.	12	121+22 RT. 121+25 RT. 121+47 RT. 121+80 RT. 121+85 RT. 121+93 RT. 122+00 RT. 122+00 RT.	123+26 RT. REV. 122+84 RT. REV. 122+11 RT. 122+00 RT. 122+00 RT. REV. 122+50 RT.	0.12A±		ALL R. T. & I. EASEMENT (T) SLOPE (T) 0.02A± CONST. (T) 0.01A± CULVERT (P) CULVERT (P) DRAINAGE (P) DITCH (P)	MD	10-01-03	LONDONDERRY	51	640	VT. RTE. 11 REMOVE CULVERT 745 S.F.± 275 S.F.± TO ROUTE H20 TO RIVER								

03-3025 1805 78F213

ACCT.prp
/usr/zfd/070070.dfr/781213d.dgn
DATE PLOTTED 07-APR-1993
781213d3.1

DR. (P)- DRAINAGE RIGHT
DIT. (P)- DITCHING RIGHT
CH. (P)- CHANNEL RT.
DRIVE (T)- DRIVE RIGHT
CUL. (P)- CULVERT RIGHT
 WATER SOURCES

PRESENT R.O.W.
TAKING WITHOUT ACCESS
TAKING WITHOUT ACCESS ALONG PROPERTY LINE
TAKING WITH ACCESS
PERMANENT EASEMENT
TEMPORARY EASEMENT

LEGEND

--- CZ (P) --- CLEAR ZONE
--- CONST. (T) --- CONSTRUCTION EASEMENT
--- SR --- SLOPE RIGHTS
--- P --- PROPERTY LINE
--- L --- TOP OF CUT
--- O --- TOE OF SLOPE

REVISED 04-07-03

R. O. W. PLANS

APPROVED: LAWRENCE W. BLISS DATE: 7-22-02
AGENT D. PLANS & TITLES

LONDONDERRY
BRF 016-1(13)
SHEET 11A OF 13

TABLE OF PROJECT PROPERTY ACQUISITION

STATE OF VERMONT
AGENCY OF TRANSPORTATION
RIGHT OF WAY PLANS
DETAIL SHEET

PARCEL NO.	GRANTOR	SHEET NO.	BEGINNING STATION	ENDING STATION	TAKING	REM.	RIGHTS	TITLE TAKEN	DATE	TOWN OR CITY RECORDED	BK.	PG.	REMARKS	REVISION NO.	SHEET	DESCRIPTION OF REVISION	DATE	MADE BY	APPROVED BY	
14	CENTRAL VERMONT PUBLIC SERVICE CORP.												UTILITY							
15	NEW ENGLAND TELEPHONE COMPANY												UTILITY							
	MAINT. AGREE. AREA NO. 1	13	REV. 126+62 RT.	REV. 126+61 RT.									T.H. 28 LENGTH 24'							
	MAINT. AGREE. AREA NO. 2	13	REV. 127+36 RT.	REV. 127+42 RT.									T.H. 5 LENGTH 18'							

03-3025 1805 78F213
ACCT:prop
/usr/zfd/070070.dwg/78F233d.dgn
DATE PLOTTED 07-APR-1993
78F233a

DR. (P)- DRAINAGE RIGHT
DIT. (P)- DITCHING RIGHT
CH. (P)- CHANNEL RT.
DRIVE (T)- DRIVE RIGHT
CUL. (P)- CULVERT RIGHT
W- WATER SOURCES

PRESENT R.O.W.
TAKING WITHOUT ACCESS
TAKING WITHOUT ACCESS ALONG PROPERTY LINE
TAKING WITH ACCESS
PERMANENT EASEMENT
TEMPORARY EASEMENT

LEGEND
CZ (P) CLEAR ZONE
CONSI. (T) CONSTRUCTION EASEMENT
SR SLOPE RIGHTS
P PROPERTY LINE
L TOP OF CUT
TOE OF SLOPE

REVISED 04-07-93
APPROVED: LAWRENCE W. BLISS DATE: 7-22-92
AGENT D. PLANS & TITLES

R. O. W. PLANS
LONDONDERRY
BRF 016-1(13)
SHEET 118 OF 13

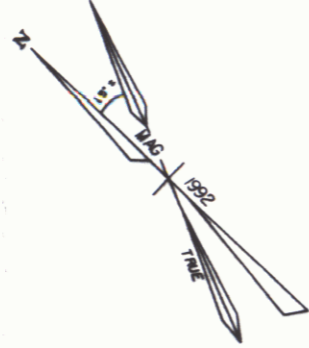

- STEEL BEAM GUARD RAIL
REV 125+02 ~ 125+25 RT.
- CONSTRUCT DRIVE
REV. 123+00 LT. (30' PAVED)
REV. 124+90 LT. (30' PAVED)
- CONSTRUCT PAVED GUTTER
REV. 123+42 LT ~ VT 100 5+88 LT
VT 100 5+85 RT ~ REV. 124+42 LT
- GUARD RAIL APPROACH SECTION TYPE I
REV. 125+25 ~ 125+37.5 RT.
- CONSTRUCT SPECIAL DITCH
REV. 122+00 ~ 122+50 RT.

THE FOLLOWING LIST DENOTES LOCATIONS AND STRUCTURES WHICH THE CONTRACTOR IS NOT ALLOWED TO ALTER.

- VT. RTE. 11--CONCRETE RETAINING WALL
STA 121+60 LT. ~ 122+79 LT.
- VT. RTE. 100--CONCRETE RETAINING WALL
SURV. STA. 5+44 LT. ~ 5+62 LT.
STONE WALL
SURV. STA. 5+50 RT. ~ 6+00 RT.
- T.H. 28--STEEL CRIB WALL
REV. STA. 15+62 LT. ~ 16+12 LT.
STONE WALL
REV. STA. 15+19 LT. ~ 15+33 LT.
- T.H. 5--STONE STEPS
SURV. STA 20+30 RT
CONCRETE CURB
SURV. STA. 20+38 RT. ~ 20+63 RT.

CONSTRUCT SIDEWALK
5" PORTLAND CEMENT CONCRETE--4" WIDE
STA 124+27 LT ~ 124+72 LT

REV 123-00
END APPROACH
BEGIN PROJECT
BRF 016-1(13) S

B M C1933/942,
RESET 1985-DISC.
ELEV 1154.819

GENSER, WALTER R. & BETTE L.

VT 100 5-88
END CONSTRUCTION

SURV PI 123-17.00-
123-16.43
REV PI 123-17.00-
123-16.89

DO NOT DISTURB

VT 100 5-24.46 @ VRT
BEGIN CONSTRUCTION

NEW ENGLAND SHOE BARN

DO NOT DISTURB

RESET (T)

DO NOT DISTURB

REV. 123+26

REV. 123+70

REV. 123+70

REV. 123+60

REV. 123+84

REV. 123+50

REV. 123+84

REV. 123+84

REV. 123+84

REV. 123+84

REV. 123+84

REV. 123+84

REV. 123+84

REV. 123+84

REV. 123+84

REV. 123+84

REV. 123+84

REV. 123+84

REV. 123+84

121+00
BEGIN APPROACH

N/F
ROMAN CATHOLIC
DIOCESE OF BURLINGTON

PI 120-27.69-
120-27.68

VT RTE 11 & 100
TO MANCHESTER
AND JAMAICA

THE MILL TAVERN

CURVE#1 DATA
L 1-27-15 RT
R 5-00
PC 120-03.45
PT 120-51.92
PI 120-27.69
PVI 120-27.68
ELEV 120.00

BEGIN R. O. W. PROJECT

BRF 016-1(13) STA. 121+22

NOTE: CONTINUE DITCH AS
NEEDED TO OUTLET.

SURV. CURVE#2 DATA
L 1-49-10 RT
R 2-00
PC 121-03.45
PT 121-51.92
PI 121-27.69
PVI 121-27.68
ELEV 121.00

REV. CURVE#2 DATA
L 1-49-10 RT
R 2-00
PC 121-03.45
PT 121-51.92
PI 121-27.69
PVI 121-27.68
ELEV 121.00

SCALE IN FEET

DATUM
VERTICAL MVD 1929
HORIZONTAL N/A

03-3025 1805 78F213 FJM

SURVEYED BY FANTONI DATE 9/85
DRAWN BY MEUNIER DATE 12/88
SQUAD LEADER HEDGES/JUNVALL
DESIGN FILE NO. /UMF/2101/070070.DR/78F213Z11.4
PLOT FILE THE30101.DAT PLOTTED 08-APR-1993

LONDONDERRY
BRF 016-1(13)

R. O. W. SHEET (2) OF 13

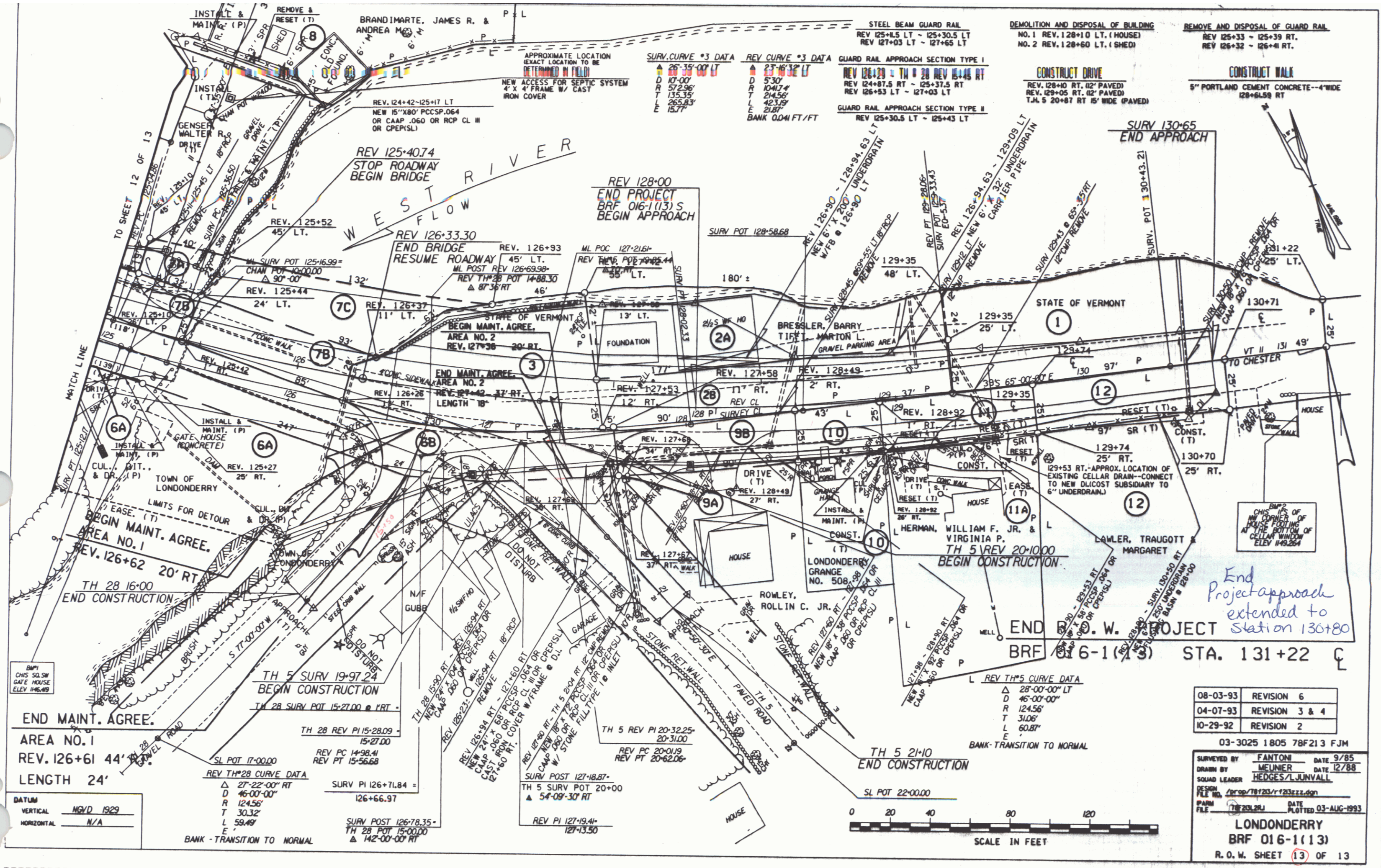

BMP CHD 50 SW GATE HOUSE ELEV 146.49

END MAINT. AGREE.
 AREA NO. 1
 REV. 126+61 44' RT
 LENGTH 24'

DATUM
 VERTICAL MVD 1929
 HORIZONTAL N/A

TH 28 SURV POT 15-27.00 @ VRT
 REV PC 14-38.41
 REV PT 15-56.68
 SURV PI 126+71.84 = 126+66.97
 SURV POST 126-78.35
 TH 28 POT 15-00.00
 @ 142-00-00 RT

TH 5 SURV 19-97.24
 BEGIN CONSTRUCTION
 TH 28 SURV POT 15-27.00 @ VRT

TH 5 REV PI 20-32.25-20-31.00
 REV PC 20-01.9
 REV PT 20-62.06
 SURV POST 127-18.87
 TH 5 SURV POT 20+00
 @ 54-09-30 RT
 REV PI 127-19.41
 127-13.50

TH 5 REV PI 20-32.25-20-31.00
 REV PC 20-01.9
 REV PT 20-62.06

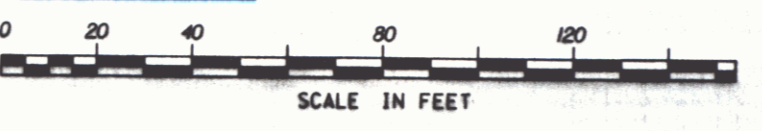

08-03-93	REVISION 6
04-07-93	REVISION 3 & 4
10-29-92	REVISION 2

03-3025 1805 78F213 FJM
 SURVEYED BY FANTONI DATE 9/85
 DRAWN BY MELNER DATE 12/88
 SQUAD LEADER HEDGES/L JUNVALL
 REGION 7/000/78123/123222.dwg
 PARM FILE 782322JL DATE PLOTTED 03-AUG-1993
LONDONDERRY
BRF 016-1(13)
 R. O. W. SHEET 13 OF 13

End Project approach extended to Station 130+80

APR 21 1997