

STATE OF VERMONT  
AGENCY OF TRANSPORTATION

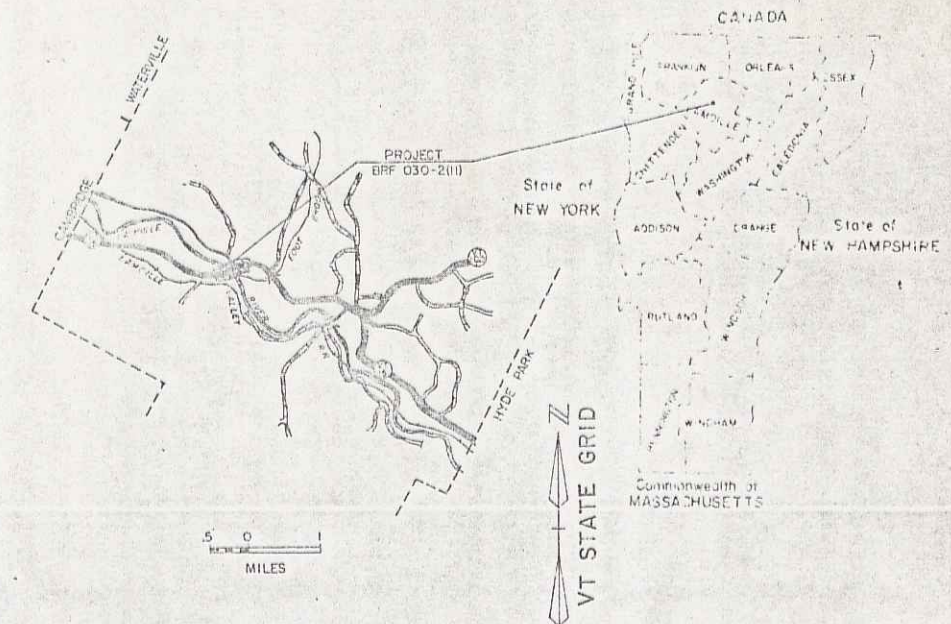

PROPOSED IMPROVEMENT  
**TOWN OF JOHNSON**  
**COUNTY OF LAMOILLE**  
VT RTE 15 (FAP)

R.O.W. PLANS



BEGINNING AT A POINT ON VT RTE 15 IN THE TOWN OF JOHNSON, WHICH IS APPROXIMATELY 2.159 MI. EASTERLY OF THE CAMBRIDGE-JOHNSON TOWN LINE, AND CONTINUING EASTERLY FOR 0.227 MI.

LENGTH OF ROADWAY	945.23	FEET	0.179	MILES
LENGTH OF BRIDGE	254.77	FEET	0.048	MILES
LENGTH OF PROJECT	1200.00	FEET	0.227	MILES
LENGTH OF R.O.W. PROJECT	1525.00	FEET	0.288	MILES

PROJECT TO CONSIST OF REPLACEMENT OF BRIDGE NO. 33 OVER THE LAMOILLE RIVER WITH A NEW TWO SPAN CURVED PLATE GIRDER BRIDGE AND NECESSARY ROADWAY APPROACH WORK TO INCLUDE SUB-BASE, BASE COURSE AND PAVEMENT AS WELL AS NECESSARY DRAINAGE.

END MAINT. AGREE. AREA NO. 1  
REV. TH4 1+00 C

END R.O.W. PROJECT  
STA. 129+40 27' LT.

MP 2.45

BEGIN R.O.W. PROJECT  
STA. 114+15 C

MP 2.159

- CONVENTIONAL SIGNS
- COUNTY LINE
  - TOWN LINE
  - LIMITS OF ACCESS
  - POINT OF ACCESS
  - FENCE LINE
  - STONE WALL
  - TRUNKED WAY
  - GUARD RAIL
  - RAILROAD
  - SURVEY LINE
  - CULVERT
  - POWER POLE
  - TELEPHONE POLE
  - TREES
  - CONTROL OF ACCESS
  - PROPERTY LINE
  - R.O.W. TAKING LINE
  - SLOPE RIGHTS
  - TOP OF CUT
  - TOE OF SLOPE

DATUM

VERTICAL	NSVD 1929
HORIZONTAL	N/A

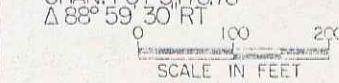
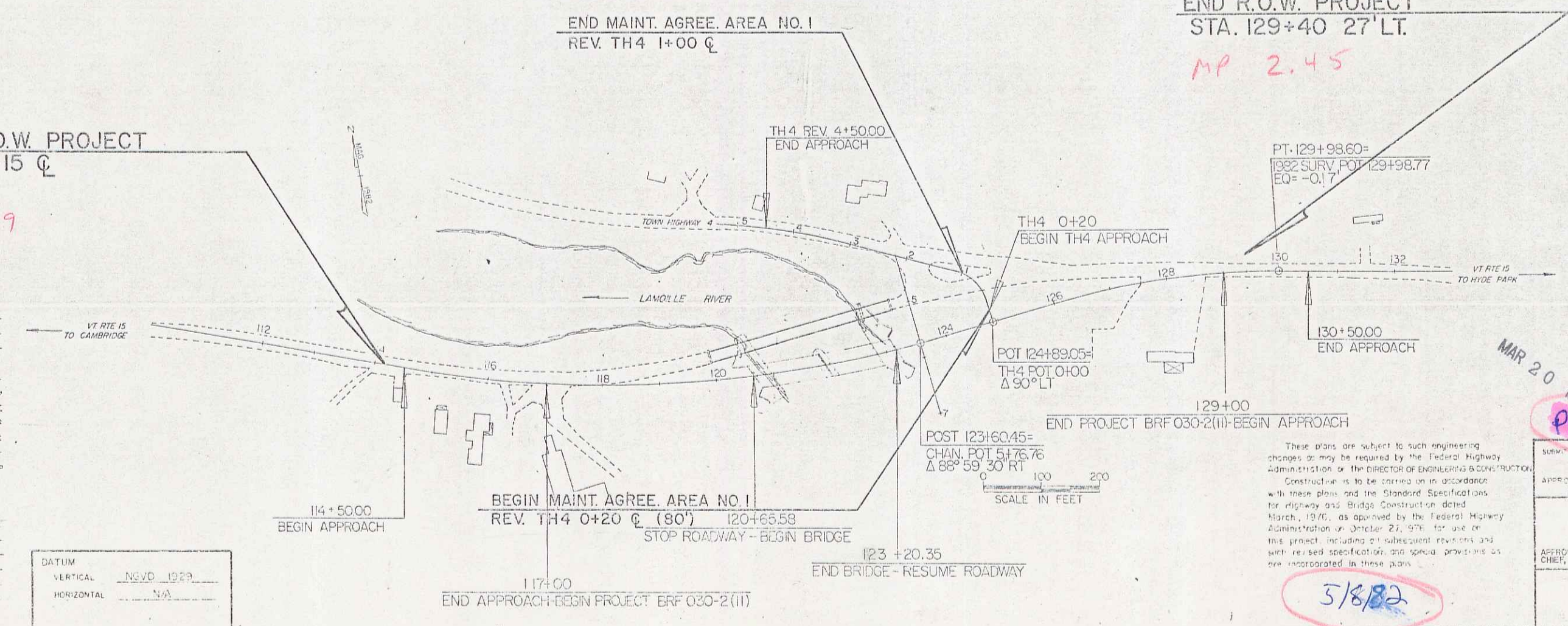

These plans are subject to such engineering changes as may be required by the Federal Highway Administration or the DIRECTOR OF ENGINEERING & CONSTRUCTION. Construction is to be carried out in accordance with these plans and the Standard Specifications for Highway and Bridge Construction dated March, 1976, as approved by the Federal Highway Administration on October 27, 1976 for use on this project, including all subsequent revisions and with revised specifications and special provisions as are incorporated in these plans.

5/8/82

MAR 20 1982

Pin# 78Fa11

APPROVED BY: *[Signature]* DATE: *[Date]*  
CHIEF, PROPERTY ADMINISTRATION

JOHNSON  
BRF 030-2 (11)

SHEET 1 OF 8

REMOVAL AND DISPOSAL OF EXISTING GUARD RAIL

118+07 RT ~ 119+33 LT
118+86 LT ~ 119+65 LT
119+16 LT ~ 119+90 LT
123+20 LT ~ 123+46 LT
123+20 LT ~ 123+51 LT

EXCAVATION REMOVAL OF ROAD SURFACE & PAVEMENT

123+20 LT ~ 124+46 LT
125+30 LT ~ 126+00 LT

GUARD RAIL, STANDARD STEEL BEAM @ WOOD POST TYPE II

LT	RT
119+25 ~ 119+75	115+66 ~ 120+26
123+64 ~ 124+26	123+77 ~ 126+00

CONSTRUCT DRIVE

116+45 RT (14')
116+52 RT ~ 117+16 RT (14')
117+20 LT (30') PAVED
118+00 LT (20') (FISHING ACCESS)
TH#4 2+35± RT. (14')

BREAKAWAY CABLE TERMINAL

LT	RT
119+20 ~ 119+25	116+41 ~ 116+66
124+26 ~ 124+53	

Granite Slope Edging

125+08 LT. ~ 125+81 LT. (Island)
----------------------------------

GUARD RAIL APPROACH SECTION, TYPE I

LT	RT
114+75 ~ 120+25	120+26 ~ 120+76
123+14 ~ 123+64	123+27 ~ 123+77

Cost in Place Cement Conc. Curb, Type A

115+50 RT. ~ 116+25 RT.
-------------------------

Guard Rail, Plank w/ Wood Posts

117+50 LT. ~ 118+50 LT.
-------------------------

Bituminous Conc. Surface for Gutters and Traffic Islands

115+45 RT ~ 116+25 RT (Gutter)
125+08 LT ~ 125+81 LT. (Island)

Curve #1  
 Δ 26° 05' 20" LT  
 D 2' 45"  
 T 2023.48'  
 L 482.71'  
 E 943.69'  
 Pk. 1051' P1/2

END MAINT. AGREE. AREA NO. 1  
 REV. TH4 1+00 C

BM #10  
 6" CONC. POST  
 115.52 ELEV. 44.22

TH#4 Rev. Curve Data  
 Δ 56° 23' 02" LT  
 D 80' 01' 19"  
 T 71.60'  
 L 10.00'  
 E 12.96'  
 Pk. 12.42'

BEGIN R.O.W. PROJECT  
 STA. 114+15 C

BEGIN MAINT. AGREE. AREA NO. 1  
 REV. TH4 0+20 C (80')

DATUM  
 VERTICAL 1195.1929  
 HORIZONTAL 1195

SURVEYED BY [Signature] DATE 11/24  
 DRAWN BY [Signature] DATE 1/25  
 TRACED BY [Signature] DATE 1/25

JOHNSON  
 BR# 030-2(1)  
 SHEET 5 OF 8

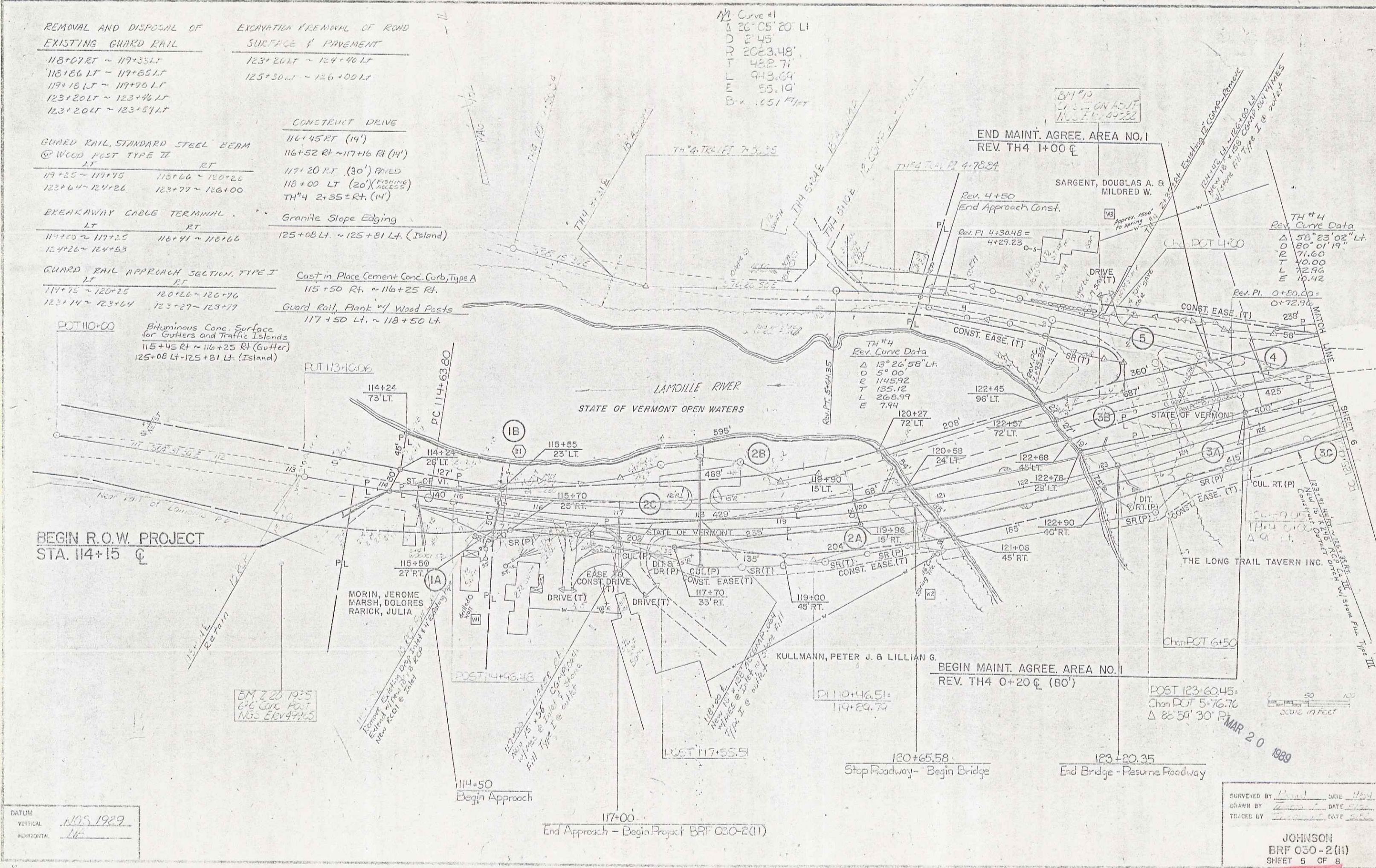

EXCAVATION & REMOVAL OF ROAD SURFACE & PAVEMENT  
126+00 LT ~ 126+50 LT

CONSTRUCT DRIVE  
127+10 RT (40' WIDE) PAVED  
128+00 RT (40' WIDE) PAVED

GRANITE SLOPE EDGING  
STA STA  
126+76 ± RT ~ 126+90 ± RT  
127+30 ± RT ~ 127+80 ± RT  
128+20 ± RT ~ 129+50 ± RT

Guard Rail, Standard Steel Beam w/ Wood Posts, Type II  
126+00 RT ~ 126+27 RT

Breakaway Cable Terminal  
126+27 RT ~ 126+52 RT

DATE	
BY	
REVISION	
NO.	
DESCRIPTION	
DATE	
BY	
REVISION	
NO.	
DESCRIPTION	

DATE	
BY	
REVISION	
NO.	
DESCRIPTION	
DATE	
BY	
REVISION	
NO.	
DESCRIPTION	

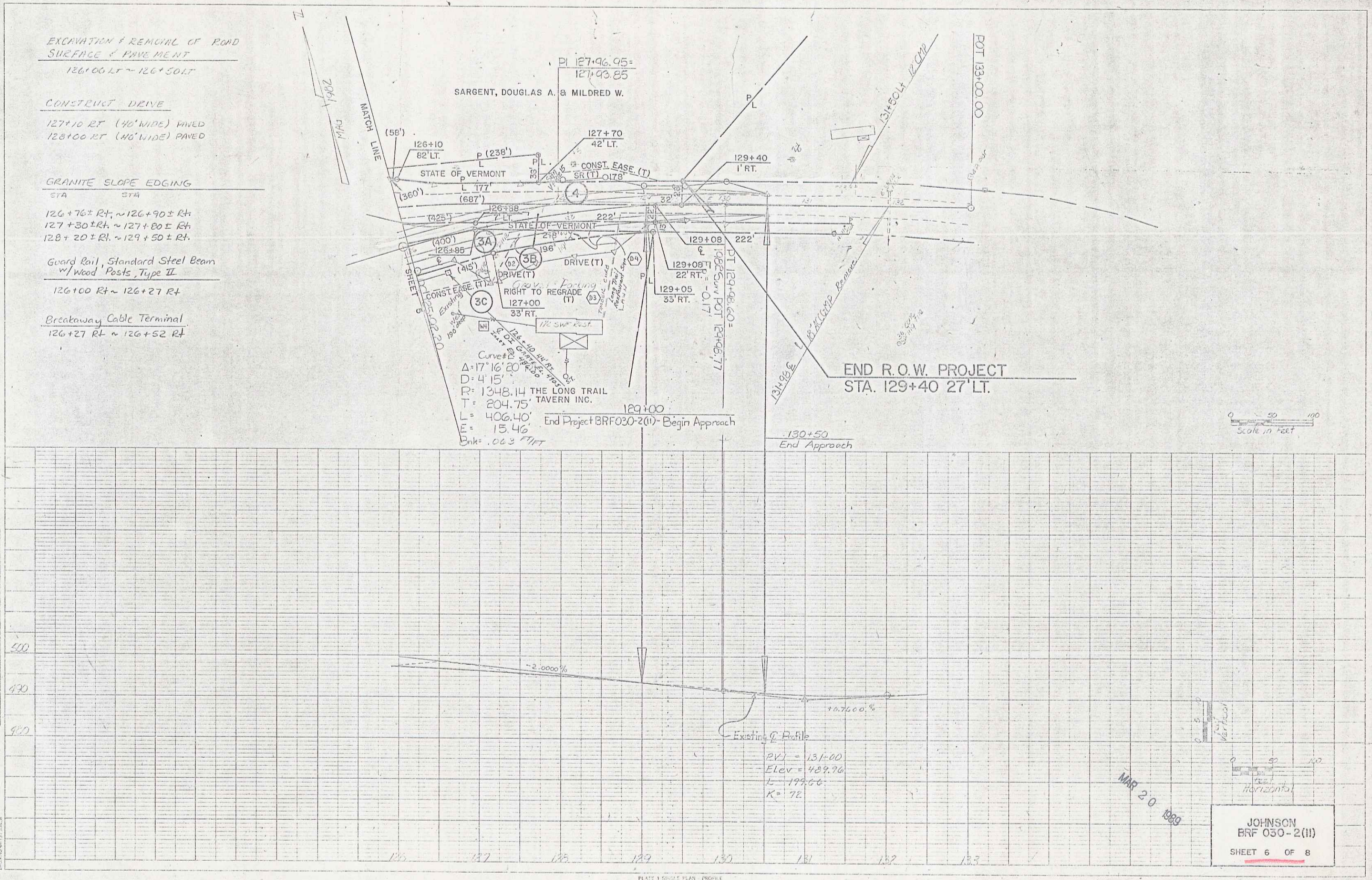

JOHNSON  
BRF 030-2(II)  
SHEET 6 OF 8

MAR 20 1989