

STATE OF VERMONT
AGENCY OF TRANSPORTATION

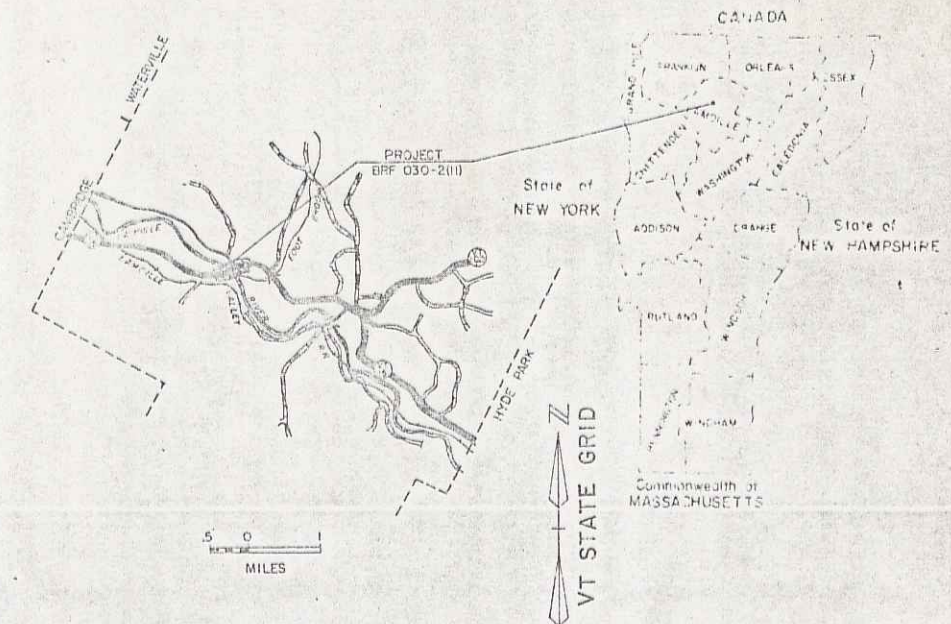

PROPOSED IMPROVEMENT
TOWN OF JOHNSON
COUNTY OF LAMOILLE
VT RTE 15 (FAP)

R.O.W. PLANS



BEGINNING AT A POINT ON VT RTE 15 IN THE TOWN OF JOHNSON, WHICH IS APPROXIMATELY 2.159 MI. EASTERLY OF THE CAMBRIDGE-JOHNSON TOWN LINE, AND CONTINUING EASTERLY FOR 0.227 MI.

LENGTH OF ROADWAY	945.23	FEET	0.179	MILES
LENGTH OF BRIDGE	254.77	FEET	0.048	MILES
LENGTH OF PROJECT	1200.00	FEET	0.227	MILES
LENGTH OF R.O.W. PROJECT	1525.00	FEET	0.288	MILES

PROJECT TO CONSIST OF REPLACEMENT OF BRIDGE NO. 33 OVER THE LAMOILLE RIVER WITH A NEW TWO SPAN CURVED PLATE GIRDER BRIDGE AND NECESSARY ROADWAY APPROACH WORK TO INCLUDE SUB-BASE, BASE COURSE AND PAVEMENT AS WELL AS NECESSARY DRAINAGE.

END MAINT. AGREE. AREA NO. 1
REV. TH4 1+00 C

END R.O.W. PROJECT
STA. 129+40 27' LT.

MP 2.45

BEGIN R.O.W. PROJECT
STA. 114+15 C

MP 2.159

CONVENTIONAL SIGNS

- COUNTY LINE
- TOWN LINE
- LIMITS OF ACCESS
- POINT OF ACCESS
- FENCE LINE
- STONE WALL
- TRAVELLED WAY
- GUARD RAIL
- RAILROAD
- SURVEY LINE
- CULVERT
- POWER POLE
- TELEPHONE POLE
- TREES
- CONTROL OF ACCESS
- PROPERTY LINE
- R.O.W. TAKING LINE
- SLOPE RIGHTS
- TOP OF CUT
- TOE OF SLOPE

DATUM

VERTICAL	NVD 1929
HORIZONTAL	N/A

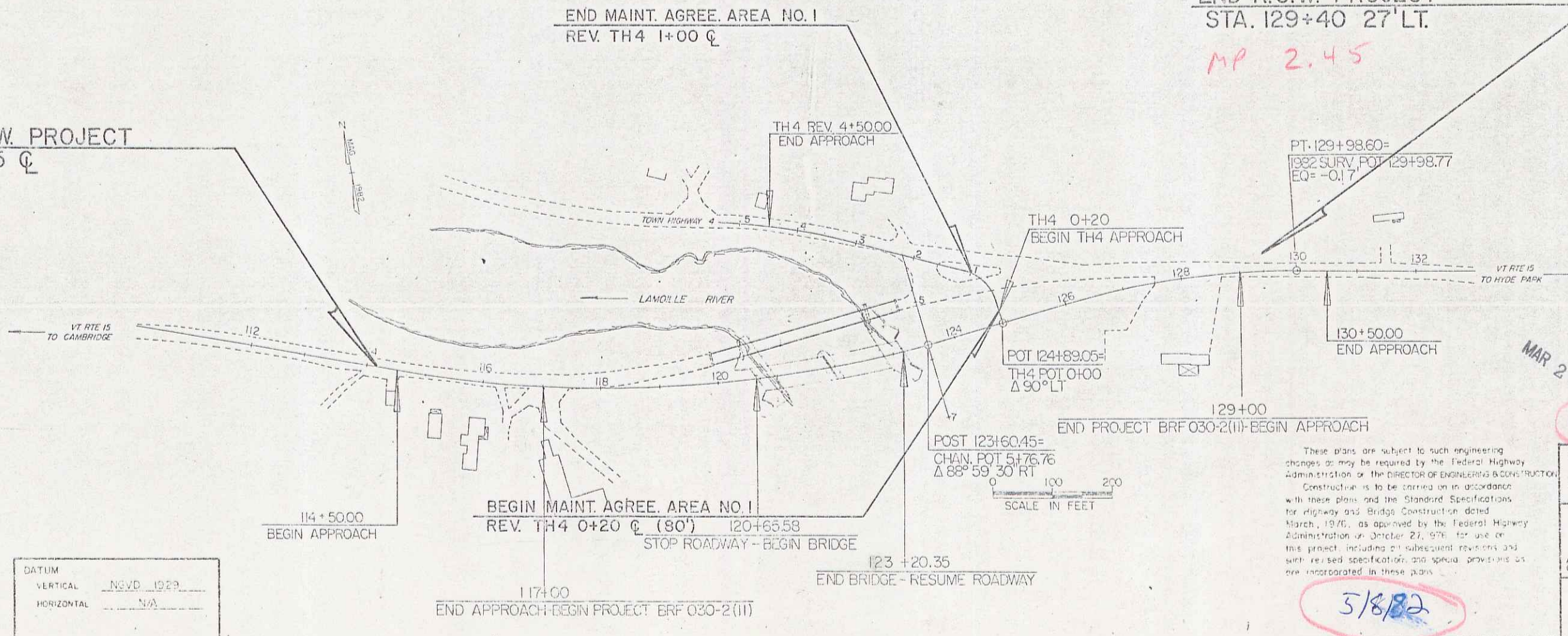

These plans are subject to such engineering changes as may be required by the Federal Highway Administration or the DIRECTOR OF ENGINEERING & CONSTRUCTION. Construction is to be carried out in accordance with these plans and the Standard Specifications for Highway and Bridge Construction dated March, 1976, as approved by the Federal Highway Administration on October 27, 1976 for use on this project, including all subsequent revisions and with revised specifications and special provisions as are incorporated in these plans.

MAR 20 1989

Pin# 78Fa11

APPROVED BY: [Signature] DATE: [Blank]
CHIEF, PROPERTY ADMINISTRATION

JOHNSON
BRF 030-2 (11)

SHEET 1 OF 8

5/8/82