

KONOPAS, DOROTHY W.
WONDROFSKI, HERMAN F.

36

- EXTRA DEPTH OF SUBBASE
STA 5+462.5 TO 5+478.5
STA 5+559 TO 5+574
- GRANULAR BORROW
STA 5+462.5 TO 5+478.5
STA 5+559 TO 5+574
- GUARDRAIL APPROACH SECTION, NETC 2 RAIL
STA 0+109.6 RT (TH 41) TO STA 5+474.7 LT
STA 0+210.3 RT (TH 43) TO STA 5+474.7 RT
STA 5+563.0 TO 5+570.6 LT & RT
- SNOW FENCE (MODIFIED)
STA 5+546 TO 5+588 RT
MARCH, ROBIN C.
- STEEL BEAM GUARDRAIL
STA 5+420 TO 0+114.1 LT (TH 41)
STA 5+420 TO 0+215.8 RT (TH 43)
STA 5+570.6 TO 5+600 RT
STA 5+570.6 TO 5+600 LT
STA 0+109.6 TO 0+121.0 RT (TH 41)
STA 0+210.3 TO 0+240.0 LT (TH 43)
- REMOVAL & DISP. OF GUARDRAIL
STA 5+420 TO 5+429 RT
STA 5+472 TO 5+482 LT
STA 5+478 TO 5+482 RT
STA 5+556 TO 5+592 RT
STA 5+556 LT TO 5+600 LT
- REMOVING AND RESETTING FENCE
STA 5+420 RT TO 0+240 RT (TH 43)
- MODIFIED ECCENTRIC LOADER TERMINAL
STA 0+114.1 TO 0+125.5 LT (TH 41)
STA 0+121.0 TO 0+132.4 RT (TH 41)
STA 0+215.8 TO 0+227.2 RT (TH 43)
- STONE FILL TYPE I
VT RTE 100 STA 5+420 LT TO
TH 41 STA 0+120 LT-600 DEEP

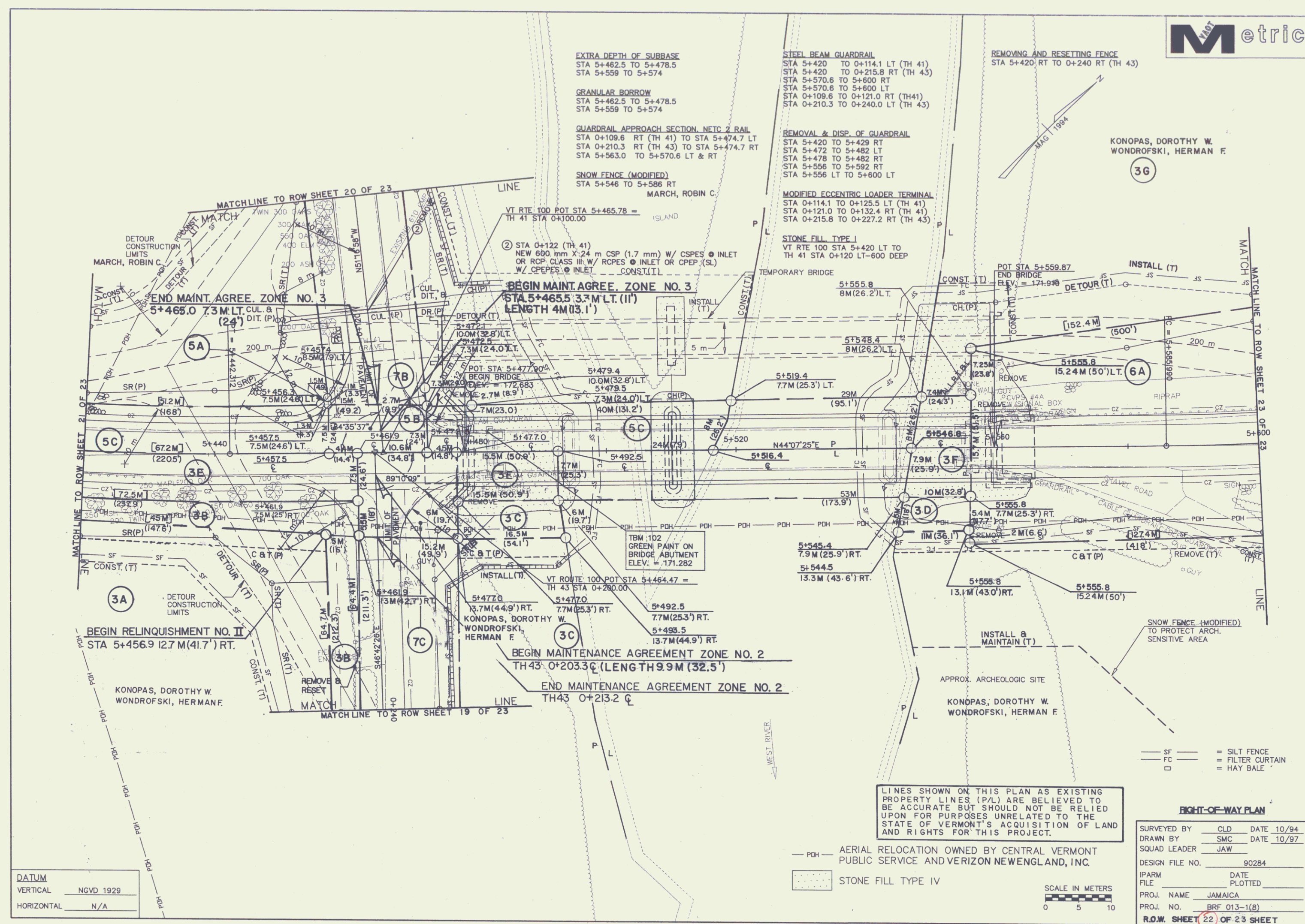

DATUM

VERTICAL	NGVD 1929
HORIZONTAL	N/A

LINES SHOWN ON THIS PLAN AS EXISTING PROPERTY LINES (P/L) ARE BELIEVED TO BE ACCURATE BUT SHOULD NOT BE RELIED UPON FOR PURPOSES UNRELATED TO THE STATE OF VERMONT'S ACQUISITION OF LAND AND RIGHTS FOR THIS PROJECT.

- PDH — AERIAL RELOCATION OWNED BY CENTRAL VERMONT PUBLIC SERVICE AND VERIZON NEWENGLAND, INC.
- STONE FILL TYPE IV

- SF — SILT FENCE
- FC — FILTER CURTAIN
- H — HAY BALE

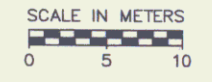

RIGHT-OF-WAY PLAN

SURVEYED BY	CLD	DATE	10/94
DRAWN BY	SMC	DATE	10/97
SQUAD LEADER	JAW		
DESIGN FILE NO.	90284		
IPARM	DATE		
FILE	PLOTTED		
PROJ. NAME	JAMAICA		
PROJ. NO.	BRF 013-1(B)		
R.O.W. SHEET	22	OF 23 SHEET	