

INDEX OF SHEETS

# STATE OF VERMONT AGENCY OF TRANSPORTATION

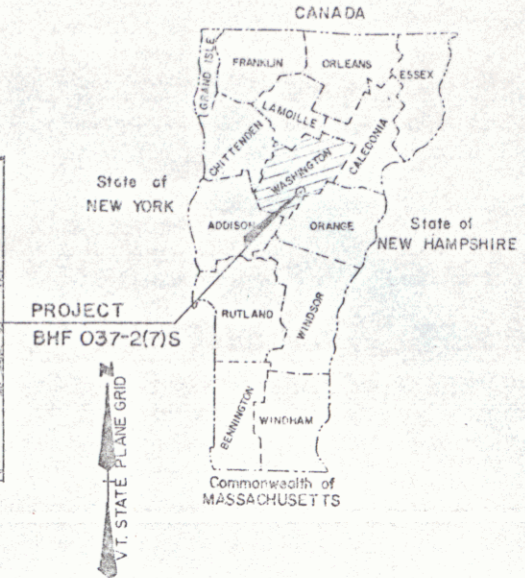

## PROPOSED IMPROVEMENT **TOWN OF EAST MONTPELIER** COUNTY OF WASHINGTON **VT. RTE. 14 (E.A.P.)**

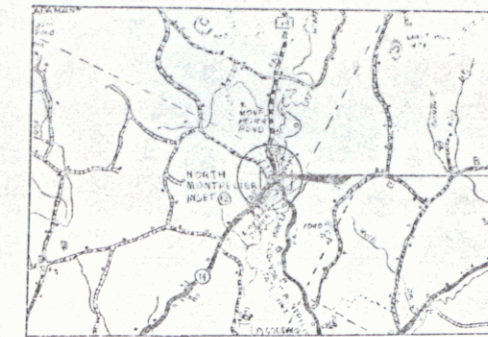

R.O.W. PLANS

IN EAST MONTPELIER, BEGINNING AT A POINT ON EXISTING VT. ROUTE 14 WHICH IS LOCATED APPROXIMATELY 0.187 MILES SOUTHERLY OF THE EAST MONTPELIER-CALAIS TOWN LINE, AND EXTENDING NORTHERLY FOR APPROXIMATELY 0.024 MILES. -  
LENGTH OF R.O.W. 322 FEET 0.098 MILES  
LENGTH OF ROADWAY 45 FEET 0.009 MILES  
LENGTH OF BRIDGE 80 FEET 0.015 MILES  
LENGTH OF PROJECT 125 FEET 0.024 MILES

PROJECT WORK TO CONSIST OF REHABILITATION AND WIDENING OF BRIDGE NO. 72 AS WELL AS ASSOCIATED ROADWAY APPROACH AND CHANNEL WORK.

BEGIN R.O.W. PROJECT  
BHF 037-2(7)S STA. 294+78 33' RT.

- CONVENTIONAL SIGNS
- COUNTY LINE
  - TOWN LINE
  - LIMITS OF ACCESS
  - POINT OF ACCESS
  - FENCE LINE
  - STONE WALL
  - TRAVELED WAY
  - GUARD RAIL
  - RAILROAD
  - SURVEY LINE
  - CULVERT
  - POWER POLE
  - TELEPHONE POLE
  - TREES
  - CONTROL OF ACCESS
  - PROPERTY LINE
  - R.O.W. TAKING LINE
  - SLOPE RIGHTS
  - TOP OF CUT
  - TCE OF SLOPE

DATUM  
VERTICAL N/A  
HORIZONTAL N/A

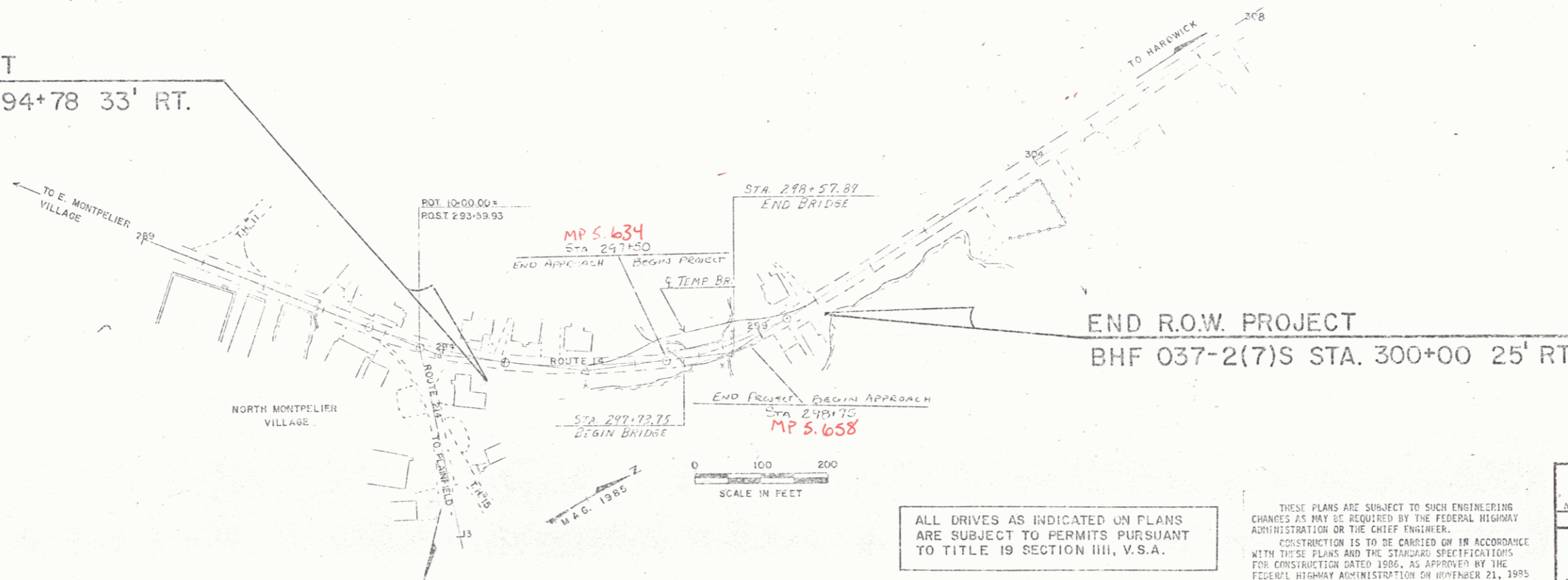

END R.O.W. PROJECT  
BHF 037-2(7)S STA. 300+00 25' RT.

ALL DRIVES AS INDICATED ON PLANS ARE SUBJECT TO PERMITS PURSUANT TO TITLE 19 SECTION III, V.S.A.

THESE PLANS ARE SUBJECT TO SUCH ENGINEERING CHANGES AS MAY BE REQUIRED BY THE FEDERAL HIGHWAY ADMINISTRATION OR THE CHIEF ENGINEER. CONSTRUCTION IS TO BE CARRIED ON IN ACCORDANCE WITH THESE PLANS AND THE STANDARD SPECIFICATIONS FOR CONSTRUCTION DATED 1986, AS APPROVED BY THE FEDERAL HIGHWAY ADMINISTRATION ON NOVEMBER 21, 1985 FOR USE ON THIS PROJECT, INCLUDING ALL SUBSEQUENT REVISIONS AND SUCH REVISED SPECIFICATIONS AND SPECIAL PROVISIONS AS ARE INCORPORATED IN THESE PLANS.

Pin# 78F201  
PROJECT PROCESSED UNDER  
SECONDARY ROAD PLAN

APPROVED: *R. W. ...* DATE: 12-7-88  
Dir., Dept. of Engineering and Construction

APPROVED: *Samuel ...* DATE: 12/6/88  
Chief, Property Administration

**EAST MONTPELIER**  
**BHF 037-2(7)S**  
R.O.W. SHEET 1 OF 9

FEB 05 1992