

STATE OF VERMONT
AGENCY OF TRANSPORTATION

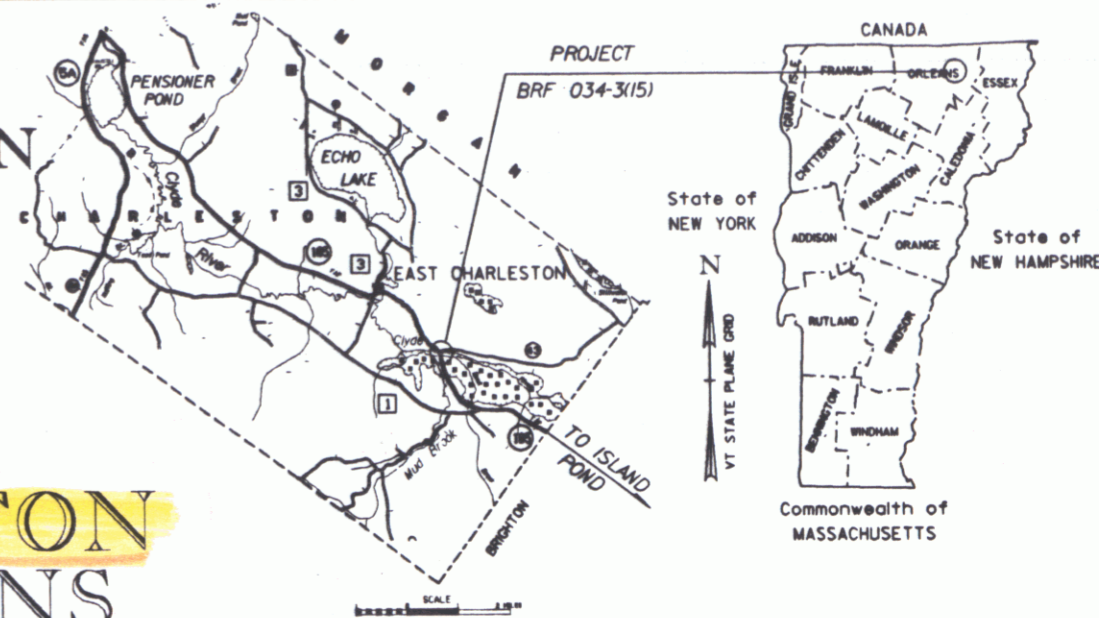

PROPOSED IMPROVEMENT
TOWN OF CHARLESTON
COUNTY OF ORLEANS
VT RTE 105 (F.A.P.)



BEGINNING AT A POINT ON VT 105 APPROXIMATELY 1.90 MILES NORTHWESTERLY FROM THE CHARLESTON-BRIGHTON TOWN LINE AND EXTENDING SOUTHEASTERLY FOR 0.208 MILE.

LENGTH OF ROADWAY= 995.28 FEET= 0.189 MILE
LENGTH OF BRIDGE= 104.72 FEET= 0.019 MILE
LENGTH OF PROJECT= 1100.00 FEET= 0.208 MILE
LENGTH OF R.O.W. PROJECT= 1500.00 FEET= 0.284 MILE
WORK UNDER THIS PROJECT INCLUDES THE REPLACEMENT OF BRIDGE #81 WITH NECESSARY CHANNEL AND ROADWAY APPROACH WORK.

R.O.W. PLANS

END MAINT. AGREE. AREA #1
TH 43 11+10 C LENGTH 58'

BEGIN R.O.W. PROJECT
BRF 034-3(15) STA. 426+50C

END R.O.W. PROJECT
BRF 034-3(15) STA. 441+50C

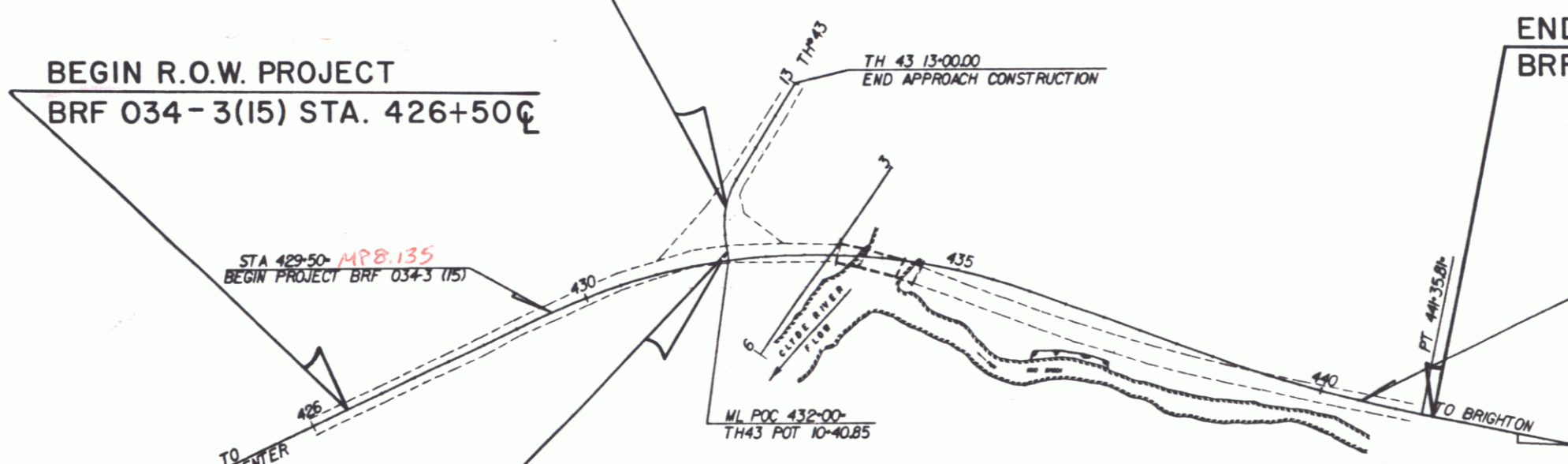

CONVENTIONAL SIGNS

COUNTY LINE	---
TOWN LINE	---
LIMITS OF ACCESS	---X---
POINT OF ACCESS	X
FENCE LINE	---X---
STONE WALL	-----
TRAVELED WAY	-----
GUARD RAIL	-----
RAILROAD	-----
SURVEY LINE	-----
CULVERT	-----
POWER POLE	○
TELEPHONE POLE	◇
TREES	●
CONTROL OF ACCESS	///
PROPERTY LINE	---
R.O.W. TAKING LINE	---
SLOPE RIGHTS	○
TOP OF CUT	△
TOE OF SLOPE	○

DATUM

VERTICAL	---
HORIZONTAL	---



ALL DRIVES AS INDICATED ON PLANS ARE SUBJECT TO PERMITS PURSUANT TO TITLE 19 SECTION III, V.S.A.



Vt. Route 105
RIGHT-OF-WAY DIVISION
TOWN FILE
PERPETUAL
Town of CHARLESTON
(To Be Returned To R.O.W. Division)
Pin # 78F196

THESE PLANS ARE SUBJECT TO SUCH ENGINEERING CHANGES AS MAY BE REQUIRED BY THE FEDERAL HIGHWAY ADMINISTRATION OR THE AGENCY SECRETARY.
CONSTRUCTION IS TO BE CARRIED ON IN ACCORDANCE WITH THESE PLANS AND THE STANDARD SPECIFICATIONS FOR CONSTRUCTION DATED 1986, AS APPROVED BY THE FEDERAL HIGHWAY ADMINISTRATION ON NOVEMBER 21, 1985 FOR USE ON THIS PROJECT, INCLUDING ALL SUBSEQUENT REVISIONS AND SUCH REVISED SPECIFICATIONS AND SPECIAL PROVISIONS AS ARE INCORPORATED IN THESE PLANS.

MAR 18 1996

APPROVED: *Scott of the Alder* DATE: 8/3/90
Dir., Dept. of Planning & Preconstruction

APPROVED: *Laugher* DATE: 8/6/90
Chief, Property Administration

CHARLESTON
BRF 034-3(15)
R.O.W. SHEET 1 OF 9 SHEETS

TYPICAL SECTIONS

MATERIAL ITEM	THICKNESS TOLERANCE
PAVEMENT	* 1/4"
BASE COURSE	* 1/2"
SUBBASE	* 1"
GRANULAR BORROW	* 1"
SAND BORROW	* 1"

1 1/2" BITUMINOUS CONCRETE PAVEMENT TYPE III
 3" BASE COURSE OF BITUMINOUS CONCRETE PAVEMENT, TYPE I
 18" SUBBASE OF CRUSHED GRAVEL (FINE GRADED)
 30" SAND BORROW
 SHOULDERS : 1 1/2" BITUMINOUS CONCRETE PAVEMENT

SEEDING FORMULA RURAL AREAS

% WT.	LBS./A.	NAME	PUR %	GERM %
3.33	2	CROWN VETCH	97	75
50.00	30	CREeping RED FESCUE	98	85
8.33	5	TIMOTHY	99	85
16.67	10	PERENNIAL RYE GRASS (VAR.PENNFINE)	95	85
8.34	5	ALFAFA (VAR. SARANAC)	99	85
8.33	5	BIRDSFOOT TREFLOIL (VAR.EMPIRE)	98	85
5.00	3	HIGHLAND BENT GRASS	92	85
100.00	60			

THE SEED MIXTURE SHALL NOT HAVE A WEED CONTENT EXCEEDING 0.40% BY WEIGHT AND SHALL BE FREE OF ALL NOXIOUS WEED SEED.
 SEED- TO BE APPLIED PER SEEDING FORMULAS DIRECTED BY THE ENGINEER.
 FERTILIZER- FORMULA 10-20-10 TO BE USED WITH SEED, APPLIED AT THE RATE OF 500 LBS./ACRE.
 AGRICULTURAL LIMESTONE- TO BE APPLIED AT THE RATE OF 2 TONS/ACRE OR AS DIRECTED BY THE ENGINEER.
 HAY MULCH- TO BE PLACED ON EARTH SLOPES AT THE RATE OF 2 TONS/ACRE, OR AS DIRECTED BY THE ENGINEER.
 TOPSOIL- TO BE USED WITH SEED AS INDICATED ON THE PLANS, OR AS DIRECTED BY THE ENGINEER.
 MARKER POSTS- TO BE PLACED AS DIRECTED BY THE ENGINEER.
 SLOPE ROUNDING- ALL CUT SLOPES TO BE ROUNDED IN ACCORDANCE WITH STANDARD SHEET B-5
 PAY LIMITS OF SAND BORROW WHEN USED IN CONJUNCTION WITH UNDERDRAIN- SEE STANDARD SHEET D-2.

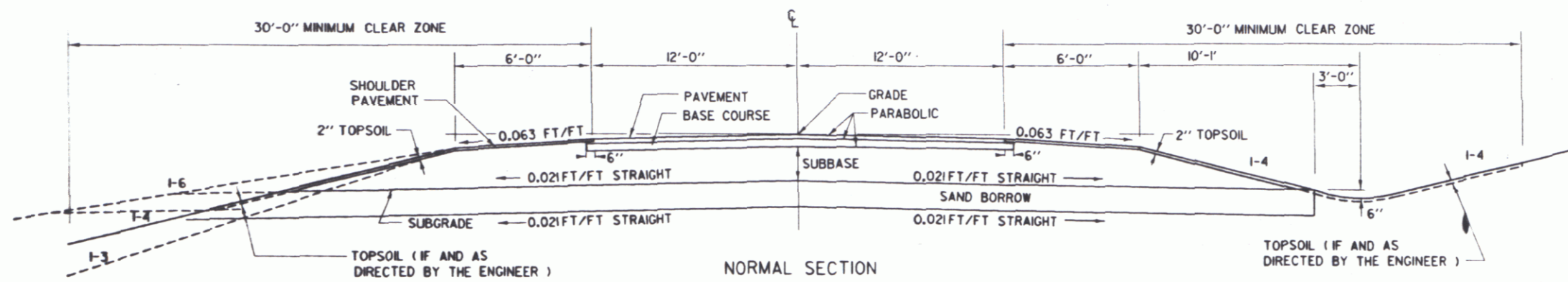

NORMAL SECTION

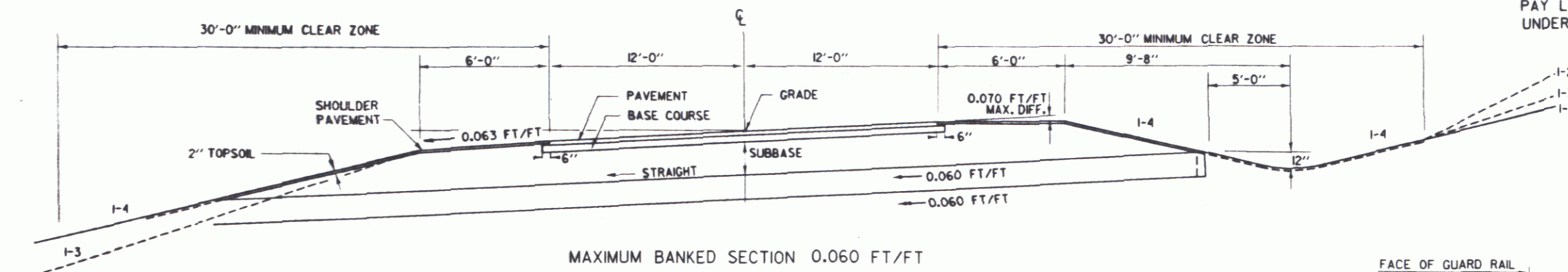

MAXIMUM BANKED SECTION 0.060 FT/FT

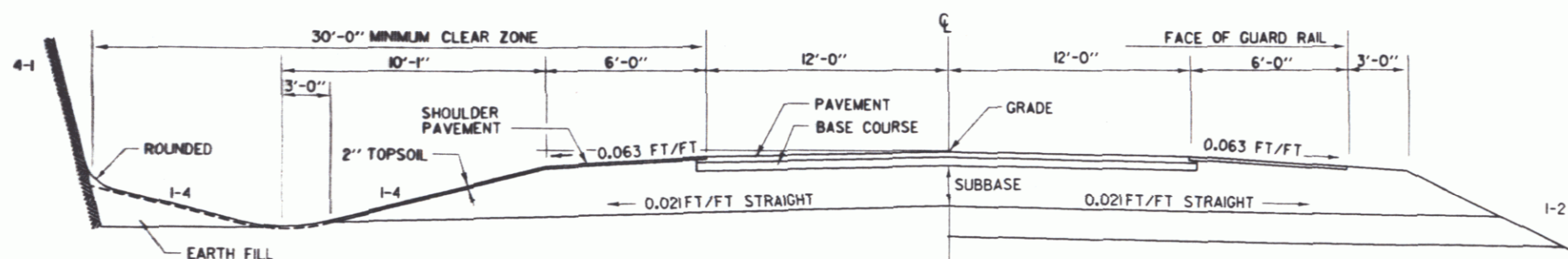

NORMAL SECTION IN ROCK CUT

NORMAL SECTION WITH GUARD RAIL

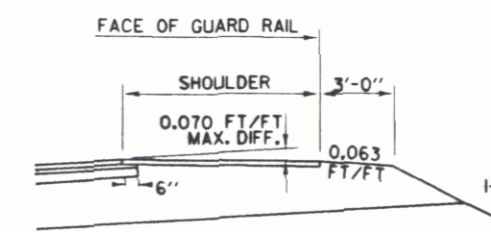

DETAIL OF GUARD RAIL ON HIGH SIDE OF BANKED SECTION

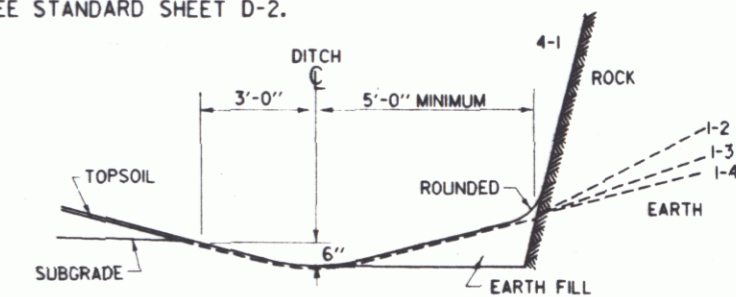

DETAILS OF DITCH AND BACKSLOPE FOR LOW SIDE OF BANK < 0.042 FT/FT

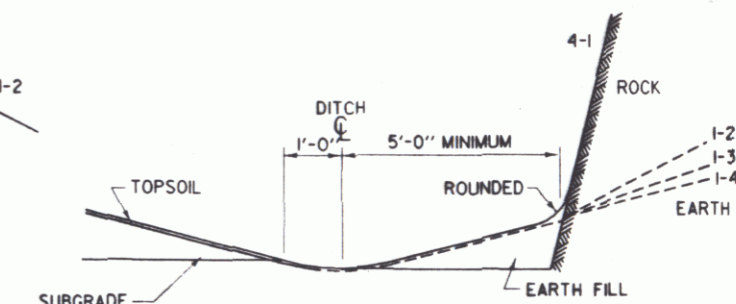

DETAILS OF DITCH AND BACKSLOPE FOR LOW SIDE OF BANK ≥ 0.042 FT/FT

FOR SLOPES IN SOLID ROCK EXCAVATION AND DRILLING AND BLASTING OF SOLID ROCK SUBGRADE, SEE STANDARD SHEET A-60.

DATUM
 VERTICAL _____
 HORIZONTAL _____

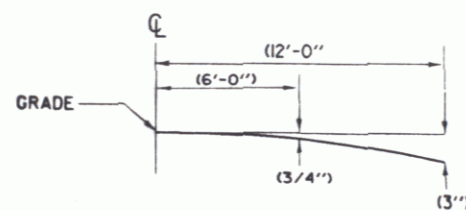

PARABOLIC DETAIL

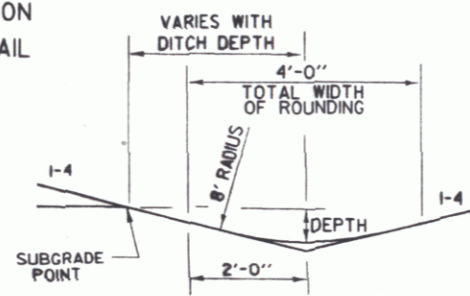

TYPICAL DITCH DETAILS

MAR 18 1996

SURVEYED BY CLARK DATE 3/85
 DRAWN BY MEUNIER DATE 11/30
 SQUAD LEADER HEDGES
 DESIGN FILE NO. ZG0450_67378F196.DGN
 PRF FILE 78F196TYP.PRF DATE PLOTTED 8-JUN-1990

CHARLESTON
 BR 034-3(15)
 R.O.W. SHEET 2 OF 9 SHEETS

TYPICAL SECTIONS

TOWN HIGHWAY # 43

NOTE: TOWN HIGHWAY # 43 IS TO BE PAVED WITH 1 1/4" BITUMINOUS CONCRETE PAVEMENT TYPE III TO THE RADIUS POINT. (OR II+50)

15" SUBBASE OF CRUSHED GRAVEL (FINE GRADED)
 0"-12" GRANULAR BORROW (IN FILLS) } AS INDICATED ON THE PLANS OR
 0"-24" SAND BORROW (IN CUTS) } AS DIRECTED BY THE ENGINEER.

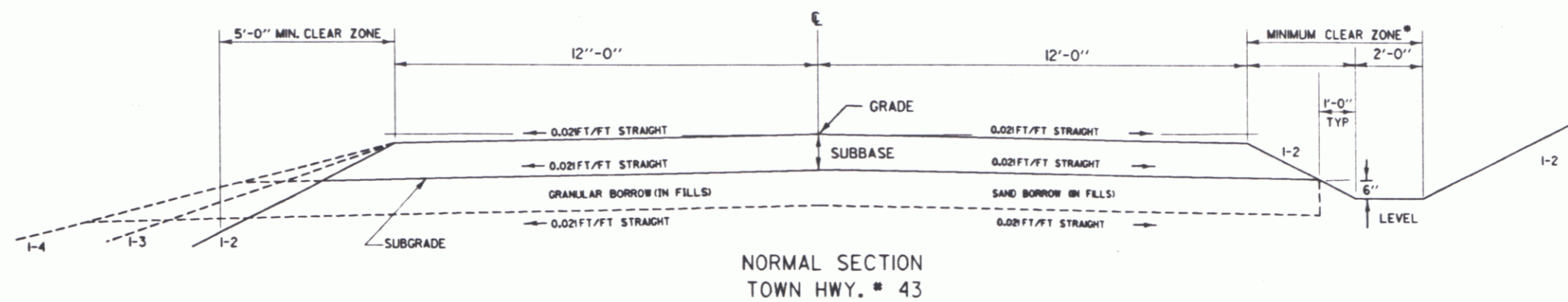

MATERIAL ITEM	THICKNESS TOLERANCE
SUBBASE	±1"
GRANULAR BORROW	±1"
SAND BORROW	±1"

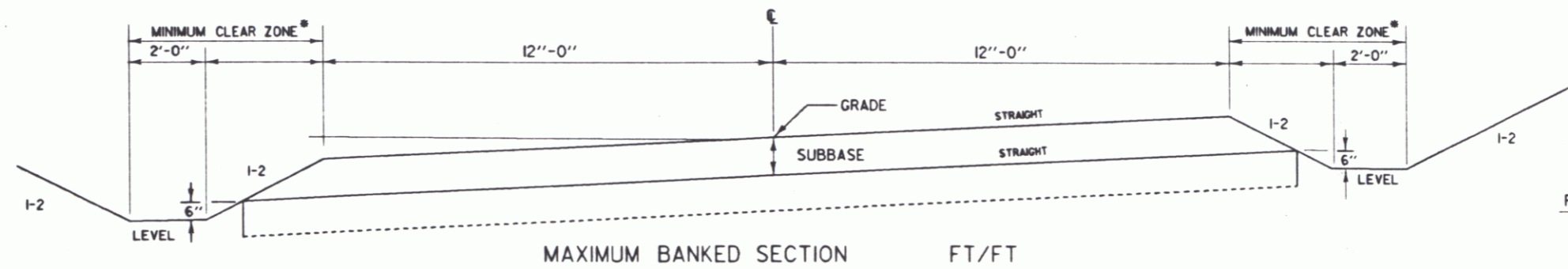

NOTE: 1-1/2 BACKSLOPES MAY BE USED IN CRITICAL AREAS

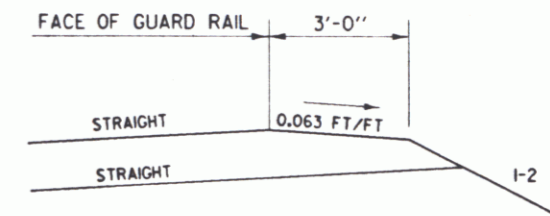

DETAIL OF GUARD RAIL ON HIGH SIDE OF BANKED CURVE

*THE MINIMUM CLEAR ZONE IS MEASURED FROM THE EDGE OF THE TRAVEL WAY TO THE FAR SIDE OF THE 2 FOOT FLAT BOTTOM DITCH.

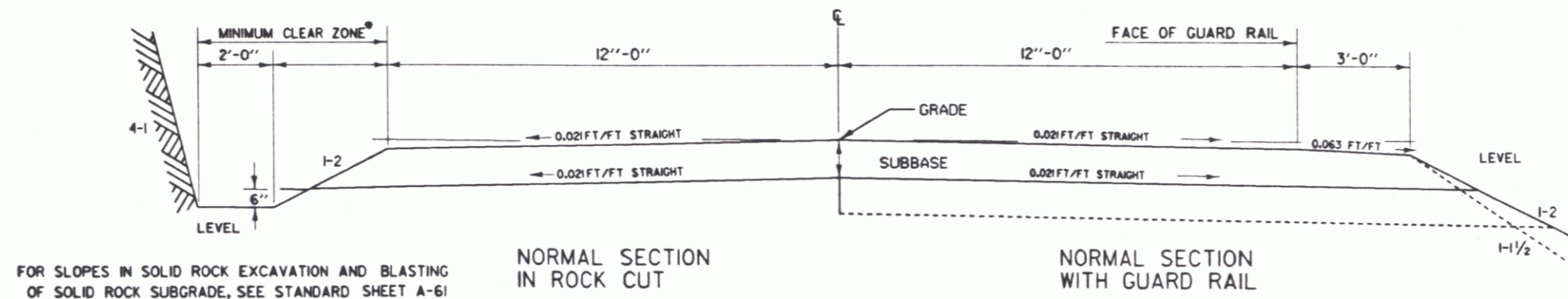

FOR SLOPES IN SOLID ROCK EXCAVATION AND BLASTING OF SOLID ROCK SUBGRADE, SEE STANDARD SHEET A-61

DATUM
 VERTICAL _____
 HORIZONTAL _____

MAR 18 1996

SURVEYED BY _____ DATE _____
 DRAWN BY MEUNIER DATE 12/88
 SQUAD LEADER HEDGES
 DESIGN FILE NO. Z60450.67J78F196.DGN
 PRF FILE 78F196THT.PRF DATE PLOTTED 8-JUN-1990

CHARLESTON
 BRF 034-3(15)
 R.O.W. SHEET 3 OF 9 SHEETS

TIES NOT TO SCALE

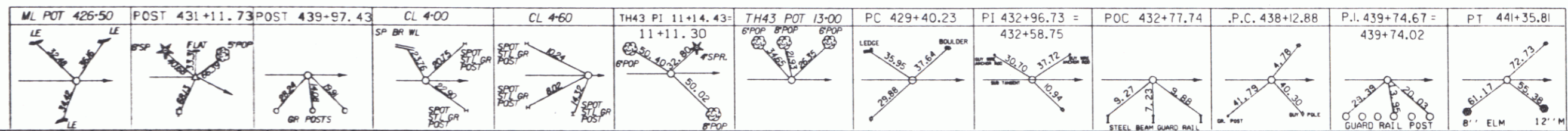

DATUM
 VERTICAL _____
 HORIZONTAL _____

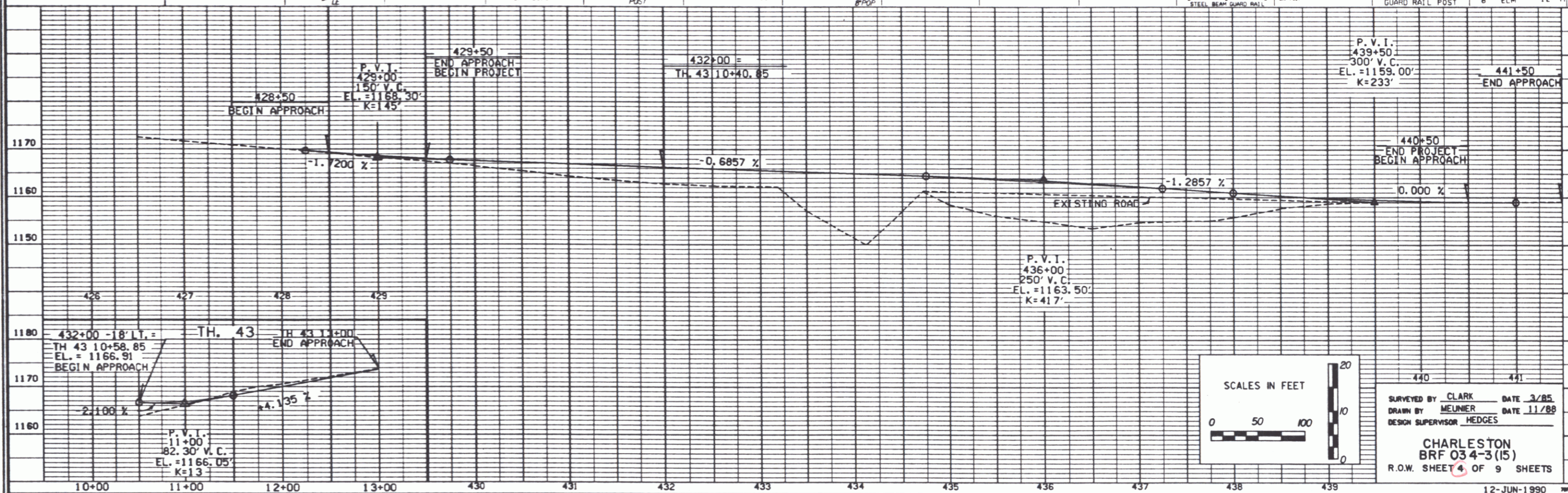

440 441

SURVEYED BY CLARK DATE 3/85
 DRAWN BY MELNER DATE 11/88
 DESIGN SUPERVISOR HEDGES

CHARLESTON
 BR 034-3(15)
 R.O.W. SHEET 4 OF 9 SHEETS

12-JUN-1990

NEW HIGHWAY SECTION - BRIDGE APPROACHES

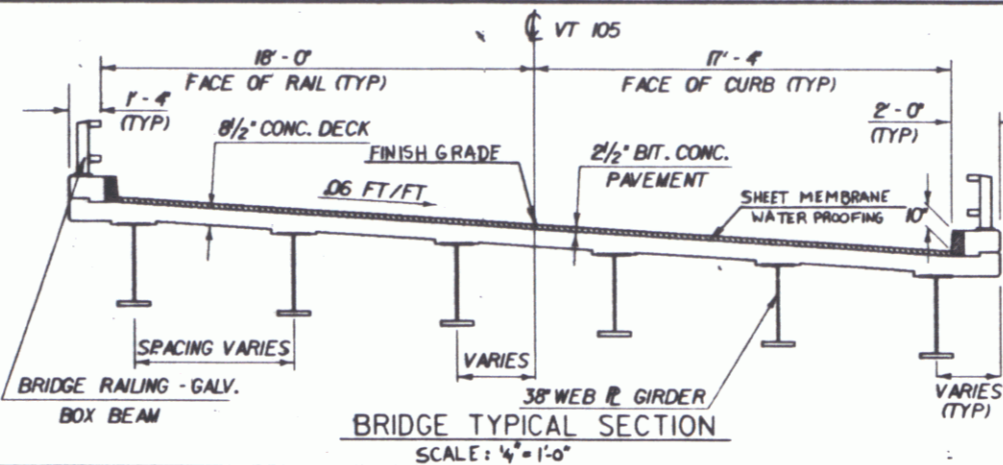

EXISTING STRUCTURE

- STRUCTURE TYPE: 3 SPAN CONCRETE T BEAM OVERALL LENGTH: 106 FT INVENTORY RATING: #5
- SPAN LENGTH (S) CENTER TO CENTER OF BEARINGS: 28-48-21 CLEAR SPAN LENGTH (S) NORMAL TO STREAM: 96 FT
- WATERWAY AREA OF FULL OPENING (NORMAL TO STREAM): VERTICAL CLEARANCE ABOVE STREAMBED:
- WATER SURFACE ELEVATION @ 2.33: WATER SURFACE ELEVATION @ 0
- WATER SURFACE ELEVATION AT FLOOD OF RECORD: YEAR: ESTIMATED DISCHARGE:
- DOES ALL WATER PASS THROUGH EXISTING STRUCTURE? IF NOT, AT WHAT FREQUENCY AND ELEVATION DOES RELIEF OCCUR?
- ADDITIONAL WATERWAY AREA PROVIDED BY RELIEF:
- TYPE OF SUBSTRUCTURE FOUNDATION MATERIAL: REMOVAL OF STRUCTURE
- DISPOSITION OF STRUCTURE:

NEW STRUCTURE

- STRUCTURE GEOMETRY: COMPOSITE PLATE GIRDER OVERALL LENGTH: 104.72 (ALONG HORIZONTAL CURVE)
- SPAN LENGTH (S) CENTER TO CENTER OF BEARINGS: 80.06 FT ALONG MAJOR CHORD
- VERTICAL CLEARANCE ABOVE STREAMBED OR ROAD UNDER: 11 FT
- CLEAR SPAN LENGTH (S) NORMAL TO STREAM: 74 FT
- WATERWAY AREA OF FULL OPENING (NORMAL TO STREAM): NO
- ARE PROVISIONS TO BE MADE FOR PUBLIC UTILITIES?

HYDRAULIC DATA:

1. @ 2.33	800 CFS	WATER ELEVATION	1155.1	VELOCITY	
2. @ 2.33	1500 CFS	WATER ELEVATION	1156.8	VELOCITY	
3. @ 2.33	2000 CFS	WATER ELEVATION	1157.9	VELOCITY	
4. @ 2.33	2650 CFS	WATER ELEVATION	1158.8	VELOCITY	4.9 FPS
5. @ 2.33	3200 CFS	WATER ELEVATION	1159.6	VELOCITY	

- DRAINAGE AREA: 55.4 SQ. MI. CHARACTER OF TERRAIN:
- ARE THERE OBJECTIONS TO A PIER IN THE STREAM?
- DOES STREAM REACH ITS MAXIMUM HIGH WATER ELEVATION RAPIDLY? IS ORDINARY RISE RAPID?
- NATURE OF NATURAL STREAMBED:
- ESTIMATED SCOUR DEPTH: COMMENT ON DRIFT: ICE
- WILL ALL WATER PASS THROUGH NEW STRUCTURE? NO IF NOT, WHAT FREQUENCY AND ELEVATION WILL RELIEF OCCUR? #35, ELEV 1159
- ADDITIONAL WATERWAY AREA PROVIDED BY RELIEF:
- VERTICAL CLEARANCE ABOVE 0:
- ALLOWABLE WATER SURFACE ELEVATION LIMITED BY:
- IS DESIGN STAGE AFFECTED BY UPSTREAM OR DOWNSTREAM CONDITIONS? IF YES, DESCRIBE:
- AVERAGE DAILY LOW FLOW: 20 CFS DEPTH: 7 FT AVERAGE DAILY HIGH FLOW: 200 CFS DEPTH: 6 FT
- STREAMBANK OR CHANNEL PROTECTION REQUIRED: STONE FILL, TYPE III
- DISTANCE TO EXISTING UPSTREAM STRUCTURE: SPAN: WATERWAY AREA OF FULL OPENING: 0
- DISTANCE TO EXISTING DOWNSTREAM STRUCTURE: SPAN: WATERWAY AREA OF FULL OPENING: 0

- ALLOWABLE STRESSES:
- DESIGN LIVE LOAD: HS 25-44
 - ALLOWABLE LOAD FOR SPREAD FOOTINGS ON SOIL: N/A ON LEDGE: N/A
 - ALLOWABLE LOAD FOR FILLING: TYPE: ESTIMATED LENGTH:
 - ALLOWABLE STRESS FOR STRUCTURAL STEEL AASHTO M 222: 24 KSI TENSION: 21,000 PSI
 - ALLOWABLE STRESS FOR REINFORCING STEEL GRADE 60: 24 KSI TENSION: 20 KSI
 - ALLOWABLE STRESS FOR CONCRETE CLASS A: 3,500 PSI CLASS B: 3,500 PSI COMPRESSION: 1,400 PSI
- TRAFFIC MAINTENANCE:
- IS TRAFFIC TO BE MAINTAINED? YES IF YES, ON EXISTING STRUCTURE: NO OR ON TEMPORARY BRIDGE: YES
 - TEMPORARY BRIDGE REQUIREMENTS: MINIMUM CLEAR SPAN: 60 FT MINIMUM CLEAR HEIGHT: 15 FT LOWER THAN ELEV. 1157.0 MINIMUM WATERWAY AREA: ARE SIDEWALKS REQUIRED? NO

MUST SPAN THE NATURAL CHANNEL A MINIMUM OF 60 FT PERPENDICULAR TO THE STREAM FLOW. THE BEAMS CAN BE NO LOWER THAN ELEVATION 1157.0

LOAD RATING (TONS)

STRESS LEVELS	TRUCK				
	H	HS	20K	18 KILLER	SA, STR. I.A., STR. I.S.A., SEM
INVENTORY					
D. 95 P ₁₀					
POSTED					
D. 67 P ₁₀					
OPERATING					
D. 75 P ₁₀					

RECOMMENDED FOR APPROVAL: STRUCTURES ENGINEER DATE

RECOMMENDED FOR APPROVAL: CHIEF OF DESIGN DATE

APPROVED BY: CHIEF ENGINEER DATE

REVISIONS

NO.	DESCRIPTION	BY & DATE

STATE OF VERMONT AGENCY OF TRANSPORTATION

Town Of: CHARLESTON Bridge No.: 81

Highway No.: VT 105 Log Sta.: 434+04

Surv. Sta.: 434+00

VT 105 OVER THE CLYDE RIVER

PRELIMINARY INFORMATION

Designed By: C. MEUNIER Drawn By: R. WHITCOMB

CHARLESTON BRF 034-3(15)

R.O.W. SHEET 5 OF 9 SHEETS

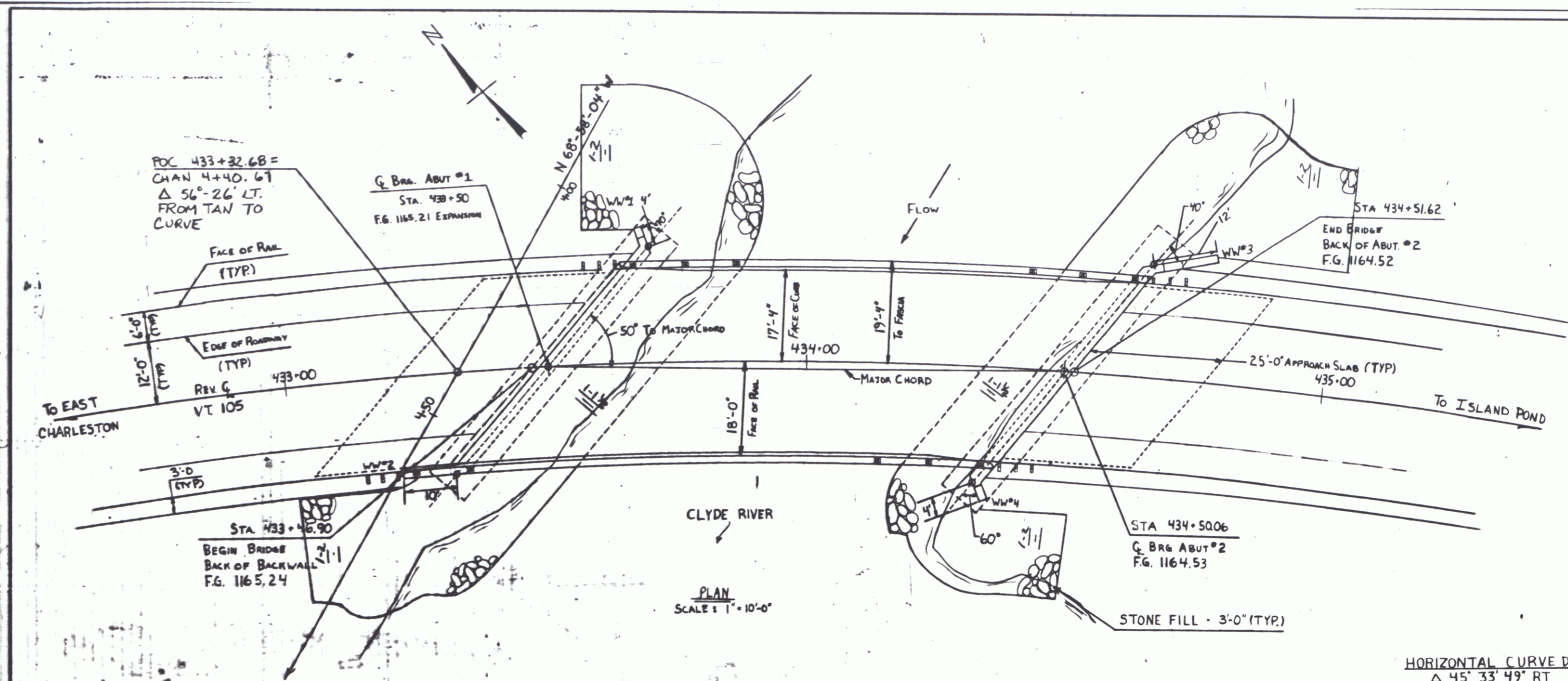

PLAN
SCALE: 1" = 10'-0"

HORIZONTAL CURVE DATA
 Δ 45° 33' 49" RT
 D 6° 45' 00"
 R 848.83'
 T 356.50'
 L 675.02'
 E 71.82'
 BANK 0.060 ft/ft

VERTICAL CURVE DATA
 PVI - STA 436+00
 EL - 1163.50'
 LVC - 250'
 G₁ - -0.6857%
 G₂ - -1.2857%

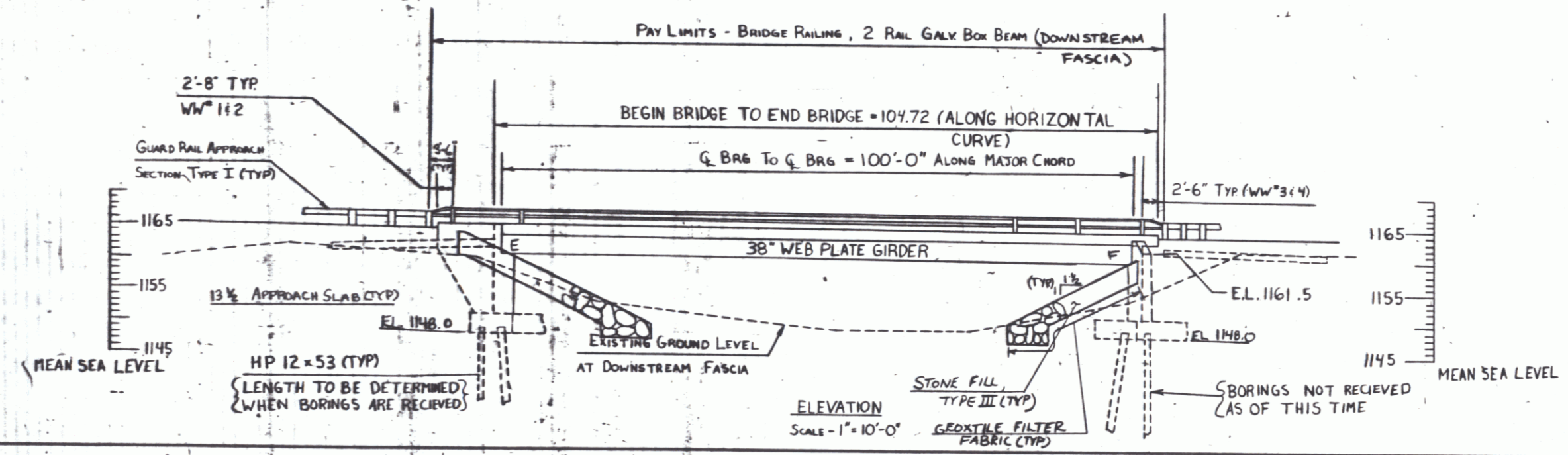

ELEVATION
SCALE: 1" = 10'-0"

STATE OF VERMONT	
AGENCY OF TRANSPORTATION	
Town Of	CHARLESTON
Highway No.	VT 105
VT 105 OVER THE CLYDE RIVER	
PLAN AND ELEVATION	
Designed By	C. MEUNIER
Drawn By	WILLIS/LYONS
CHARLESTON BRF 034-3(15) R.O.W. SHEET 6 OF 9 SHEETS	

MAR 18 1996

6

TABLE OF PROJECT PROPERTY ACQUISITION

STATE OF VERMONT
AGENCY OF TRANSPORTATION
RIGHT OF WAY PLANS
DETAIL SHEET

PARCEL NO.	GRANTOR	SHEET NO.	BEGINNING STATION	ENDING STATION	TAKING	REM.	RIGHTS	TITLE TAKEN	DATE	TOWN OR CITY RECORDED	BK.	PG.	REMARKS	REVISION NO.	SHEET	DESCRIPTION OF REVISION	DATE	MADE BY	APPROVED BY	
1A	CHEPULIS, EDWARD W. JR. & MARGIE M.	9	431+25 RT. 429+79 RT. 429+96 RT. 431+10 RT. 433+00 RT.	433+72 RT. 433+15 RT. 433+00 RT. 433+35 RT.	0.07A±		CONST. (T) 0.07A± SLOPE (T) 0.09A± CUL. & DR. (P) CHANNEL (P) 0.01A±	WD	05-21-93	CHARLESTON	45	112	2880 S.F. ± 2900 S.F. ± 352 S.F. ±	1	7, 8, 9	PARCEL NO. 1 CHEPULIS, PARCEL NO. 2 THOMAS PARCEL NO. 3 TENDLER, PARCEL NO. 7 TOWN OF CHARLESTON. REVISE PROPERTY LINE FROM 426+50 ~ 432+58 FROM CENTER OF EXISTING RTE 105 TO CENTER OF FORMER STATUTORY R.O.W. THAT EXISTED ON 1938 PLANS. PER C.O. 8228.	06-26-92	C. C. P.	L. W. B.	
1B		9	426+50 CL.	433+96 RT.	0.42A±		ALL R.T. & I.						VT RTE. 105	2	7, 9	PARCEL NO. 3 TENDLER. FOR EASEMENT (T) FOR DETOUR, CHANGE AREA FROM 0.31A± TO 0.07A±, AND CHANGE ENDING STATION FROM 437+50 LT. TO 436+50 LT. PER C.O. 8283.	11-05-92	C. C. P.	L. W. B.	
2A	THOMAS, FORRES' W. & MAITE	9	TH 43 11+15 LT. TH 43 11+08 LT. TH 43 11+15 LT.	TH 43 13+00 LT. TH 43 13+00 LT. TH 43 12+60 LT.	0.01A±		CONST. (T) 0.04A± SLOPE (P) 0.02A±	WD	06-17-93	CHARLESTON	45	140	635 S.F. ± 1800 S.F. ± 1035 S.F. ±	3	8, 9	PARCEL NO. 4 STATE OF VERMONT (FISH & GAME DEPT). FOR EASEMENT (T) FOR DETOUR, CHANGE AREA FROM 0.22A± TO 0.11A±, AND CHANGE ENDING STATION FROM 434+75 LT. TO 434+55 LT. PER C.O. 8284.	11-05-92	C. C. P.	L. W. B.	
2B		9	426+50 CL. 426+70 LT. 426+85 LT.	TH 43 11+15 LT. 430+80 LT. 430+50 LT.	1.06A±		ALL R.T. & I. CONST. (T) 0.05A± SLOPE (P) 0.06A±						VT RTE. 105 2000 S.F. ± 2580 S.F. ±	4	8, 9	PARCEL NO. 5 TAFT. REMOVE WILLARD H. & JEAN V. TAFT AS PROPERTY OWNER. PER C.O. 8315. MYLARS TO DESIGN 06-03-93	01-21-93	M. J. R.	L. W. B.	
3A	TENDLER, BEREK & CHAN	9	432+10 LT.	433+20 LT.	0.13A±			WD	08-10-93	CHARLESTON	45	213								
3B		9	434+22 LT. 434+42 LT. 434+69 LT. 434+90 LT. 437+42 LT.	441+50 LT. 436+50 LT. 434+90 LT. 437+70 LT. 438+30 LT.	0.49A±		EASE (T) 0.07A± CHANNEL (P) 0.01A± SLOPE (T) 0.11A± CONST. (T) 0.01A±						TEMPORARY DETOUR 3135 S.F. ± 100 S.F. ± 465 S.F. ±							
3C		9	431+91 LT.	432+70 LT.	0.04A±		ALL R. T. & I.						VT RTE. 105 1620 S.F. ±							
3D		9	434+17 RT.	441+50 CL.	0.46A±		ALL R. T. & I.						VT RTE. 105							

03-3184 1805 78F196

ACCT.prac
/usr/zsfar/070070.dfr/78f196.dgn
DATE PLOTTED 20-JAN-99
78F196.dtl

DR. (P)- DRAINAGE RIGHT
DIT. (P)- DITCHING RIGHT
CH. (P)- CHANNEL RT.
DRIVE (T)- DRIVE RIGHT
CUL. (P)- CULVERT RIGHT
[W]- WATER SOURCES

PRESENT R.O.W.
TAKING WITHOUT ACCESS
TAKING WITHOUT ACCESS ALONG PROPERTY LINE
TAKING WITH ACCESS
PERMANENT EASEMENT
TEMPORARY EASEMENT

LEGEND . . . CZ (P) CLEAR ZONE
--- CONST. (T) --- CONSTRUCTION EASEMENT
SR SR SLOPE RIGHTS
P PROPERTY LINE
△ L △ △ △ TOP OF CUT
○ ○ ○ TOE OF SLOPE

REVISED 01-21-93

R. O. W. PLANS

APPROVED: LAWRENCE BLISS, L.S. DATE: 08-03-90
AGENT D. PLANS & TITLES

CHARLESTON
BRF 034-3(15)
SHEET 7 OF 9

TABLE OF PROJECT PROPERTY ACQUISITION

STATE OF VERMONT
AGENCY OF TRANSPORTATION
RIGHT OF WAY PLANS
DETAIL SHEET

PARCEL NO.	GRANTOR	SHEET NO.	BEGINNING STATION	ENDING STATION	TAKING	REM.	RIGHTS	TITLE TAKEN	DATE	TOWN OR CITY RECORDED	BK.	PG.	REMARKS	REVISION NO.	SHEET	DESCRIPTION OF REVISION	DATE	MADE BY	APPROVED BY	
4a	STATE OF VERMONT (FISH & GAME DEPT.)	9	433+45 LT. 432+70 LT. 433+56 LT. 432+90 LT.	434+33 LT. 433+56 LT. 433+90 LT. 434+55 LT.	0.02A±		SLOPE (T) 0.03A± CHANNEL (P) 0.01A± EASE (T) 0.11A±	EXEC. ORDER					320 S.F. ± 1350 S.F. ± 650 S.F. ± TEMPORARY DETOUR							
4b		9	432+58 LT.	434+22 RT.	0.08A±		ALL R. T. & I.						VT RTE. 105							
5	TAFT, THEODORE H.	9	433+60 RT.	437+24 RT.	0.25A±		ALL R. T. & I.	WD	06-30-94	CHARLESTON	48	241	VT RTE. 105							
6	TAFT, WILLARD H. & JEAN V.	9	437+22 RT. 440+30 RT. 440+40 RT.	441+50 CL. 441+50 RT. 441+27 RT.	0.30A±		ALL R. T. & I. CONST. (T) 0.02A± SLOPE (P) 0.01A±	WD	08-13-93	CHARLESTON	45	234	VT RTE. 105 750 S.F. ± 400 S.F. ±							
7	TOWN OF CHARLESTON	9	431+16 RT. 432+00 LT.	432+25 LT.	0.06A±		ALL R. T. & I. APPROACH (T)	000	05-13-93	CHARLESTON	45	103	VT RTE. 105 1750 S.F. ± TH 43							
8	CITIZENS UTILITY												UTILITY							
9	NEW ENGLAND TELEPHONE CO.												UTILITY							
	MAINTENANCE AGREEMENT AREA #1	9	432+00 LT.	TH 43 11+10 CL.									LENGTH 58'							

03-31-94 1805 78F196

ACCT:prbc
/usr/zfs/070070.dir/78f196a.dwg
DATE PLOTTED 20-JAN-1993
78f196d2.1

DR. (P)- DRAINAGE RIGHT
DIT. (P)- DITCHING RIGHT
CH. (P)- CHANNEL RT.
DRIVE (T)- DRIVE RIGHT
CUL. (P)- CULVERT RIGHT
W- WATER SOURCES

PRESENT R.O.W.
TAKING WITHOUT ACCESS
TAKING WITHOUT ACCESS ALONG PROPERTY LINE
TAKING WITH ACCESS
PERMANENT EASEMENT
TEMPORARY EASEMENT

LEGEND
--- CZ (P) --- CLEAR ZONE
--- CONST. (T) --- CONSTRUCTION EASEMENT
SR SR SLOPE RIGHTS
P L PROPERTY LINE
△ △ TOP OF CUT
○ ○ TOE OF SLOPE

REVISED 01-21-93

R. O. W. PLANS

APPROVED: LAWRENCE BLISS, L.S., DATE: 08-03-90
AGENT D. PLANS & TITLES

CHARLESTON
BRF 034-3(15)
SHEET 8 OF 9

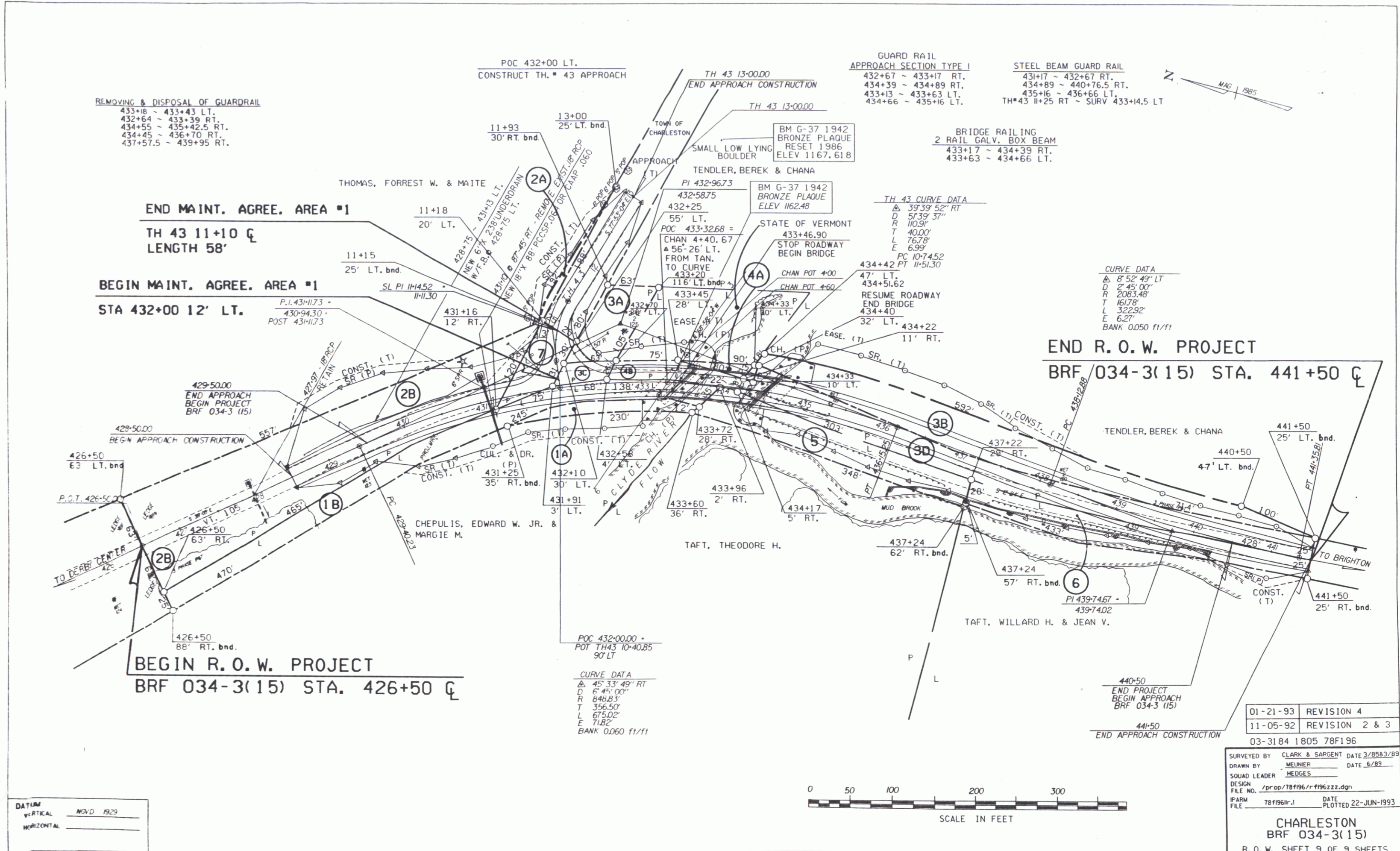

DATUM
 VERTICAL NGVD 1929
 HORIZONTAL _____

01-21-93	REVISION 4
11-05-92	REVISION 2 & 3
03-3184 1805 78F196	

SURVEYED BY CLARK & SARGENT DATE 3/858.3/89
 DRAWN BY MELNIER DATE 5/89
 SQUAD LEADER HEDGES
 DESIGN FILE NO. /prop/78f196/r/196222.dgn
 PARM FILE 78f196r.1 DATE PLOTTED 22-JUN-1993

CHARLESTON
BRF 034-3(15)
 R. O. W. SHEET 9 OF 9 SHEETS

MAR 18 1996

9