

INDEX OF SHEETS

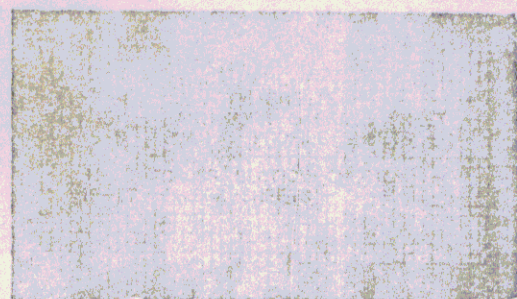

# STATE OF VERMONT AGENCY OF TRANSPORTATION



## PROPOSED IMPROVEMENT TOWN OF CASTLETON COUNTY OF RUTLAND VT. RTE. 4-A [F.A.S.] FAIR HAVEN-RUTLAND RD.

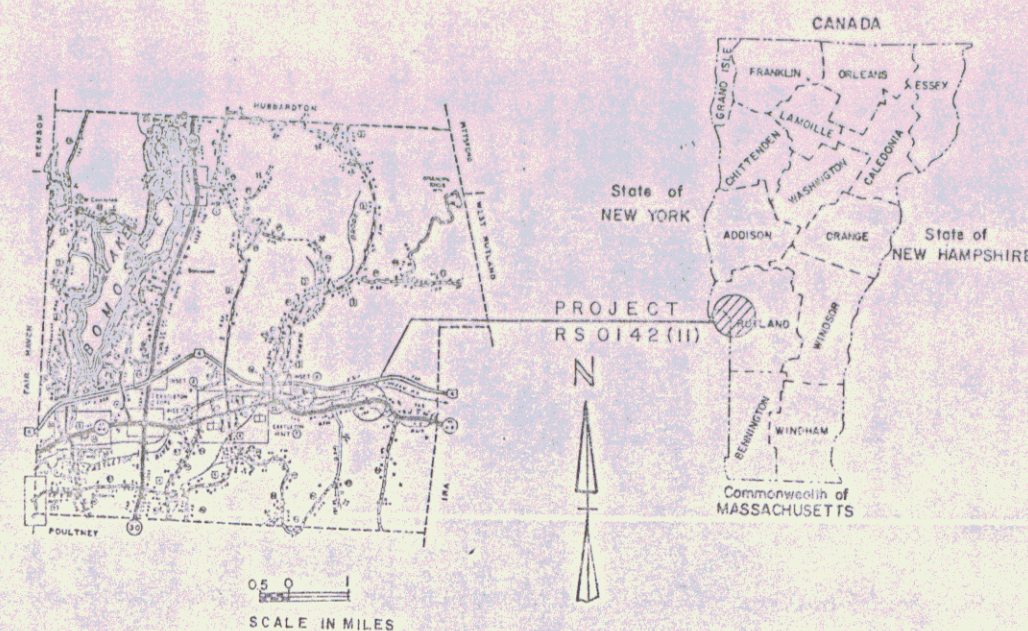

BEGINNING AT A POINT APPROXIMATELY 1.242 MILES WESTERLY OF THE CASTLETON - IRA TOWN LINE AND EXTENDING EASTERLY ALONG VT. ROUTE 4-A FOR A DISTANCE OF 450.00 FEET.

LENGTH OF ROADWAY 387.55 FEET = 0.073 MILES  
LENGTH OF BRIDGE 62.45 FEET = 0.012 MILES  
LENGTH OF PROJECT 450.00 FEET = 0.085 MILES  
LENGTH OF ROW PROJ. 775.00 FEET = 0.147 MILES

WORK TO BE PERFORMED UNDER THIS PROJECT CONSISTS OF REPLACEMENT OF AN EXISTING BRIDGE AS WELL AS RECONSTRUCTION OF THE APPROACHES.

### R.O.W. PLANS

BEGIN R.O.W. PROJECT  
RS 0142(II) STA. 298+75 @

Pin # 78F 194

END R.O.W. PROJECT  
RS 0142(II) STA. 306+50 @

#### CONVENTIONAL SIGNS

- COUNTY LINE
- TOWN LINE
- LIMITS OF ACCESS
- POINT OF ACCESS
- FENCE LINE
- STONE WALL
- TRAVELED WAY
- GUARD RAIL
- RAILROAD
- SURVEY LINE
- CULVERT
- POWER POLE
- TELEPHONE POLE
- TREES
- CONTROL OF ACCESS
- PROPERTY LINE
- ROW TAKING LINE
- SLOPE RIGHTS
- TOP OF CUT
- TOP OF SLOPE

DATUM  
VERTICAL NVD 1989  
HORIZONTAL N/A

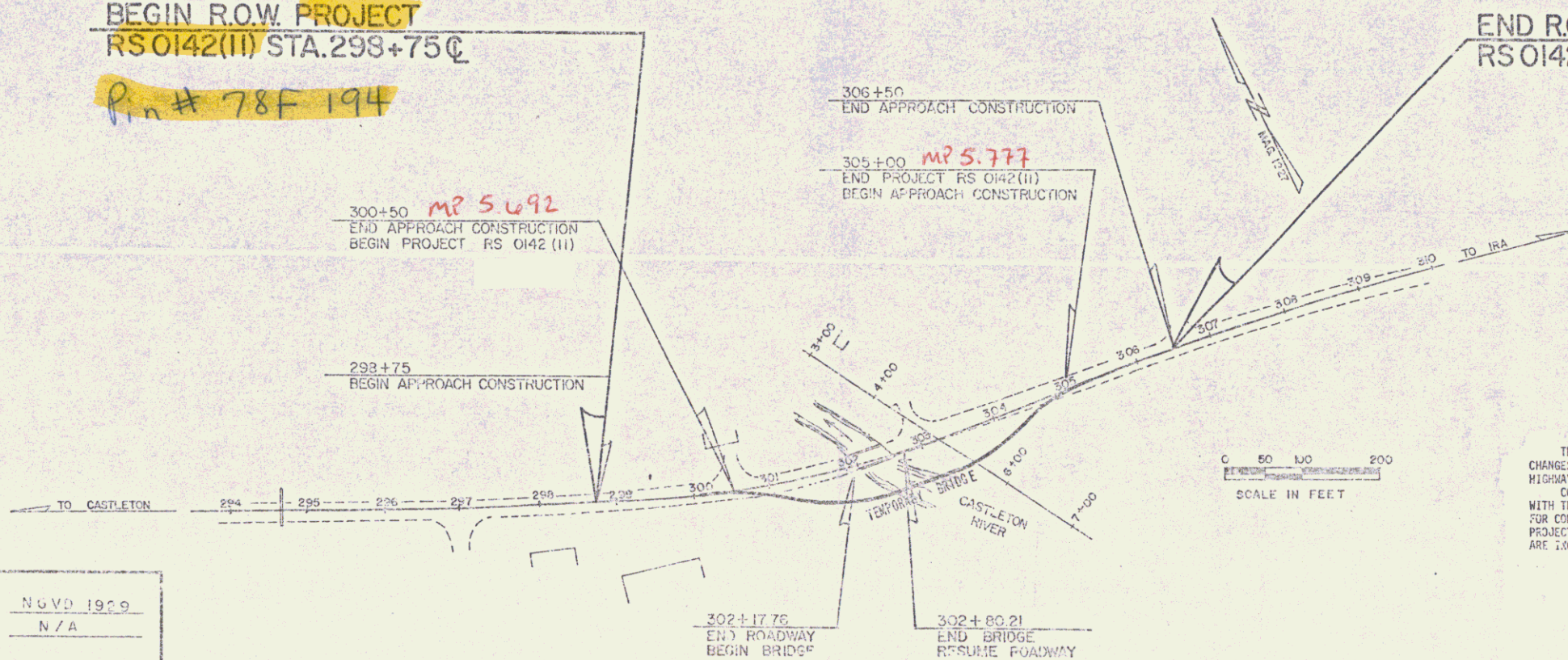

SCALE IN FEET

THESE PLANS ARE SUBJECT TO SUCH ENGINEERING CHANGES AS MAY BE REQUIRED BY THE FEDERAL HIGHWAY ADMINISTRATION OR THE CHIEF ENGINEER. CONSTRUCTION IS TO BE CARRIED ON IN ACCORDANCE WITH THESE PLANS AND THE STANDARD SPECIFICATIONS FOR CONSTRUCTION DATED 1968, FOR USE ON THESE PROJECTS, INCLUDING ALL SUBSEQUENT PROVISIONS AS ARE INCORPORATED IN THESE PLANS.

MAR 20 1989

#### PROJECT PROCESSED UNDER SECONDARY ROAD PLAN

SUBMITTED BY ORDER OF THE STATE TRANSPORTATION BOARD  
APPROVED: *Frank E. Blodgett* DATE 12-17-85  
CHIEF ENGINEER

APPROVED: *W. New* DATE 12-19-85  
CHIEF PROPERTY ADMINISTRATION

CASTLETON  
RS 0142(II)

SHEET 1 OF 9 SHEETS

C-10 SHS 12/17/70

STATE OF VERMONT  
AGENCY OF TRANSPORTATION  
RIGHT-OF-WAY PLANS  
DETAIL SHEET

TABLE OF PROJECT PROPERTY ACQUISITION

PARCEL NO.	GRANTOR	SHEET NO.	BEGINNING STATION	ENDING STATION	TAKING	REM.	RIGHTS	TITLE TAKEN	DATE	TOWN OR CITY RECORDED	BK.	PG.	REMARKS
1A	RUBY, WILLIAM & NORMA	7B	299+68 RT 299+25 RT 299+56 RT	300+20 RT 300+24 RT 300+23 RT	0.01 A±		CONST. EASE. (T) SLOPE (P)	(0.01 A±) (0.04 A±)	W.D.		CASTLETON		(25 SE±) (500 SE±) (1910 SE±)
1B			298+75 E	300+21 LT	0.07 A±		ALL R.T. & I.						(2975 SE±) HWY. EASE. VT. RTE. 4A
				TOTAL	0.08 A±								
2	CODERRE, MARK J.	8	299+94 E 300+23 LT 300+25 LT 300+15 LT 300+75 LT 300+27 LT 300+94 LT±	303+48 LT 302+12 LT 300+75 LT 301+30 LT 302+05 LT 301+00 LT	0.20 A±		ALL R.T. & I. CONST. EASE. (T) DITCH (P) DRIVE (T) SLOPE (P) CHANNEL (P) EASE. TO REMOVE(T)	(0.03 A±)	OPTION 11/3/86		CASTLETON	70	480-81 HWY. EASE. VT. RTE. 4A (1420 SE±)  16" GRAVEL M.P. 0568 (512 SE±)  R.R. TIES (525 SE±)  GUARDRAIL 12" GRAVEL M.P. 0573
			302+25 LT 302+33 LT 302+45 LT 302+88 LT± 303+00 LT	303+44 LT 302+51 LT 302+64 LT			CONST. EASE. (T) CHANNEL (P) SLOPE (P) INSTALL & MAINT. (P) DRIVE (T)	(0.01 A±)  (27 SE±)					
3A	RUBY, LENORE B. ELINE, MARJORIE B. BARNOVW, DOROTHY B.	8,9	300+20 RT 300+20 RT 300+23 RT 300+20 RT 303+14 RT 304+00 RT 304+72 RT	306+50 RT 301+82 RT 300+90 RT 305+00 RT 304+00 RT 306+10 RT 306+50 RT	0.16 A±		SLOPE (P) CONST. EASE. (T) EASE. (T) SLOPE (P) SLOPE (T) CONST. EASE. (T)	(0.03 A±) (0.01 A±) (0.58 A±) (0.02 A±) (0.02 A±) (0.03 A±)	W.D.		CASTLETON		(1525 SE±) (525 SE±) TEMPORARY BRIDGE & DETOUR (795 SE±) (1060 SE±) (1435 SE±)
3B		7,8	298+75 E 299+80 LT 298+87 LT	299+94 LT 299+72 LT	0.07 A±		ALL R.T. & I. DRIVE (T) CONST. EASE.(T)	(0.01 A±)					(2975 SE±) HWY. EASE. VT. RTE. 4A 16" GRAVEL M.P. 0567 (500 SE±)
3C		8,9	300+21 LT	306+50 RT	0.36 A±		ALL R.T. & I.						HWY. EASE. VT. RTE. 4A
				TOTAL	0.59 A±								

TABLE OF REVISIONS

REVISION NO.	SHEET NO.	DESCRIPTION OF REVISION	DATE	MADE BY	APPROVED BY
1	5,8	PARCEL NO. 2 CODERRE, TITLE CHANGE FROM - ESTATE TO ,MARK J PER C.O. 6726	4-25-86	DEJM	<i>CAF</i>
2	5,8	PARCEL NO. 2 CODERRE-CORRECTED TOPO., ADDED DITCH, MOVED DRIVE FROM 300+50 TO +15 LT. PER C.O.'S 6761 & 6762	8-4-86	FJM	<i>Sub</i>
3	5	PARCEL NO. 3B RUBY et al: ADDED CE(T) TO DETAIL SHEET, MISSED FROM LAYOUT PER C.O. 6769	8-4-86	FJM	<i>Sub</i>
4	5,8	PARCEL NO. 3A RUBY et al: REDUCED SRIP) & C.E.(T) @ 300+25 RT.± ALSO AREA FOR TEMP. BRIDGE (T) DUE TO DESIGN CHANGE AT NECESSITY HEARING PER C.O. NO. 6634	19-12-86	F.J.M.	<i>Sub</i>
5	5,8	PARCEL NO. 1 RUBY W. & N. ± REDUCED SRIP) & CE(T) @ 300+00 RT. DUE TO DESIGN CHANGE AT NECESSITY HEARING PER C.O. 6635  <i>Mylaes to Design 7/7/87</i>	19-12-86	F.J.M.	<i>Sub</i>

MADE BY: FJM DATE 12-18-85  
CHECKED BY: L.W.B. DATE 12-18-85

DR. RT - DRAINAGE RIGHT  
DIT. RT - DITCHING RIGHT  
CH. RT - CHANNEL RIGHT  
DRIVE RT - DRIVE RIGHT  
CUL. RT - CULVERT RIGHT  
D - DEMOLITION OR REMOVAL  
W - WATER SOURCES

PRESENT R.O.W.  
- - - - - TAKING WITHOUT ACCESS  
- - - - - TAKING WITHOUT ACCESS ALONG PROPERTY LINES  
- - - - - TAKING WITH ACCESS  
(P) PERMANENT EASEMENT  
(T) TEMPORARY EASEMENT

LEGEND  
- - - - - CONST. EASE. - - - - - CONST. EASEMENT  
SR - SR - SLOPE RIGHTS  
P - P - PROPERTY LINE  
- Δ - Δ - Δ - TOP OF CUT  
- O - O - O - TOE OF SLOPE

APPROVED *Lawrence Bl...* DATE 1-9-87  
CHIEF OF PLANS & TITLES

PROJECT CASTLETON  
NO. RS 0142(11)  
SHEET 5 OF 9

MAR 20 1989

STATE OF VERMONT  
AGENCY OF TRANSPORTATION  
RIGHT-OF-WAY PLANS  
DETAIL SHEET

TABLE OF PROJECT PROPERTY ACQUISITION

PARCEL NO.	GRANTOR	SHEET NO.	BEGINNING STATION	ENDING STATION	TAKING	REM.	RIGHTS	TITLE TAKEN	DATE	TOWN OR CITY RECORDED	BK.	PG.	REMARKS
4	RUBY, WILLIAM & NORMA	8,9	303 + 48 LT 303 + 30 LT 303 + 47 LT 304 + 57 LT 304 + 12 LT	306 + 50 LT 306 + 50 LT 304 + 04 LT 305 + 85 LT	0.17 A±		ALL R.T. & L. CONST. EASE. (T) (0.06 A±) SLOPE (T) (116 S.E.) SLOPE (T) (0.01 A±) DRIVE (T)	W.D.		CASTLETON			HWY. EASE. VT. RTE. 4A (2415 SF ±)  (455 SF ±) 16' GRAVEL W.P. 0573
5	CENTRAL VERMONT PUBLIC SERVICE CORP.												UTILITY
6	NEW ENGLAND TELEPHONE CO.												UTILITY

TABLE OF REVISIONS

REVISION NO.	SHEET NO.	DESCRIPTION OF REVISION	DATE	MADE BY	APPROVED BY

MAR 20 1989

MADE BY: E.J.H. DATE 12-18-85  
 CHECKED BY: L.W.B. DATE 12-18-85

DR. RT. — DRAINAGE RIGHT  
 DIT. RT. — DITCHING RIGHT  
 CH. RT. — CHANNEL RIGHT  
 DRIVE RT. — DRIVE RIGHT  
 CUL. RT. — CULVERT RIGHT  
 (D) — DEMOLITION CR.  
 REHABIL.  
 (W) — WATER SOURCES

PRESENT R.O.W.  
 ————  
 - - - - - TAKING WITHOUT ACCESS  
 - - - - - TAKING WITHOUT ACCESS ALONG PROPERTY LINES  
 - - - - - TAKING WITH ACCESS  
 (P) — PERMANENT EASEMENT  
 (T) — TEMPORARY EASEMENT

LEGEND  
 - - - - - CONST. EASE. ———— CONST. EASEMENT  
 - - - - - SR — SR — SLOPE RIGHTS  
 - - - - - P — P — PROPERTY LINE  
 - - - - - Δ — Δ — TOE OF CUT  
 - - - - - O — O — TOE OF SLOPE

APPROVED [Signature] DATE 1-7-86  
 CHIEF OF PLANS & TITLES

PROJECT CASTLETON  
 NO. RS 0142 (II)  
 SHEET 6 OF 9



**CONSTRUCT DRIVES**  
 299+80 LT (16' GRAVEL)  
 300+15 LT (16' GRAVEL)  
 303+00 LT (12' GRAVEL)  
 304+12 LT (16' GRAVEL)

**EROSION MATTING**  
 299+75 ~ 302+25 FT.

**45' CONCRETE GIRDER TEE-BEAM**  
**21 ROADWAY**  
**AVERAGE CLEARANCE 6'-0"**

**GUARDRAIL, STD. ST. BEAM**  
**w/WOOD POSTS, TYPE II**  
 301+04 ~ 301+54 LT  
 301+05 ~ 301+80 RT  
 302+81 ~ 302+88 LT  
 303+44 ~ 303+94 RT

**GUARDRAIL APPROACH SECTION,**  
**TYPE I**  
 301+54 ~ 302+04 LT  
 301+80 ~ 302+30 RT  
 302+94 ~ 303+44 RT

**BREAKAWAY CABLE TERMINAL**  
 300+79 ~ 301+04 LT  
 300+80 ~ 301+05 RT  
 303+94 ~ 304+19 RT

**GUARDRAIL APPROACH SECTION,**  
**TYPE II**  
 302+69 ~ 302+81 LT

MAG. 1927  
 N

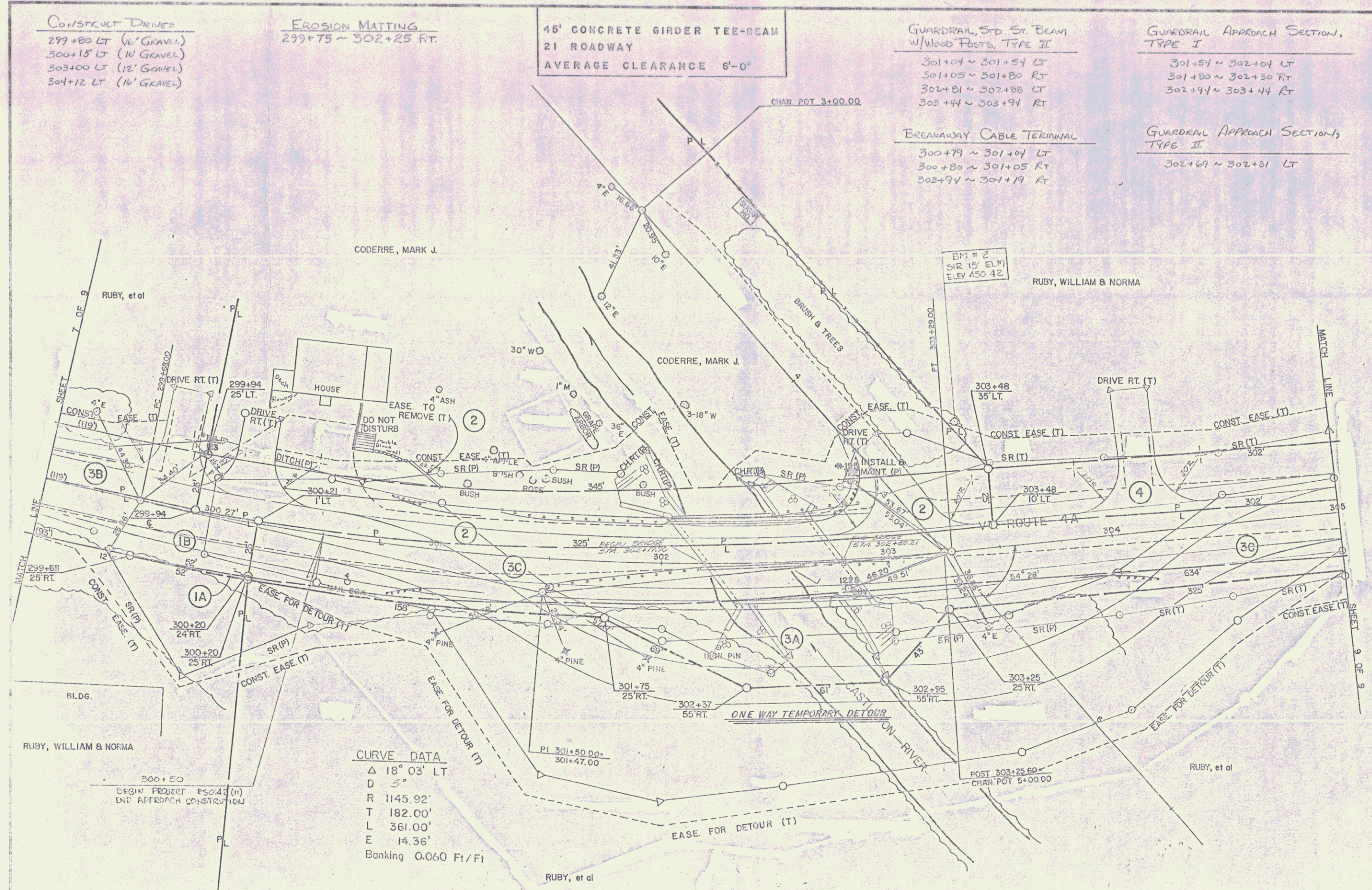

**CURVE DATA**  
 Δ 18° 03' LT  
 D 5°  
 R 1145.92'  
 L 361.00'  
 E 14.36'  
 Banking 0.060 Ft/Ft

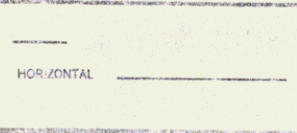

**ROW PLANS**  
 SURVEYED BY: CAUTIONI DATE MAY 81  
 DRAWN BY: H. CASSIDY DATE DEC 81  
 TRACED BY: H. CASSIDY DATE DEC 81  
 CASTLETON  
 RS 0142(11)  
 8 OF 9

MAR 20 1989

