

GUARD RAIL, STANDARD STEEL BEAM
WITH WOOD POSTS, TYPE II
92+50 ~ 101+00 LT.
87+25 ~ 92+74 RT.
93+37.5 ~ 101+00 RT.

REMOVAL AND DISPOSAL
OF EXISTING GUARD RAIL
95+40 ~ 99+45 LT.
95+40 ~ 99+45 RT.

TREATED TIMBER CURB
92+50 ~ 101+00 LT.
BITUMINOUS CONCRETE SURFACE
FOR CUTTERS AND TRAFFIC ISLANDS
101+00 LT.

EXCAVATION OF ROAD SURFACES
AND PAVEMENTS
97+50 ~ 99+50 R.
100+45 ~ 101+10 RT.

CONSTRUCT DRIVES
91+25 LT (11)
93+00 ~ 95+50 RT (20)
101+50 RT (12)
102+00 LT (12)

DRILLING AND BLASTING OF
SOLID ROCK - SUEGRADE
101+00 ~ 102+00

WOOD GUIDE P.S. (10' C.C.)
92+94 ~ 95+44 RT, DRIVE

#1	#2
CURVE DATA	CURVE DATA
Δ 10° 28' 30" LT.	Δ 40° 32' 37" LT.
D 3183.0'	D 4774.65'
R 1800.00'	R 1200.00'
T 165'	T 443.22'
L 329.08'	L 849.14'
E 7.55'	E 79.24'
2T-L 0.92	2T-L 37.30
BANK .053 1/11	BANK .070 1/11

R.R. CURVE DATA
Δ 8° 12' RT
D 17826'
R 3214.17'
T 230.39'
L 46000'
E 6.25'

BEGIN R.O.W. PROJECT
BRS 0158(1) STA. 86+50 C

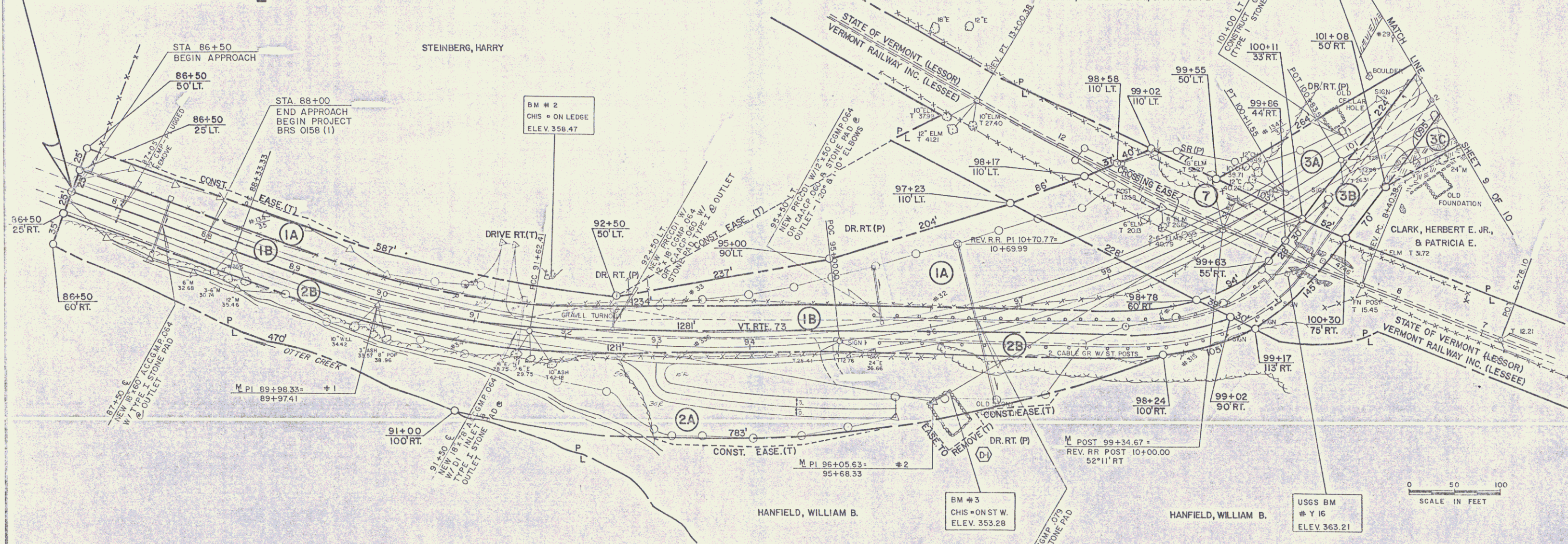

DATUM	NGVD 1929
VERTICAL	N/A
HORIZONTAL	N/A

STONE FILL TYPE II
(FOR SLOPE STABILIZATION)
86+50 ~ 94+00 RT.

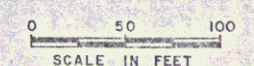

86+50 - 102+00
SURVEYED BY CARLSON DATE 5/80
DRAWN BY _____ DATE _____
TRACED BY _____ DATE _____
BRANDON
BRS 0158(1)
SHEET 8 OF 10