

Guardrail Approach Section Type I
 308+85 Rt - 309+35 Rt.
 310+42 Lt - 310+92 Rt
 310+65.5 Lt - 311+15.5 Lt

Guardrail Approach Section Type II
 309+46 Lt - 309+58.5 Lt
 TH 12

END MAINT. AGREE. AREA #1
 20+42 C LENGTH 30'
BEGIN MAINT. AGREE. AREA #1
 STA. 309+17 12' LT.

EASTMAN, ROBERT N., - LESSOR
 SEVERANCE, WALTER J. &
 SEVERANCE, W. JOHN, - LESSEES

308+50
 END APPROACH CONSTRUCTION
 BEGIN PROJECT BRS 0241(16)

BM No 2
 ON T.H. 12, 14' RT OF
 STA. 22+32.5, S.I.P.
 NET E.T. 4-3/1 G.M.P.
 U.S. ELEV. 529.90

T.H. #12
 REV. CURVE DATA
 $\Delta = 5^{\circ}-00'-00''$ RT.
 NO CURVE RUN

BRIDGE RAILING - 2 RAIL
 GALVANIZED BOX BEAM
 309+58 → 310+66 LT.
 309+34 → 310+42 RT.

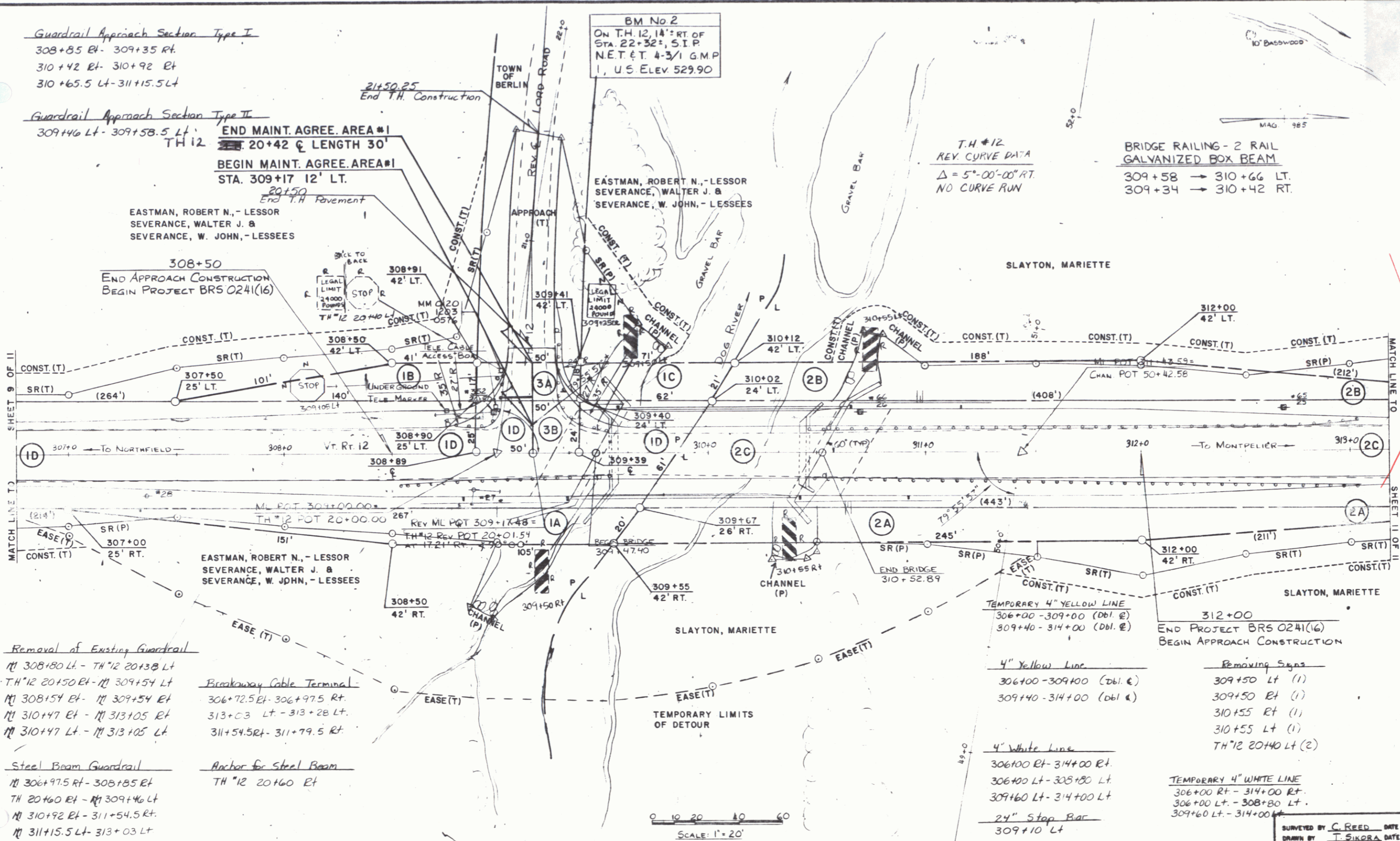

Removal of Existing Guardrail
 M 308+80 Lt - TH 12 20+13 B Lt
 TH 12 20+150 Rt - M 309+154 Lt
 M 308+154 Rt - M 309+154 Rt
 M 310+47 Rt - M 313+105 Rt
 M 310+47 Lt - M 313+105 Lt

Breakaway Cable Terminal
 306+72.5 Rt - 306+97.5 Rt.
 313+03 Lt - 313+28 Lt.
 311+54.5 Rt - 311+79.5 Rt.

Steel Beam Guardrail
 M 306+97.5 Rt - 308+85 Rt
 TH 20+60 Rt - M 309+46 Lt
 M 310+92 Rt - 311+54.5 Rt.
 M 311+15.5 Lt - 313+03 Lt

Anchor for Steel Beam
 TH 12 20+60 Rt

DATUM
 VERTICAL NGVD 1929
 HORIZONTAL N/A

SCALE: 1" = 20'

SIGN LEGEND
 R = REMOVE
 N = NEW

SURVEYED BY C. REED DATE 2/85
 DRAWN BY J. SIKORA DATE 4/85
 TRACED BY P.M. PELKEY DATE 5/85
 BERLIN
 BRS 0241(16)
 R.O.W. SHEET 10 OF 11 SHEETS