

SAND BORROW  
507+00 ~ 507+25

CONSTRUCT SIDEWALK  
RAMP TYPE 2  
509+62 LT

5" PORTLAND CEMENT  
CONCRETE SIDEWALK  
309+62 ~ 311+00 LT

CAST IN PLACE CEMENT  
CONCRETE CURB TYPE B  
309+65 ~ 311+00 LT

CONCRETE DRIVE  
509+80 LT

REPAIR EXISTING PAVEMENT  
310+70 ~ 311+00

PICNIC AREA LEGEND  
□ EXISTING PICNIC TABLE LOCATION  
○ EXISTING PICNIC TABLE TIE DOWN ANCHOR POSTS  
◇ EXISTING HIBRACHIS

GREEN MOUNTAIN POWER CORP

PROPOSED SITE FOR RELOCATION OF  
PICNIC TABLE, TIE DOWN ANCHOR POST  
AND HIBRACH (EXACT LOCATION TO BE  
DETERMINED BY THE ENGINEER IN FIELD)

EXISTING PICNIC TABLE TIE DOWN  
ANCHOR POST AND HIBRACH TO BE  
RELOCATED

NOTE: PICNIC TABLE RELOCATED  
SITE SHALL BE LEVELLED AND  
HAVE CRUSHED STONE BASE  
INSTALLED. CRUSHED STONE  
SHALL BE THE SAME OR SIM-  
ILAR TO THAT USED ON EXIST-  
ING SITES AS APPROVED BY THE  
ENGINEER.  
PAYMENT FOR RE-  
LOCATION TABLE, HIBRACH,  
TIE DOWN ANCHOR AND SITE  
PREPARATION SHALL BE  
CONSIDERED SUBSIDIARY  
TO ALL OTHER CONTRACT  
ITEMS.

MAG 1982

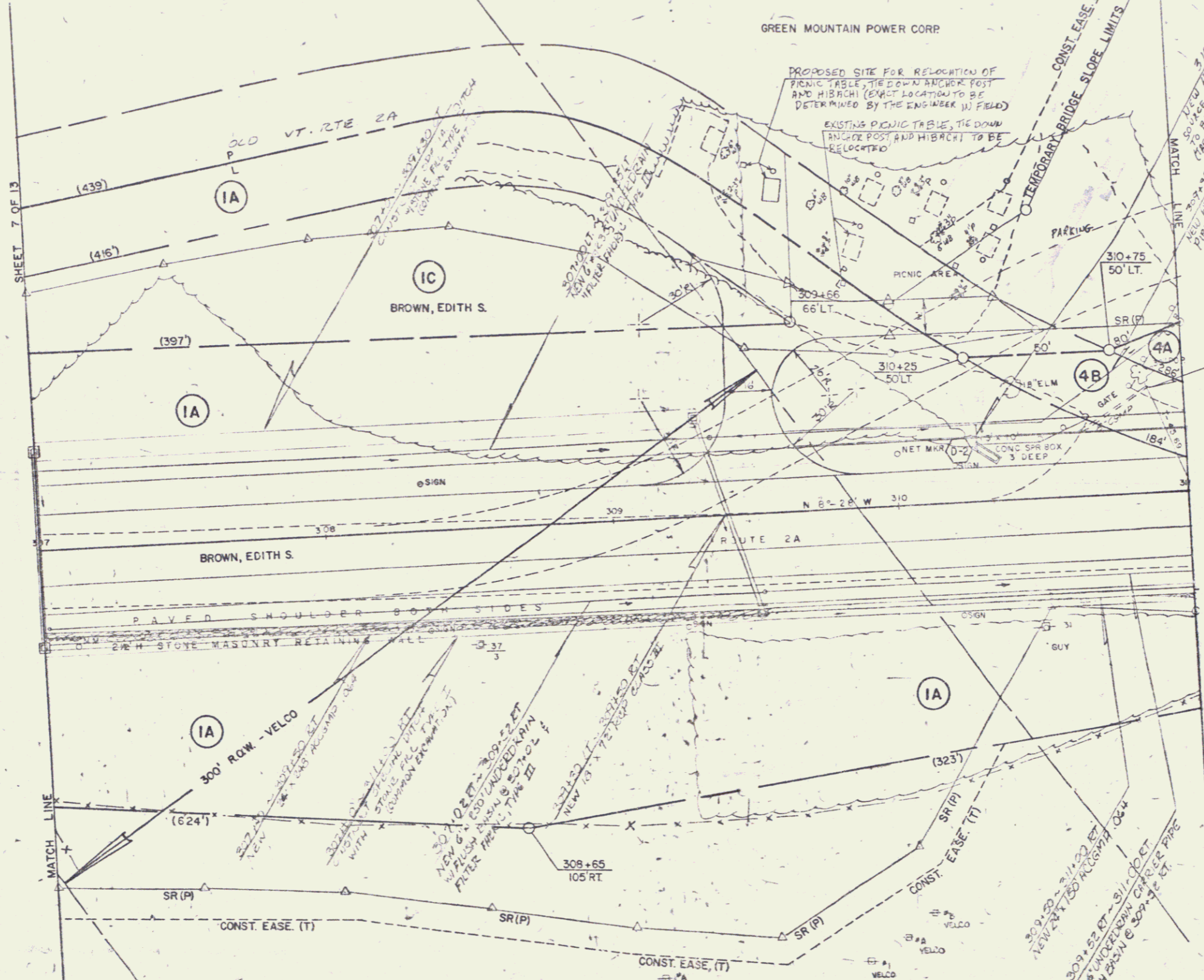

DATUM  
VERTICAL NGVD 1929  
HORIZONTAL N/A

SCALE IN FEET  
0 10 20 40

307+00 ~ 311+00  
SURVEYED BY BRADY DATE 2-82  
DRAWN BY SECELL DATE 3-82  
TRACKED BY GLEASON DATE 3-82

WILLISTON - ESSEX  
M-EGC-BRM 5300 (6)  
8 OF 13

3