

STATE OF VERMONT  
AGENCY OF TRANSPORTATION



PROPOSED IMPROVEMENT  
TOWNS OF WATERBURY-DUXBURY-MORETOWN  
COUNTY OF WASHINGTON  
U.S. ROUTE 2

BEGINNING AT A POINT ON U.S. ROUTE 2 (MAIN ST.), IN THE VILLAGE OF WATERBURY, WHICH IS LOCATED APPROXIMATELY .089 MILES NORTHERLY OF THE WATERBURY-DUXBURY TOWN LINE AND EXTENDING EASTERLY AND SOUTHERLY FOR APPROXIMATELY 0.217 MILES, ENDING AT A POINT ON EXISTING U.S. ROUTE 2 IN THE TOWN OF MORETOWN.

WORK TO BE PERFORMED UNDER THIS PROJECT INCLUDES REMOVAL AND REPLACEMENT OF THE EXISTING BRIDGE, AS WELL AS GRADING, DRAINAGE, SUBBASE AND PAVEMENT OF ROADWAY APPROACH SECTIONS.

LENGTH OF ROADWAY 1109.78 FT. 0.210 MILES  
LENGTH OF BRIDGE 278.05 FT. 0.063 MILES  
LENGTH OF PROJECT 1387.83 FT. 0.263 MILES  
LENGTH OF R.O.W. PROJ. 1536.83 FT. 0.291 MILES

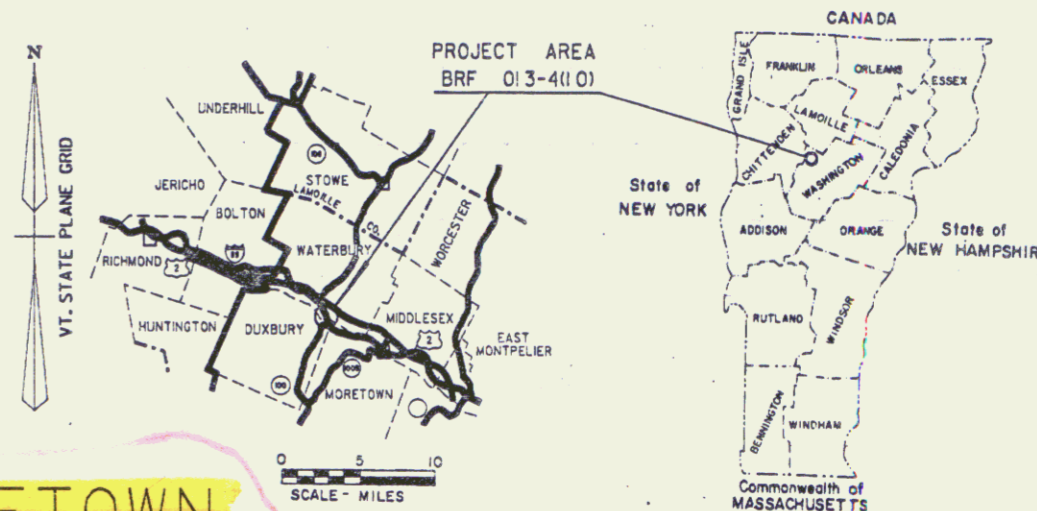

R.O.W. PLANS

RIGHT-OF-WAY DIVISION  
TOWN FILE  
TOWNS OF  
Waterbury, Duxbury, MORETOWN  
(To be Returned To R.O.W. Division)

END R.O.W. PROJECT  
BRF 013-4(10) STA. 25+35 25' LT.

BEGIN R.O.W. PROJECT  
BRF 013-4(10) STA. 9+86 33' LT.

- CONVENTIONAL SIGNS
- COUNTY LINE
  - TOWN LINE
  - LIMITS OF ACCESS
  - POINT OF ACCESS
  - FENCE LINE
  - STONE WALL
  - TRAVELED WAY
  - GUARD RAIL
  - RAILROAD
  - SURVEY LINE
  - CULVERT
  - POWER POLE
  - TELEPHONE POLE
  - TREES
  - CONTROL OF ACCESS
  - PROPERTY LINE
  - R.O.W. TAKING LINE
  - SLOPE RIGHTS
  - TOP OF CUT
  - TOE OF SLOPE

DATUM  
VERTICAL NGVD 1929  
HORIZONTAL N/A

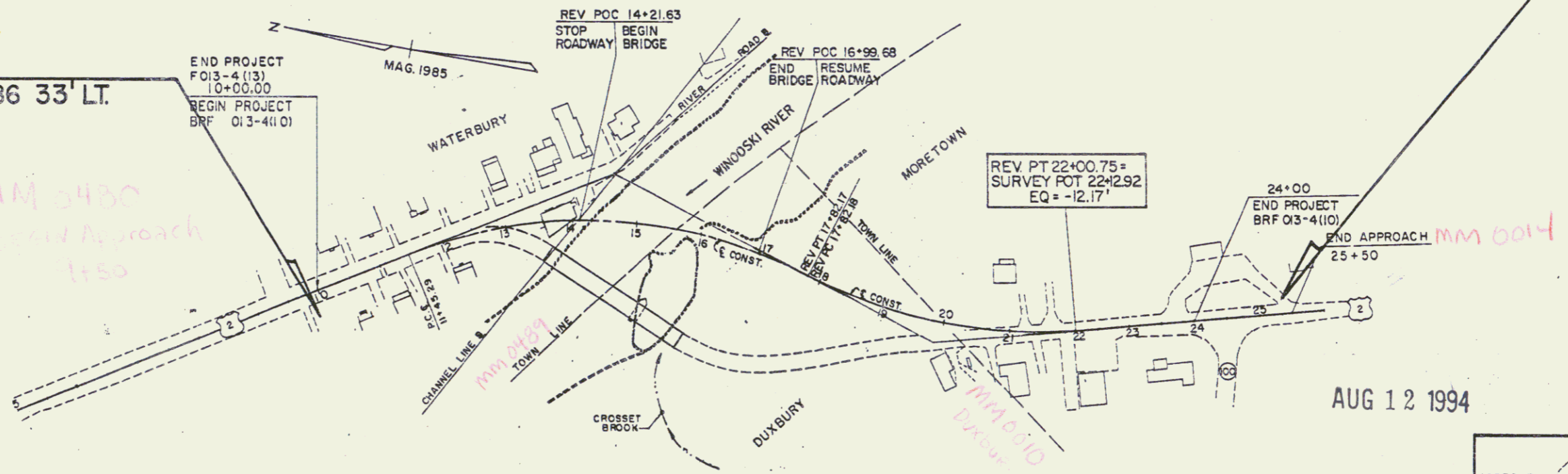
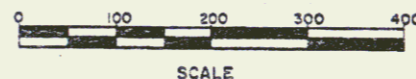

THESE PLANS ARE SUBJECT TO SUCH ENGINEERING CHANGES AS MAY BE REQUIRED BY THE FEDERAL HIGHWAY ADMINISTRATION OR THE SECRETARY OF TRANSPORTATION CONSTRUCTION IS TO BE CARRIED ON IN ACCORDANCE WITH THESE PLANS AND THE STANDARD SPECIFICATIONS FOR CONSTRUCTION DATED 1986, AS APPROVED BY THE FEDERAL HIGHWAY ADMINISTRATION ON NOVEMBER 21, 1985 FOR USE ON THIS PROJECT INCLUDING ALL SUBSEQUENT REVISIONS AND SUCH REVISED SPECIFICATIONS AND SPECIAL PROVISIONS AS ARE INCORPORATED IN THESE PLANS.

AUG 12 1994

APPROVED: *[Signature]* DATE: *12/12/89*  
Director of Planning

APPROVED: \_\_\_\_\_ DATE: \_\_\_\_\_  
Chief, Property Administration

WATERBURY-DUXBURY-MORETOWN  
BRF 013-4(10)  
R.O.W. SHEET 1 OF 13

BRW/MSG 04/13/89/02