

INDEX OF SHEETS

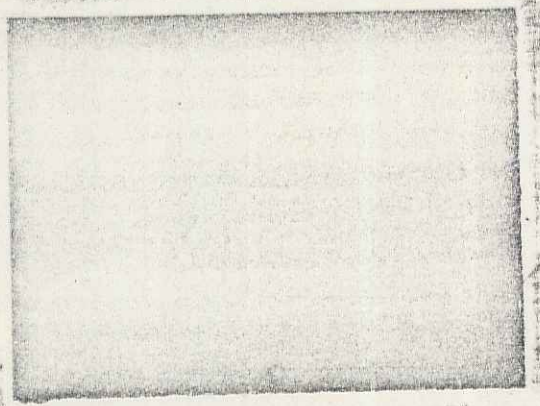

# STATE OF VERMONT AGENCY OF TRANSPORTATION



## PROPOSED IMPROVEMENT TOWN OF ROCHESTER COUNTY OF WINDSOR VT. ROUTE 100

BEGINNING AT A POINT 1.267 MILES SOUTH OF THE ROCHESTER-HANCOCK TOWN LINE AND EXTENDING NORTHERLY 0.189 MILES.  
LENGTH OF ROADWAY 898.00 FEET = 0.170 MILES  
LENGTH OF BRIDGE 102.00 FEET = 0.019 MILES  
LENGTH OF PROJECT 1000.00 FEET = 0.189 MILES  
TRAFFIC DATA  
1982 ADT = 2140 2002 ADT = 2930  
1982 DHV = 300 2002 DHV = 425  
D = 5.1% T = 9% V = 50 MPH  
LENGTH OF ROW PROJECT 1217 FEET = 0.230 MILES

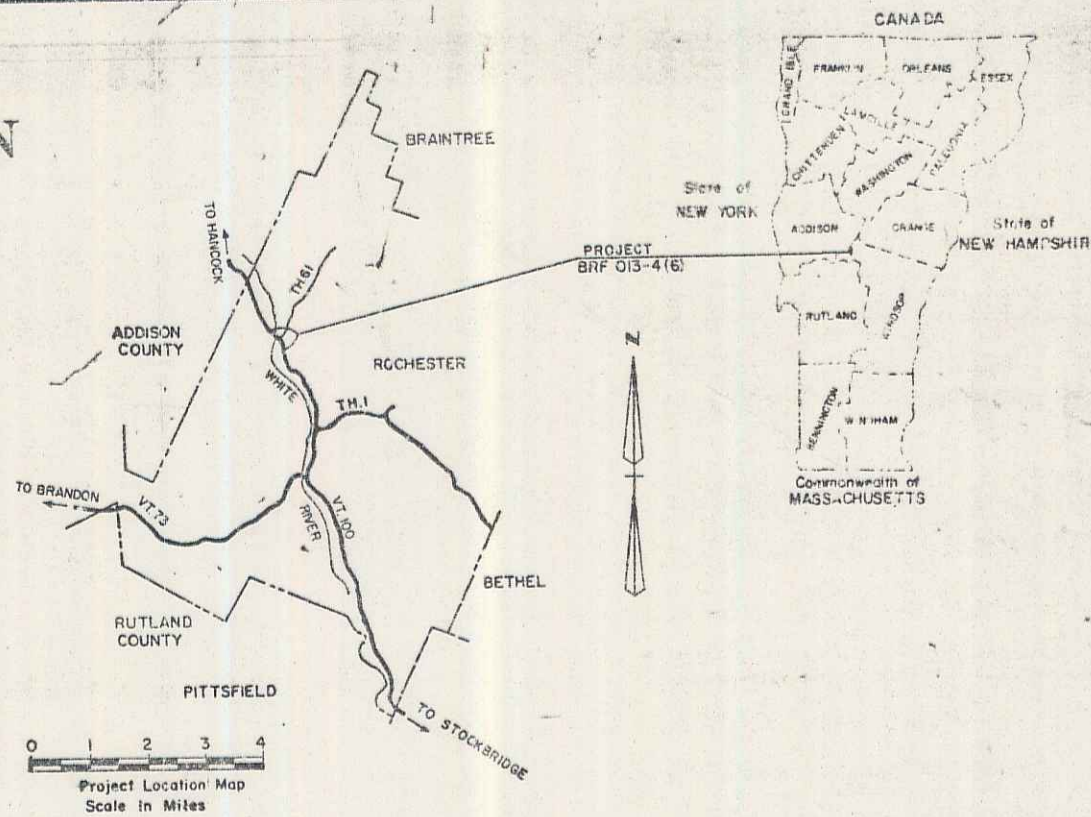

R.O.W. PLANS

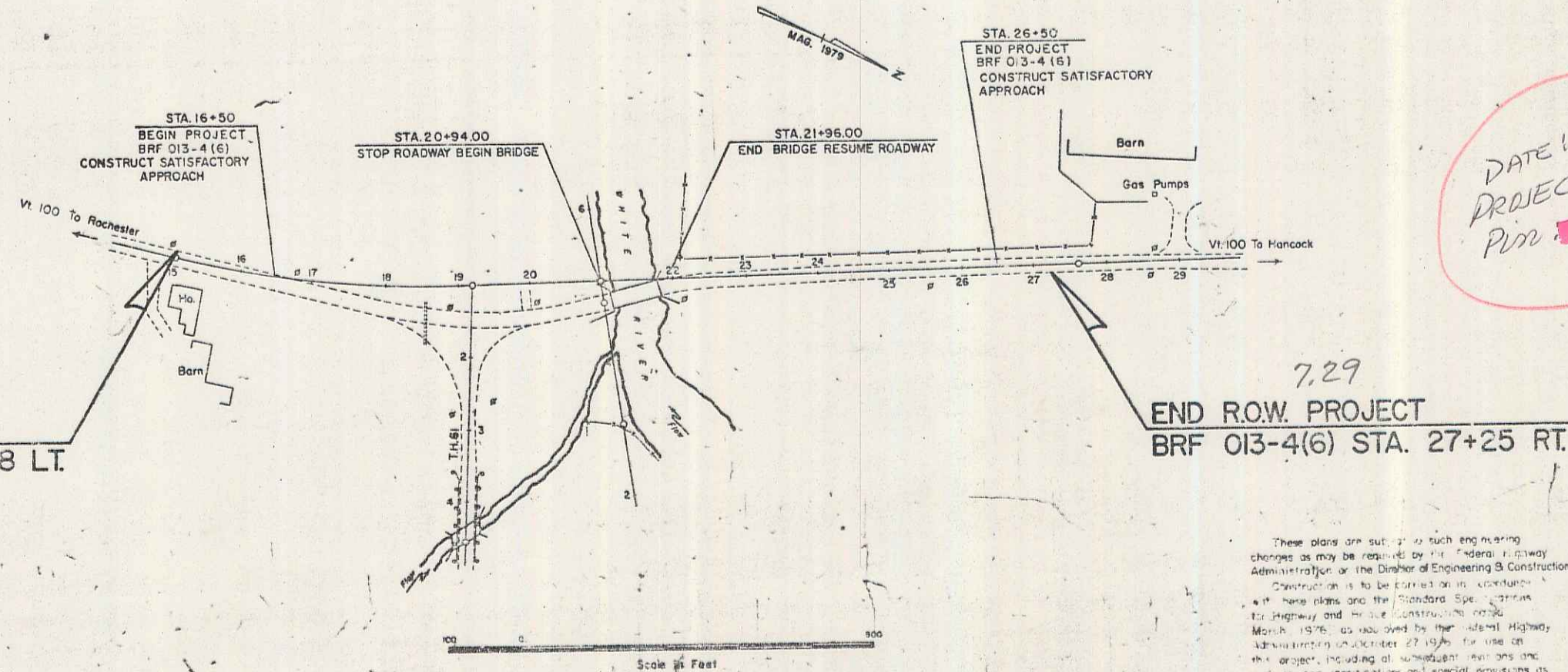

- CONVENTIONAL SIGNS
- COUNTY LINE
  - TOWN LINE
  - LIMITS OF ACCESS
  - POINT OF ACCESS
  - FENCE LINE
  - STONE WALL
  - TRAVELED WAY
  - GUARD RAIL
  - RAILROAD
  - SURVEY LINE
  - VERT
  - POLE
  - PHONE POLE
  - TREES
  - CONTROL OF ACCESS
  - PROPERTY LINE
  - R.O.W. TAKING LINE
  - SLOPE RIGHTS
  - TOP OF CUT
  - TOE OF SLOPE

DATUM  
VERTICAL NGVD 1929  
HORIZONTAL N/A

APPROVED *[Signature]*  
CHIEF, PROPERTY ADMINISTRATION  
DATE 7-10-82

APPROVED *[Signature]* DATE 3-12-82  
DIRECTOR OF ENGINEERING & CONSTRUCTION  
DEPARTMENT OF TRANSPORTATION  
FEDERAL HIGHWAY ADMINISTRATION

PROJECT: BRF 013-4(6)  
SHEET 1 OF 4 SHEETS  
SRS 5/17/70

