

INDEX OF SHEETS

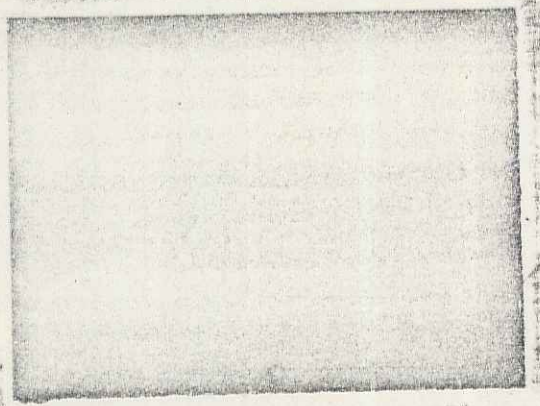

STATE OF VERMONT AGENCY OF TRANSPORTATION



PROPOSED IMPROVEMENT TOWN OF ROCHESTER COUNTY OF WINDSOR VT. ROUTE 100

BEGINNING AT A POINT 1.267 MILES SOUTH OF THE ROCHESTER-HANCOCK TOWN LINE AND EXTENDING NORTHERLY 0.189 MILES.
LENGTH OF ROADWAY 898.00 FEET = 0.170 MILES
LENGTH OF BRIDGE 102.00 FEET = 0.019 MILES
LENGTH OF PROJECT 1000.00 FEET = 0.189 MILES
TRAFFIC DATA
1982 ADT = 2140 2002 ADT = 2930
1982 DHV = 300 2002 DHV = 425
D = 5.1% T = 9% V = 50 MPH
LENGTH OF ROW PROJECT 1217 FEET = 0.230 MILES

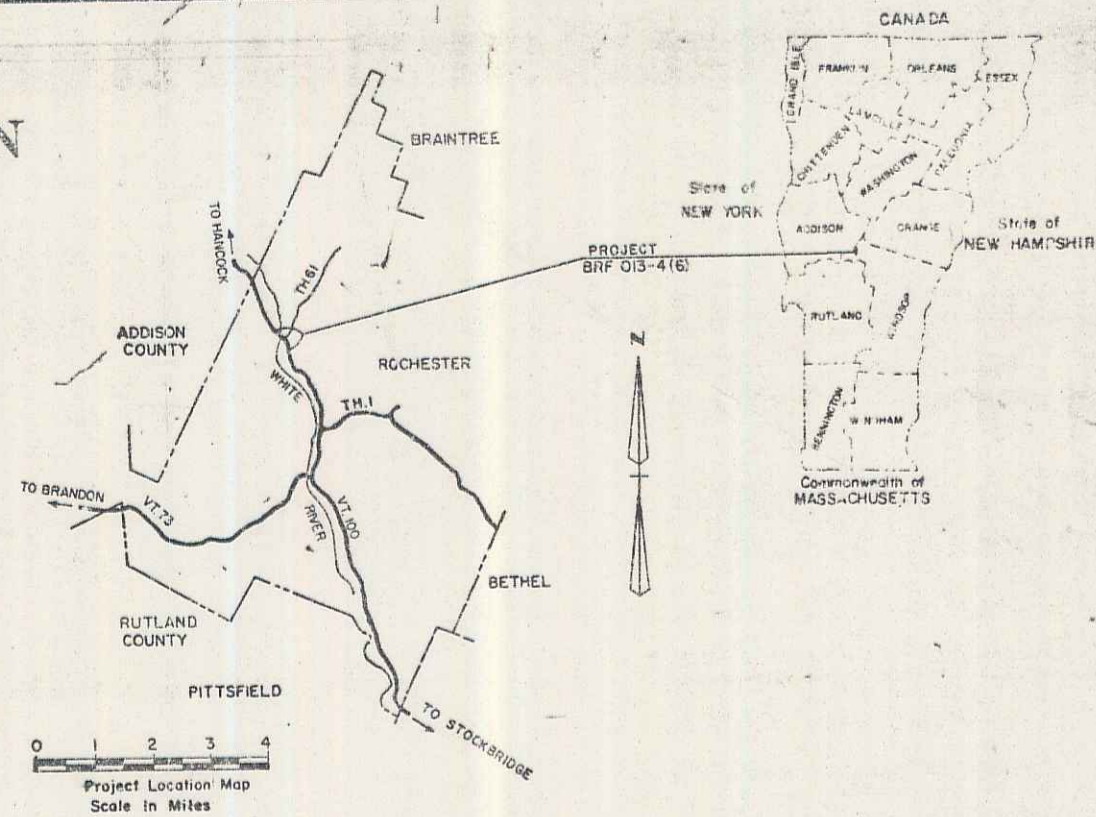

R.O.W. PLANS

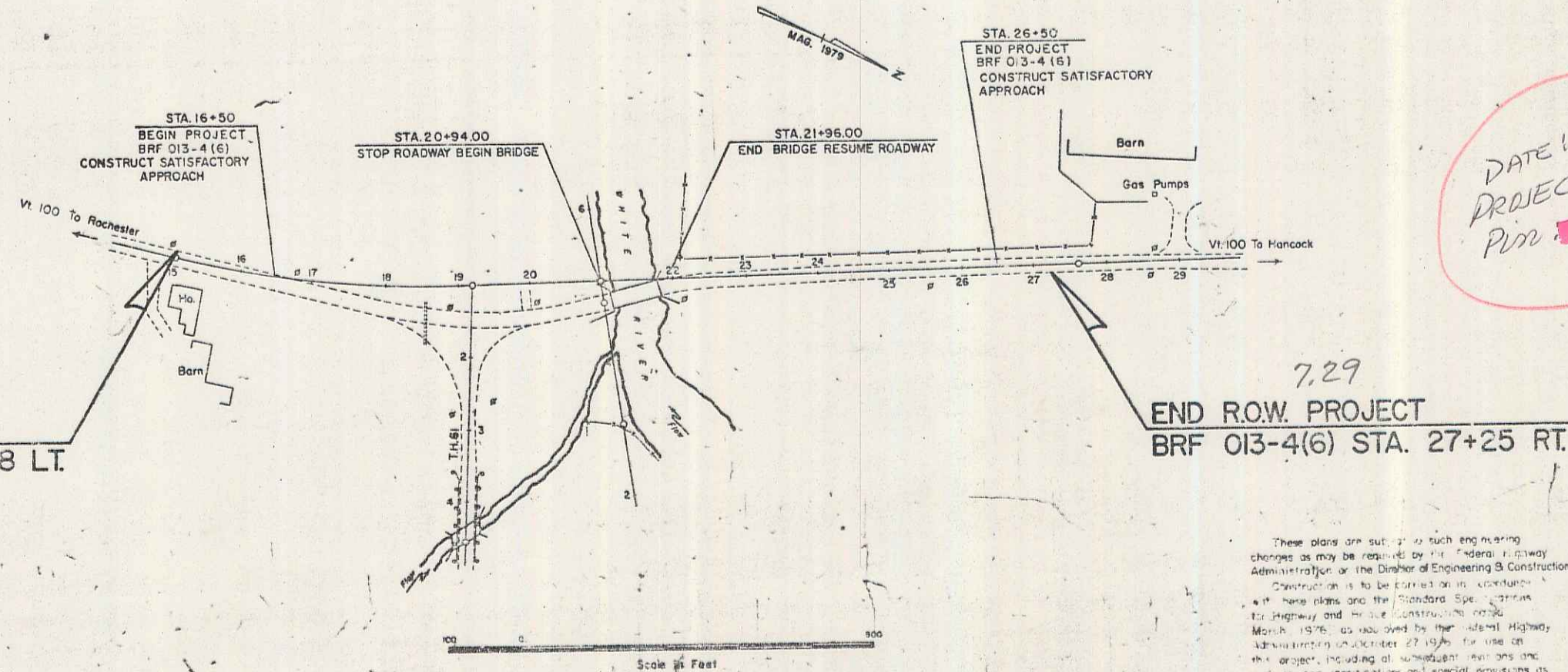

CONVENTIONAL SIGNS

COUNTY LINE	---
TOWN LINE	- - - -
LIMITS OF ACCESS	—○—
POINT OF ACCESS	—○—
FENCE LINE	—x—
STONE WALL	—x—
TRAVELED WAY	—•••••
GUARD RAIL	—•••••
RAILROAD	—+—+—+—
SURVEY LINE	—+—+—+—
VERT	—+—+—+—
POLE	—○—
PHONE POLE	—○—
TREES	—○—
CONTROL OF ACCESS	— —
PROPERTY LINE	— —
R.O.W. TAKING LINE	— —
SLOPE RIGHTS	—SR—
TOP OF CUT	—○—
TOE OF SLOPE	—○—

BEGIN R.O.W. PROJECT
BRF 013-4(6) STA. 15+08 LT.

END R.O.W. PROJECT
BRF 013-4(6) STA. 27+25 RT.

DATUM

VERTICAL	NGVD 1929
HORIZONTAL	N/A

These plans are submitted as such engineering changes as may be required by the Federal Highway Administration or the Director of Engineering & Construction. Construction is to be carried out in accordance with these plans and the Standard Specifications for Highway and Bridge Construction, 1976 Edition, as amended by the Federal Highway Administration on October 27, 1978, for use on this project, including all subsequent revisions and with the specifications and special provisions as incorporated in these plans.

APPROVED: *[Signature]*
CHIEF, PROPERTY ADMINISTRATION
DATE: 3-10-82

SUBMITTED BY ORDER OF THE STATE TRANSPORTATION BOARD

APPROVED: *[Signature]* DATE: 3-10-82
Director of Engineering & Construction

DEPARTMENT OF TRANSPORTATION
FEDERAL HIGHWAY ADMINISTRATION

APPROVED: _____ DATE: _____
DIVISION ADMINISTRATOR

PROJECT: BRF 013-4(6)
SHEET: 1 OF 4 SHEETS
SRS 5/77/70