



# STATE OF VERMONT AGENCY OF TRANSPORTATION



## PROPOSED IMPROVEMENT TOWN OF HARTLAND COUNTY OF WINDSOR U.S. ROUTE 5 (F.A.S.)

BEGINNING AT A POINT APPROXIMATELY 0.685 MILES SOUTHERLY OF THE HARTLAND /  
HARTFORD TOWN LINE ON US 5 AND EXTENDING NORTHERLY APPROXIMATELY 0.227 MILES  
LENGTH OF ROADWAY 980.95 FEET = 0.186 MILES  
LENGTH OF BRIDGE 219.05 FEET = 0.041 MILES  
LENGTH OF PROJECT 1200.00 FEET = 0.227 MILES  
LENGTH OF ROW FROM 2000.00 FEET = 0.379 MILES  
WORK TO BE PERFORMED UNDER THIS PROJECT CONSISTS OF A NEW BRIDGE OVER THE  
OTTAUQUECHEE RIVER AND CONSTRUCTING THE NECESSARY ROADWAY APPROACHES.

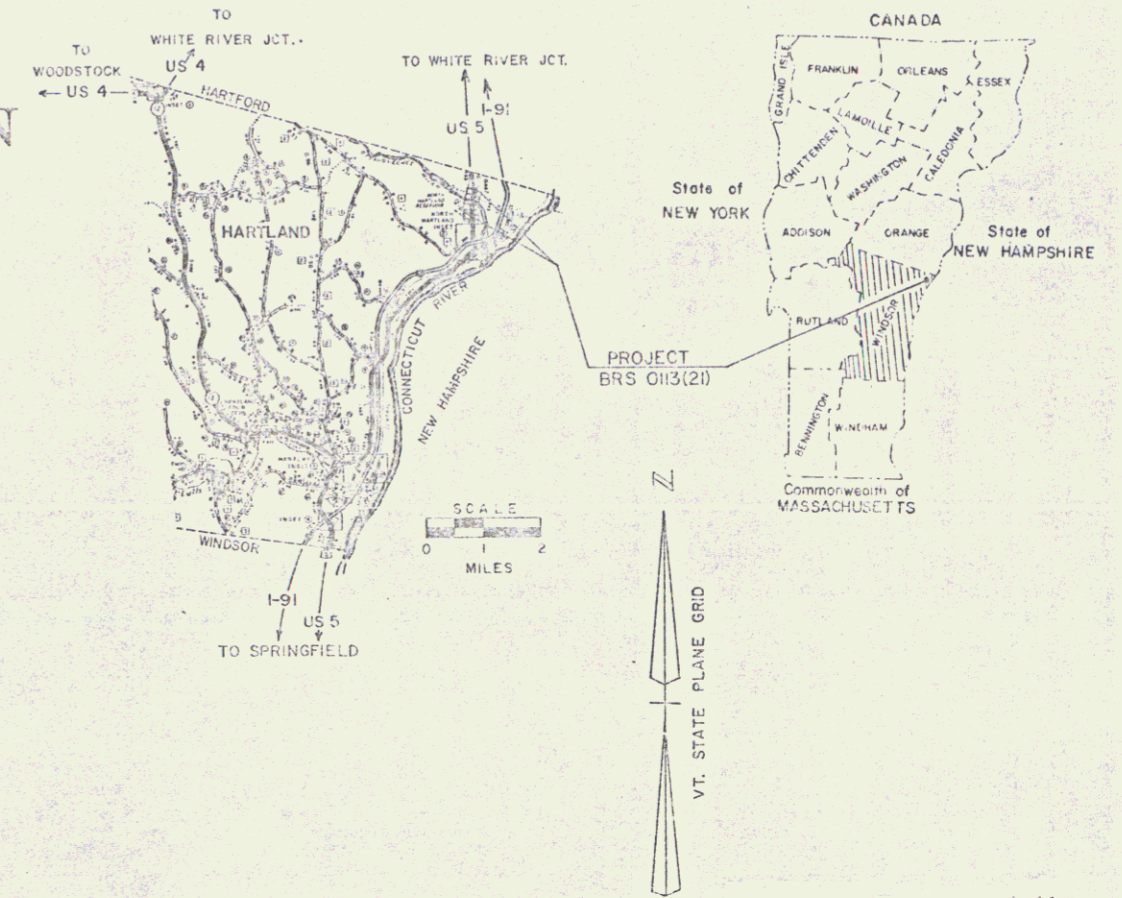

### R.O.W. PLANS

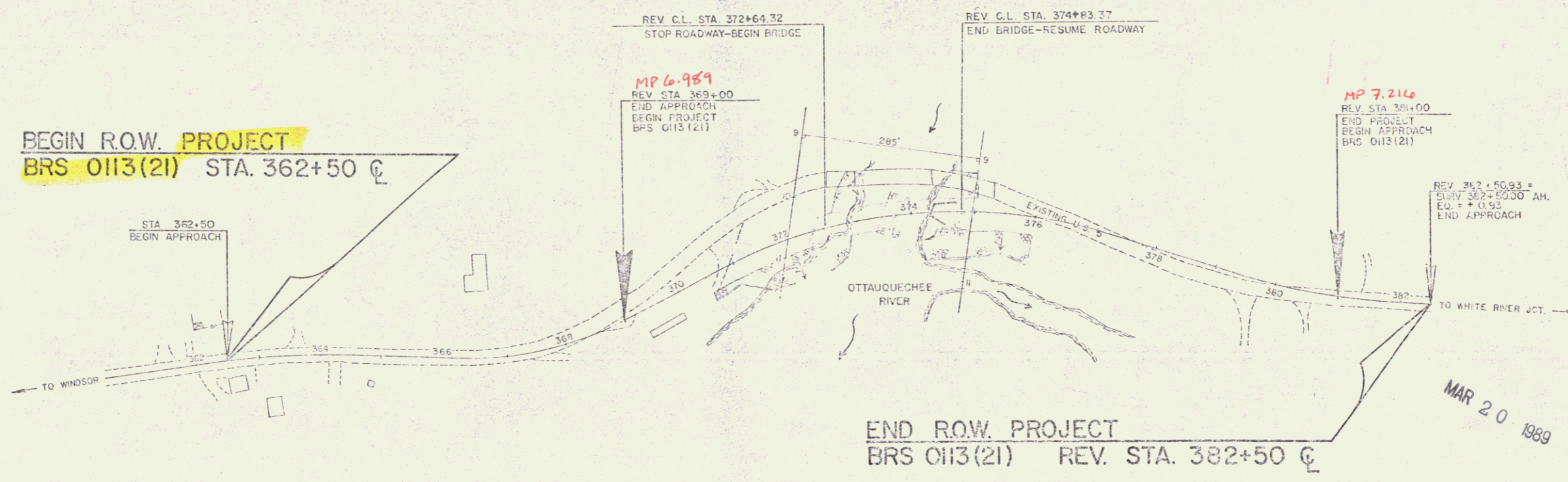

CONVENTIONAL SIGNS

|                   |     |
|-------------------|-----|
| COUNTY LINE       | --- |
| TOWN LINE         | --- |
| LIMITS OF ACCESS  | --- |
| POINT OF ACCESS   | X   |
| FENCE LINE        | --- |
| STONE WALL        | --- |
| TRAVELED WAY      | --- |
| GUARD RAIL        | --- |
| RAILROAD          | --- |
| SURVEY LINE       | --- |
| CULVERT           | --- |
| POWER POLE        | --- |
| TELEPHONE POLE    | --- |
| TREES             | --- |
| CONTROL OF ACCESS | --- |
| PROPERTY LINE     | --- |
| ROW TAKING LINE   | --- |
| SLOPE RIGHTS      | --- |
| TOP OF CUT        | --- |
| TCL OF SLOPE      | --- |

DATUM

|            |           |
|------------|-----------|
| VERTICAL   | NOVD 1925 |
| HORIZONTAL | N/A       |



**Pin # 78F171**  
ALL DRIVES AS INDICATED ON  
PLANS ARE SUBJECT TO PER-  
MITS PURSUANT TO TITLE 19,  
SECTION 43, V.S.A.

These plans are subject to such engineering changes as may be required by the Federal Highway Administration or the Director of Engineering and Construction.  
Construction is to be carried on in accordance with these plans and the Standard Specifications for Highway and Bridge Construction dated March, 1976, as approved by the Federal Highway Administration on October 27, 1976 for use on this project, including all subsequent revisions and such revised specifications and special provisions as are incorporated in these plans.

SUBMITTED BY ORDER OF THE STATE TRANSPORTATION BOARD

APPROVED: *S. J. O'Connell* DATE: 10-5-84  
DIRECTOR OF ENGINEERING AND CONSTRUCTION

DEPARTMENT OF TRANSPORTATION  
FEDERAL HIGHWAY ADMINISTRATION

APPROVED: \_\_\_\_\_ DATE: \_\_\_\_\_  
DIVISION ADMINISTRATOR

**HARTLAND**  
**BRS 0113(21)**  
SHEET 1 OF 9

STATE OF VERMONT  
AGENCY OF TRANSPORTATION  
RIGHT-OF-WAY PLANS  
DETAIL SHEET

TABLE OF PROJECT PROPERTY ACQUISITION

| PARCEL NO.        | GRANTOR  | SHEET NO.     | BEGINNING STATION | ENDING STATION    | TAKING  | REM. | RIGHTS                     | TITLE TAKEN | DATE     | TOWN OR CITY RECORDED | BK. | PG.    | REMARKS  |
|-------------------|--|---------------|-------------------|-------------------|---------|------|----------------------------|-------------|----------|-----------------------|-----|--------|--|
| 1A                | MAXFIELD, LOUIS E. & MARGARET L. & MAXFIELD, LOUELL E. | 8,9           | REV. 366 + 24 RL  | REV. 372 + 85 LI  | 0.60 A± |      | CONST. EASE. (T) (0.14 A±) | WB          | 12/15/85 | HARTLAND              | 68  | 240-44 | 12' GRAVEL WP 0630   |
|                   |  |               | 363 + 95 RL       | REV. 369 + 45 RL  |         |      | SLOPE (T) (0.77 A±)        |             |          |                       |     |        |  |
|                   |  |               | 364 + 10 RL       | REV. 369 + 38 RL  |         |      | DRIVE (T)                  |             |          |                       |     |        |  |
|                   |  |               | 364 + 25 RL       |                   |         |      | DRAINAGE (P)               |             |          |                       |     |        |  |
|                   |  |               | 364 + 55 RL       |                   |         |      | CULVERT (P)                |             |          |                       |     |        |  |
|                   |  |               | 364 + 85 RL       | 364 + 85 RL±      |         |      | ALL R.T. & I. DRIVE (T)    |             |          |                       |     |        |  |
|                   |  |               | REV. 369 + 00 RL  |                   |         |      |                            |             |          |                       |     |        |  |
|                   |  |               | REV. 364 + 92 RL± | REV. 369 + 30 RL± |         |      | ALL R.T. & I.              |             |          |                       |     |        |  |
|                   |  |               | REV. 369 + 30 RL  | REV. 369 + 95 RL  |         |      | ALL R.T. & I.              |             |          |                       |     |        |  |
|                   |  |               | REV. 369 + 70 RL± | REV. 369 + 80 RL± |         |      | ALL R.T. & I.              |             |          |                       |     |        |  |
| REV. 369 + 85 RL± |  | ALL R.T. & I. |                   |                   |         |      |                            |             |          |                       |     |        |  |
| REV. 369 + 70 RL± | REV. 370 + 05 RL±                                      |               | ALL R.T. & I.     |                   |         |      |                            |             |          |                       |     |        |  |
| 1B                |  | 8,9           | 363 + 75 LI       | 363 + 85 LI       |         |      | ALL R.T. & I.              |             |          |                       |     |        | FENCE D-1 (2165 SE±)   |
|                   |  |               | 363 + 80 LI       | REV. 366 + 60 LI  |         |      | SLOPE (T) (0.05 A±)        |             |          |                       |     |        |  |
|                   |  |               | 364 + 80 LI       | 367 + 10 LI       |         |      | CONST. EASE. (T) (0.05 A±) |             |          |                       |     |        |  |
|                   |  |               | 365 + 18 LI±      | 365 + 25 LI±      |         |      | CULVERT (P)                |             |          |                       |     |        |  |
| REV. 371 + 25 LI  |  | DRIVE (T)     |                   |                   |         |      |                            |             |          |                       |     |        |  |
| 363 + 65 LI       |  | DRIVE (T)     |                   |                   |         |      |                            |             |          |                       |     |        |  |
| 1C                |  | 9             | REV. 374 + 33 RL  | REV. 378 + 05 RL  | 0.53 A± |      | CONST. EASE. (T) (0.05 A±) |             |          |                       |     |        | (2600 SE±)   |
|                   |  |               | REV. 375 + 05 RL  | REV. 380 + 00 RL  |         |      | SLOPE (T) (0.02 A±)        |             |          |                       |     |        |  |
|                   |  |               | REV. 372 + 28 RL  | REV. 373 + 75 RL  |         |      | INSTALL & MAINT. (P)       |             |          |                       |     |        |  |
|                   |  |               | REV. 373 + 60 RL  | REV. 373 + 80 RL  |         |      | CHANNEL (P) (0.07 A±)      |             |          |                       |     |        |  |
|                   |  |               | REV. 374 + 05 RL  | REV. 374 + 85 RL  |         |      |                            |             |          |                       |     |        |  |
| 1D                |  | 9             | REV. 379 + 41 RL  | REV. 382 + 50 RL  | 0.06 A± |      |                            |             |          |                       |     |        | (2535 SE±)   |
|                   |  |               | REV. 379 + 64 RL  |                   |         |      | CULVERT (T)                |             |          |                       |     |        |  |
|                   |  |               | REV. 380 + 50 RL  |                   |         |      |                            |             |          |                       |     |        |  |
| REV. 380 + 64 RL± |  |               |                   |                   |         |      |                            |             |          |                       |     |        |  |
| 1E                |  | 8,9           | 362 + 50 CL       | REV. 372 + 78 LI  | 1.08 A± |      | ALL R.T. & I.              |             |          |                       |     |        | HWY. EASE. VI. RTE. 5  |
| 1F                |  | 8,9           | REV. 373 + 81 LI  | REV. 382 + 50 CL  | 0.52 A± |      | ALL R.T. & I.              |             |          |                       |     |        | HWY. EASE. VI. RTE. 5  |
| 1G                |  | 9             | REV. 373 + 62 RL  | REV. 374 + 45 LI  | 0.10 A± |      | ALL R.T. & I.              |             |          |                       |     |        | OTTAWAQUEHEE RIVER (EXCEPT & RESERVE FLOWAGE RTS. TO WCC PARCEL 3) |

TABLE OF REVISIONS

| REVISION NO. | SHEET NO. | DESCRIPTION OF REVISION   | DATE     | MADE BY | APPROVED BY |
|--------------|-----------|---|----------|---------|-------------|
| 1            | 6,7,8,9   | Parcel #1 Maxfield & Parcel #2 White Current Corp. added parcel 1F630 and added new for taking to B and reduced taking on 1A per C.O. 6357  | 10-25-84 | JGH     | Sub         |
| 2            | 6,8       | Parcel #7 Maxfield's increased drive @ 363+65.25 to 16' wide with a 35' drive and also added note that topsoil be added @ 363+65.25 per C.O. #6354  | 11-21-84 | JGH     | Sub         |
| 3            | 6         | Parcel #10 Changed Taking on Detail Sheet 0.09 A± To 0.06 A± Per C.O. 6453  | 3/22/85  | A.S.J.  | JGH         |
| 4            | 7,9       | Parcel #2 water system; Added Curbs Between System + Inc. Parcel #3 water Curbs; Added "THE" to Title Parcel #4 Corp. of Eng; Added "Army" to Title... U.S. "Army" Corp... Parcel #5 Water System; Added "Inc." to Title Per C.O. #6463 | 4-9-85   | DEM     | Sub         |
| 5            | 7         | Parcel #2A Added ALL R.T.I. For Pump House per Co #6502   | 4-30-85  | A.S.J.  | JGH         |
| 6            | 6,7,9     | Parcel #1 Maxfield & #3 WCC; added parcel 16432, all R.T.I. from River also added channel (P) & Install & Maint (P) to 1C added ST + 1P on A.T.I. to River + 2205 and added names to sheet & per C.O. 6532                              | 6-6-85   | JGH     | Sub         |
| 7            | 7,9       | Parcel #3 WCC; indicated area on CH. RTs + changed ending sta. on 3-6-85 also added new ch. RT. (P) to sheet which was omitted from sheet sheet only per C.O. #6532   | 6-14-85  | JGH     | Sub         |
| 8            | 7,9       | Parcel #3 WCC: Reduced Taking 0.02 A± AT STA. REV. 370+50-REV. 371+23 RT; 3A changed Begin STA. From REV. 370+52 RT to REV. 370+75 RT; Added Remainder REV. 370+52 RT - REV. 373+62 RT 0.56 A± PER C.O. #6541                           | 8-22-85  | DEM     | Sub         |

MADE BY: F. JOHN WALSH DATE: 10-3-84  
CHECKED BY: L. BLISS DATE: 10-3-84

DR. RT. - DRAINAGE RIGHT  
DIT. RT. - DITCHING RIGHT  
CH. RT. - CHANNEL RIGHT  
DRIVE RT. - DRIVE RIGHT  
CUL. RT. - CULVERT RIGHT  
Ⓟ - REVOLUTION OR REGIONAL  
Ⓜ - WATER SOURCES

PRESENT R.O.W.  
- - - - - TAKING WITHOUT ACCESS  
- - - - - TAKING WITHOUT ACCESS ALONG PROPERTY LINES  
- - - - - TAKING WITH ACCESS  
(P) PERMANENT EASEMENT  
(T) TEMPORARY EASEMENT

LEGEND  
- - - - - CONST. EASE. - - - - - CONST. EASEMENT  
SR - SR - SLOPE RIGHTS  
P - P - PROPERTY LINE  
- Δ - Δ - TOP OF CUT  
- O - O - TOE OF SLOPE

APPROVED: Lawrence W. D'Amico DATE: 11/8/85  
CHIEF OF PLANS & TITLES

MAR 20 1986

PROJECT: HARTLAND  
NO. BGS 0113(21)  
SHEET 6 OF 9

RCW

STATE OF VERMONT  
AGENCY OF TRANSPORTATION  
RIGHT-OF-WAY PLANS  
DETAIL SHEET

TABLE OF PROJECT PROPERTY ACQUISITION

| PARCEL NO. | GRANTOR  | SHEET NO. | BEGINNING STATION  | ENDING STATION  | TAKING  | REM.    | RIGHTS  | TITLE TAKEN | DATE     | TOWN OR CITY RECORDED | BK. | PG.    | REMARKS   |
|------------|--|-----------|--|---|---------|---------|---|-------------|----------|-----------------------|-----|--------|---|
| 2A         | NO. HARTLAND CO-OP WATER SYSTEM, INC.                  | 8         | 364 + 85 RT.   |   |         |         | ALL R.T.I.  | WDOE        | 10-21-86 | HARTLAND              | 70  | 375-76 | CONCRETE PUMP HOUSE D-4   |
| 2B         |  | 8         | REV. 368 + 00 RT.<br>REV. 368 + 95 RT.   | REV. 369 + 40 RT.   |         |         | DRIVE (T)   |             |          |                       |     |        | 12' GRAVEL MP 0607 USED IN COMMON WITH PARCEL NO. 1 GMP ROW TO PUMP HOUSE FOR POWER   |
| 3A         | THE WHITE CURRENT CORP.                                | 9         | REV. 370 + 98 RT.<br>REV. 371 + 25 RT.<br>REV. 372 + 38 RT.<br>REV. 370 + 52 RT.   | REV. 373 + 15 LT.<br>REV. 373 + 02 RT.<br>REV. 373 + 62 RT.   | 0.24 A± | 0.56 A± | CHANNEL (P)<br>CULVERT (P)                              | WO          | 10-21-86 | HARTLAND              | 70  | 377-79 | IN FLOWAGE RTS. AREA  |
| 3B         |  | 9         | REV. 374 + 05 RT.<br>REV. 374 + 25 RT.   | REV. 374 + 85 RT.   |         |         | CHANNEL (P)   |             |          |                       |     |        | (8.50 SE±) IN FLOWAGE RTS. AREA SIGN-OWNED BY VELCO-OP                                |
| 3C         |  | 9         | REV. 372 + 38 RT.<br>REV. 373 + 40 RT.   | REV. 373 + 81 LT.<br>REV. 374 + 00 LT.  | 0.13 A± |         | ALL R.T. & I.<br>INSTALL & MAINT. (P)                   |             |          |                       |     |        | OTTAUQUECHEE RIVER (EXCEPT & RESERVE FLOWAGE RTS.) BRIDGE PIER (IN FLOWAGE RTS. AREA) |
| 3D         |  | 9         | REV. 372 + 85 LT.  | REV. 373 + 20 LT.   | 0.08 A± |         | ALL R.T. & I.   |             |          |                       |     |        | HWY. EASE. RTE. 5 (3500 SE±)  |
| 3E         |  | 9         | REV. 373 + 62 RT.  | REV. 374 + 45 LT.   | 0.10 A± |         | ALL R.T. & I.   |             |          |                       |     |        | OTTAUQUECHEE RIVER (EXCEPT W/ RTS)  |
| 3F         |  | 9         | REV. 373 + 15 LT.  | REV. 373 + 86 LT.   | 0.03 A± |         | ALL R.T. & I.   |             |          |                       |     |        | OTTAUQUECHEE RIVER (EXCEPT W/ RTS)  |
| 4A         | UNITED STATES OF AMERICA - U.S. ARMY CORP OF ENGINEERS | 9         | REV. 375 + 50 LT.<br>REV. 375 + 25 LT.<br>REV. 375 + 60 LT.<br>REV. 377 + 50 LT.<br>REV. 381 + 35 LT.<br>REV. 381 + 50 LT. | REV. 382 + 50 LT.<br>REV. 381 + 33 LT.<br>REV. 376 + 85 LT.<br>REV. 381 + 35 LT.<br>REV. 381 + 65 LT. | 0.43 A± |         | CONST. EASE. (T)<br>DITCH (P)<br>SLOPE (P)<br>DRIVE (T) | WO          |          | HARTLAND              |     |        | GATE "DO NOT DISTURB" 24'-GRAVEL MP 0723  |
| 4B         |  | 9         | REV. 372 + 28 LT.  | REV. 382 + 50 CL.   | 0.59 A± |         | ALL R.T. & I.   |             |          |                       |     |        | HWY. EASE. RTE. 5   |
| 5          | NO. HARTLAND CO-OP WATER SYSTEM, INC.                  |           |  |   |         |         |   |             |          |                       |     |        | UTILITY   |
| 6          | GREEN MOUNTAIN POWER CORP.                             |           |  |   |         |         |   |             |          |                       |     |        | UTILITY   |
| 7          | NEW ENGLAND TELEPHONE CO.                              |           |  |   |         |         |   |             |          |                       |     |        | UTILITY   |

TABLE OF REVISIONS

| REVISION NO. | SHEET NO. | DESCRIPTION OF REVISION   | DATE    | MADE BY | APPROVED BY |
|--------------|-----------|---|---------|---------|-------------|
| 9            | 7,9       | The white current corp parcel #3 Add 10' Const. Easement Sta. 370+86 RT - 371+25 RT per C.O. # 6595                   | 8/29/86 | A.S.J.  | <i>Sub</i>  |
| 10           | 6,7,8,9   | Parcels #1 Maxfield & #2 No. Hartland H <sub>2</sub> O System. Moved drive used in common to 364+00 RT. Per C.O. 6598 | 9-4-85  | J.B.M.  | <i>Sub</i>  |
| 11           | 7,9       | PARCEL #3A THE WHITE CURRENT CORP. DELETED CONST. EASE. (T) REV. STA 370+80 RT TO REV. STA 371+25 RT. PER C.O. # 6737 | 6-6-86  | M.J.A.  | <i>Sub</i>  |
|              |           | <i>Myfars To Design</i>   | 8-4-96  |         |             |

MADE BY: E.J. WALBATH DATE: 10-2-84  
CHECKED BY: L.W. BLISS DATE: 10-3-84

DR. RT - DRAINAGE RIGHT  
DIT. RT - DITCHING RIGHT  
CH. RT - CHANNEL RIGHT  
DRIVE RT - DRIVE RIGHT  
CUL. RT - CULVERT RIGHT  
⊖ - DEMOLITION OR REMOVAL  
W - WATER SOURCES

PRESENT R.O.W.  
- - - - - TAKING WITHOUT ACCESS  
- - - - - TAKING WITHOUT ACCESS ALONG PROPERTY LINES  
- - - - - TAKING WITH ACCESS  
(P) PERMANENT EASEMENT  
(T) TEMPORARY EASEMENT

LEGEND  
- - - - - CONST. EASE  
SR - SR SLOPE RIGHTS  
P - P PROPERTY LINE  
- Δ - Δ TOP OF CUT  
- O - O TOE OF SLOPE

APPROVED: *Lauren M. Blinn* DATE: 10/5/88  
CHIEF OF PLANS & TITLES

PROJECT: HARTLAND  
NO. BRS. OUT (21)  
SHEET 7 OF 9

MAR 20 1989

HOW

|  |  |   |
|--|--|---|
| <p>Survey <math>\phi</math></p> <p>PC 362+18.35</p>                        | <p>Survey <math>\phi</math></p> <p>PT 375+97.64</p>                    | <p>Offset - channel line</p> <p>POT 11+00.00<br/>285' Right</p> |
| <p>Survey <math>\phi</math></p> <p>PI 365+42.15 =<br/>365-41.53</p>        | <p>Survey <math>\phi</math></p> <p>PC 377+69.97</p>                    |   |
| <p>Survey <math>\phi</math></p> <p>PT 364+65.33</p>                        | <p>Survey <math>\phi</math></p> <p>PT 381+59.28</p>                    |   |
| <p>Survey <math>\phi</math></p> <p>PT 369+06.58</p>                        | <p>Channel Line</p> <p>Chan Line 10+00.00 =<br/>Sub. POC 375+00.00</p> |   |
| <p>Survey <math>\phi</math></p> <p>PC 369+46.04</p>                        | <p>Channel Line</p>  |   |
| <p>Survey <math>\phi</math></p> <p>PI 372+93.15 BK =<br/>372+50.55 Ah.</p> | <p>Channel Line</p> <p>POT 9+25.00<br/>285' Right</p>                  |   |

Special Ditch (Item 203.15)  
Rev. 369+00 LT ~ Rev. 369+50 LT.

Guard Rail, Std. Steel Beam  
w/Wood Posts, Type II  
Rev. 369+27 Rt ~ Rev. 369+50 Rt.

Removal of Existing Wood  
Guide Posts  
364+50 Rt ~ Rev. 367+43 Rt.

Drilling & Blasting of Solid Rock Subgrade  
Rev. 369+00 ~ Rev. 369+50

Removal of Existing Portland  
Cement Concrete Pavement (Item 203.16)  
362+50 ~ Rev. 369+50

Remove existing Topsoil, stockpile, spread Topsoil  
back on new 1:4 slopes. (\* depth to be determined  
by the Engineer). Payment subsidiary to other  
Items  
364+30 Rt ~ 369+00 RT.

**BEGIN ROW. PROJECT**  
BRS 0113(21) STA. 362+50  $\phi$

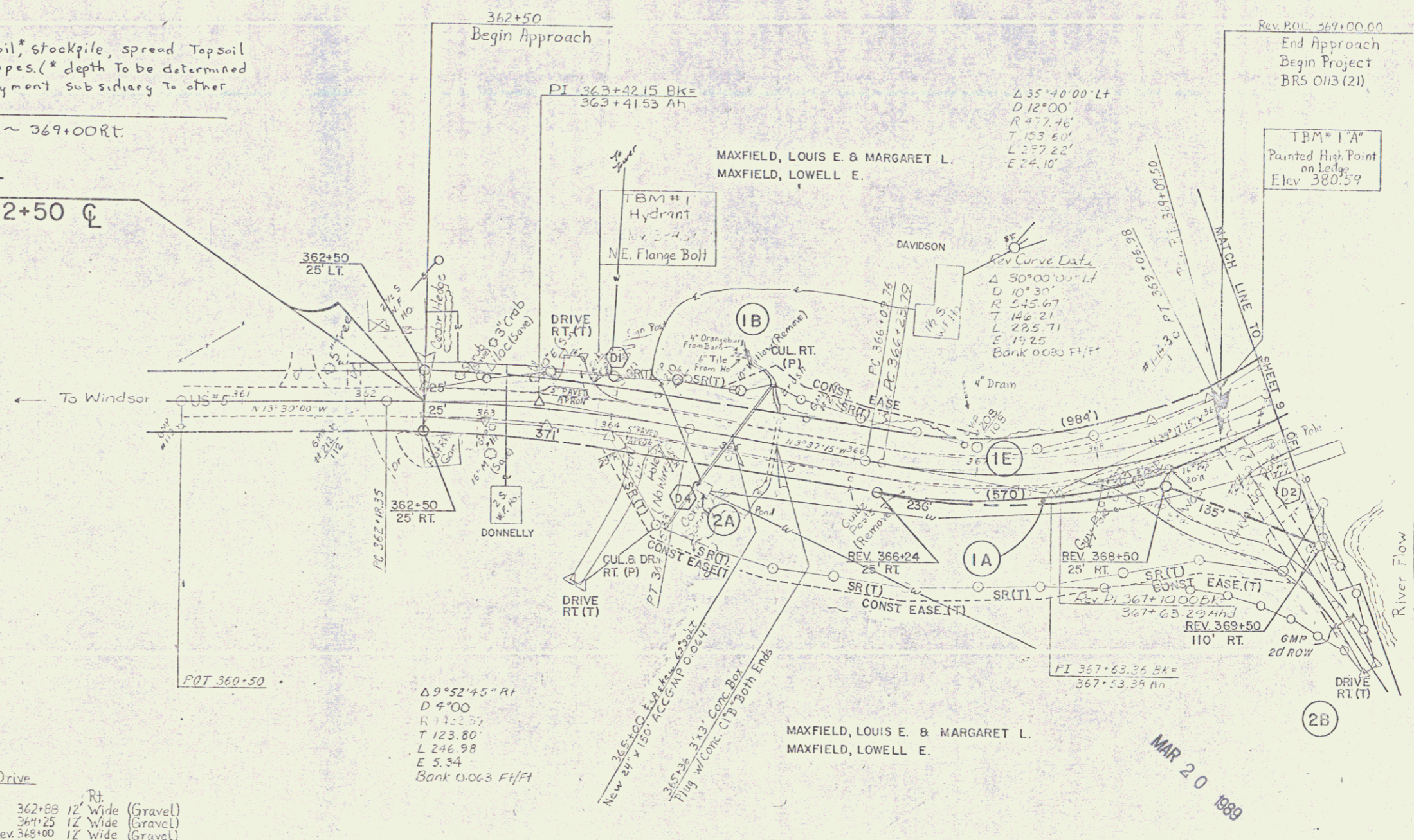

|            |           |
|------------|-----------|
| DATUM      |           |
| VERTICAL   | NCVD 1929 |
| HORIZONTAL | N/A       |

Construct Drive

|                          |                               |
|--------------------------|-------------------------------|
| 363+65 16' Wide (Gravel) | 362+88 12' Wide (Gravel)      |
|                          | 364+25 12' Wide (Gravel)      |
|                          | Rev. 368+00 12' Wide (Gravel) |

SURVEYED BY JESSIE DATE MAR '82  
 DRAWN BY SHELDON DATE OCT '82  
 TRACED BY MILLER DATE OCT '82  
**HARTLAND**  
 BRS 0113(21)  
 SHEET 8 OF 9

Drilling & Blasting of Solid Rock Subgrade  
 Rev. 369+50 ~ Rev. 370+75  
 Rev. 378+00 ~ Rev. 381+50

Removal of Existing Portland Cement  
 Concrete Pavement (To Be Paid Under  
 Item 202.16)  
 Rev. 369+50 ~ 370+52.14  
 Rev. 375+30 ~ 382+00

Excavation & Removal of Road Surfaces & Pavements  
 (Removal of Existing Portland Cement  
 Concrete Pavement) (Item 202.15)  
 Rev. 370+05 ~ 372+80 Lt.

Gravel Parking Area (Rev. 372+00 ~ 372+70 Lt.)  
 (See Special Provisions)

Guard Rail, Pmk w/Wood Posts  
 Rev. 372+70 Lt.

Removal & Disposal of Existing Guard Rail  
 Rev. 371+85 Lt ~ Rev. 372+80 Lt.  
 Rev. 372+10 Lt ~ Rev. 372+85 Lt.  
 Rev. 375+32 Lt ~ Rev. 378+32 Rt.  
 Rev. 375+32 Lt ~ Rev. 378+92 Rt.

Guard Rail, Std Steel Beam  
 w/Wood Posts, Type II  
 Lt. Rt.  
 Rev. 371+70 ~ Rev. 372+20 Rev. 369+50 ~ Rev. 371+89  
 Rev. 375+75 ~ Rev. 378+12 Rev. 375+35 ~ Rev. 378+97

Mag. 1 1982 Z

BCT  
 Lt. Rt.  
 Rev. 371+45 ~ 371+70 Rev. 370+77 ~ 379+22  
 Rev. 378+12 ~ 378+37

Treated Timber Curb  
 Rev. 372+36 Rt ~ Rev. 372+40 Rt.  
 Rev. 374+84 Rt ~ Rev. 377+75 Rt.

Guard Rail Approach Section, Type I  
 Lt. Rt.  
 Rev. 372+20 ~ Rev. 372+70 Rev. 371+89 ~ Rev. 372+39  
 Rev. 375+25 ~ Rev. 375+75 Rev. 374+85 ~ Rev. 375+35

Rev. 381+00  
 End Project  
 BRS 0113(21)  
 Begin Approach

Temporary 4" ReflectORIZED White Lines  
 Rev. 369+50 Rt ~ Rev. 382+50 Rt.  
 Rev. 369+50 Lt ~ Rev. 382+50 Lt.  
 Temporary 4" ReflectORIZED Yellow Lines (Double)  
 Rev. 369+50 ~ Rev. 382+50

END R.O.W. PROJECT  
 BRS 0113(21) REV. STA. 382+50

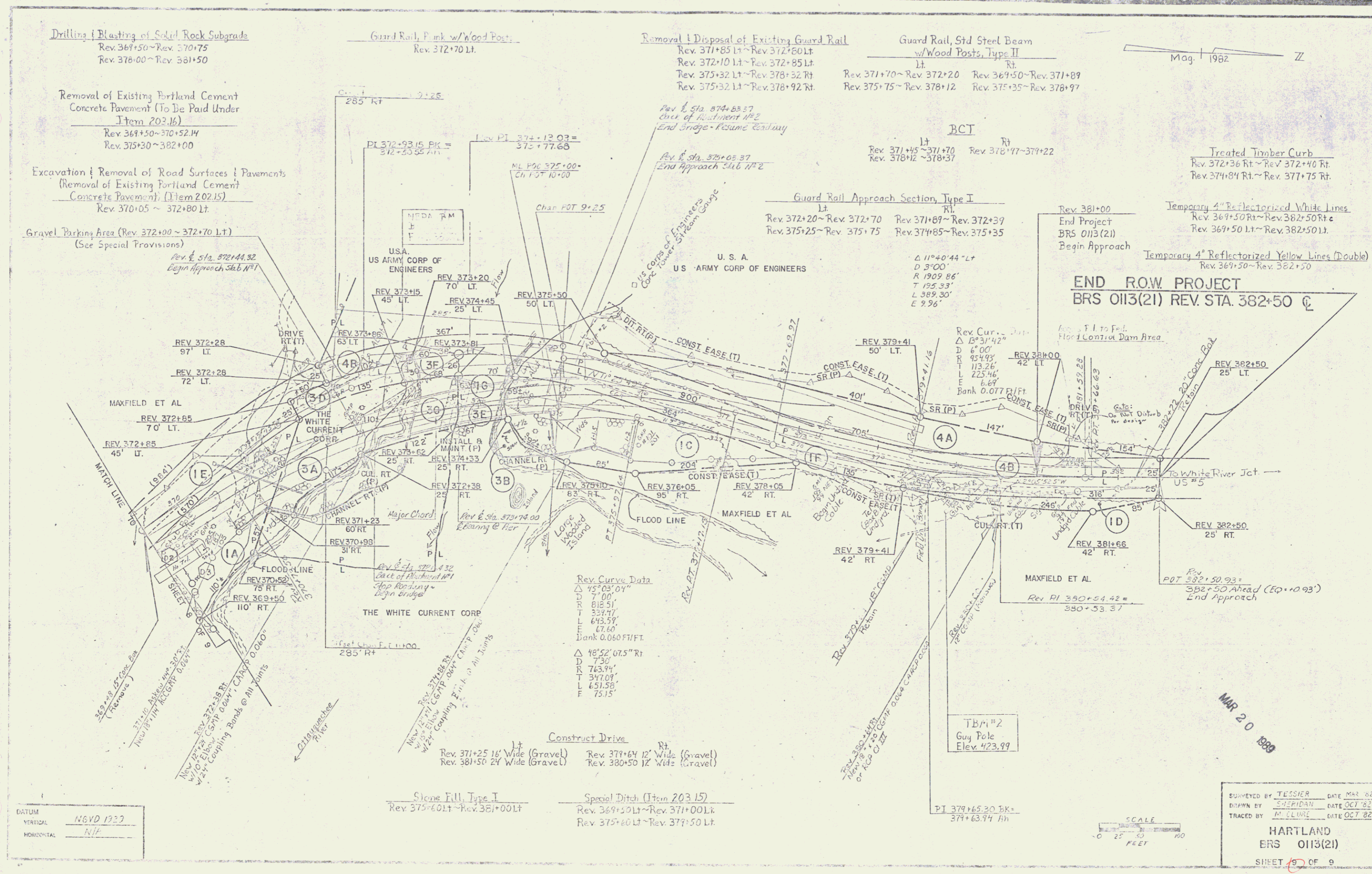

DATUM  
 VERTICAL NGVD 1923  
 HORIZONTAL NIP

Stone Fill, Type I  
 Rev. 375+60 Lt ~ Rev. 381+00 Lt

Special Ditch (Item 203.15)  
 Rev. 369+50 Lt ~ Rev. 371+00 Lt.  
 Rev. 375+60 Lt ~ Rev. 377+50 Lt.

PI 379+65.30 Bk =  
 379+63.94 Hh

MAR 20 1982

SURVEYED BY TESSER DATE MAR 82  
 DRAWN BY SHERIDAN DATE OCT 82  
 TRACED BY M. CLURE DATE OCT 82  
 HARTLAND  
 ERS 0113(21)  
 SHEET 9 OF 9

5