

Concrete Drive
261+75 to 261+85 (Gravel)
261+85 to 261+95 (Gravel)
Rev. 261+00 to 261+00

WIREWAY CABLE TERMINAL FOR GUARD
FAC. STEEL WOOD POSTS, TYPE III
Rev. 261+12 LT. - Rev. 261+31 LT.

GUARD RAIL 143 STEEL BEAM W/
WOOD POSTS, TYPE III
Rev. 261+37 LT. - 261+00 LT.

ADJUSTED EASEMENT DISTANCE WITH DRIVE
Rev. 261+15 LT. - Rev. 261+00 LT.

CHISELING & BLASTING Y-SOLD ROCK SUBGRADE
Surv. 260+20 - Rev. 260+00

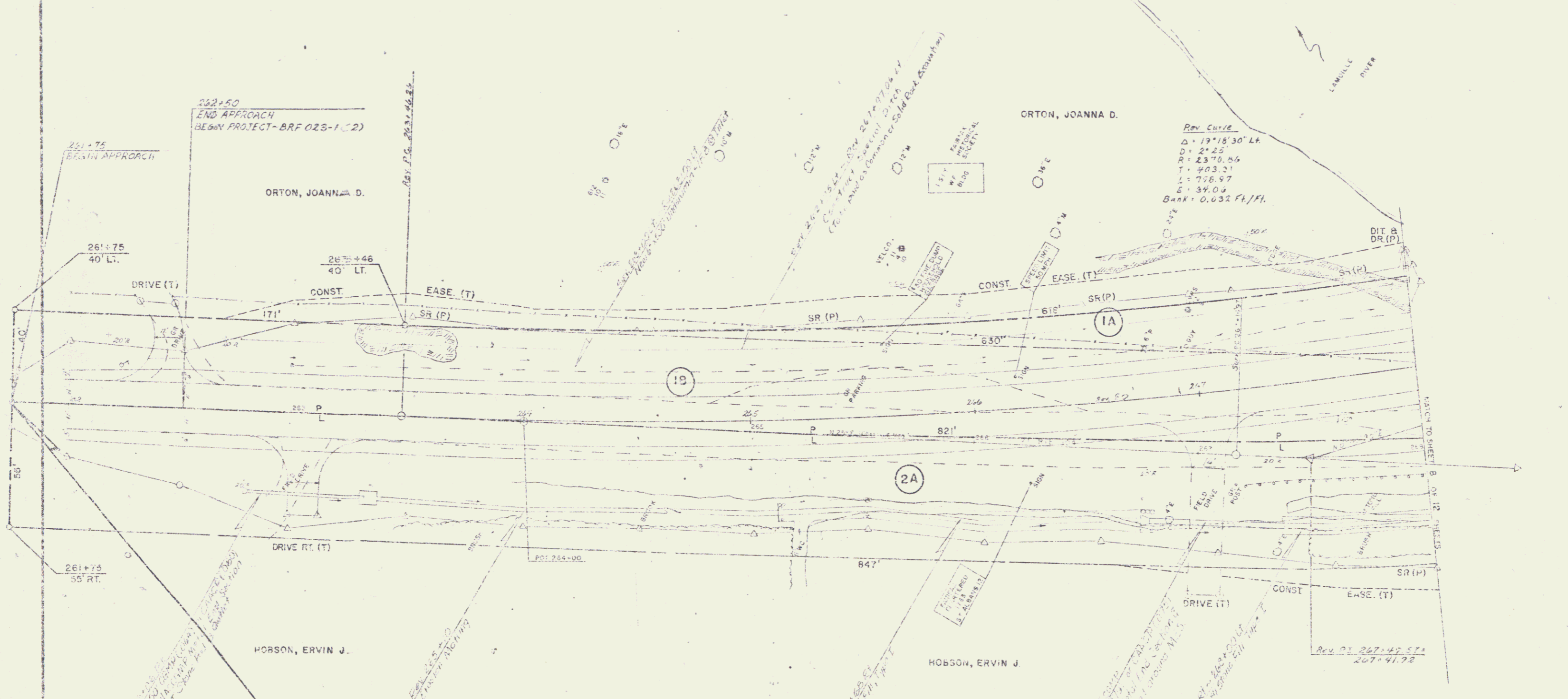

Rev Curve
Δ = 19°18'30" LT.
D = 21.25
R = 2370.54
T = 403.31
L = 78.97
E = 34.04
Bank = 0.032 Ft./Ft.

BEGIN R.O.W PROJECT
BRF 023-1(2) 261+75 CL

OCT 3 1986

DATE	NOV 2 1986
SCALE	AS SHOWN
HORIZONTAL	AS SHOWN

NOTE:
SEE PROFILE SHEETS FOR ALIGNMENT TIES

SURVEYED BY	BRIDY	DATE	1986
DRAWN BY	SS	DATE	1986
TRACED BY	SP	DATE	1986
EASEMENT			
PROJ. DFW	NO. 023-1(2)		
SHEET	7	OF	12