

NOTE : SEE PIPE PROFILE SHEET 2 AND MAINLINE CROSS SECTIONS FOR ADDITIONAL INFORMATION ON STORMWATER DROP INLETS AND PIPES.

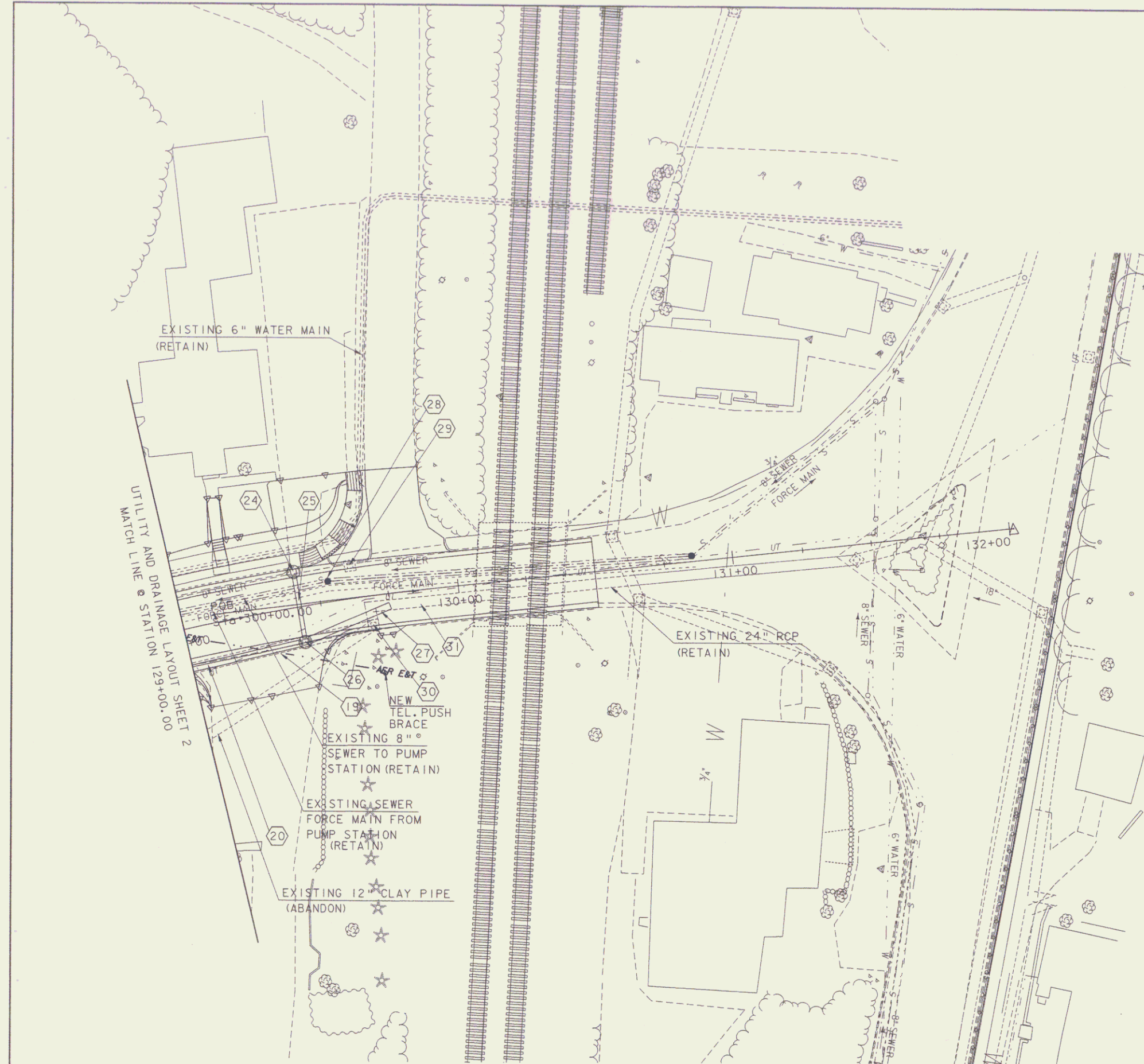
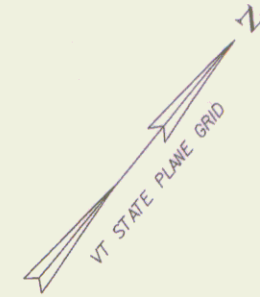

DRAINAGE

- 19 VT 107 STA 129+00.00 RT ~ 129+68.00 RT
REMOVE 24" LENGTH 67'-0" RCP
(TOTAL = 56'-6" + 67'-0" = 123'-6")
- 20 VT 107 STA 129+00.00 RT ~ 129+42.00 RT
NEW 24" LENGTH 40'-0" CPEP/CAAP/PCCSP
(TOTAL = 56'-6" + 40'-0" = 96'-6")
- 24 NEW DI* AT 129+42.00 LT
- 25 VT 107 STA 129+42.00 LT ~ 129+42.00 RT
NEW 12" LENGTH 23'-0" CPEP/CAAP/PCCSP
- 26 NEW CB AT 129+42.00 RT
- 27 VT 107 STA 129+42.00 RT ~ 129+75.00 RT
NEW 24" LENGTH 32'-5" CPEP/CAAP/PCCSP
(NEW PIPE 27 TO BE CONNECTED TO CUT PIPE 31)
- 28 ADJUST MANHOLE COVER ELEVATION AT
VT 107 STA 129+54.00 LT
- 29 VT 107 STA 129+63.00 LT
REMOVE EXISTING CAST IN PLACE CB*
- 30 VT 107 STA 129+68.00 RT
REMOVE EXISTING CAST IN PLACE CB*
- 31 VT 107 STA 129+68.00 RT ~ 129+75.00 RT
REMOVE 24" (CUT) LENGTH 7'-0" RCP

* DENOTES PRECAST REINFORCED CONCRETE DROP INLET

**UTILITIES AND DRAINAGE
LAYOUT SHEET 3**

PROJECT NAME:	BETHEL	PLOT DATE:	10-FEB-2010
PROJECT NUMBER:	BRF 022-(14)	DRAWN BY:	G. ROKES
FILE NAME:	ppms*/Section/-----,dgn	CHECKED BY:	S. SCRIBNER
PROJECT LEADER:	M. EVANS-MONGEON	ROW SHEET	12 OF 27 SHEETS
DESIGNED BY:	G. ROKES		

SCALE 1" = 20'-0"
20 0 20