

REMOVAL AND DISPOSAL OF EXISTING GUARDRAIL  
 ITEM 207.40  
 226+17 LT - 228+67 LT  
 226+20 RT - 228+70 RT  
 229+10 RT - 229+55 RT

CURVE DATA		REV CURVE DATA	
Δ	29°10' LT	Δ	36°00' LT
D	10°15'	D	7°15'
R	558.98	R	918.51
T	145.43	T	265.95
L	284.55	L	514.29
E	18.60	E	42.12
		BNK	.05 FT/FT

DATUM  
 VERTICAL NGVD 1929  
 HORIZONTAL N/A

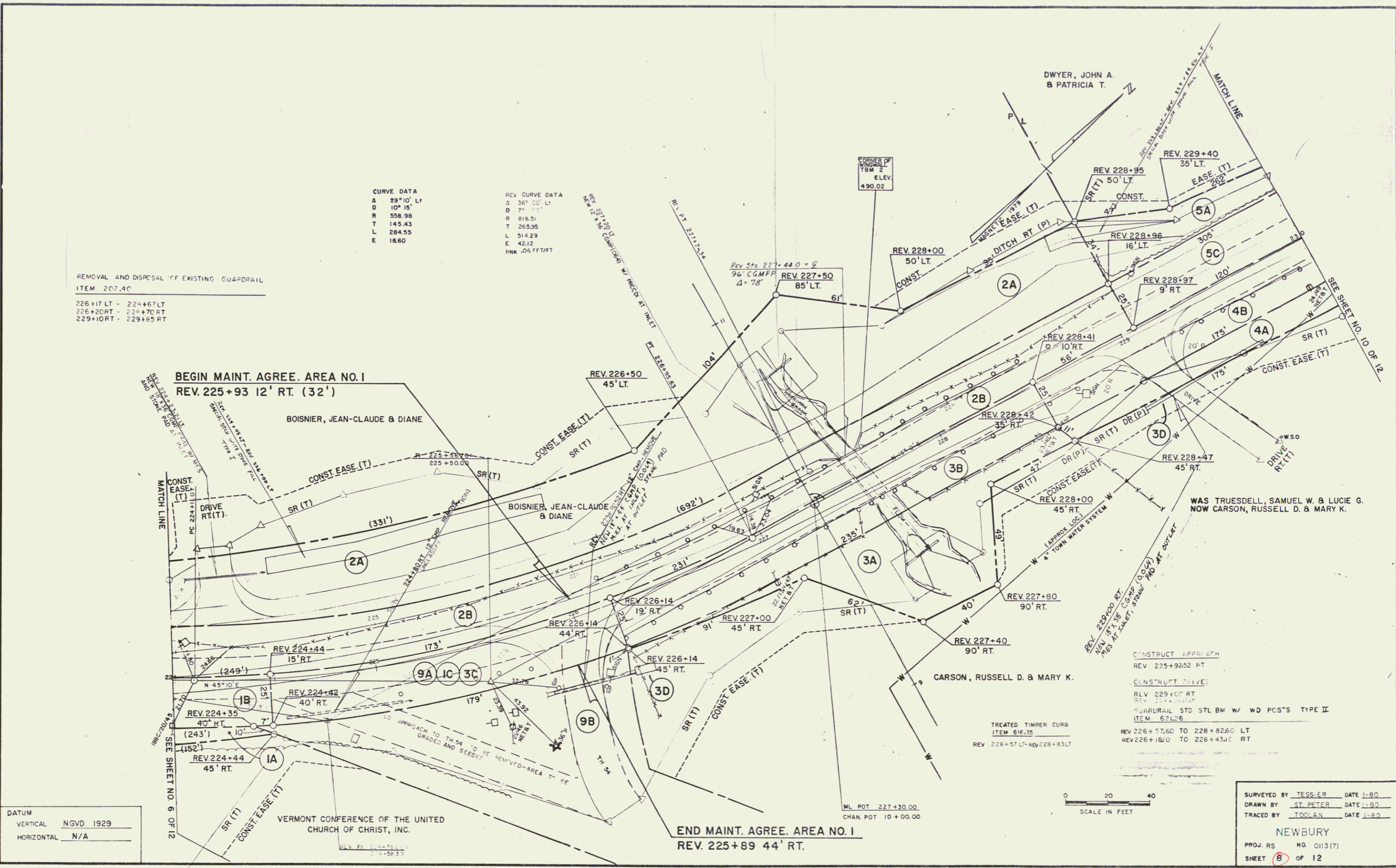

CONSTRUCT APPROACH  
 REV 225+92.52 FT  
 CONSTRUCT DRIVE  
 REV 229+00 RT  
 REV 224+00 RT  
 GUARDRAIL STD STL BM W/ WD PC'S TYPE II  
 ITEM 671.6  
 REV 226+57.60 TO 228+82.60 LT  
 REV 226+18.00 TO 228+43.00 RT

TREATED TIMBER CURB  
 ITEM 616.35  
 REV 226+57 LT-REV 228+83 LT

SCALE IN FEET  
 0 20 40

SURVEYED BY TESSIER DATE 1-80  
 DRAWN BY ST. PETER DATE 1-80  
 TRACED BY TOOLAN DATE 1-80  
 NEWBURY  
 PROJ. RS NO. 0113(7)  
 SHEET 8 OF 12  
 0-7

4