

Trout River
 Junction VT Rte. 113, VT Rte.
 58 & TH 26

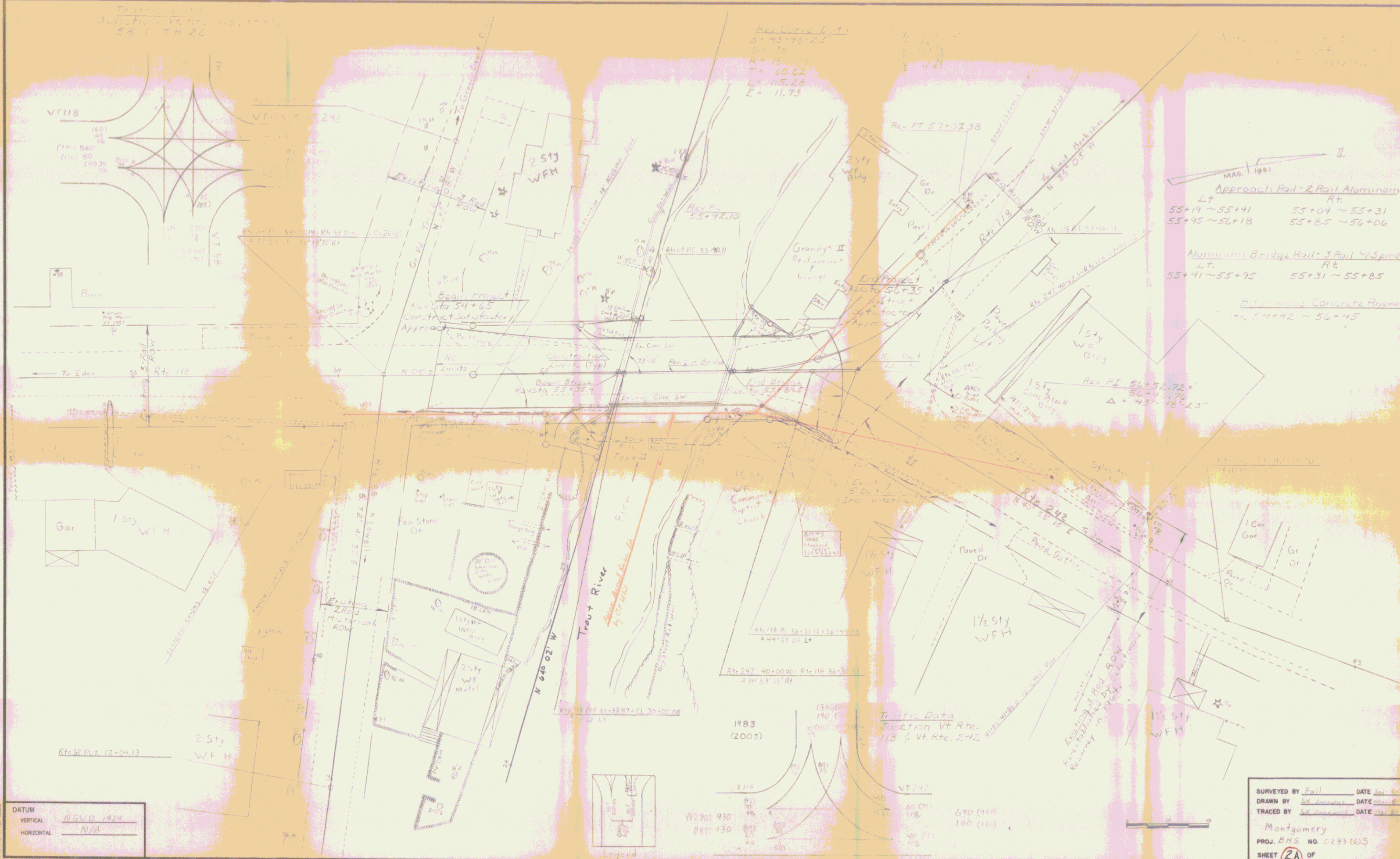

MAG. 1981

Approach Rail - 2 Rail Aluminum
 Lt. 55+19 ~ 55+41 Rt. 55+04 ~ 55+31
 55+45 ~ 56+18 55+85 ~ 56+06

Aluminum Bridge Rail - 3 Rail 1/2 Spindle
 Lt. 55+41 ~ 55+45 Rt. 55+31 ~ 55+85

Retaining Concrete Pavement
 Lt. 54+42 ~ 56+45

DATUM
 VERTICAL NGVD 1929
 HORIZONTAL N/A

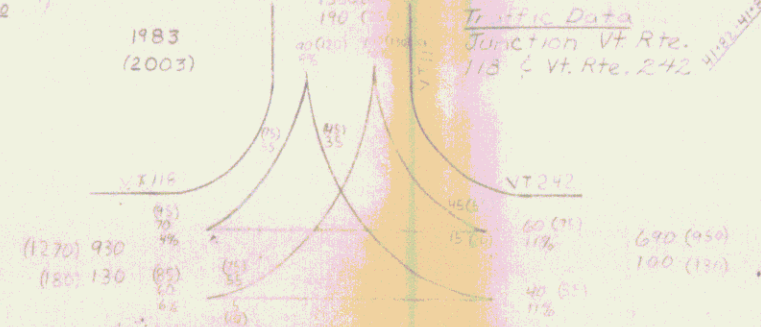

SURVEYED BY Bill DATE Jan. 81
 DRAWN BY SK DATE Jan. 81
 TRACED BY SK DATE Jan. 81

Montgomery
 PROJ. BHS NO. 0283 (6)S
 SHEET 2A OF

3
 C03-001A