

INDEX OF SHEETS

# STATE OF VERMONT AGENCY OF TRANSPORTATION

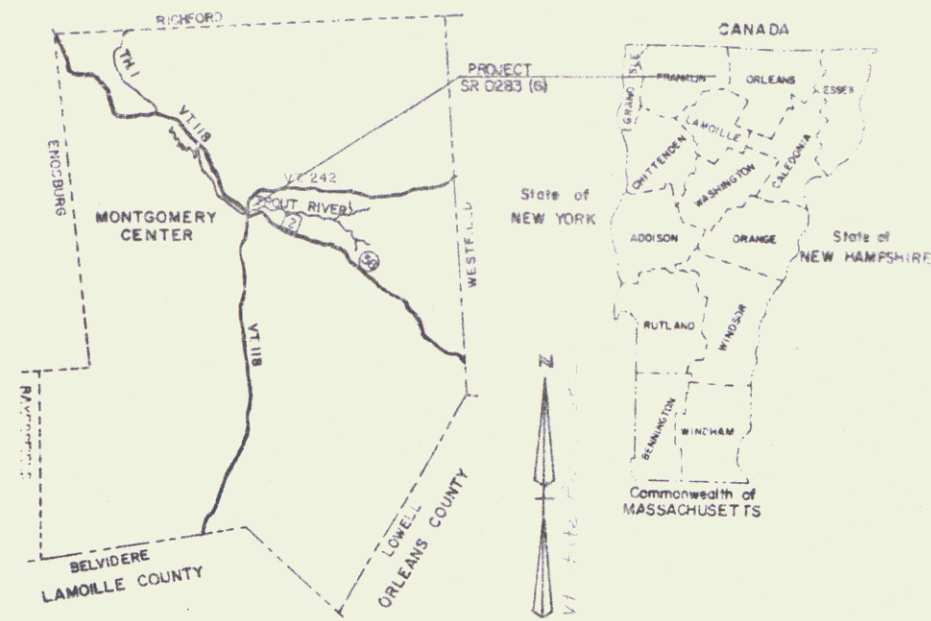

## PROPOSED IMPROVEMENT TOWN OF MONTGOMERY COUNTY OF FRANKLIN VT. ROUTE 118 BRIDGE NO. 15



R.O.W. PLANS

*Project Location: BHS 0283(6) SR 118, 1/4 mile east of Eden Rte 118, 1/4 mile west of Trout River.*  
*Project Description: Replace existing concrete bridge and abutments with 2 spans, each 75 ft long, with 10 ft approach on each end. Also, replace existing 12 ft wide sidewalk with 18 ft wide sidewalk.*

SCALE IN MILES

Length of Structure = 75 ft  
Length of Approach = 115 ft  
LENGTH OF R.O.W. PROJECT = 170.00 FT.

BEGIN R.O.W. PROJECT  
BHS 0283(6)S REV. STA. 54+65

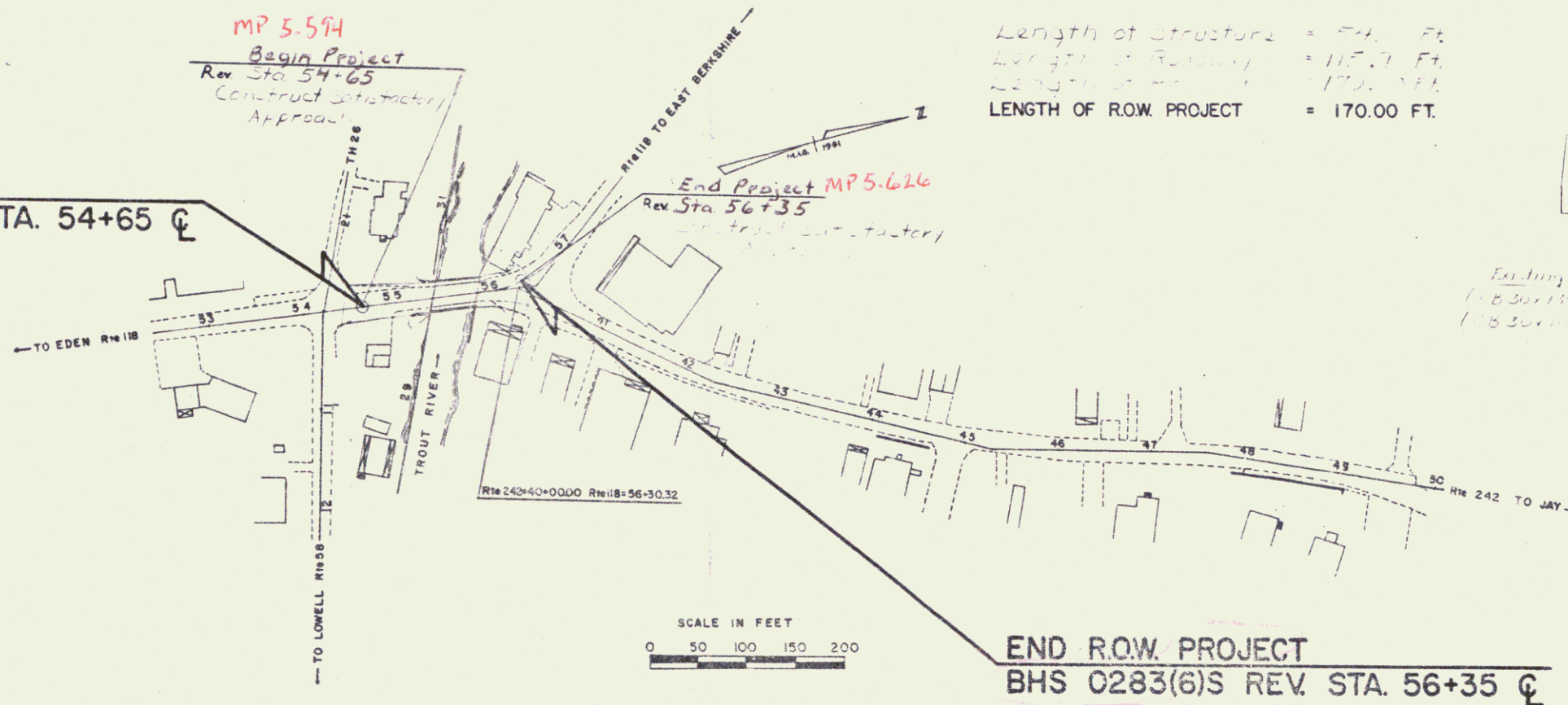

SCALE IN FEET  
0 50 100 150 200

END R.O.W. PROJECT  
BHS 0283(6)S REV. STA. 56+35

CONVENTIONAL SIGNS

COUNTY LINE	---
TOWN LINE	- - - -
LIMITS OF ACCESS	---X---
POINT OF ACCESS	X
FENCE LINE	=====
STONE WALL	-----
TRAVELED WAY	-----
GUARD RAIL	-----
RAILROAD	-----
SURVEY LINE	-----
CULVERT	-----
POWER POLE	○
TELEPHONE POLE	○
TREES	○
CONTROL OF ACCESS	///
PROPERTY LINE	---
R.O.W. TAKING LINE	---
SLOPE RIGHTS	○ SR ○
TOP OF CUT	○
TOE OF SLOPE	○

DATUM

VERTICAL	NGVD 1929
HORIZONTAL	N/A

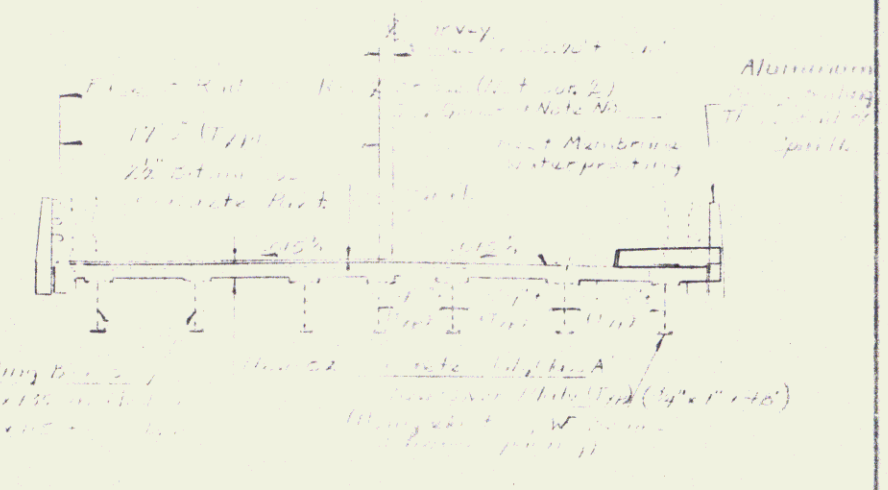

RIGHT-OF-WAY DIVISION  
TOWN FILE Pin # 78E151  
PERPETUAL Date 11/24/1989  
Town of Montgomery  
(To Be Returned To R.O.W. Division)

These plans are subject to such engineering changes as may be required by the Federal Highway Administration or the Director of Engineering and Construction.  
Construction is to be carried on in accordance with these plans and the Standard Specifications for Highway and Bridge Construction dated March, 1976, as approved by the Federal Highway Administration on October 27, 1976 for use on this project, including all subsequent revisions and such revised specifications and special provisions as are incorporated in these plans.

SUBMITTED BY ORDER OF THE STATE TRANSPORTATION BOARD
APPROVED <u>S. J. O'Neil</u> DATE <u>Nov 23 1989</u> DIRECTOR OF ENGINEERING AND CONSTRUCTION
DEPARTMENT OF TRANSPORTATION FEDERAL HIGHWAY ADMINISTRATION
APPROVED _____ DATE _____ DIVISION ADMINISTRATOR
MONTGOMERY BHS 0283(6)S SHEET 1 OF 3 SHEETS

HYDRAULIC DATA  
DRAINAGE AREA = 23.4 SQ. MI.  
Q<sub>10</sub> = 2250 CFS ; HW ELEV. = 522.7  
Q<sub>25</sub> = 3000 CFS ; HW ELEV. = 524.1  
Q<sub>50</sub> = 3600 CFS ; HW ELEV. = 525.1  
Q<sub>100</sub> = 4500 CFS ; HW ELEV. = 526.5  
TAILWATER ELEVATION @ Q<sub>100</sub> = 504.62  
VELOCITY THROUGH BRIDGE @ Q<sub>100</sub> = 9.0 FPS