

INDEX OF SHEETS

1	TITLE SHEET
2 - 4	TYPICAL SECTIONS OF IMPROVEMENT
5	PLATE PIPE ARCH DETAIL
6, 7	ALPHABETICAL INDEX OF OWNERS
8 - 35	RIGHT-OF-WAY DETAIL SHEETS
36 - 50	ROADWAY PLANS & PROFILES

STATE OF VERMONT  
AGENCY OF TRANSPORTATION



RURAL PROJECT  
PROPOSED IMPROVEMENT

TOWN OF TROY

COUNTY OF ORLEANS

ROUTE 101  
R.O.W. PLANS

LENGTH OF PROJECT = 21,465.02' FT. = 4.065 MI.  
LENGTH OF PROJECT = 21,465.02' FT. = 4.065 MI.  
LENGTH OF R.O.W. PROJECT = 21,529.39' FT. = 4.076 MI.

WORK DESCRIPTION  
WORK TO BE PERFORMED UNDER THIS PROJECT INCLUDES GRADING, DRAINAGE, SUBBASE AND PAVEMENT FOR A STATE HIGHWAY GENERALLY ALONG EXISTING ALIGNMENT.

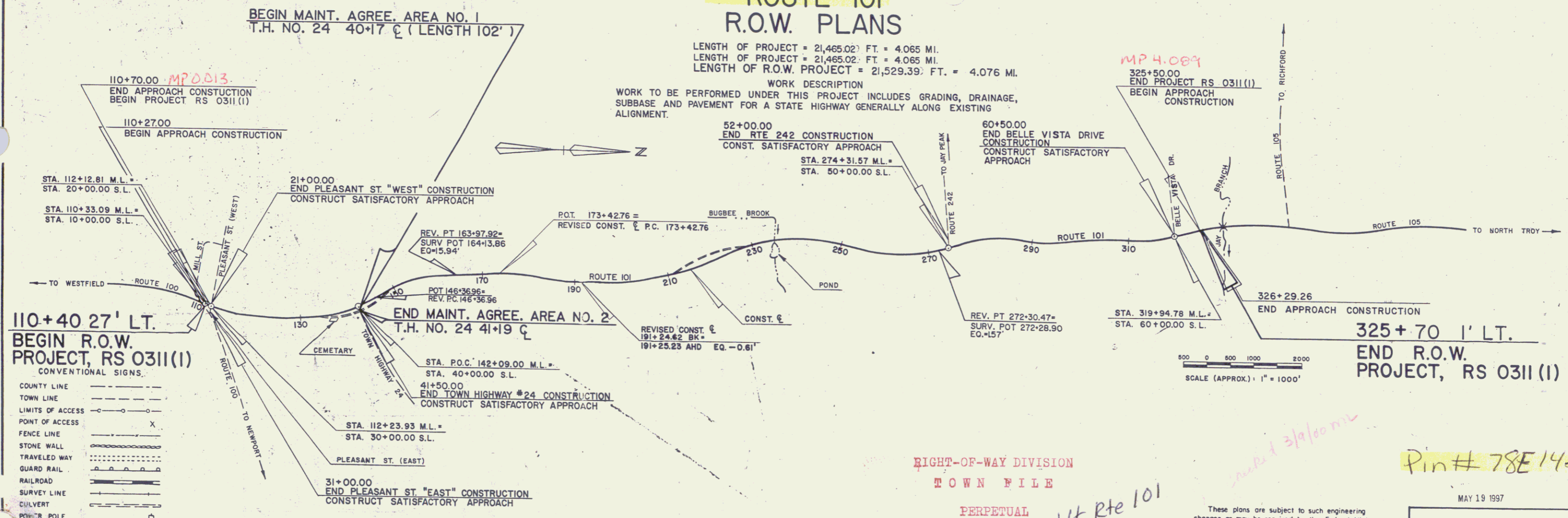
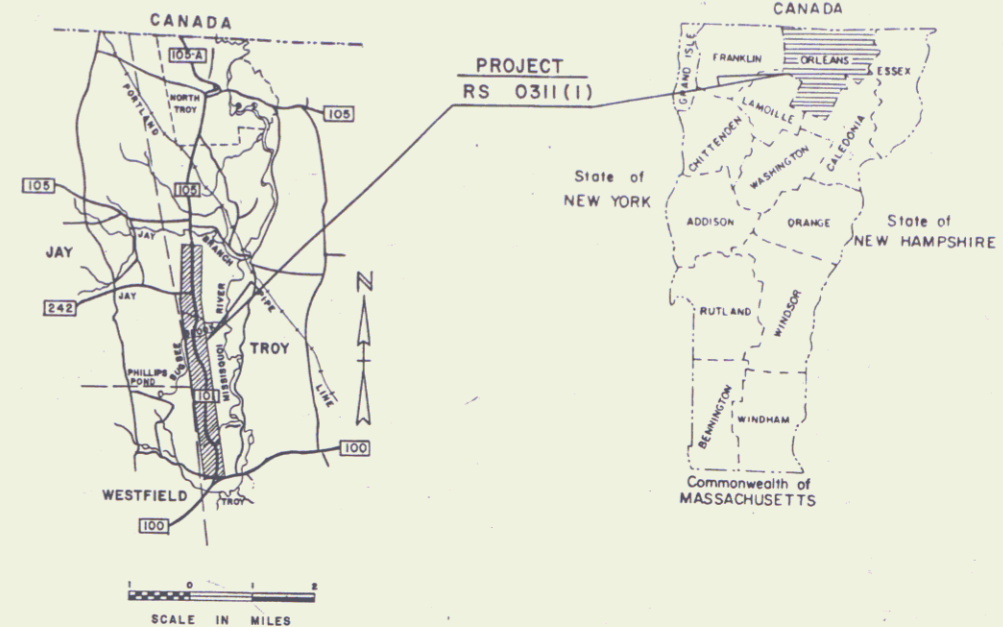

110+40 27' LT.  
BEGIN R.O.W. PROJECT, RS 0311(1)  
CONVENTIONAL SIGNS.

- COUNTY LINE
- TOWN LINE
- LIMITS OF ACCESS
- POINT OF ACCESS
- FENCE LINE
- STONE WALL
- TRAVELED WAY
- GUARD RAIL
- RAILROAD
- SURVEY LINE
- CULVERT
- POLE
- POLE
- TELEPHONE POLE
- TREES
- CONTROL OF ACCESS
- PROPERTY LINE
- R.O.W. TAKING LINE
- SLOPE RIGHTS
- TOP OF CUT
- TOE OF SLOPE

DATUM NATIONAL GEODETIC  
VERTICAL VERTICAL DATUM 1929  
HORIZONTAL VT. STATE COORDINATE SYSTEM

PLANS PREPARED BY  
WEBSTER-MARTIN, INC.  
SOUTH BURLINGTON, VERMONT.  
By Robert A. Clayton



RIGHT-OF-WAY DIVISION  
TOWN FILE  
PERPETUAL  
Town of TROY  
(To Be Returned To R.O.W. Division)

MM 0000 - MM 0408

These plans are subject to such engineering changes as may be required by the Federal Highway Admin. or the Director of Engineering & Construction. Construction is to be carried on in accordance with these plans and the Standard Specifications for Highway and Bridge Construction dated March, 1976, as approved by the Federal Highway Administration on October 27, 1976 for use on this project, including all subsequent revisions and such revised specifications and special provisions as are incorporated in these plans.

Pin # 78E142

MAY 19 1997

APPROVED: *Walter F. [Signature]* DATE: 3/24/97  
Acting Dir., Dept. of Planning & Preconstruction

APPROVED: \_\_\_\_\_ DATE: \_\_\_\_\_  
Chief, Property Administration

TROY  
RS 0311 (1)  
SHEET 1 OF 50