

INDEX OF SHEETS
WILMINGTON

1. Title Page	
2. Typical Sections	
3. Particulars, Drainage & Quantity Sheet	
4. Plan Profile Sheet	
5. Blank	
6. B-1: Banking Tables	12-43-11
7. B-2: Embankment on Earth Slope	12-43-11
8. B-3: Use of Underdrain with Shattered Rock Subgrade	12-12-74 R
9. D-2: C.R.M. Roadways	2-28-72 R
10. D-4: Reinforced Concrete Drop Inlet w/Grate	4-24-73
11. E-2: Road Construction Approach Signs	5-14-75 R
12. G-1: Guard Rail, 10x6 Steel Beam with Steel Posts, Type II	6-04-74 R
13. G-2: Guard Rail, 10x6 Steel Beam with Steel Posts, Type I (Approach End Detail) B-23-76 R	
14. Blank	
15-16. Cross Sections	

STATE OF VERMONT
DEPARTMENT OF HIGHWAYS



PROPOSED IMPROVEMENT

TOWN OF WILMINGTON
COUNTY OF WINDHAM
VERMONT ROUTE 100

BEGINNING AT A POINT 2.910 MILES NORTHEASTERLY
OF THE INTERSECTION OF VERMONT ROUTE 9 WITH VERMONT
ROUTE 100 AND EXTENDING NORTHEASTERLY 0.152 MILES.

LENGTH OF ROADWAY	800.00	FT. = 0.152 MI.
LENGTH OF PROJECT	800.00	FT. = 0.152 MI.
LENGTH OF ROW PROJ.	1246.63	FT. = 0.236 MI.

ADT 1975	3,070
DHV 1975	425
D	55
T	5
V	40 MPH
ACCIDENTS ('69-'70)	4

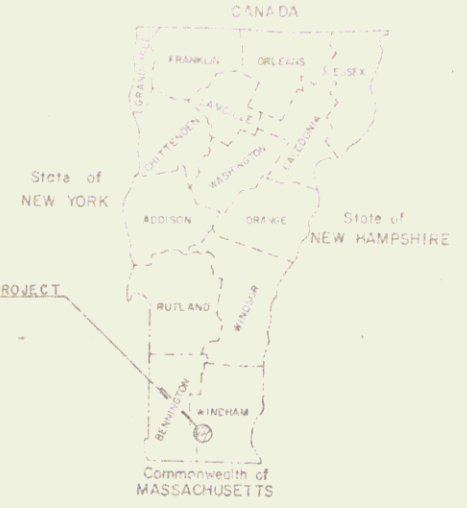

*Resurvey 1964
According to
Booklets*

R.O.W. PLANS

BEGIN R.O.W. PROJ. HES-ROS 013-1(4)S
STA. REV. 284+00 C

END R.O.W. PROJ. HES-ROS 013-1(4)S
STA. 296+50 C

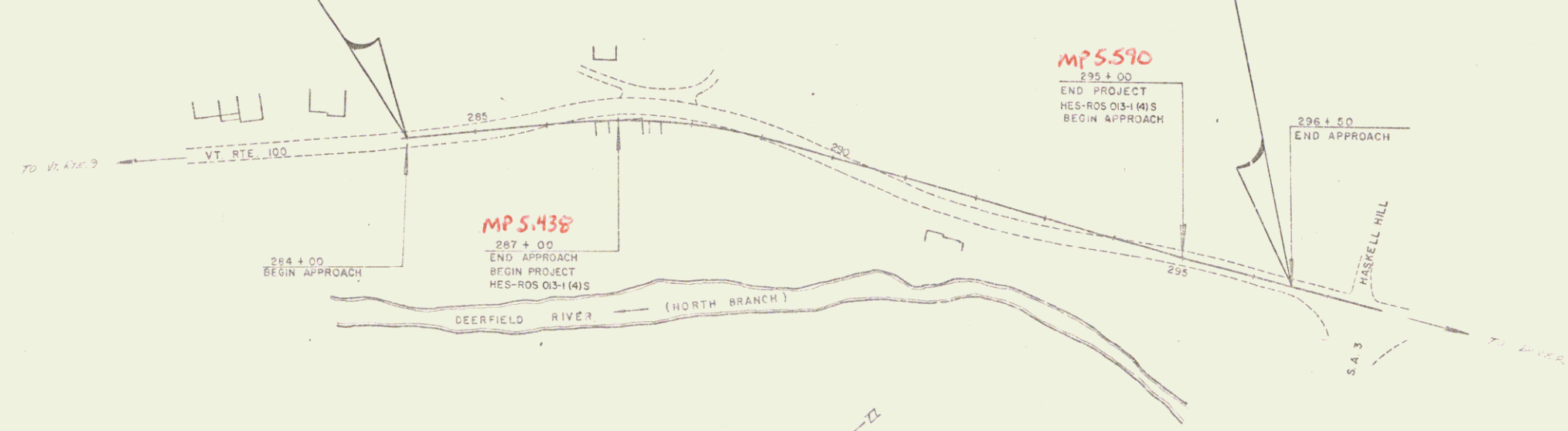

*DATE: 10/18/1976
PIN: 780323*

CONVENTIONAL SIGNS

COUNTY LINE	---
TOWN LINE	---
LIMIT OF ACCESS	---
POINT OF ACCESS	X
FENCE LINE	---
STONE WALL	---
TRAVELLED WAY	---
GUARD RAIL	---
RAILROAD	---
SURVEY LINE	---
CULVERT	---
POWER POLE	○
TELEPHONE POLE	○
TREES	○
ROADS' IDENTIFICATION SIGNS	△
WIRELESS LINE	---
ROW TAKING LINE	---
SLOPE SIGNS	---
TOP OF CUT	---
TOE OF SLOPE	---

RIGHT-OF-WAY DIVISION
TOWN FILE
PERPETUAL
Town of Wt 100
(To Be Returned To R.O.W. Division)

These plans are subject to such engineering changes as may be required by the Federal Highway Administration or the Chief Engineer. Construction is to be carried on in accordance with these plans and the Standard Specifications for Highway and Bridge Construction dated January 3, 1972 as approved by the Federal Highway Administration on December 22, 1971 for use on this project, including all subsequent revisions and such revised specifications and special provisions as are incorporated in these plans.

APPROVED _____
DIRECTOR OF R.O.W.
DATE _____

DEC 21 1981
PROJECT PROCESSED UNDER
SECONDARY ROAD PLAN

SUBMITTED BY ORDER OF THE STATE HIGHWAY BOARD	
APPROVED <i>E. H. Sedgwick</i> DATE 6-8-76	CHEF ENGINEER
DEPARTMENT OF TRANSPORTATION FEDERAL HIGHWAY ADMINISTRATION	
APPROVED _____	DIVISION ENGINEER
PROJECT HES-ROS 013-1(4)S	
SHEET 1 OF 5 SHEETS	
D-10 SRR 12/17/73	

STATE OF VERMONT
DEPARTMENT OF HIGHWAYS
RIGHT-OF-WAY PLANS
DETAIL SHEET

TABLE OF PROJECT PROPERTY ACQUISITION

PARCEL NO.	GRANTOR	SHEET NO.	BEGINNING STATION	ENDING STATION	TAKING	REM	RIGHTS	TITLE TAKEN	DATE	TOWN OR CITY RECORDED	BK.	PG.	REMARKS		
1A	MAY, OLIVE M.	4	REV. 285+43RT.	REV. 289+83RT.	0.12A±	2.8A±		CONDEMN	4-23-80	WILMINGTON	83	116			
			REV. 285+47RT.	REV. 286+68RT.			CONST. EASE. (T) 0.03A±							1000 S.F.±	
			REV. 285+45RT.	REV. 286+07RT.			SLOPE (T) 0.02A±							780 S.F.±	
			REV. 286+65RT.	REV. 288+28RT.			SLOPE (T) 0.04A±							1825 S.F.±	
			REV. 286+68RT.	REV. 287+60RT.			ALL R.T. & L.							SHED, BARN & SHED	
			REV. 286+68RT.	REV. 287+80RT.			CONST. EASE. (T) 0.08A±							3600 S.F.± (FOR REMOVAL OF BUILDINGS)	
			REV. 288+15LT.	REV. 288+60RT.			INSTALL & MAINTAIN (P)							WATER LINE SLEEVE	
			REV. 288+50RT.				DRIVE (T)							17' GRAVEL N.P. 0546	
							DRIVE RELEASE DATE:							DRIVE PERMIT DATE:	
							REV. 289+65RT.	REV. 290+45RT.			SLOPE (T) 0.01A±				425 S.F.±
1B		4	REV. 287+62LT.	REV. 290+20LT.	0.12A±	3.34A±									
			REV. 287+66LT.				DRIVE (T)							14' GRAVEL N.P. 0545	
													DRIVE RELEASE DATE:		
													DRIVE PERMIT DATE:		
													STONE WALL & STEPS		
2	BROOKS, DOUGLAS M. & JOYCE J.	4	REV. 284+55LT.	REV. 285+69LT.				CONDEMN	4-23-80	WILMINGTON	83	116			
			REV. 284+75LT.	REV. 285+55LT.			CONST. EASE. (T) 0.03A±							1100 S.F.±	
													875 S.F.±		
3	BROOKS, FRANK W. & ELAINE M.	4	REV. 285+80LT.	REV. 286+65LT.						WILMINGTON					
			REV. 287+13LT.				DRIVE (T)							STONE WALL	
													12' GRAVEL N.P. 0544		
													DRIVE RELEASE DATE:		
													DRIVE PERMIT DATE:		
4A	BATCHELDER, EDITH CHASE	4	REV. 290+18LT.	REV. 293+56LT.	0.4A±	2.5A±		CONDEMN	4-23-80	WILMINGTON	83	116			
			REV. 291+00LT.	REV. 291+40LT.										STONE WALL	
													HEN HOUSE		
4B		4	REV. 290+80RT.	REV. 291+03RT.											
			REV. 292+88RT.				DITCH & DRAINAGE (P)							BY OPTION ONLY	
													16' GRAVEL N.P. 0555		
													DRIVE RELEASE DATE:		
													DRIVE PERMIT DATE:		

TABLE OF REVISIONS

REVISION NO.	SHEET NO.	DESCRIPTION OF REVISION	DATE	MADE BY	APPROVED BY
1	3A,4	PARCEL # 6 - CHASE: ADDED CONST. LIMITS & TEMPORARY DRIVE P. AT STA. 295+28 LT. PER C.O. # 4621	2-7-80	NBB	T.P.M.
2	3	Parcel # 6 - Batchelder: added "BY OPTION ONLY" for DITCH & DRAINAGE To detail sheet per C.O. # 4546	3-19-80	NBB	T.P.M.
3	3	Parcel # 1 - May: added "BY OPTION ONLY" for DITCH & DRAINAGE To detail sheet per C.O. # 4346	3-19-80	NBB	T.P.M.
4	3W	PARCEL # 1A MAY, OLIVE M. CHANGED DRIVE FROM STA. 289+45 TO STA. 288+50 PER REVISED DESIGN (C.O. # 4666)	3-31-80	DM	T.P.M.
5	3,4	PARCEL # 1A MAY, OLIVE M. MOVED CULVERT TO REV. STA. 280+91. REMOVED DIT. (DR. RT. PER REVISED DESIGN (C.O. # 4705)	5-1-80	DM	T.P.M.
6	3A,4	PARCEL # 6 - CHANGED CULVERT & DITCH (C) AT REV. STA. 294+75 LT. - REV. STA. 294+93 LT. TO DITCH (P) AT REV. STA. 294+80 LT. DELETED DRIVE RIGHT (T) AT STA. 295+18 LT. PER C.O. # 4706	5-15-80	NBB	T.P.M.
7	3,3A, 4,5	PARCELS # 1A & # 9 - REVISED 1/4 TO REV. STA. 295+45 RT. ADJUSTED TAKES, SLOPE RIGHTS & CONSTRUCTION EASEMENTS ACCORDINGLY. PER C.O. # 4718	5-15-80	NBB	T.P.M.
8	3,3A, 4	REVISED CULVERT & DRAINAGE AT REV. STA. 295+00 RT. TO OUTLET AT REV. STA. 295+22 RT. DELETED THE RIGHT FROM PARCEL # 1A AND ADDED IT TO PARCEL # 9 PER C.O. # 4719	5-15-80	NBB	T.P.M.
9	3A,4	PARCEL # 9 GARRON, ADDED DRAINAGE (P), DRIVE (T) & REVISED CONST. EASE. AREA PER C.O. # 4752	6-19-80	DM	T.P.M.

MADE BY: NBB DATE: 11-14-79
CHECKED BY: NBB DATE: 11-14-79

DR. RT. -- DRAINAGE RIGHT
DT. RT. -- DITCHING RIGHT
CH. RT. -- CHANNEL RIGHT
DRIVE RT. -- DRIVE RIGHT
CUL. RT. -- CULVERT RIGHT
⊙ -- DEMOLITION OR REMOVAL
⊠ -- WATER SOURCES

----- PRESENT R.O.W.
--- TAKING WITHOUT ACCESS
--- TAKING WITHOUT ACCESS ALONG PROPERTY LINES
--- TAKING WITH ACCESS
(P) PERMANENT EASEMENT
(T) TEMPORARY EASEMENT

LEGEND
--- CONST. EASE. --- CONST. EASEMENT
SR --- SR --- SLOPE RIGHTS
P --- P --- PROPERTY LINE
--- Δ --- Δ --- TOP OF CUT
--- ○ --- ○ --- TOE OF SLOPE

APPROVED: *Thomas V. Wagon* DATE: 11-20-79
CHIEF OF PLANS & TITLES

DEC 21 1981

PROJECT: WILMINGTON

NO. HES-BOC Q13-1415

SHEET 3 OF 5

ROW

2

STATE OF VERMONT
DEPARTMENT OF HIGHWAYS
RIGHT-OF-WAY PLANS
DETAIL SHEET

TABLE OF PROJECT PROPERTY ACQUISITION

PARCEL NO.	GRANTOR	SHEET NO.	BEGINNING STATION	ENDING STATION	TAKING	REM.	RIGHTS	TITLE TAKEN	DATE	TOWN OR CITY RECORDED	BK	PG	REMARKS
5	MAHONEY, DANIEL	4	REV. 293+25 RT.	296+50 RT.	0.1A±	1.5A±		CONDEMN.	4-23-80	WILMINGTON	83	116	
6	CHASE, ROLAND L. & SHIRLEY M.	4	REV. 293+46 LT. REV. 294+80 LT.	REV. 294+23 LT.	0.02A±	2.97A±	DITCH (P)	CONDEMN.	4-23-80	WILMINGTON	83	116	1000 S.F.±
7	NEW ENGLAND TELEPHONE & TELEGRAPH CO.												UTILITY
8	GREEN MOUNTAIN POWER CORP.												UTILITY
9	GAGNON, YVONNE L.	4	REV. 284+70 RT. REV. 285+07 RT. REV. 285+15 RT. REV. 285+22 RT. 282+47 RT. REV. 285+00 RT.	REV. 285+45 RT. REV. 285+50 RT. REV. 285+47 RT. REV. 285+30 RT.	0.01A±		CONST. EASE. (T) 0.01A± SLOPE (T) 270 S.F.± CULVERT & DRAINAGE (P) DRAINAGE (P) DRIVE (T)	WDOE	7-16-80	WILMINGTON	83	439	130 S.F.± 350 S.F.± 16' GRAVEL W.P. 0480 DRIVE RELEASE DATE DRIVE PERMIT DATE

TABLE OF REVISIONS

REVISION NO.	SHEET NO.	DESCRIPTION OF REVISION	DATE	MADE BY	APPROVED BY

MADE BY: NBB DATE 11-14-79
CHECKED BY: WBL DATE 4-18-79

DR RT - DRAINAGE RIGHT
DT RT - DITCHING RIGHT
CH RT - CHANNEL RIGHT
DRIVE RT - DRIVE RIGHT
CLL RT - CULVERT RIGHT
⊙ - DEMOLITION OR REMOVAL
□ - WATER SOURCES

————— PRESENT R.O.W.
/// ——— TAKING WITHOUT ACCESS
/// ——— TAKING WITHOUT ACCESS ALONG PROPERTY LINES
————— TAKING WITH ACCESS
(P) PERMANENT EASEMENT
(T) TEMPORARY EASEMENT

LEGEND
——— CONST. EASE. ——— CONST. EASEMENT
——— SR ——— SR ——— SLOPE RIGHTS
——— P ——— P ——— PROPERTY LINE
——— Δ ——— Δ ——— TOP OF CUT
——— ○ ——— ○ ——— TCE OF SLOPE

APPROVED Thomas J. Mans DATE 11-20-79
CHIEF OF PLANS & TITLES

DEC 21 1981
PROJECT WILMINGTON
NO. HES-RCS 013-1(4)S
SHEET 3A OF 5

BEGIN ROW. PROJECT HES-ROS 013-1(4)S STA. REV. 284+00 CL

END ROW. PROJECT HES-ROS 013-1(4)S STA. 296+50 CL

GUARD RAIL STD. STEEL BEAM w/ STEEL POSTS TYPE II

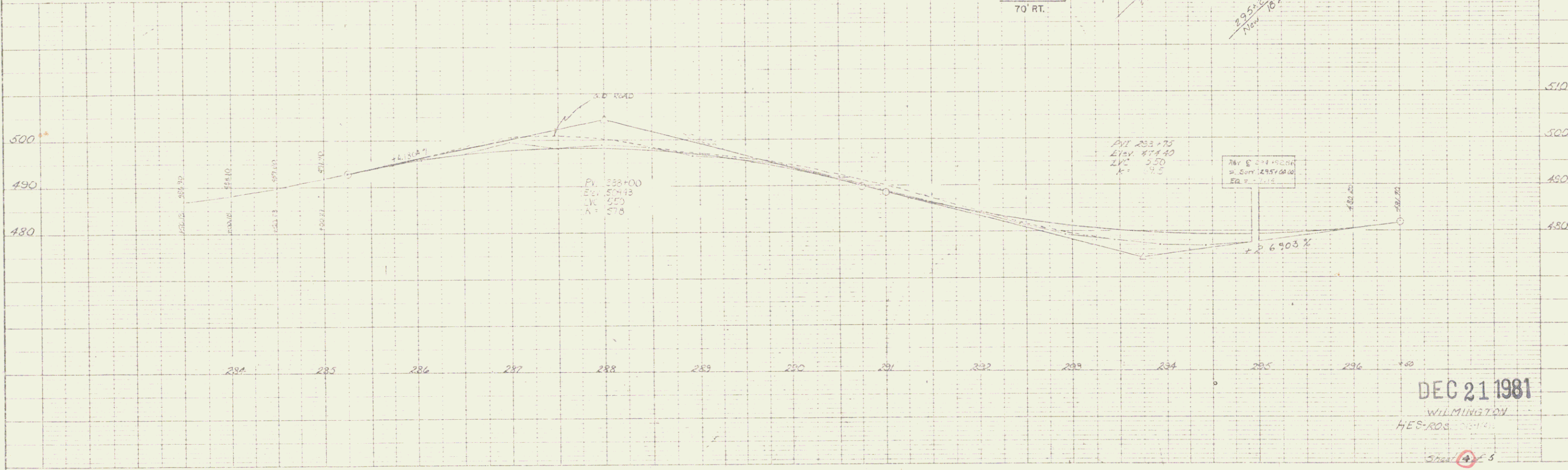
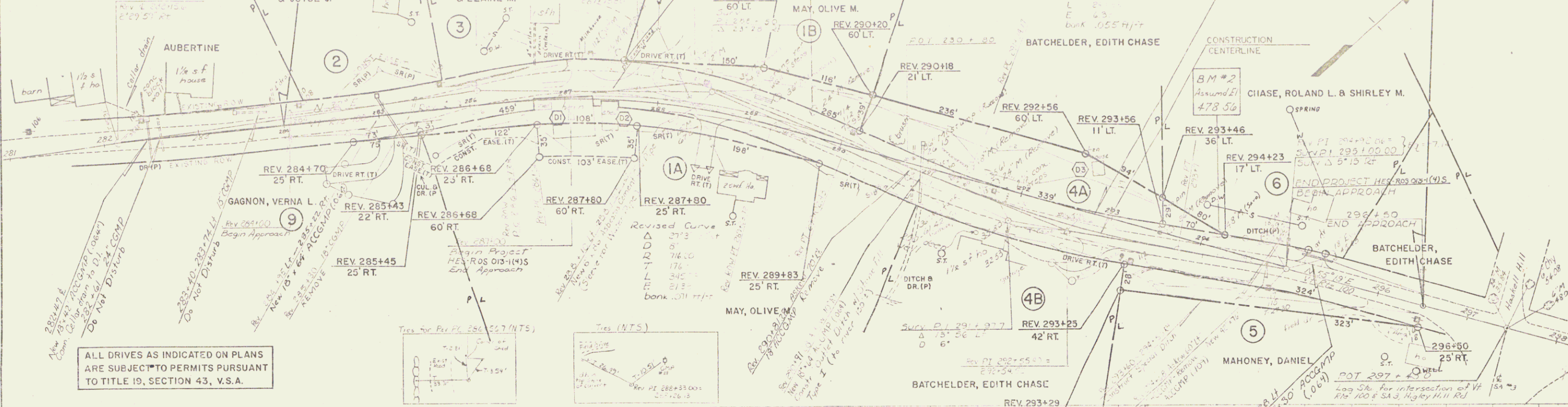

1-K-E PLATE 1, PLAN/PROFILE

