

CURVE CN2		CURVE RI	
Δ = 91°06'59.6" LT.	R. = 468.400m	Δ = 84°46'06.2" RT.	R. = 70.000m
T. = 477.618m	L. = 744.889m	T. = 63.883m	L. = 103.564m
E. = 200.568m	BANK = 0.069	E. = 24.769m	BANK = 0.060
LS = 61.177m	PI STA. CN 2+187.929	PI STA. RI+528.649	N = 45318.1042
OS = 3°44'29.9"	N = 442872.3761	N = 45318.1042	E = 442458.0418
TS = 575.534m	TS N = 44808.0314	PC N = 45312.5036	E = 442394.4044
Lt = 40.793m	E = 442871.3593	PT N = 45255.2425	E = 442469.4216
St = 20.400m	SC N = 44848.7459		
	E = 442873.8348		
	CS N = 45335.9968		
	E = 442394.8794		
	ST N = 45335.5370		
	E = 442374.4841		

Δ = 236°03'34.7" RT.	R. = 90.000m
T. = N/A	L. = 370.802m
E. = N/A	BANK = 0.060
PI STA. GI+396.514	N = 45179.3415
N = 45179.3415	E = 442268.2761
PC N = 45305.8601	E = 442346.1949
PCC N = 45159.4245	E = 442284.5381
PT N = 45200.7744	E = 442254.0714

CURVE HI	
Δ = 93°31'06.3" RT.	R. = 200.000m
T. = 212.675m	L. = 326.441m
E. = 91.943m	BANK = 0.060
PI STA. H I+212.675	N = 45330.8404
N = 45330.8404	E = 442166.8007
PC N = 45342.5925	E = 442379.1505
PT N = 45543.5112	E = 442168.1025

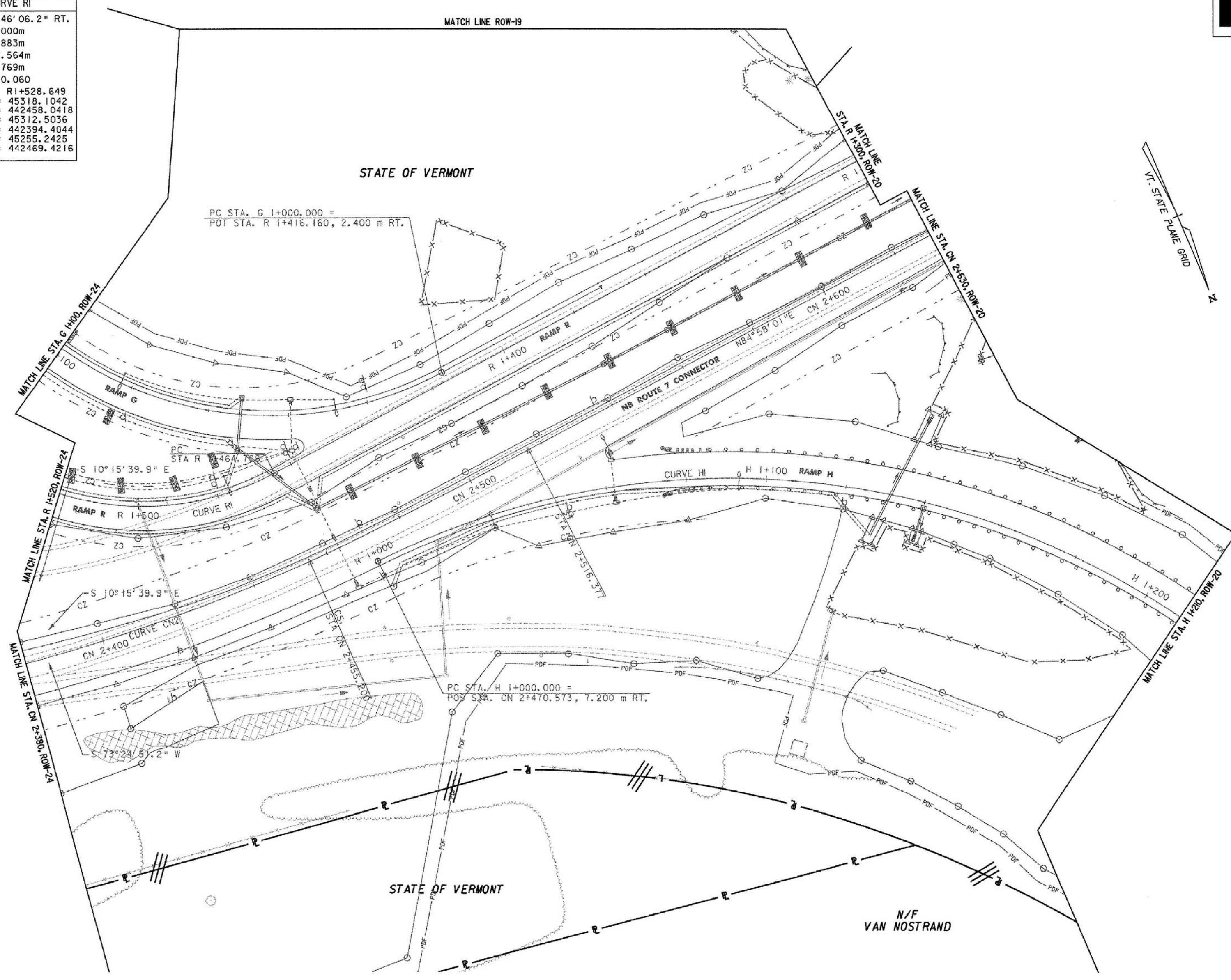

LINES SHOWN ON THIS PLAN AS EXISTING PROPERTY LINES P/L ARE BELIEVED TO BE ACCURATE BUT SHOULD NOT BE RELIED UPON FOR PURPOSES UNRELATED TO THE STATE OF VERMONT'S ACQUISITION OF LAND AND RIGHTS FOR THIS PROJECT.

THIS SHEET TO BE USED FOR RIGHT-OF-WAY INFORMATION ONLY

DATUM	
VERTICAL	NAVD 88
HORIZONTAL	NAD 83 (1992)



R.O.W. PLAN
ROW-25

PROJECT NAME: BENNINGTON BYPASS	PROJECT NUMBER: NH F019-1(5)
DESIGN FILE NAME: c:\ndh\bennington\row	PLOT DATE: 12-06-05
PROJECT LEADER: JDP	DRAWN BY: MBB
	CHECKED BY: GAK
SHEET: 97 OF 112	