

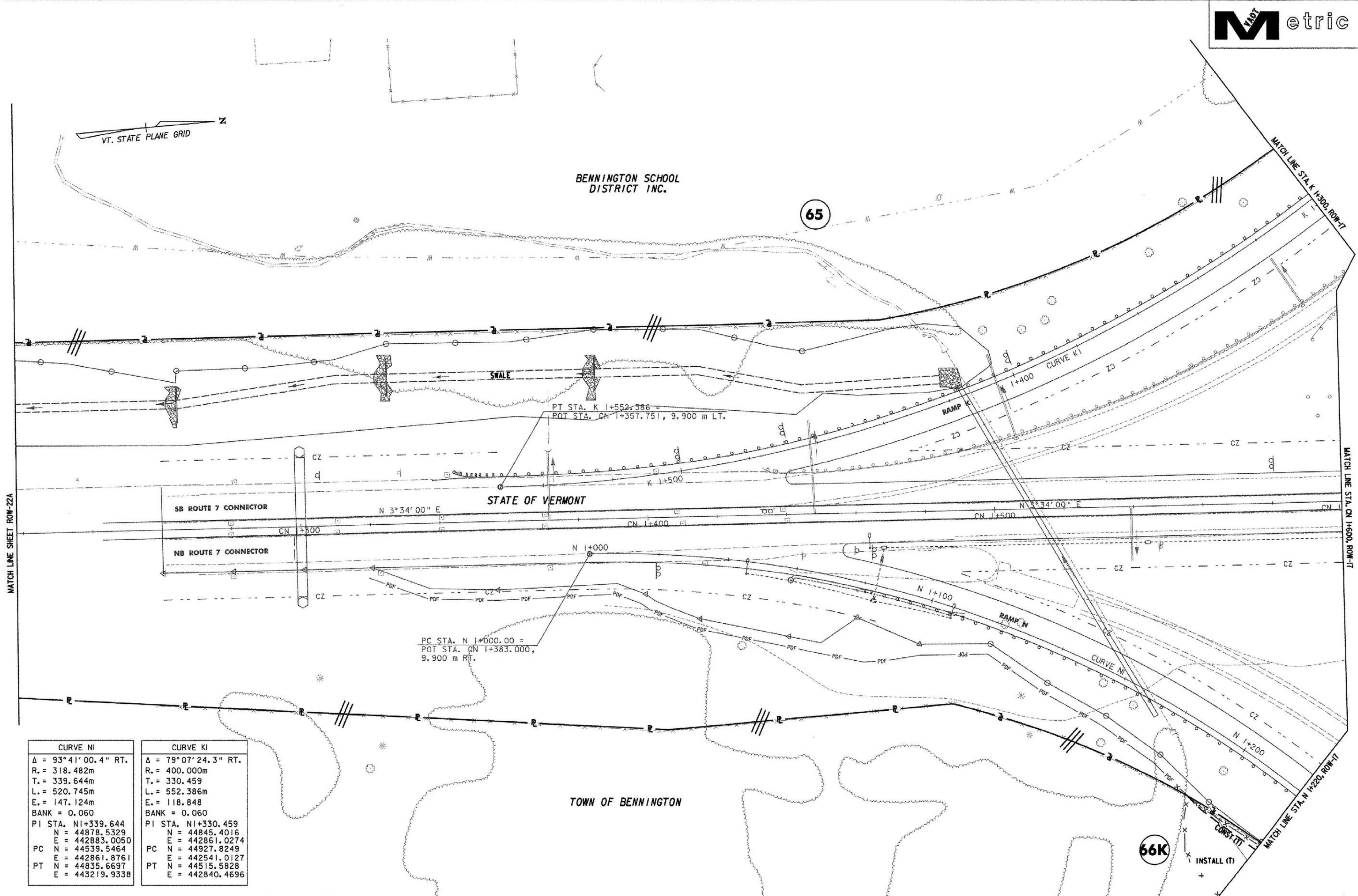

BENNINGTON SCHOOL DISTRICT INC.

65



STATE OF VERMONT

TOWN OF BENNINGTON

CURVE NI	CURVE KI
Δ = 93°41'00.4" RT.	Δ = 79°07'24.3" RT.
R. = 318.482m	R. = 400.000m
T. = 339.644m	T. = 330.459
L. = 520.745m	L. = 552.386m
E. = 147.124m	E. = 118.848
BANK = 0.060	BANK = 0.060
PI STA. N1+339.644	PI STA. N1+330.459
N = 44878.5329	N = 44845.4016
E = 442883.0050	E = 442861.0274
PC N = 44538.5464	PC N = 44927.8249
E = 442861.8761	E = 442541.0127
PT N = 44835.6697	PT N = 44515.5828
E = 443219.9338	E = 442840.4696

LINES SHOWN ON THIS PLAN AS EXISTING PROPERTY LINES P/L ARE BELIEVED TO BE ACCURATE BUT SHOULD NOT BE RELIED UPON FOR PURPOSES UNRELATED TO THE STATE OF VERMONT'S ACQUISITION OF LAND AND RIGHTS FOR THIS PROJECT.

THIS SHEET TO BE USED FOR RIGHT-OF-WAY INFORMATION ONLY

DATUM
 VERTICAL NAVD 88
 HORIZONTAL NAD 83 (1992)

0 10 20 30
 SCALE 1:500
 FULL SIZE

R.O.W. PLAN
ROW-22

PROJECT NAME: BENNINGTON BYPASS	PROJECT NUMBER: NH FO19-1(5)
DESIGN FILE NAME: c:\dh\bennington\row	PLOT DATE: 3-26-07
PROJECT LEADER: JDP	DRAWN BY: MBB
	CHECKED BY: GAK
	SHEET: 94 OF 112