

RIGHT - OF - WAY DETAIL SHEET

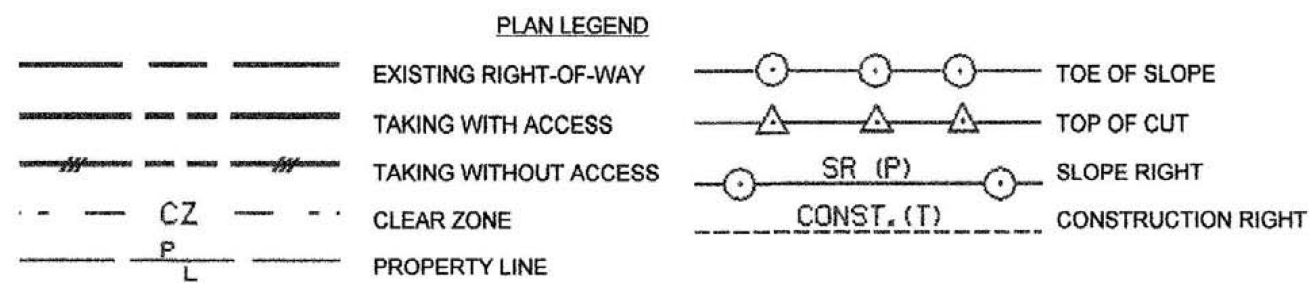

TABLE OF PROPERTY ACQUISITION

PARCEL NO.	PROPERTY OWNER	SHEET NO.	BEGINNING STATION	ENDING STATION	TAKE	REMAINDER	RIGHT			RECORDING DATA				REMARKS	
					AREA ±	AREA ±	TYPE	(T)/(P)	AREA ±	TITLE	DATE	TOWN / CITY	BOOK		PAGE
1A	STATE OF VERMONT	4,AA	NB 5+651.03 LT	NB 5+764.19 LT						WD	10/12/2001	BENNINGTON	375	155	FORMERLY RACICOT, SELINA M.
1B		4,AA	NB 5+750.00 LT	NB 5+772.02 LT			ALL R, T, & I								HWY EASE TH 504
2A	STATE OF VERMONT	4,AA	NB 5+681.15 LT	NB 5+750.00 LT						WD	10/29/2003	BENNINGTON	402	105	FORMERLY VANDER RIET, DEBORAH K.
2B		4,AA	NB 5+739.01 LT	NB 5+757.83 LT			ALL R, T, & I								HWY EASE TH 504
3	NOT USED														
4	NOT USED														
5A	STATE OF VERMONT	4,5,AA	NB 5+746.94 RT	NB 5+811.50 RT						WD	10/2/2001	BENNINGTON	375	69	FORMERLY PURDY, ROBERT
5B		4,AA	NB 5+739.52 RT	NB 5+756.43 RT			ALL R, T, & I								HWY EASE TH 504
6A	STATE OF VERMONT	4,5,AA	NB 5+756.43 RT	NB 5+815.56 LT						WD	9/11/2001	BENNINGTON	374	142	FORMERLY GATES, WINFIELD P. SR. & ISABELLE E.
6B		4,AA	NB 5+749.02 CL	NB 5+765.69 LT			ALL R, T, & I								HWY EASE TH 504
7A	STATE OF VERMONT	4,5,AA	NB 5+765.69 LT	NB 5+822.20 LT						WD	1/10/2002	BENNINGTON	378	126	FORMERLY SMITH, TIMOTHY D.
7B		4,AA	NB 5+757.83 LT	NB 5+796.34 LT			ALL R, T, & I								HWY EASE TH 504
8A	STATE OF VERMONT	4,5,AA	NB 5+788.34 LT	NB 5+917.00 LT						WD	9/18/2001	BENNINGTON	374	188	FORMERLY KNAPP, ELLEN G.
8B		4,5,AA	NB 5+778.36 LT	NB 5+802.45 LT			ALL R, T, & I								HWY EASE TH 504
9A	STATE OF VERMONT	12,EE	NB 8+293.75 RT	NB 8+347.37 RT	0.082± HA					WD	5/11/2004	BENNINGTON	406	137	0.20± A LIMITED ACCESS FORMERLY PARK, JASON E. & TRACY D.
9B		12,EE	NB 8+184.64 RT	NB 8+355.67 RT	4.0± HA										9.8± A
9C		12,EE	NB 8+337.50 RT	NB 8+381.97 RT	0.046± HA		ALL R, T, & I								0.11± A HWY EASE TH 16
				TOTAL	4.128± HA										10.11± A
10A	STATE OF VERMONT	28,31, AA	VT 1+379.62 RT	VT 1+413.12 RT	0.17± HA					WD	10/21/2003	BENNINGTON	402	29	0.42± A FORMERLY LONG, ROBERT B. & KATHERINE B.
10B		28,AA	VT 1+392.62 RT	VT 1+413.74 RT	0.015± HA		ALL R, T, & I								1614± SF HWY EASE TH 2 / VT RTE 9
				TOTAL	0.185± HA										0.46± A
11A	STATE OF VERMONT	28,31, 32,AA	VT 1+405.21 RT	VT 1+471.65 RT	0.42± HA					WD	9/17/2005	BENNINGTON	424	157	1.0± A FORMERLY FENDLER, REED H.
11B		28,AA	VT 1+413.12 RT	VT 1+474.15 RT	0.045± HA		ALL R, T, & I								0.11± A HWY EASE TH 2 / VT RTE 9
				TOTAL	0.465± HA										1.11± A

TABLE OF REVISIONS

REVISION NO.	SHEET NO.	DESCRIPTION	DATE
1	56,99	PARCEL NO. 17 THOMAYER. REVISED TAKE LINE ON ROW SHEET 27 (99 OF 112) AND DETAIL SHEET 2 (56 OF 112) PER C.O. 9453	6/5/06
2	57,70	PARCEL NO. 21 CENTRAL VERMONT PUBLIC SERVICE CORPORATION. REVISED TAKE LINE ON ROW SHEET 6 (70 OF 112) AND DETAIL SHEET 3 (67 OF 112) PER C.O. 9454	6/5/06
3	59,102	PARCEL NO. 40 SHERMAN. CHANGED TAKE TO EASEMENT(P) ROW SHEET 30 (102 OF 112) AND DETAIL SHEET 5 (59 OF 112) PER C.O. 9455	6/5/06
4	60,76	PARCEL NO. 48 JEPSON. REVISED PROPERTY LINE PER PROUTY SURVEY ON ROW SHEET 9 (76 OF 112) AND ADJUSTED CONST(T) AND DIT&DR(P) ON DETAIL SHEET 6 (60 OF 112) PER C.O. 9463	7/12/06
5	60,76	PARCEL NO. 49 PROUTY. REVISED PROPERTY LINE PER PROUTY SURVEY ON ROW SHEET 9 (76 OF 112) AND ADJUSTED CONST(T) AND DIT&DR(P) ON DETAIL SHEET 6 (60 OF 112) PER C.O. 9464	7/12/06
6	62,88, 94	PARCEL NO. 65 BENNINGTON SCHOOL DISTRICT, INC. DRAINAGE DESIGN CHANGED ON ROW SHEET 17 (88 OF 112) AND ROW SHEET 22 (94 OF 112). REVISED CONST(T), SR(P), AND ELIMINATED DIT&DR(P), CUL(P), AND LANDSCAPE(T) ON DETAIL SHEET 8 (62 OF 112) PER C.O. 9469	7/12/06
7	54, 57, 99, 100, 104	PARCEL NO. 26 NILES. OWNERS ARE MELODY V. NILES & MARK J. NILES. CHANGE OF NAME ISSUED BY BENNINGTON PROBATE COURT DATED 1/23/02. REVISED NAME ON ROW SHEET 5-A (68 OF 112), ROW SHEET 28 (100 OF 112), ROW SHEET 32 (104 OF 112), ALPHABETICAL INDEX #1 (54 OF 112) AND DETAIL SHEET 3 (57 OF 112) PER C.O. 9470	07/26/06
8	62, 86	PARCEL NO. 60 HOOD. REVISED LOCATION OF DRIVE AND DRIVE CULVERT ON ROW SHEET 15 (86 OF 112) AND REVISED STATIONS OF DRIVE(T) AND CUL(T) ON DETAIL SHEET 8 (62 OF 112) PER C.O. 9483	1/17/07
9	54, 69, 69-76, 80, 82, 84, 106	PARCEL NO. 44 VT TRANSCO LLC. NAME CHANGED FROM VERMONT ELECTRIC POWER COMPANY, INC. (VELCO) TO VERMONT TRANSCO LLC (VT TRANSCO). NAME CHANGED ON ALPHABETICAL INDEX #1 (54 OF 112), DETAIL SHEET 5 (59 OF 112), ROW SHEETS 5A-10 (69-76 OF 112), ROW SHEET 11 (80 OF 112), ROW SHEET 12 (82 OF 112), ROW SHEET 13 (84 OF 112), AND ROW SHEET AA (106 OF 112) PER C.O. 9487	3/8/07
10	54, 56, 99, 103, 106	PARCEL NO. 16 KIPP. NAME CHANGED FROM MAXFIELD, GARTH & SARAH TO KIPP, BRENT & RACHEL ON ALPHABETICAL INDEX #1 (54 OF 112), DETAIL SHEET 2 (56 OF 112), ROW SHEET 27 (99 OF 112), ROW SHEET 31 (103 OF 112) AND ROW SHEET AA (106 OF 112) PER C.O. 9488	3/12/07
11	54, 56, 99, 106	PARCEL NO. 17 THOMAYER. NAME CHANGED FROM THOMAYER, HENRY & HAMILTON, CYNTHIA TO THOMAYER, HENRY & CYNTHIA (FORMERLY KNOWN AS CYNTHIA HAMILTON) ON ALPHABETICAL INDEX #1 (54 OF 112), DETAIL SHEET 2 (56 OF 112), ROW SHEET 27 (99 OF 112) AND ROW SHEET AA (106 OF 112) PER C.O. 9489	3/12/07
12	54, 57, 99, 100	PARCEL NO. 22 SLEEMAN. NAME CHANGED FROM SLEEMAN, RICHARD TO SLEEMAN, RICHARD A. ESTATE ON ALPHABETICAL INDEX #1 (54 OF 112), DETAIL SHEET 3 (57 OF 112), ROW SHEET 27 (99 OF 112) AND ROW SHEET 28 (100 OF 112) PER C.O. 9490	3/12/07
13	54, 57, 82, 83, 109, 110	PARCEL NO. 23 WATSON. NAME CHANGED FROM WATSON, RALPH E. & CYNTHIA W. TO WATSON, CYNTHIA W. ON ALPHABETICAL INDEX #1 (54 OF 112), DETAIL SHEET 3 (57 OF 112), ROW SHEET 12 (82 OF 112), ROW SHEET 12A (83 OF 112), ROW SHEET DD (109 OF 112), AND ROW SHEET EE (110 OF 112) PER C.O. 9491	3/12/07
14	54, 69, 100, 101, 102	PARCEL NO. 42 SLEEMAN. NAME CHANGED FROM SLEEMAN, RICHARD A. & ISABELL R. TO SLEEMAN, ISABELL R. ON ALPHABETICAL INDEX #1 (54 OF 112), DETAIL SHEET 5 (59 OF 112), ROW SHEET 28 (100 OF 112), ROW SHEET 29 (101 OF 112) AND ROW SHEET 30 (102 OF 112) PER C.O. 9492	3/12/07
15	59	PARCEL NO. 44 VERMONT TRANSCO LLC. REMOVED "BY OPTION ONLY" - ALL R, T, & I TO UTILITY EASEMENT AT NB 8+174.51 LT TO NB 8+297.8 LT ON DETAIL SHEET 5 (59 OF 112) PER C.O. 9493	3/12/07



APPROVED: ROGER P. DUMAS DATE: 12-07-05
CHIEF, PLANS & TITLES

PROJECT NAME: **Bennington**
PROJECT NUMBER: **NH F019-1(5)**
FILE NAME: **NORTH.XLS** PLOT DATE: **4/8/07**
PROJECT LEADER: **VSE** DRAWN BY: **GAK**
DESIGNED BY: **D-H** CHECKED BY: **JDP**
R.O.W. DETAIL SHEET #1 SHEET **55** OF **112**