

POOR ORIGINAL COPY

STANDARD STEEL BEAM GUARD RAIL
W/ STEEL POSTS - ITEM 545-A
556+00 - 556+54.24
556+18 - 556+72.41

STANDARD SUPPLY FOR GUTTERS
4" CHANNEL - 12" WIDE
557+00 - 557+12.00
UNCLASSIFIED CHANNEL EXCAV
Item # 108-C
556+10 - 556+25.41

CONTRACTOR DRIVE

GRAVITY CURB ITEM 545-B
556+00 - 556+54.24
556+18 - 556+72.41

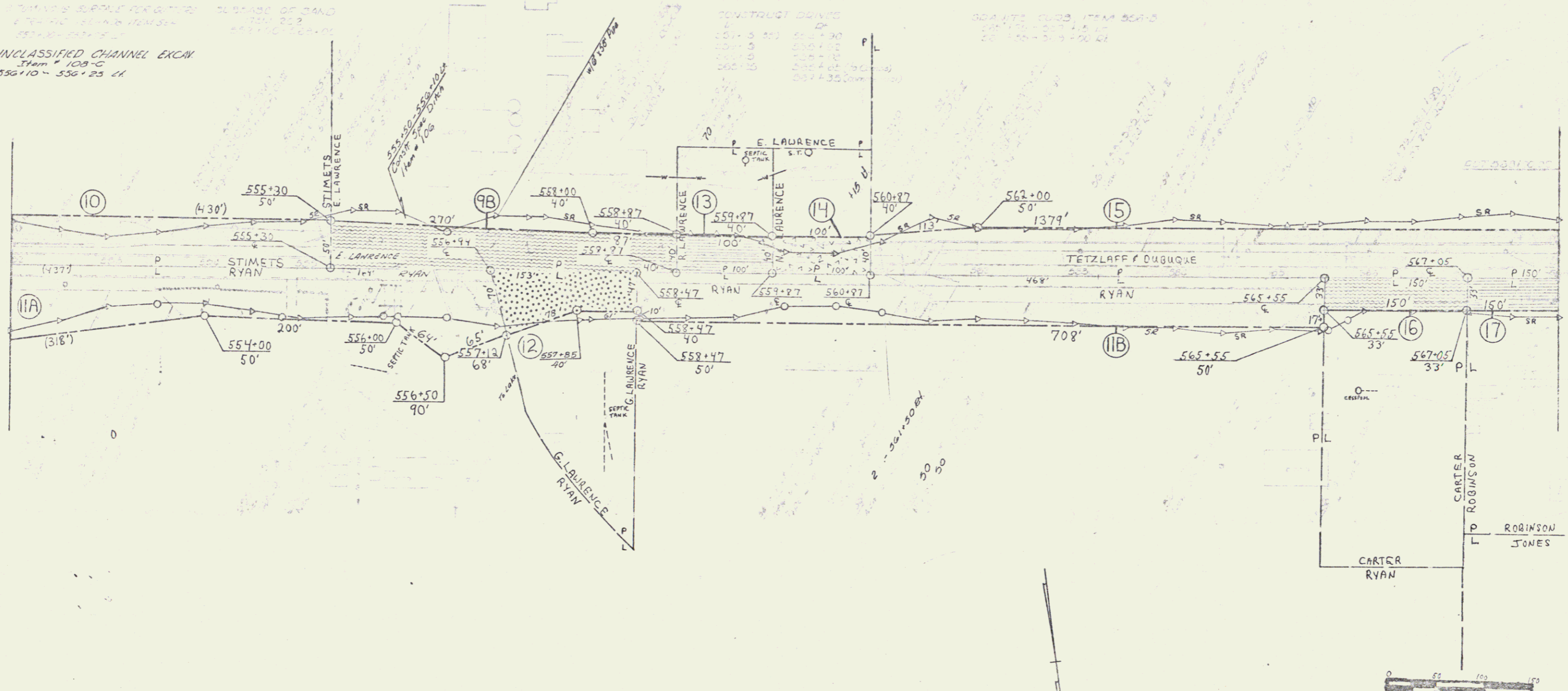

VERMONT DEPARTMENT OF HIGHWAYS
 RIGHT-OF-WAY PLANS
 PROJECT So. 4400
 NO. E 028-1(5)
 SHEET 24 OF 32

JUN 04 1985

41