

INDEX OF SHEETS

STATE OF VERMONT AGENCY OF TRANSPORTATION

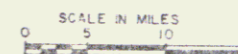

PROPOSED IMPROVEMENT TOWN OF SOUTH HERO COUNTY OF GRAND ISLE U.S. ROUTE 2: BURLINGTON-ALBURG ROAD (F.A.P.)

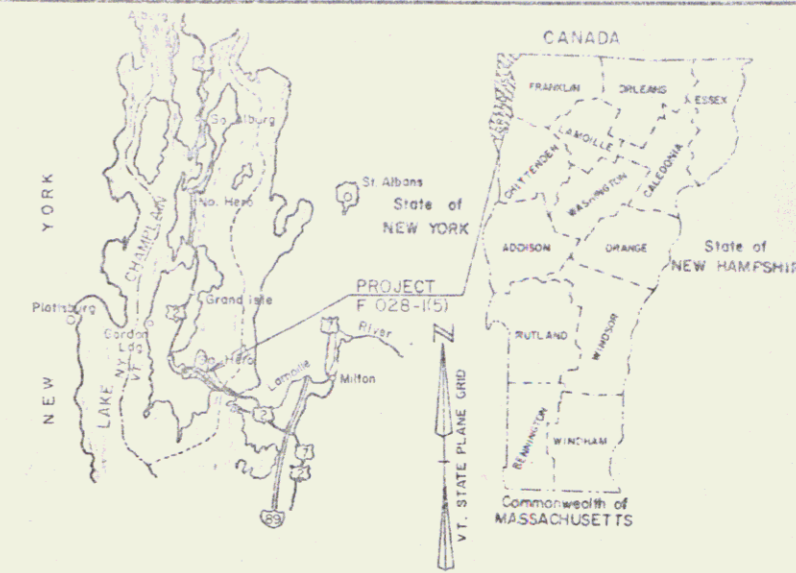

BEGINNING AT A POINT 0.778 MILES WESTERLY OF THE MILTON-SOUTH HERO TOWN LINE AT THE SO CALLED "SAND BAR" BRIDGE AND EXTENDING NORTH WESTERLY 1.986 MILES.

Pin # 78D098

LENGTH OF PROJECT: 10,488 FEET = 1.986 MILES
PROJECT CONSISTS OF VERTICAL AND HORIZONTAL REALIGNMENT, GRADING, DRAINAGE, SUBBASE AND PAVEMENT

UPDATED R.O.W. PLANS TO BE USED ALONG WITH ORIGINAL R.O.W. PLANS

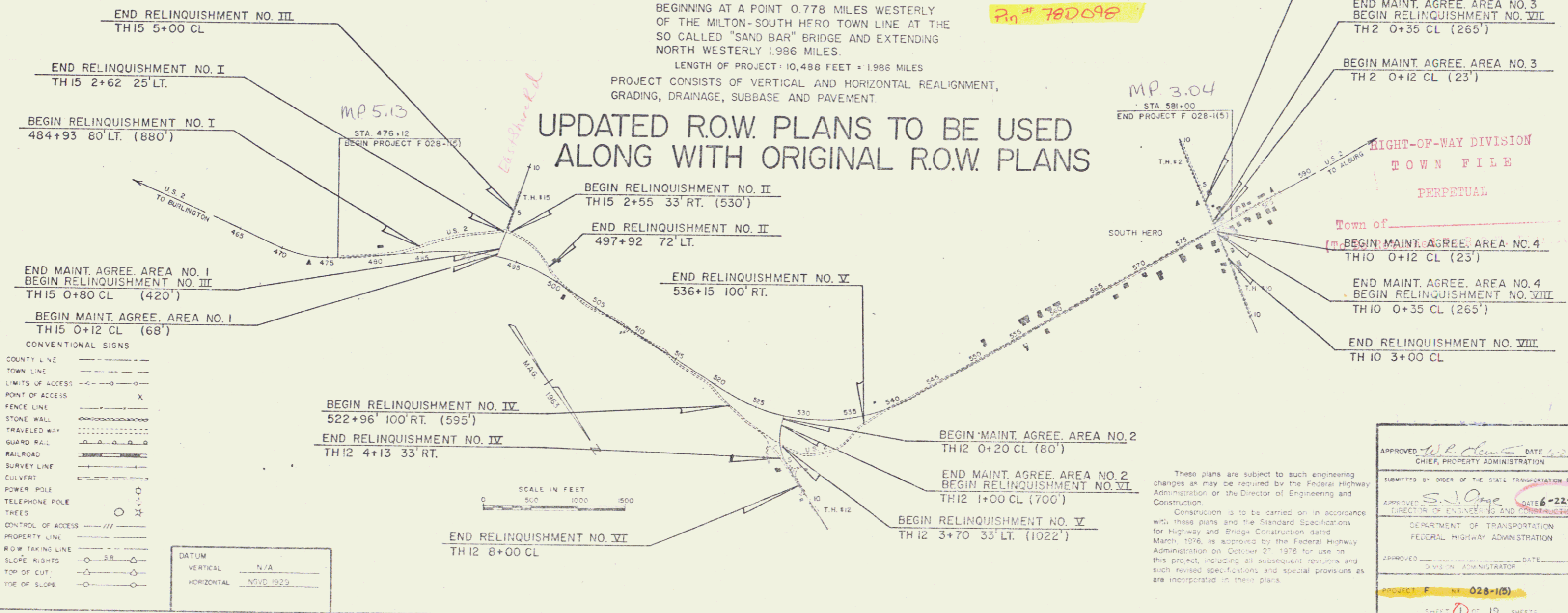

- CONVENTIONAL SIGNS
- COUNTY LINE
 - TOWN LINE
 - LIMITS OF ACCESS
 - POINT OF ACCESS
 - FENCE LINE
 - STONE WALL
 - TRAVELED WAY
 - GUARD RAIL
 - RAILROAD
 - SURVEY LINE
 - CULVERT
 - POWER POLE
 - TELEPHONE POLE
 - TREES
 - CONTROL OF ACCESS
 - PROPERTY LINE
 - ROW TAKING LINE
 - SLOPE RIGHTS
 - TOP OF CUT
 - TOE OF SLOPE

DATUM	VERTICAL	N/A
	HORIZONTAL	NOVD 1929



MP 3.04
STA 581+00
END PROJECT F 028-1(5)

END RELINQUISHMENT NO. VII
TH 2 3+00 CL

END MAINT. AGREE. AREA NO. 3
BEGIN RELINQUISHMENT NO. VII
TH 2 0+35 CL (265')

BEGIN MAINT. AGREE. AREA NO. 3
TH 2 0+12 CL (23')

RIGHT-OF-WAY DIVISION
TOWN FILE
PERPETUAL

Town of _____
(T) BEGIN MAINT. AGREE. AREA NO. 4
TH 10 0+12 CL (23')

END MAINT. AGREE. AREA NO. 4
BEGIN RELINQUISHMENT NO. VIII
TH 10 0+35 CL (265')

END RELINQUISHMENT NO. VIII
TH 10 3+00 CL

END RELINQUISHMENT NO. IX
536+15 100' RT.

BEGIN RELINQUISHMENT NO. IV
522+96' 100' RT. (595')

END RELINQUISHMENT NO. IV
TH 12 4+13 33' RT.

BEGIN MAINT. AGREE. AREA NO. 2
TH 12 0+20 CL (80')

END MAINT. AGREE. AREA NO. 2
BEGIN RELINQUISHMENT NO. VI
TH 12 1+00 CL (700')

BEGIN RELINQUISHMENT NO. V
TH 12 3+70 33' LT. (1022')

END RELINQUISHMENT NO. VI
TH 12 8+00 CL

These plans are subject to such engineering changes as may be required by the Federal Highway Administration or the Director of Engineering and Construction.
Construction is to be carried on in accordance with these plans and the Standard Specifications for Highway and Bridge Construction dated March 1978, as approved by the Federal Highway Administration on October 21, 1976 for use in this project, including all subsequent revisions and such revised specifications and special provisions as are incorporated in these plans.

APPROVED	<i>W.R. Hunt</i>	DATE	6-22-83
CHIEF, PROPERTY ADMINISTRATION			
SUBMITTED BY ORDER OF THE STATE TRANSPORTATION BOARD			
APPROVED	<i>S. J. O'Neil</i>	DATE	6-22-83
DIRECTOR OF ENGINEERING AND CONSTRUCTION			
DEPARTMENT OF TRANSPORTATION FEDERAL HIGHWAY ADMINISTRATION			
APPROVED		DATE	
DIVISION ADMINISTRATOR			
PROJECT F 028-1(5)			
SHEET 8 OF 19 SHEETS			
D-10			