

NOTES:
 1. Δ RADIUS MAY BE ADJUSTED BY RESIDENT ENGINEER TO MEET FIELD CONDITIONS AND TO MATCH EXISTING ALIGNMENT.

EROSION MATTING
 46+00 - 48+00 LT
 48+65 - 51+50 LT
 54+30 - 55+75 LT

TREATED TIMBER CURB
 50+50 - 55+50 LT

SCARIFYING EXIST PAVEMENT
 52+50 LT - 57+00 RT

TEMP 4" REFLECT WHITE LINES
 46+00 - 57+00, 23' LT
 57+00, 23' LT - 59+00, 15' LT
 46+00 - 57+00, 12' LT (DASHED)
 46+00 - 58+00, 23' RT
 56+00, 23' RT - T.H. 4, 11+75, 11' RT
 T.H. 4, 11+75, 11' RT - T.H. 4, 13+25, 11' RT
 T.H. 4, 13+25, 11' RT - T.H. 4, 13+75, 10' RT
 T.H. 4, 13+75, 10' RT - T.H. 4, 13+25, 11' LT
 T.H. 4, 13+25, 11' LT - T.H. 4, 11+75, 11' LT
 T.H. 4, 11+75, 11' LT - 57+00, 19' RT
 57+00, 19' RT - 58+75, 12' RT
 58+75, 12' RT - 59+00, 12' RT
 46+00, 12' RT - 56+00, 12' RT (DASHED)

TEMP 4" REFLECT YELLOW LINES
 46+00 - 56+30 Δ (DOUBLE)
 56+70 - 59+00 Δ (DBL)
 T.H. 4, 11+50 - 13+75 Δ (DBL)

DURABLE 24" STOP BAR
 56+50 - 56+69, 3' RT

EXCAVATION & REMOVAL OF ROAD SURFACE & PAVEMENTS
 46+00 LT - 52+50 LT
 T.H. 4, 11+50 RT - 12+50 RT

DRILLING AND BLASTING OF SOLID ROCK SUBGRADE
 46+25 - 48+00
 57+75 - 59+00

GUARD RAIL STD STL BEAM W/ WOOD POSTS, TYPE II
 47+75 - 56+75 LT
 49+25 - 56+00 RT
 56+00 - T.H. 4, 12+00 RT
 T.H. 4, 12+00 LT - 58+25 RT

REMOVAL & DISPOSAL OF EXIST GUARD RAIL
 51+30 LT - 55+00 RT (ON OLD ALIGNMENT)
 T.H. 4, 11+50 - 12+25 RT

CONSTRUCT DRIVE
 LT. - 59+00

CONSTRUCT RELOCATED T.H. 4
 RT. - 56+50

PUB. NO.	STATE	FED. AID PROJ. NO.	FISCAL YEAR	SHEET NO.	TOTAL SHEETS
1	VT.	FO10-1(17)	19	10	18

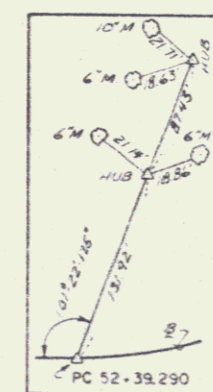
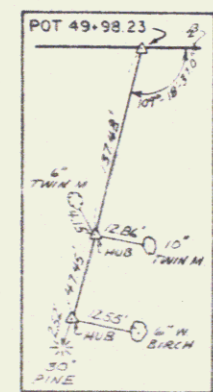
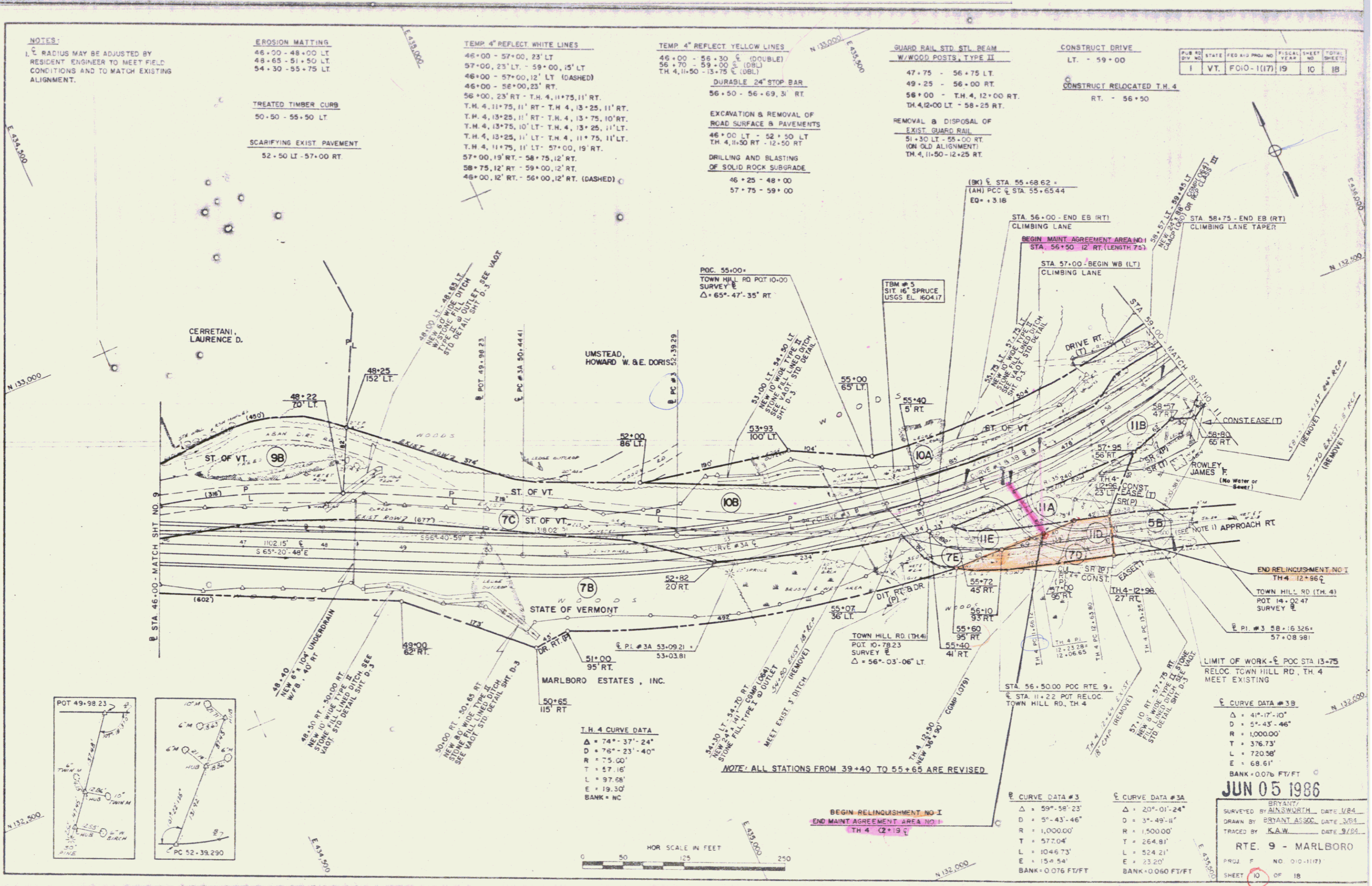

T.H. 4 CURVE DATA

Δ	74° 37' 24"
D	76° 23' 40"
R	75.00'
T	57.16'
L	97.06'
E	19.30'
BANK	+ NC

Curve Data #3

Δ	59° 58' 23"
D	5° 43' 46"
R	1,000.00'
T	577.04'
L	1046.73'
E	154.54'
BANK	0.076 FT/FT

Curve Data #3A

Δ	20° 01' 24"
D	3° 49' 11"
R	1,500.00'
T	264.81'
L	524.21'
E	23.20'
BANK	0.060 FT/FT

JUN 05 1986
 BRYANT/
 SURVEYED BY BRYANT/ DATE 1/84
 DRAWN BY BRYANT/ AS300/ DATE 3/81
 TRACED BY K.A.W./ DATE 9/81
RT. 9 - MARLBORO
 PROJ. NO. 010-1172
 SHEET 10 OF 18

