

CONSTRUCT PAVED DRIVES		
LOCATION/TYPE	RADII STA/OFFSET	APPROX. WIDTH
STA 108+95 LT/(C)	STA 108+57.16/42.00 FT STA 109+25.95/42.00 FT	24 FT

- REMOVAL OF EXISTING FENCE**
 STA 104+19 - 104+51 LT (ABANDONED WOVEN WIRE)
- STEEL BEAM GUARDRAIL, GALVANIZED**
 STA 104+58 - 105+90 RT
 STA 104+58 - 105+90 LT
- MANUFACTURED TERMINAL SECTION, FLARED**
 STA 104+20 - 104+58 RT
 STA 104+20 - 104+58 LT
 STA 105+89 - 106+28 RT
 STA 105+89 - 106+28 LT
- REMOVAL AND DISPOSAL OF GUIDE POSTS**
 STA 104+73 RT
 STA 104+75 LT
 STA 104+82 LT
 STA 104+89 RT
 STA 104+98 LT
 STA 105+04 RT
 STA 107+24 LT

- SPECIAL PROVISION (REMOVE AND RESET COMMERCIAL SIGN)**
 STA 108+63 LT
- SPECIAL PROVISION (HAND-PLACED BITUMINOUS CONCRETE, DRIVES)**
 STA 108+92 LT

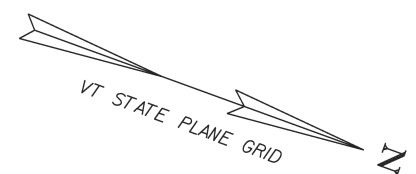

REMOVE & REPLACE PROPERTY MARKERS	
EXISTING	PROPOSED
IP 108+61.90 52.83'RT	IP 108+62.14 48.05'RT
IP 109+21.75 53.00'RT	IP 109+22.26 47.21'RT

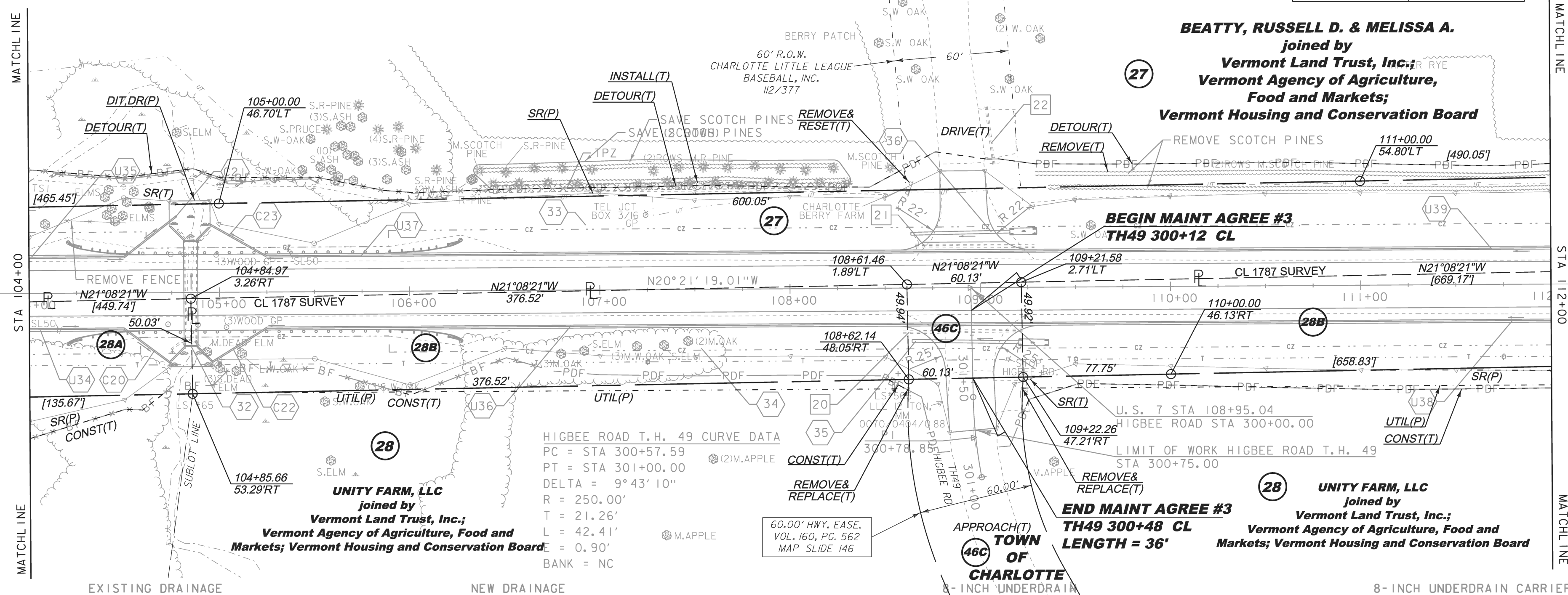

- 20 STA 108+59 - 109+22 RT
REMOVE 15" CGMP
- 21 STA 108+66 - 109+29 LT
REMOVE 15" CGMP AND HEADWALL
- 22 STA 109+08 LT
RETAIN 15" CGMP AND (2) CRM

- 32 STA 104+85 BR #142
REMOVE 5' X 5' CONCRETE BOX, HWS AND WWS
NEW 6' X 6' X 56' CONCRETE BOX W/HEADWALLS,
WINGWALLS AND STONE FILL TYPE II AT INLET
AND OUTLET. SEE BRIDGE DETAIL SHEETS
- 33 STA 106+50 - 112+50 LT
CONSTRUCT GRASS LINED TREATMENT SWALE
SEE TYPICAL SECTIONS
- 34 STA 106+60 - 112+80 RT
CONSTRUCT GRASS LINED TREATMENT SWALE
SEE TYPICAL SECTIONS
- 35 STA 108+64 - 109+20 RT
NEW 18" X 56' PIPE OPTION
W/STONE PAD AT INLET
- 36 STA 108+64 - 109+16 LT
NEW 18" X 52' PIPE OPTION
W/STONE PAD AT INLET

- U34 STA 100+00 - 104+50 RT
NEW 8" X 450' UNDERDRAIN
W/FLUSHING BASIN AT 100+00 RT
- U35 STA 100+00 - 104+50 LT
NEW 8" X 450' UNDERDRAIN
W/FLUSHING BASIN AT 100+00 LT
- U36 STA 105+25 - 111+50 RT
NEW 8" X 625' UNDERDRAIN
W/FLUSHING BASIN AT 111+50 RT
- U37 STA 105+25 - 111+50 LT
NEW 8" X 625' UNDERDRAIN
W/FLUSHING BASIN AT 111+50 LT

- U38 STA 108+50 - 118+50 RT
NEW 8" X 700' UNDERDRAIN
W/FLUSHING BASIN AT 118+50 RT
- U39 STA 111+50 - 118+00 LT
NEW 8" X 650' UNDERDRAIN
W/FLUSHING BASIN AT 118+00 LT

- C20 STA 104+50 - 104+75 RT
NEW 8" X 32' UD CARRIER PIPE
- C21 STA 104+50 - 104+78 LT
NEW 8" X 35' UD CARRIER PIPE
- C22 STA 104+95 - 105+25 RT
NEW 8" X 35' UD CARRIER PIPE
- C23 STA 104+95 - 105+25 LT
NEW 8" X 35' UD CARRIER PIPE

LINES SHOWN ON THIS PLAN AS EXISTING PROPERTY LINES P/L ARE BELIEVED TO BE ACCURATE BUT SHOULD NOT BE RELIED UPON FOR PURPOSES UNRELATED TO THE STATE OF VERMONT'S ACQUISITION OF LAND AND RIGHTS FOR THIS PROJECT.

FOR R.O.W. USE ONLY

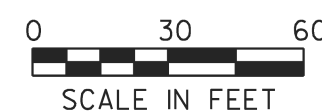

THIS PROJECT SUBJECT TO STORMWATER PERMIT 3438-INDS

PROJECT NAME: CHARLOTTE
 PROJECT NUMBER: F EGC 019-4(20)

FILE NAME: r78d062_lay13.dgn
 PROJECT LEADER: K. UPMAL
 DESIGNED BY: B. KIPP
 ROW LAYOUT SHEET 13 OF 20

PLOT DATE: 05-JAN-2015
 DRAWN BY: E. PIERCE
 CHECKED BY: E. PIERCE
 SHEET 27 OF 132