

LOCATION/TYPE	RADIUS STA/OFFSET	APPROX. WIDTH
STA 92+65 RT/(C)	STA 92+22.26/42.00 FT STA 92+78.91/42.00 FT	12 FT

CHAIN-LINK FENCE, 4 FOOT
 STA 91+50 RT
 STA 91+50 LT
 REMOVAL OF EXISTING FENCE
 STA 91+48 - 92+02 LT (ABANDONED WOVEN WIRE)
 STA 92+18 LT (ABANDONED WOVEN WIRE)
 STA 92+35 - 93+60 LT (ABANDONED WOVEN WIRE)
 STA 94+79 - 95+15 LT (ABANDONED WOVEN WIRE)
 STEEL BEAM GUARDRAIL, GALVANIZED
 STA 90+50 - 91+92 RT
 STA 90+50 - 92+00 LT

MANUFACTURED TERMINAL SECTION, FLARED
 STA 90+12 - 90+50 RT
 STA 90+12 - 90+50 LT
 STA 92+01 - 92+39 LT
 ANCHOR FOR STEEL BEAM RAIL
 STA 91+91 RT
 REMOVAL AND DISPOSAL OF GUIDE POSTS
 STA 91+85 RT
 STA 91+90 RT
 STA 92+01 RT

SPECIAL PROVISION (HAND-PLACED BITUMINOUS CONCRETE, DRIVES)
 STA 92+57 RT
 SPECIAL PROVISION (REMOVE AND STOCKPILE STONEWALL)
 STA 87+87 - 90+42 RT

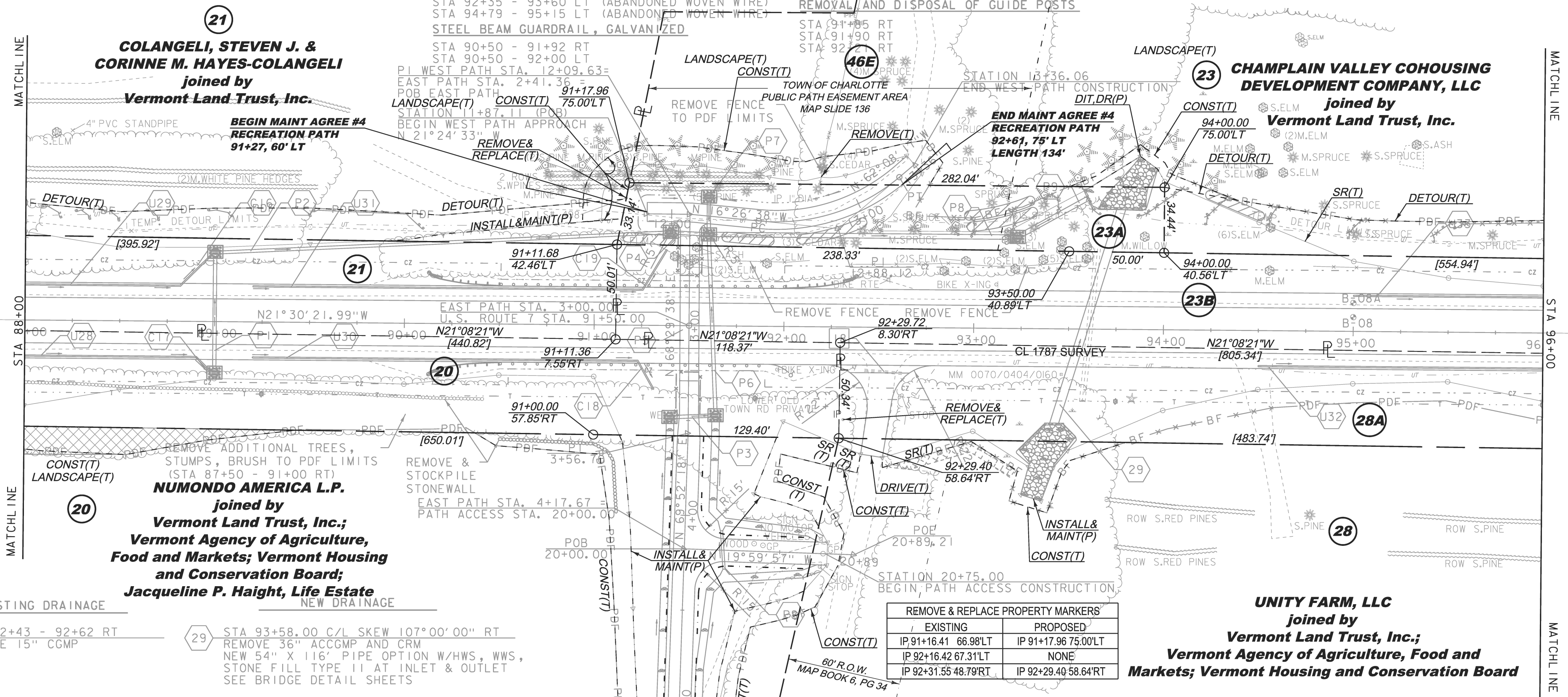

EXISTING DRAINAGE	NEW DRAINAGE
18 STA 92+43 - 92+62 RT REMOVE 15" CGMP	29 STA 93+58.00 C/L SKEW 107°00'00" RT REMOVE 36" ACCMP AND CRM NEW 54" X 116' PIPE OPTION W/HWS, WWS, STONE FILL TYPE II AT INLET & OUTLET SEE BRIDGE DETAIL SHEETS

NEW PEDESTRIAN BIKE PATH DRAINAGE	
P1 STA 89+00 C/L NEW 18" X 63' PIPE OPTION NEW PRCCB W/TYPE B GRATE	P5 STA 91+50 BR #141A NEW 10' X 10' X 95' PEDESTRIAN-BIKE UNDERPASS SEE BRIDGE DETAIL SHEETS
P2 STA 89+00 - 91+40 LT NEW 18" X 242' PIPE OPTION NEW PRCCB W/TYPE B GRATE	P6 STA 91+60 LT - 91+64 RT NEW 18" X 97' PIPE OPTION NEW PRCCB W/TYPE B GRATE
P3 STA 91+40 - 91+62 RT NEW 18" X 22' PIPE OPTION NEW PRCCB W/TYPE B GRATE	P7 STA 91+60 LT NEW 18" X 20' PIPE OPTION NEW PRCCB W/TYPE B GRATE
P4 STA 91+40 - 91+60 LT NEW 18" X 20' PIPE OPTION NEW PRCCB W/TYPE B GRATE	P8 STA 91+60 - 93+23 LT NEW 24" X 163' PIPE OPTION NEW PRCCB W/TYPE B GRATE
	P9 STA 93+23 - 93+60 LT NEW 24" X 41' PIPE OPTION NEW PRCCB W/TYPE B GRATE

REMOVE & REPLACE PROPERTY MARKERS		
EXISTING	PROPOSED	
IP 91+16.41	66.98'LT	IP 91+17.96 75.00'LT
IP 92+16.42	67.31'LT	NONE
IP 92+31.55	48.79'RT	IP 92+29.40 58.64'RT

8-INCH UNDERDRAIN	
U28 STA 84+80 - 88+91 RT NEW 8" X 411' UNDERDRAIN W/FLUSHING BASIN AT 84+80 RT	U29 STA 84+80 - 88+82 LT NEW 8" X 402' UNDERDRAIN W/FLUSHING BASIN AT 84+80 LT
U30 STA 89+20 - 91+23 RT NEW 8" X 203' UNDERDRAIN W/FLUSHING BASIN AT 89+25 RT	U31 STA 89+20 - 91+25 LT NEW 8" X 205' UNDERDRAIN W/FLUSHING BASIN AT 89+25 LT
U32 STA 94+50 - 100+00 RT NEW 8" X 550' UNDERDRAIN W/FLUSHING BASIN AT 94+50 RT	U33 STA 95+00 - 100+00 LT NEW 8" X 500' UNDERDRAIN W/FLUSHING BASIN AT 95+00 LT

8-INCH UNDERDRAIN CARRIER PIPE	
C16 STA 88+82 - 88+98 LT NEW 8" X 25' UD CARRIER PIPE	C17 STA 88+91 - 88+98 RT NEW 8" X 12' UD CARRIER PIPE
C18 STA 91+23 - 91+32 RT NEW 8" X 18' UD CARRIER PIPE	C19 STA 91+25 - 91+38 LT NEW 8" X 25' UD CARRIER PIPE

46F
 TOWN OF CHARLOTTE
 16.5' REC PATH
 EASEMENT
 140/397
 MAP SLIDE 140

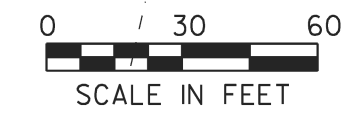

THIS PROJECT SUBJECT TO STORMWATER PERMIT 3438-INDS

LINES SHOWN ON THIS PLAN AS EXISTING PROPERTY LINES P/L ARE BELIEVED TO BE ACCURATE BUT SHOULD NOT BE RELIED UPON FOR PURPOSES UNRELATED TO THE STATE OF VERMONT'S ACQUISITION OF LAND AND RIGHTS FOR THIS PROJECT.

PROJECT NAME: CHARLOTTE	PLOT DATE: 05-JAN-2015
PROJECT NUMBER: F EGC 019-4(20)	DRAWN BY: E. PIERCE
FILE NAME: r78d062_lay11.dgn	CHECKED BY: E. PIERCE
PROJECT LEADER: K. UPMAL	SHEET 25 OF 132
DESIGNED BY: B. KIPP	
ROW LAYOUT SHEET 11 OF 20	

FOR R.O.W. USE ONLY