

REMOVAL AND DISPOSAL OF GUIDE POSTS
STA 78+49 LT

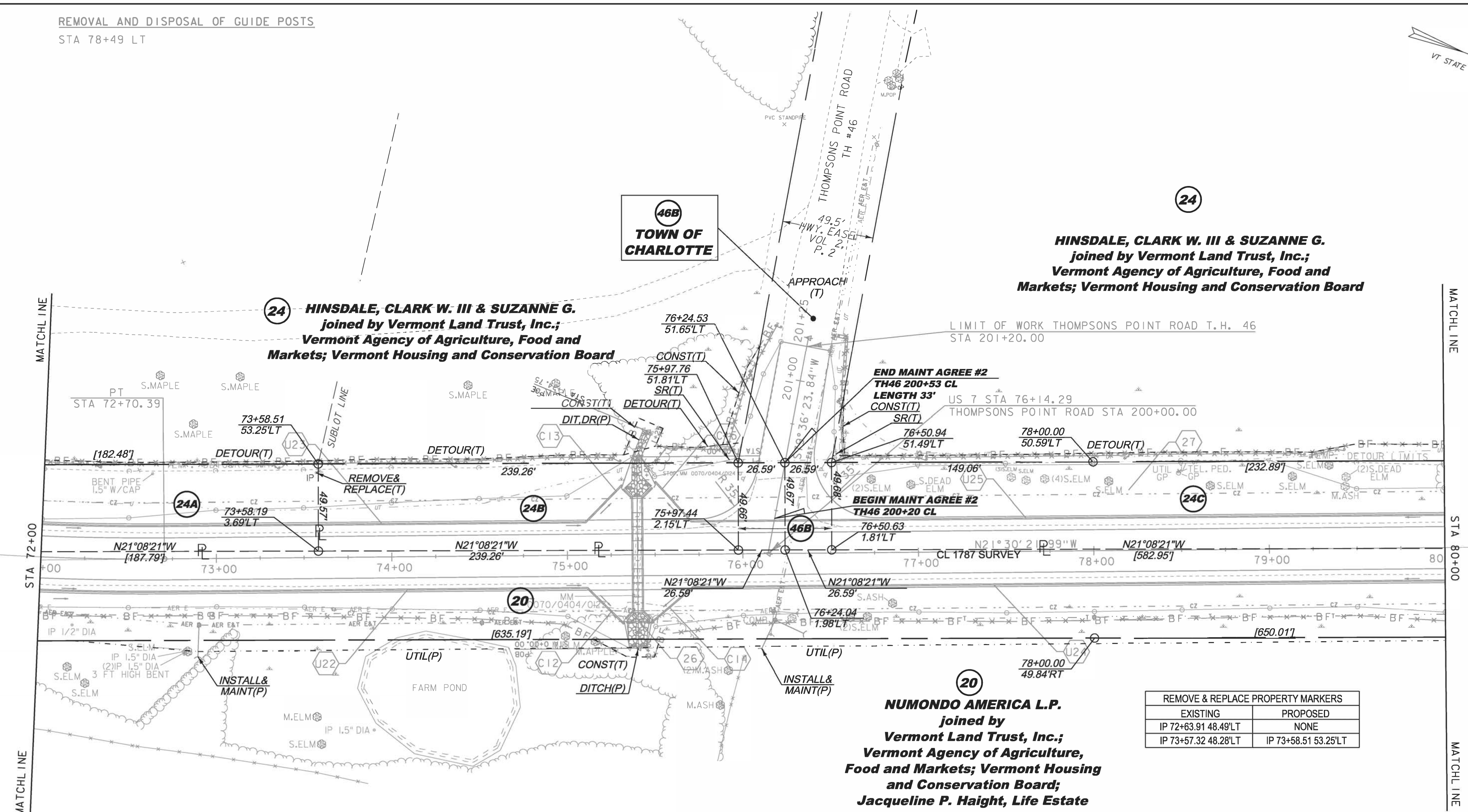
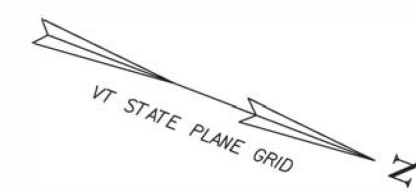

- NEW DRAINAGE
 - 8-INCH UNDERDRAIN
 - 8-INCH UNDERDRAIN CARRIER PIPE
- | | | | | |
|---|---|---|---|---|
| <p>26 STA 75+40 C/L
REMOVE 30" RCP W/CRM AND HEADWALL.
NEW 5' X 66' X 3' CONCRETE BOX W/HWS, WWS AND
STONE FILL TYPE II AT INLET & OUTLET
SEE BRIDGE DETAIL SHEETS</p> <p>27 STA 77+00 TO 79+00 LT
CONSTRUCT GRASS LINED TREATMENT SWALE
SEE TYPICAL SECTIONS</p> | <p>U22 STA 68+00 - 75+11 RT
NEW 8" X 711' UNDERDRAIN
W/FLUSHING BASIN AT 68+00 RT</p> <p>U23 STA 68+00 - 75+11 LT
NEW 8" X 711' UNDERDRAIN
W/FLUSHING BASIN AT 68+00 LT</p> | <p>U24 STA 75+71 - 80+00 RT
NEW 8" X 429' UNDERDRAIN
W/FLUSHING BASIN AT 80+00 RT</p> <p>U25 STA 75+71 - 80+00 LT
NEW 8" X 429' UNDERDRAIN
W/FLUSHING BASIN AT 80+00 LT</p> | <p>C12 STA 75+11 - 75+32 RT
NEW 8" X 30' UD CARRIER PIPE</p> <p>C13 STA 75+11 - 75+32 LT
NEW 8" X 30' UD CARRIER PIPE</p> | <p>C14 STA 75+50 - 75+71 RT
NEW 8" X 30' UD CARRIER PIPE</p> <p>C15 STA 75+48 - 75+71 LT
NEW 8" X 29' UD CARRIER PIPE</p> |
|---|---|---|---|---|

REMOVE & REPLACE PROPERTY MARKERS	
EXISTING	PROPOSED
IP 72+63.91 48.49'LT	NONE
IP 73+57.32 48.28'LT	IP 73+58.51 53.25'LT

THIS PROJECT SUBJECT TO STORMWATER
PERMIT 3438-INDS

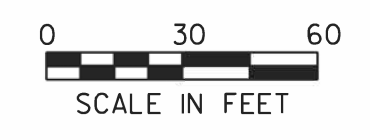

LINES SHOWN ON THIS PLAN AS EXISTING
PROPERTY LINES P/L ARE BELIEVED TO
BE ACCURATE BUT SHOULD NOT BE RELIED
UPON FOR PURPOSES UNRELATED TO THE
STATE OF VERMONT'S ACQUISITION OF LAND
AND RIGHTS FOR THIS PROJECT.

PROJECT NAME: CHARLOTTE
PROJECT NUMBER: F EGC 019-4(20)

FILE NAME: r78d062_lay09.dgn
PROJECT LEADER: K. UPMAL
DESIGNED BY: B. KIPP
ROW LAYOUT SHEET 9 OF 20

PLOT DATE: 05-JAN-2015
DRAWN BY: E. PIERCE
CHECKED BY: E. PIERCE
SHEET 23 OF 132

**FOR R.O.W.
USE ONLY**