

R.O.W. PLANS

INDEX OF SHEETS

1	TITLE SHEET
2-3	ALPHA SHEETS
4-14	DETAIL SHEETS
15-34	LAYOUT SHEETS
35-43	TYPICAL SHEETS
44-45	TIE SHEETS
46-70	PROFILE SHEETS
71-90	EPSC CONSTRUCTION SHEETS
91-110	SIGNS & PAVEMENT MARKING LAYOUTS
111-112	LANDSCAPE DETAIL SHEETS
113-132	LANDSCAPE LAYOUT SHEETS

STATE OF VERMONT AGENCY OF TRANSPORTATION

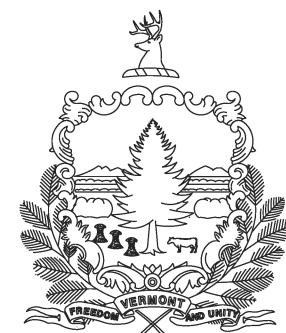

PROPOSED IMPROVEMENT TOWN OF CHARLOTTE COUNTY OF CHITTENDEN US ROUTE 7 (PRINCIPAL ARTERIAL)

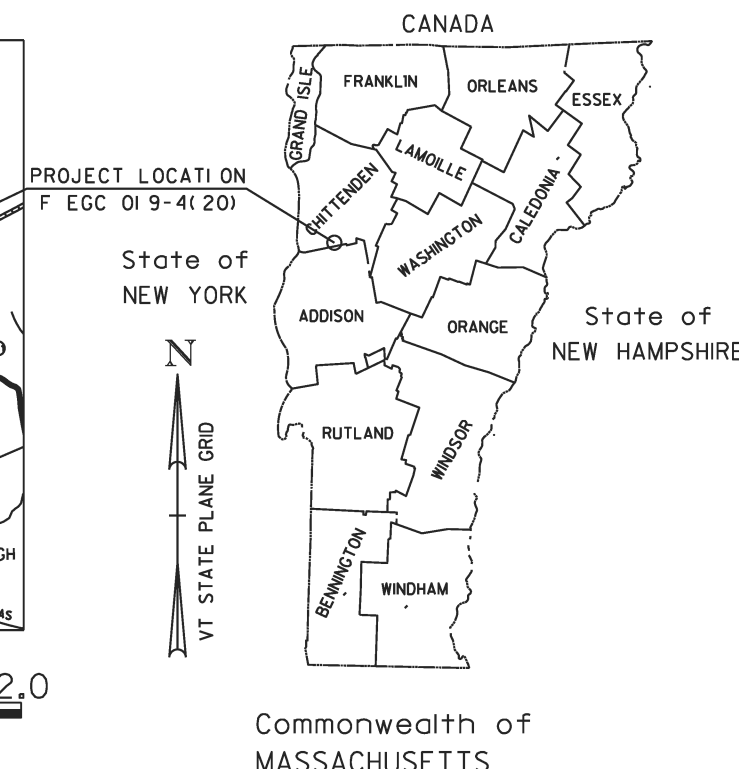
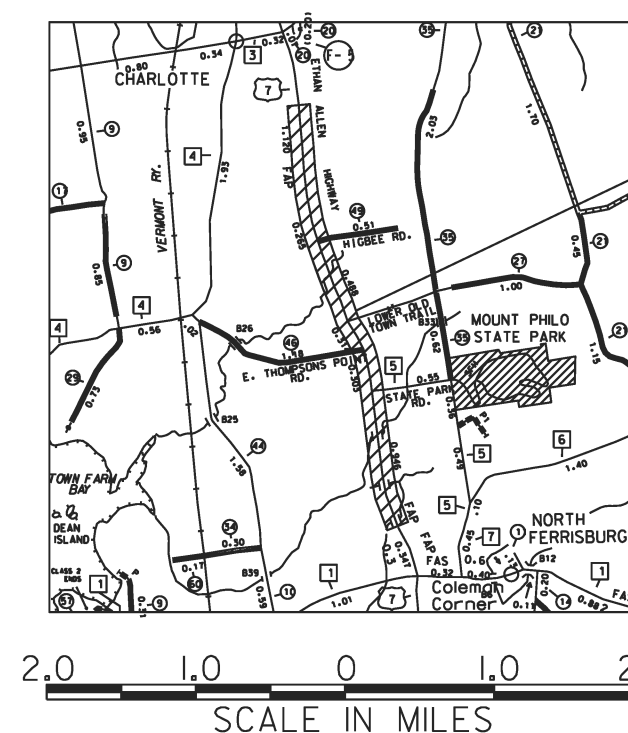

PROJECT LOCATION:
BEGINNING AT THE FERRISBURGH-CHARLOTTE TOWN LINE AND EXTENDING NORTHERLY 2.93 MILES TO A POINT APPROXIMATELY 1/2 MILE SOUTH OF THE ROUTE F-5 INTERSECTION WITH U.S. ROUTE 7

PROJECT DESCRIPTION:
WORK TO BE PERFORMED UNDER THIS CONTRACT INCLUDES THE REMOVAL AND DISPOSAL OF THE EXISTING CONCRETE ROAD, WIDENING AND FULL DEPTH RECONSTRUCTION, GRADING, DRAINAGE, PAVING, SIGNING AND OTHER RELATED ITEMS.

LENGTH OF ROADWAY: 15,322.00 FEET = 2.902 MILES
 LENGTH OF STRUCTURES: 23.67 FEET = 0.004 MILES
 LENGTH OF PROJECT: 15,345.67 FEET = 2.906 MILES
 LENGTH OF ROW PROJECT: 15,630± FEET = 2.96± MILES



EXISTING RIGHT OF WAY OF ROUTE 7 ON THESE PLANS IS BASED UPON A SURVEY BY THE VERMONT AGENCY OF TRANSPORTATION ENTITLED "RIGHT OF WAY PLAT - TOWN OF CHARLOTTE - US ROUTE 7 - MM 0.00-3.20" DATED 02/17/2011 AND RECORDED IN THE TOWN OF CHARLOTTE LAND RECORDS.

ALL DRIVES AS INDICATED ON PLANS ARE SUBJECT TO PERMITS PURSUANT TO TITLE 19 V.S.A. § 1111.

CONVENTIONAL SYMBOLS

COUNTY LINE	— — — — —
TOWN LINE	— — — — —
LIMITS OF ACCESS	— ○ — ○ —
POINT OF ACCESS	X
FENCE LINE	X — X — X — X —
STONE WALL	○ — ○ — ○ — ○ —
TRAVELED WAY	— — — — —
GUARD RAIL	— ○ — ○ — ○ — ○ —
RAILROAD	— — — — —
SURVEY LINE	— — — — —
CULVERT	— — — — —
POWER POLE	⊕
TELEPHONE POLE	⊕
TREES	⊕
CONTROL OF ACCESS	— // — // — // —
PROPERTY LINE	— — — — —
R.O.W. TAKING LINE	— ○ — ○ — ○ — ○ —
SLOPE RIGHTS	— ○ — ○ — ○ — ○ —
TOP OF CUT	— △ — △ — △ — △ —
TOE OF SLOPE	— ○ — ○ — ○ — ○ —

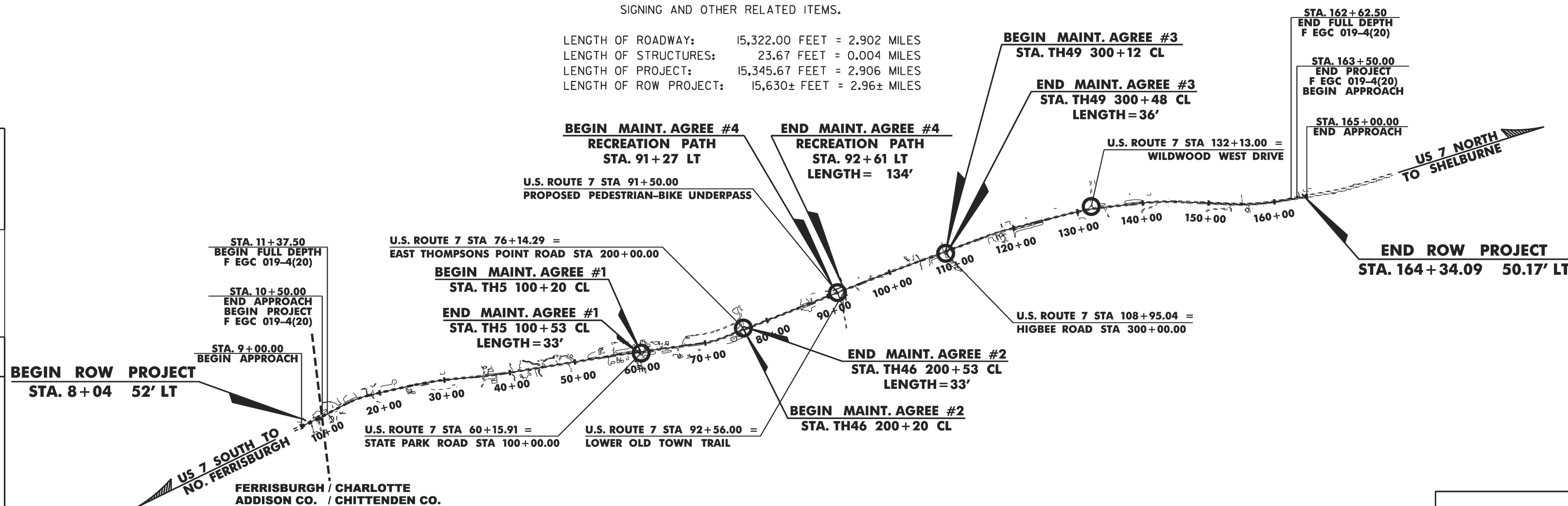

SUBJECT TO STORMWATER PERMIT #3438 - INDS

SURVEYED BY : VTRANS
SURVEYED DATE : 2009

DATUM
VERTICAL: NGVD 88
HORIZONTAL: NAD (96)

BITUMINOUS CONCRETE PAVEMENT SUPER PAVE DESIGN MIXTURE CRITERIA	
DESIGN LIFE ESAL'S (DESIGN LANE)	9,788,000
DESIGN NUMBER OF GYRATIONS	80
PERFORMANCE GRADED ASPHALT BINDER	SEE SECTION 490
GENERAL SPECIAL PROVISIONS	



THESE PLANS ARE SUBJECT TO SUCH ENGINEERING CHANGES AS MAY BE REQUIRED BY THE FEDERAL HIGHWAY ADMINISTRATION OR THE DIRECTOR OF PROGRAM DEVELOPMENT.

CONSTRUCTION IS TO BE CARRIED ON IN ACCORDANCE WITH THESE PLANS AND THE STANDARD SPECIFICATIONS FOR CONSTRUCTION DATED 2006, AS APPROVED BY THE FEDERAL HIGHWAY ADMINISTRATION ON JUNE 15, 2006 FOR USE ON THIS PROJECT, INCLUDING ALL SUBSEQUENT REVISIONS AND SUCH REVISED SPECIFICATIONS AND SPECIAL PROVISIONS AS ARE INCORPORATED IN THESE PLANS.

APPROVED RICHARD TETREAULT DATE 02-11-13
Director of Program Development

APPROVED ROBERT M. WHITE DATE 02-11-13
Chief of Right of Way

CHARLOTTE
F EGC 019-4(20)
ROW SHEET 1 OF 132 SHEETS

PLOT DATE: 03-APR-2013