

POINT #	NORTH	EAST	BEARING	DIST.
L 38	504800.96	340687.59	S12°56'-21" E	114.01
L 39	504689.83	340713.08	S19°02'-07" W	279.04
L 39 A	504424.06	340622.08	S15°00'-28" W	141.54
L 40	504286.13	340590.21	S28°43'-52" W	70.85
L 41	504284.24	340554.30	S13°42'-37" W	751.10
L 42	503494.57	340378.28	S31°00'-27" E	26.52
L 42 A	503474.69	340391.43		

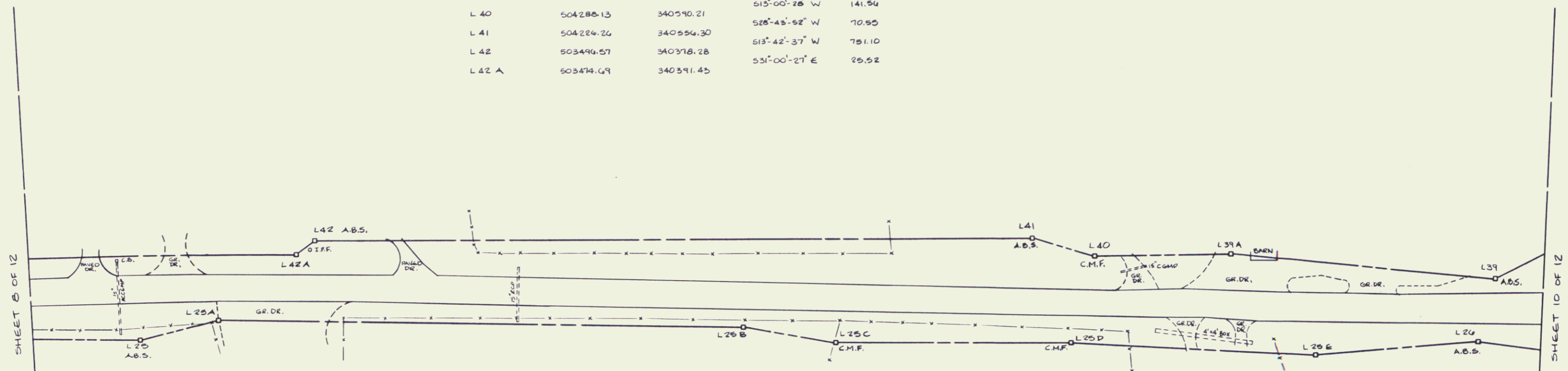

POINT #	NORTH	EAST	BEARING	DIST.
L 25	503297.38	340439.30	N01°15'-34" W	82.01
L 25 A	503379.34	340437.50	N14°27'-29" E	548.90
L 25 B	503910.88	340574.54	N22°24'-38" E	98.75
L 25 C	504002.35	340612.24	N13°52'-25" E	247.88
L 25 D	504243.00	340671.70	N16°42'-59" E	254.18
L 25 E	504484.43	340744.81	N09°14'-31" E	170.85
L 26	504655.06	340772.25	N20°38'-17" E	476.00
L 26 A	505102.38	340940.73		

ALL BEARINGS ARE REFERENCED TO THE VERMONT STATE PLANE COORDINATE SYSTEM.



STATE OF VERMONT
 US ROUTE 7 RIGHT-OF-WAY
 LEICESTER FEGC FOR-3 (29)
 VERMONT SURVEY CONSULTANTS, INC.
 58 EAST STATE ST.
 MONTPELIER, VT.

DATE: JULY 1989 SCALE: 1" = 50' SHEET: 9 OF 12