

POINT #	NORTH	EAST	BEARING	DIST.
L 51	500780.23	339933.78		
L 52	499922.13	339809.40	ON 11492.20' RADIUS CURVE	867.23
L 53	499688.68	339784.31	505°41'51" W	234.41
L 53 A	499689.33	339780.35	885°48'51" W	4.00
L 54	499490.50	339758.80	506°11'09" W	200.00
L 54 A	499489.69	339764.25	583°48'51" E	7.50

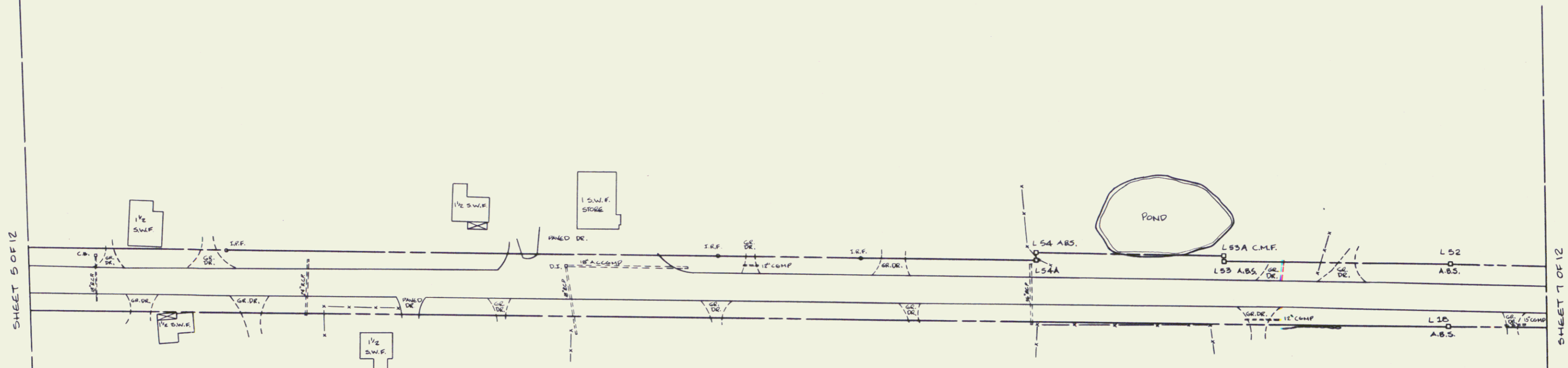

POINT #	NORTH	EAST	BEARING	DIST.
L 10	499915.02	339875.22		
L 10 A	500494.27	339948.78	ON 11426.20' RADIUS CURVE	583.99

ALL BEARINGS ARE REFERENCED TO THE VERMONT STATE PLANE COORDINATE SYSTEM.

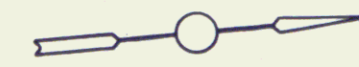
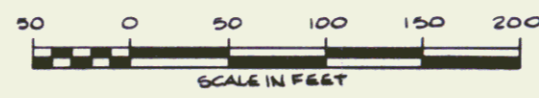

STATE OF VERMONT
 US ROUTE 7 RIGHT-OF-WAY
 LEICESTER REG. FOR-3 (29)
 VERMONT SURVEY CONSULTANTS, INC.
 58 EAST STATE ST.
 MONTPELIER, VT.

DATE: JULY 1989 SCALE: 1" = 50' SHEET: 6 OF 12

29