

POINT #	NORTH	EAST	BEARING	DIST.
L 59	497194.76	339734.71		
L 60	496660.14	339809.44	507°44'38" E	589.76
L 61	496574.44	339810.39	500°37'55" E	85.71
L 62	496501.70	339831.72	516°20'59" E	75.80
L 63	495824.15	339924.74	506°00'21" E	682.20
L 64	495444.05	339954.14	504°19'41" E	363.13

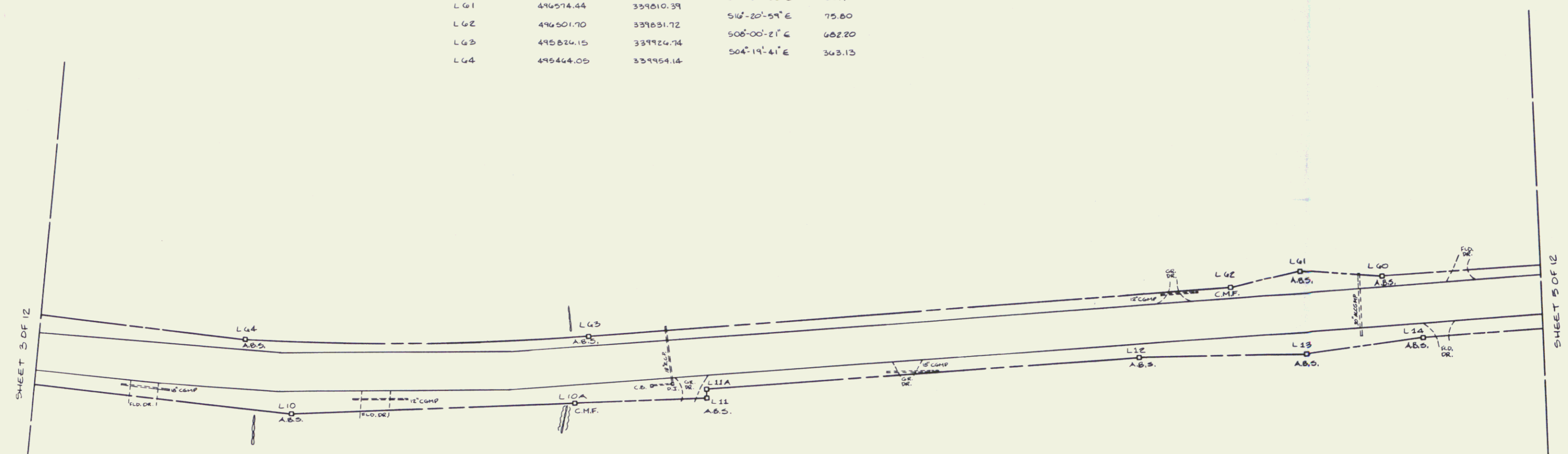

POINT #	NORTH	EAST	BEARING	DIST.
L 10	495515.43	340029.12	N02°07'26" W	303.01
L 10 A	495014.90	339996.62	N05°30'01" W	139.22
L 11	495955.48	339983.28	S81°59'39" W	9.00
L 11 A	496954.23	339974.36	N07°52'55" W	442.00
L 12	496411.86	339911.01	N05°23'18" W	175.18
L 13	496586.27	339894.56	N11°12'40" W	125.20
L 14	496709.08	339870.22	N07°53'54" W	1101.97
L 14 A	497800.60	339718.79		

ALL BEARINGS ARE REFERENCED TO THE VERMONT STATE PLANE COORDINATE SYSTEM.

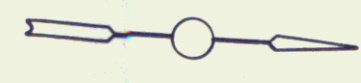
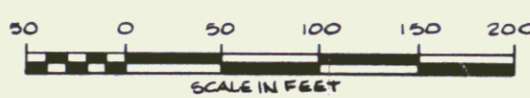

STATE OF VERMONT
 US ROUTE 7 RIGHT-OF-WAY
 LEICESTER REGC FOR 3 (29)
 VERMONT SURVEY CONSULTANTS, INC.
 58 EAST STATE ST.
 MONTPELIER, VT.

DATE: July 1989	SCALE: 1" = 50'	SHEET: 4 OF 12
--------------------	--------------------	-------------------