

POINT #	NORTH	EAST	BEARING	DIST.
L71	492241.72	339917.12	500°-26'-21"E	320.00
L72	491921.73	339919.57	N09°-35'-39"E	11.00
L72A	491921.62	339930.57	500°-26'-07"E	1415.32
L73	490504.55	339942.15		

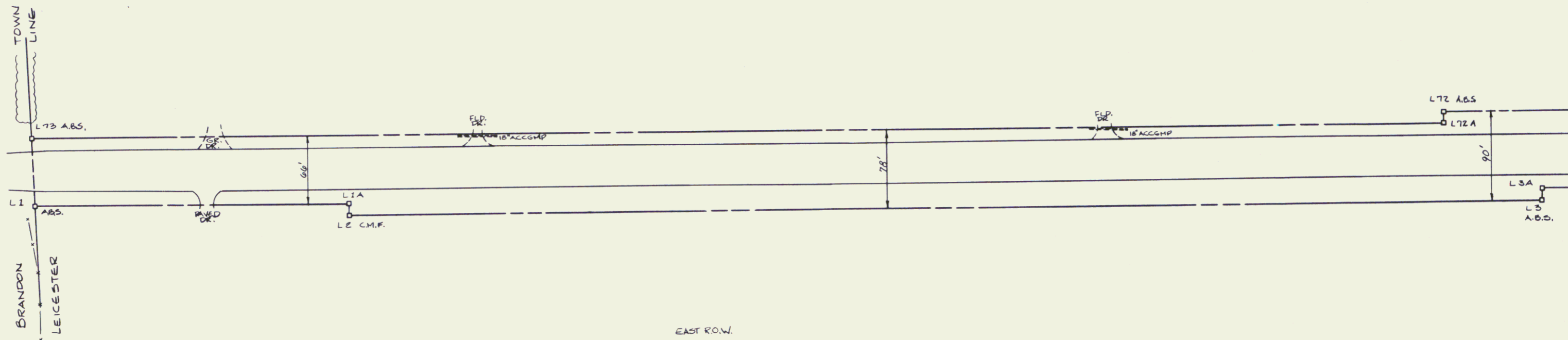

POINT #	NORTH	EAST	BEARING	DIST.
L1	490509.69	340008.13	N00°-23'-22"W	312.68
L1A	490822.36	340006.00	S71°-58'-51"E	12.32
L2	490818.55	340017.72	N00°-25'-26"W	1203.90
L3	492022.42	340008.80	S09°-33'-39"W	12.00
L3A	492022.33	339996.80	N00°-32'-04"W	601.00
L3B	492623.30	339991.20		

- LEGEND**
- A.B.S. ALUMINUM BOUND SET
  - C.M.F. CONCRETE MONUMENT FOUND
  - MONUMENT NOT SET
  - I.P.F. IRON PIPE FOUND
  - I.R.F. IRON ROD FOUND
  - GR.DR. GRAVEL DRIVE
  - FLD.DR. FIELD DRIVE
  - S.W.F. STORY WOOD FRAME
  - D.D.I. DROP INLET
  - C.B. CATCH BASIN



ALL BEARINGS ARE REFERENCED TO THE VERMONT STATE PLANE COORDINATE SYSTEM.

STATE OF VERMONT  
 US ROUTE 7 RIGHT-OF-WAY  
 LEICESTER FEGC FORM-3 (29)  
 VERMONT SURVEY CONSULTANTS, INC.  
 58 EAST STATE ST.  
 MONTPELIER, VT.

DATE: JULY 1989    SCALE: 1" = 50'    SHEET: 1 OF 12