

INDEX OF SHEETS

1 - 12 R.O.W. DETAIL SHEETS

# STATE OF VERMONT AGENCY OF TRANSPORTATION



## PROPOSED IMPROVEMENT **TOWN OF LEICESTER** COUNTY OF ADDISON **U.S. RTE. 7**

BEGINNING AT THE BRANDON/LEICESTER TOWN LINE AND  
EXTENDING NORTHERLY TO THE LEICESTER/SALISBURY TOWN LINE.

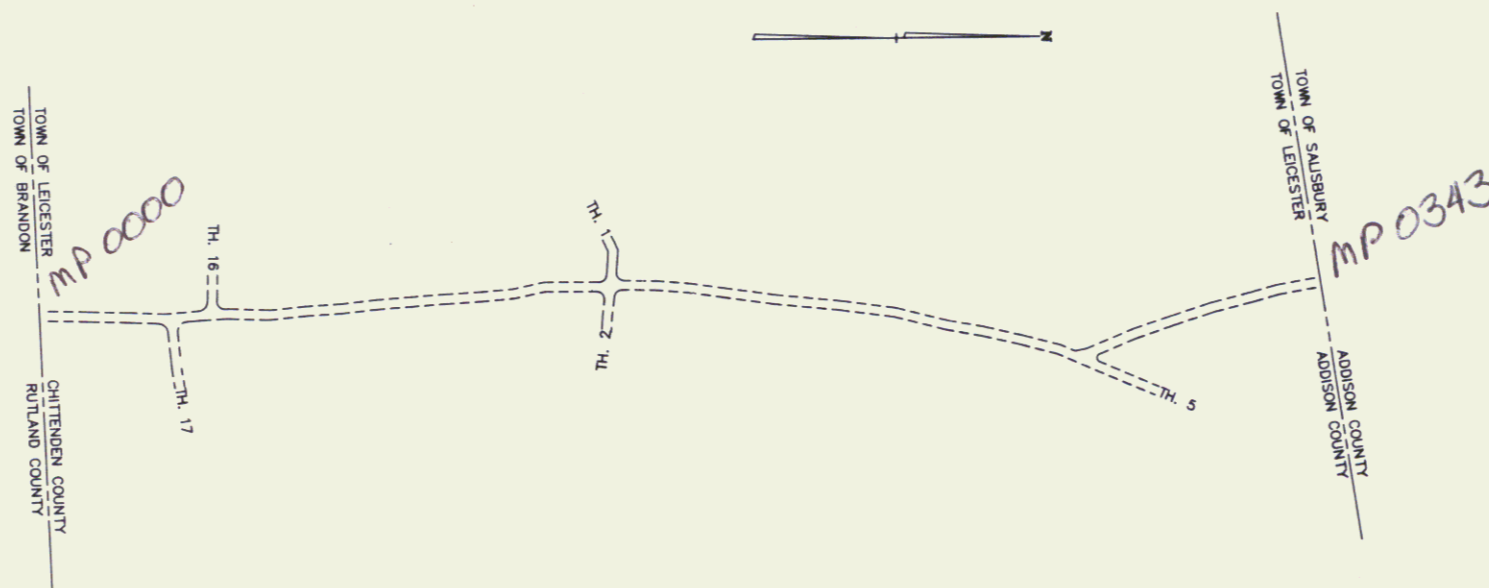
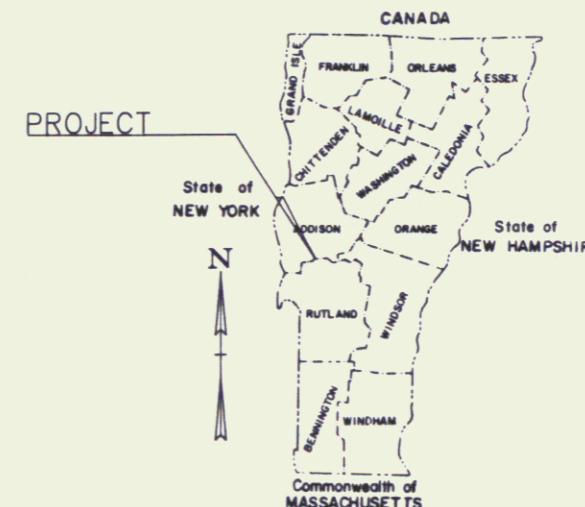

U.S. Rte #7  
RIGHT-OF-WAY DIVISION  
TOWN FILE  
PERPETUAL  
Town of LEICESTER  
(To Be Returned To R.O.W. Division)  
M m 0.00 - 3.425

CONVENTIONAL SIGNS

COUNTY LINE	---
TOWN LINE	- - - -
LIMITS OF ACCESS	○ ○ ○ ○
POINT OF ACCESS	X
FENCE LINE	— · — ·
STONE WALL	— · · · · ·
TRAVELED WAY	— · · · · ·
GUARD RAIL	— · · · · ·
RAILROAD	— · · · · ·
SURVEY LINE	— · · · · ·
CULVERT	— · · · · ·
POWER POLE	○
TELEPHONE POLE	○
TREES	○ X
CONTROL OF ACCESS	///
PROPERTY LINE	— · · · · ·
TOW TAKING LINE	— · · · · ·
SLOPE RIGHTS	○ SR ○
TOP OF CUT	○
TOE OF SLOPE	○

DATUM

VERTICAL	_____
HORIZONTAL	_____

SOURCES FOR DETERMINING RIGHT - OF - WAY WIDTHS  
SN F.A. PROJECT 109 G(1)  
F.A. PROJECT 109 H(1)  
F-ECC-019-3(34)S  
ROS 019-3(13)  
ROS 019-3(7)



THESE PLANS ARE SUBJECT TO SUCH ENGINEERING  
CHANGES AS MAY BE REQUIRED BY THE FEDERAL HIGHWAY  
ADMINISTRATION OR THE CHIEF ENGINEER.  
CONSTRUCTION IS TO BE CARRIED ON IN ACCORDANCE  
WITH THESE PLANS AND THE STANDARD SPECIFICATIONS  
FOR CONSTRUCTION DATED 1986, AS APPROVED BY THE  
FEDERAL HIGHWAY ADMINISTRATION ON NOVEMBER 21, 1985  
FOR USE ON THIS PROJECT, INCLUDING ALL SUBSEQUENT  
REVISIONS AND SUCH REVISED SPECIFICATIONS AND  
SPECIAL PROVISIONS AS ARE INCORPORATED IN THESE  
PLANS.

Project No. **FEGC FO19-3(29)**

SUBMITTED BY ORDER OF THE STATE TRANSPORTATION BOARD	
APPROVED _____	DATE _____
DEPARTMENT OF TRANSPORTATION FEDERAL HIGHWAY ADMINISTRATION	
APPROVED _____	DATE _____
DIVISION ADMINISTRATOR	
PROJECT _____	NR _____
SHEET <b>1</b> OF _____	SHEETS _____

780051

23