

POINT #	NORTH	EAST	BEARING	DIST
B73	460057.94	354660.75	S08°53'34" E	1151.61
B74	458920.17	354838.80	S08°59'04" E	853.62

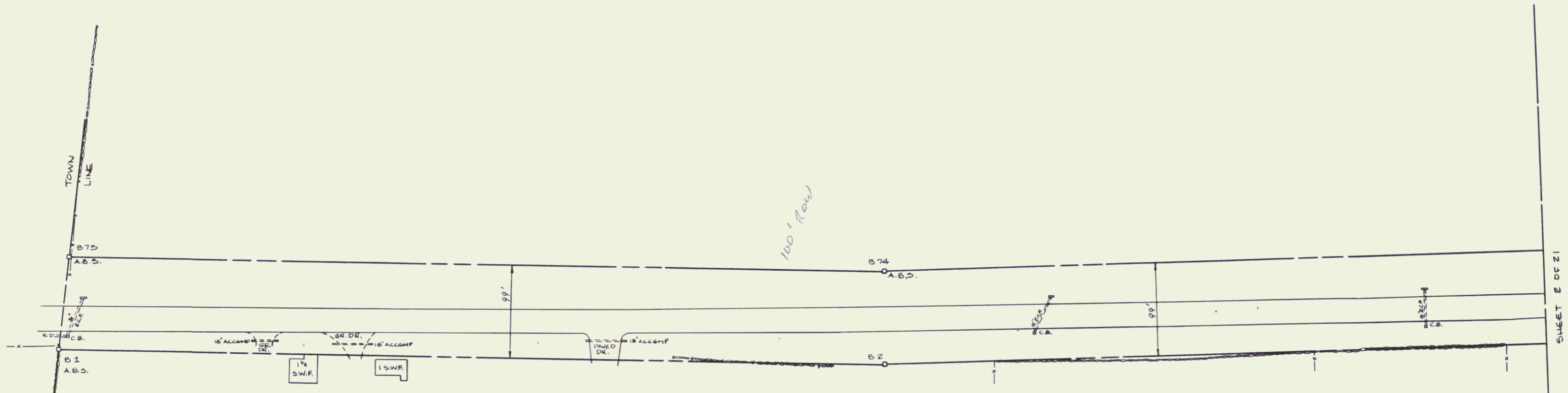

POINT #	NORTH	EAST	BEARING	DIST.
B1	458073.11	355027.14	N05°54'04" W	844.61
B2	458933.00	354937.00	N08°53'55" W	1158.30
B3	460077.34	354757.83		

- LEGEND**
- A.B.S. ALUMINUM BOUND SET
 - C.M.F. CONCRETE MONUMENT FOUND
 - MONUMENT NOT SET
 - I.P.F. IRON PIPE FOUND
 - I.R.F. IRON ROD FOUND
 - GR.DR. GRAVEL DRIVE
 - FLD.DR. FIELD DRIVE
 - S.W.F. STORK WOOD FRAME
 - DI DROP INLET
 - CB CATCH BASIN

ALL BEARINGS ARE REFERENCED TO THE VERMONT STATE PLANE COORDINATE SYSTEM.

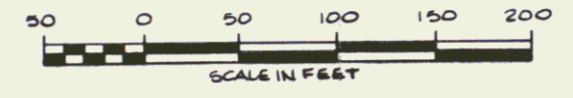

100' R.O.W.

STATE OF VERMONT
 U.S. ROUTE 7 RIGHT-OF-WAY
 BRANDON FGCC F019-5 (29)
 VERMONT SURVEY CONSULTANTS, INC.
 58 EAST STATE ST.
 MONTPELIER, VT.

DATE: JULY 1989	SCALE: 1" = 50'	SHEET: 7 OF 21
--------------------	--------------------	-------------------