

CONSTRUCT DRIVE
 *US 7 APPROACH 72+30 LT.
 *M 1909+50 LT.

WOVEN WIRE FENCE
 W/ STEEL POSTS
 REV. 1896+10 - 1897+10
 1898+95 RT.

DRILLING AND BLASTING
 OF SOLID ROCK SUBGRADE
 RAMP "H" 80100 ~ 88+00



① US 7 APPROACH SURV. CURVE DATA	② US 7 APPROACH SURV. CURVE DATA	③ RAMP T SURV. CURVE DATA	④ RAMP H SURV. CURVE DATA
Δ 22°00' LT	Δ 12°06' RT	Δ 99°54' LT	Δ 43°00' LT
D 12°30'	D 12°30'	D 87.75795°	D 12.07829°
R 458.37	R 458.37	R 65.29	R 474.37
T 89.10	T 48.68	T 77.67	T 186.86
L 176.00	L 96.80	L 113.84	L 356.01
E 8.58	E 2.57	E 36.15	E 35.48
BANK 0.063 FT/FT	BANK 0.063 FT/FT	BANK 0.063 FT/FT	BANK 0.063 FT/FT

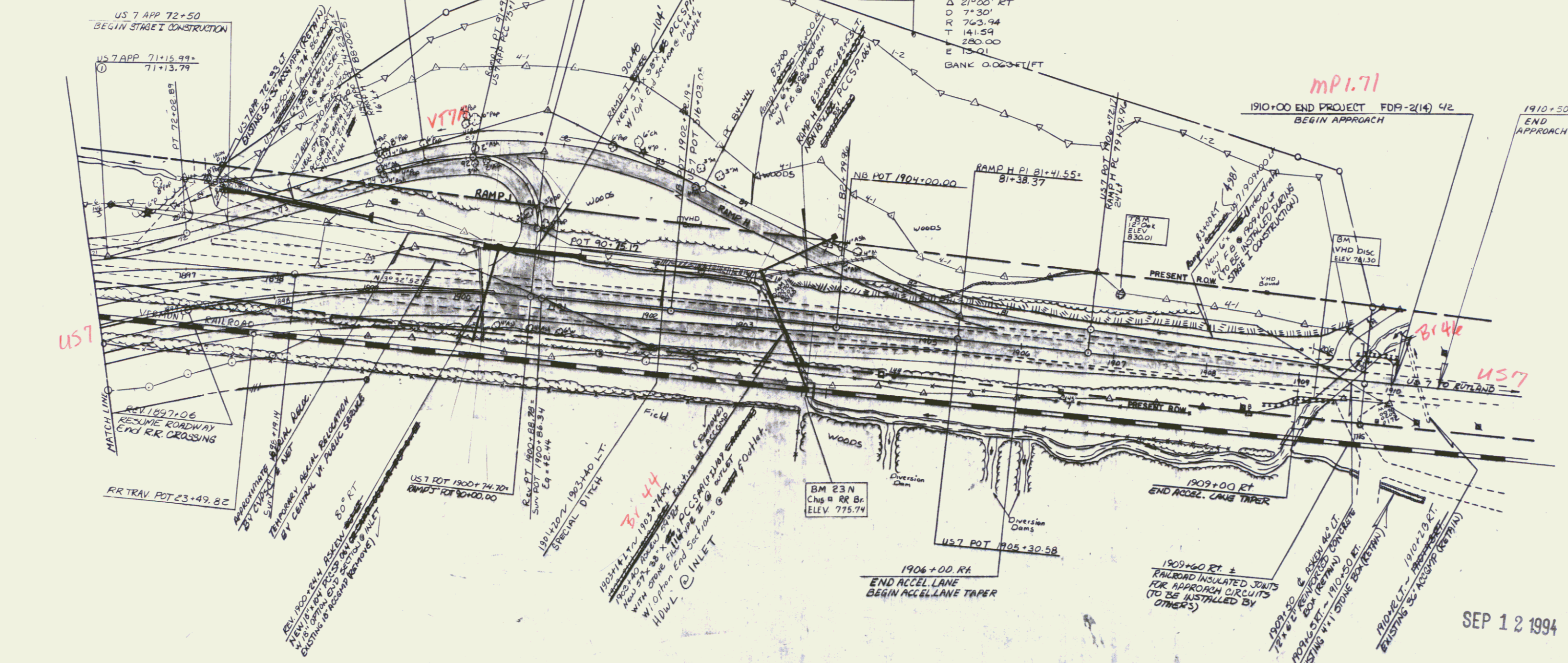

DATUM
 VERTICAL NGVD 1929
 HORIZONTAL NAD 1927

NOTE: SOLID ROCK EXCAVATION STA. 1906+72.71-1909+30 LT & DRAINAGE ITEMS ON EXISTING US 7 IS THE ONLY MAINLINE CONSTRUCTION TO BE ACCOMPLISHED BEYOND REV. STA 1895+00 DURING STAGE I CONSTRUCTION.

SCALE IN FEET
 0 25 50 75 100

1896+00 - 1904+50
 SURVEYED BY FANTONI DATE 12-81
 DRAWN BY P. ALLEN DATE 1-82
 TRACED BY SK. MANUWZ DATE 1-88
 Manchester - Dorset
 PROJ. NO. 018-2(14)
 SHEET 64 OF 411

SEP 12 1994

* DENOTES STAGE II CONSTRUCTION