

CONSTRUCT DEBRIS RACK
1781+50 RT.
(6+25 CHAN. LINE)

*STEEL BEAM GUARD RAIL
1774+25 ~ 1777+12.5 RT
1774+32.5 ~ 1777+25 LT

WOVEN WIRE FENCE
W/STEEL POSTS
1769+50 ~ 1776+10 RT.
1776+45 ~ 1782+00 LT.
1782+00 ~ 1785+00 RT.
1769+50 ~ 1785+00 LT.

Erosion Matting
1777+30 ~ 1780+50 RT.
1777+50 ~ 1780+50 LT.

* DENOTES STAGE II CONSTRUCTION

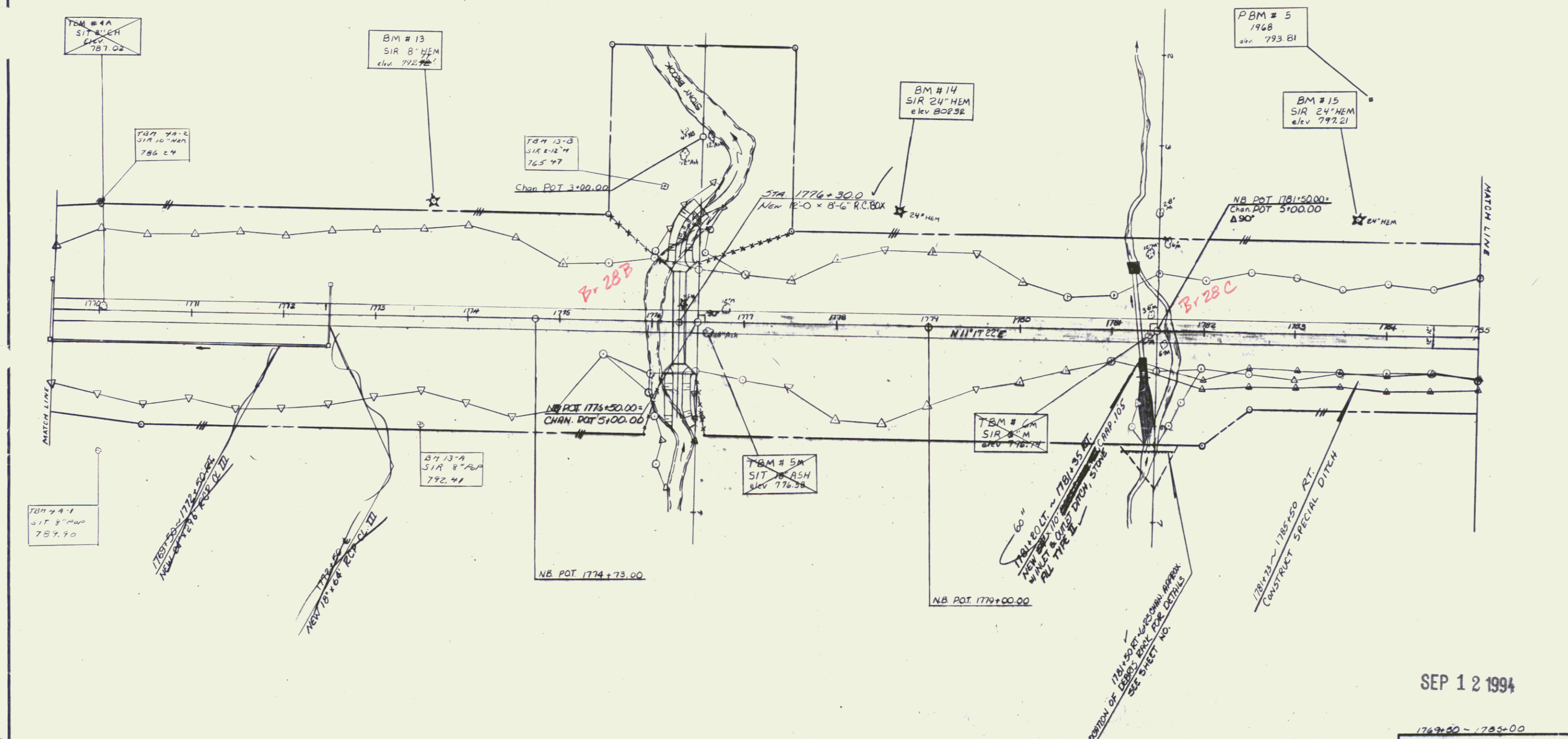

DATUM
VERTICAL NGVD 1922
HORIZONTAL NAD 1927

NOTE: NB 1769+50 RT ~ NB 1785+00 RT.
HARDWOOD TREES CUT FOR CONSTRUCTION
PURPOSES WILL BE CUT INTO FOUR FOOT
LENGTHS AND STACKED NEAR THE RIGHT-OF-
WAY, IN AN ACCESSIBLE LOCATION, ON
OWNER'S PROPERTY.

SCALE
0 50 100 150 200 FT
SEE NEXT SHEET FOR TIES

SEP 12 1994
1769+50 - 1785+00
SURVEYED BY Coarse DATE 3/79
DRAWN BY B. Boyd DATE 5/79
TRACED BY W. Higgins DATE 2/89
MANCHESTER-DORSET
PROJ. E NO 019-2(14)
SHEET 45 of 411