

INDEX OF SHEETS
 1C TITLE SHEET
 2C INDEX OF SHEETS

STATE OF VERMONT
 AGENCY OF TRANSPORTATION

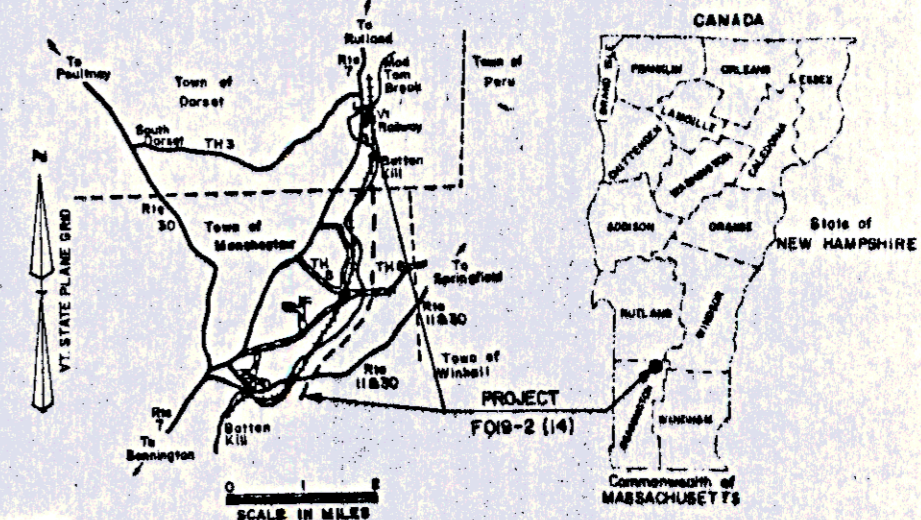

PROPOSED IMPROVEMENT
 TOWNS OF MANCHESTER & DORSET
 COUNTY OF BENNINGTON
 U.S. ROUTE 7 F.A.P.



RECORD PLANS
 CONTRACTOR J.A. McDONALD, INC.
 LYNDON CENTER, VT
 RESIDENT ENGINEER PAUL HORTON
 CONSTRUCTION BEGAN MAY 18, 1989
 CONSTRUCTION COMPLETED DECEMBER 26, 1990
 RECORD PLANS BY NATE THAYER

I hereby certify that all the construction required by this set of drawings has been accomplished as indicated herein.
 By Paul Horton, Resident Engineer
 Date April 22, 1991

NOTE: Any further information concerning final quantities, amounts or other details relative to this project may be found on microfilm in Central Files.

Beginning at a point 3.5 miles southerly of the Manchester-Dorset town line and extending northerly 4.746 miles.

Length of Roadway 24572.62 Feet = 4.654 Miles
 Length of Bridges 388.78 Feet = 0.073 Miles
 Length of Railroad Crossing 99.00 Feet = 0.019 Miles
 Length of Project 25060.40 Feet = 4.746 Miles

This project consists of the construction of U.S. 7 on a completely new location.

TRAFFIC DATA
 1987 ADT 3500
 1987 D+V 485
 2007 ADT 4500
 2007 D+V 625
 T 5%
 D 5%
 V 60 MPH

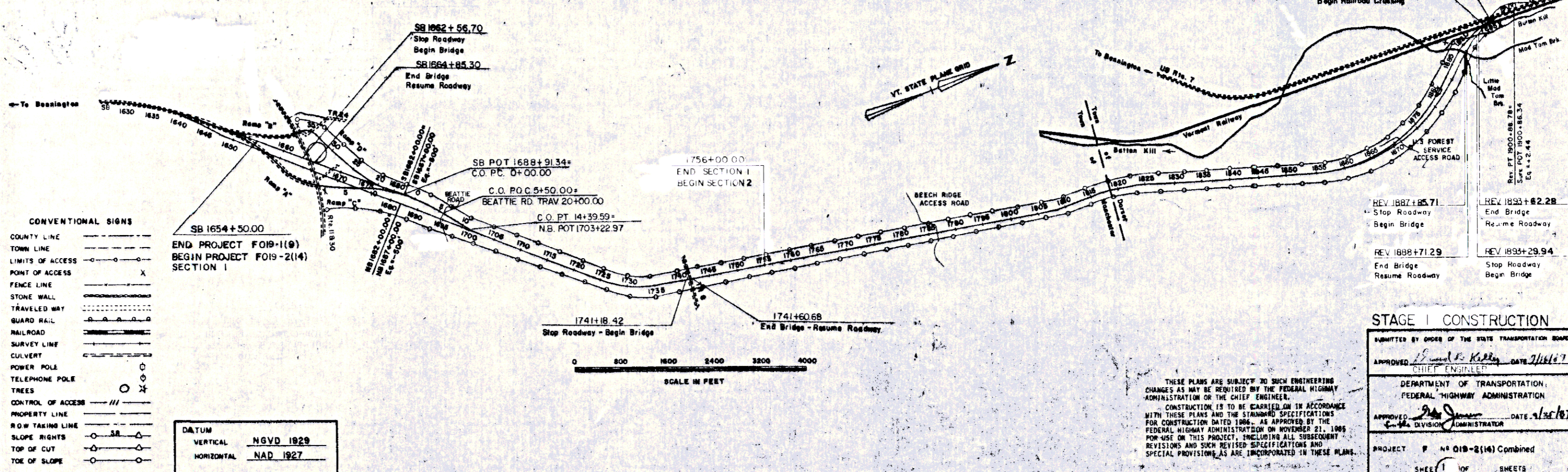

- CONVENTIONAL SIGNS
- COUNTY LINE
 - TOWN LINE
 - LIMITS OF ACCESS
 - POINT OF ACCESS
 - FENCE LINE
 - STONE WALL
 - TRAVELED WAY
 - GUARD RAIL
 - RAILROAD
 - SURVEY LINE
 - CULVERT
 - POWER POLE
 - TELEPHONE POLE
 - TREES
 - CONTROL OF ACCESS
 - PROPERTY LINE
 - ROW TAKING LINE
 - SLOPE RIGHTS
 - TOP OF CUT
 - TOE OF SLOPE

DATUM
 VERTICAL NGVD 1929
 HORIZONTAL NAD 1927

SCALE IN FEET
 0 800 1600 2400 3200 4000

REV 1897+06.00
 End Railroad Crossing
 Resume Roadway

REV 1896+07.00
 Stop Roadway
 Begin Railroad Crossing

REV 1887+85.71
 Stop Roadway
 Begin Bridge

REV 1898+71.29
 End Bridge
 Resume Roadway

REV 1895+62.28
 End Bridge
 Resume Roadway

REV 1895+29.94
 Stop Roadway
 Begin Bridge

THESE PLANS ARE SUBJECT TO SUCH ENGINEERING CHANGES AS MAY BE REQUIRED BY THE FEDERAL HIGHWAY ADMINISTRATION OR THE CHIEF ENGINEER.
 CONSTRUCTION IS TO BE CARRIED ON IN ACCORDANCE WITH THESE PLANS AND THE STANDARD SPECIFICATIONS FOR CONSTRUCTION DATED 1986, AS APPROVED BY THE FEDERAL HIGHWAY ADMINISTRATION ON NOVEMBER 21, 1986 FOR USE ON THIS PROJECT, INCLUDING ALL SUBSEQUENT REVISIONS AND SUCH REVISED SPECIFICATIONS AND SPECIAL PROVISIONS AS ARE INCORPORATED IN THESE PLANS.

STAGE I CONSTRUCTION

SUBMITTED BY ORDER OF THE STATE TRANSPORTATION BOARD

APPROVED Paul Horton CHIEF ENGINEER DATE 7/16/87

DEPARTMENT OF TRANSPORTATION
 FEDERAL HIGHWAY ADMINISTRATION

APPROVED [Signature] DATE 1/24/87

PROJECT # 018-2(14) Combined

SHEET 1 OF 1 SHEETS