

CONSTRUCT DRIVE
 REV. 18+65 LT.
 REV. 19+20 RT.
 REV. 20+00 RT.
 VT. II 19+67 LT.

GUARD RAIL, THREE CABLE
 W/LIGHT WOOD POSTS
 REV. 11+86 LT. ~ REV. 18+50 LT.

BEGIN R.O.W. PROJECT
 RFO19-2(14) SECT. I STA. SB 1656+00 698' LT.

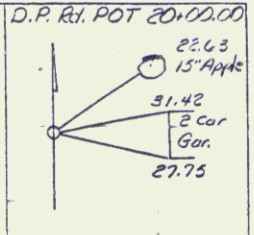
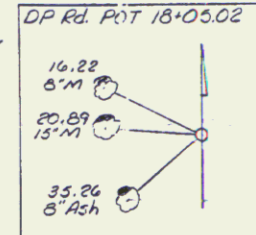
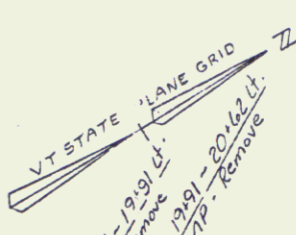
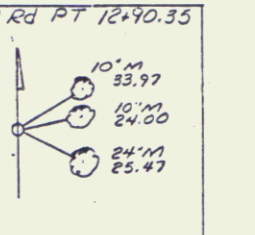
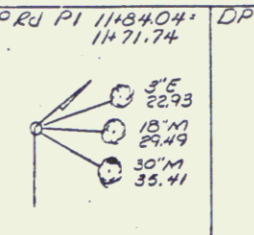
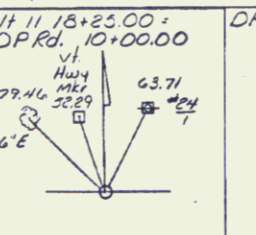
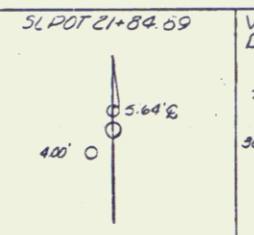
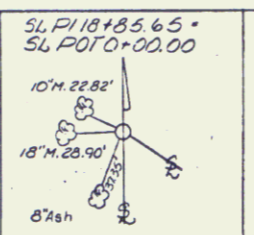
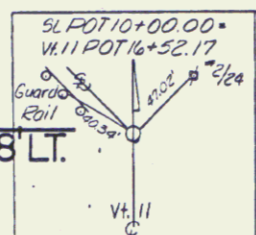

PLAN

DATE	
BY	
CHECKED	
APPROVED	
SCALE	
NOTE BOOK	
NO.	

PROFILE

DATE	
BY	
CHECKED	
APPROVED	
SCALE	
NOTE BOOK	
NO.	

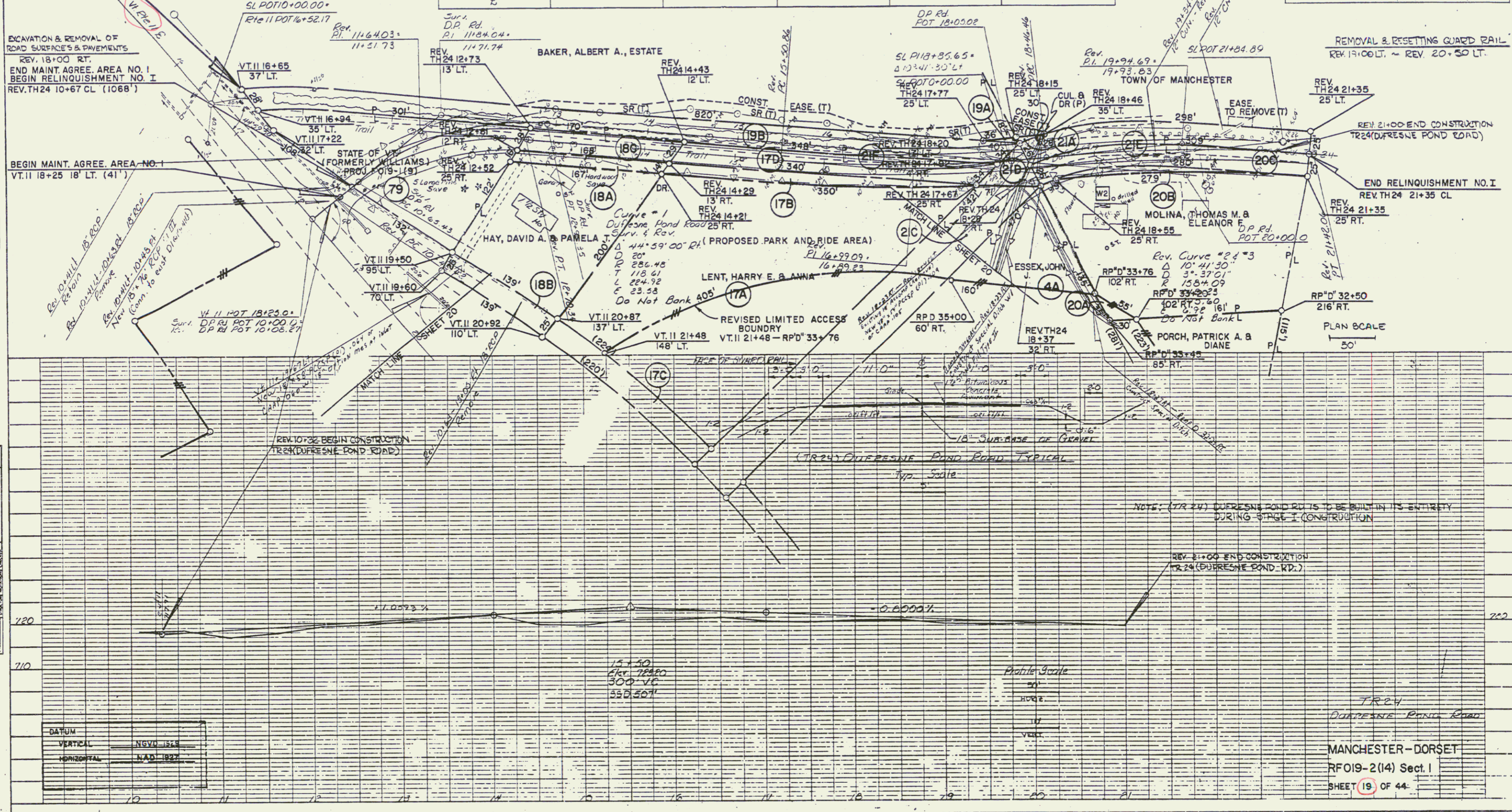

NOTE: (TR 24) DUFRESNE POND RD IS TO BE BUILT IN ITS ENTIRETY DURING STAGE I CONSTRUCTION

REV. 21+00 END CONSTRUCTION TR 24 (DUFRESNE POND RD.)

MANCHESTER-DORSET
 RFO19-2(14) Sect. I
 SHEET 19 OF 44

JUL 25 1994