

Future	Existing	(Surv. & Rev.)	(Surv. & Rev.)	5	6	7	8	9	10	(Rev. & Surv.)	12
1 NB curve no. 1 Δ 22°22'30" Rt D 100' R 5729.58 T 1133.19 L 2237.50 E 110.99 Bnk. 0.038 Ft./ft.	2 SB curve no. 1 Δ 22°22'30" Rt D 100' R 5729.58 T 1133.19 L 2237.50 E 110.99 Bnk. 0.038 Ft./ft.	3 Dufresne Pond Road Δ 44°59'00" Rt. D 20°00' R 285.48 T 118.61 L 224.92 E 23.58 Bnk. Do Not Bank Rev. P.I. 11+64.03+ 11+51.73 Rev. P.C. 10+45.42 Rev. P.T. 12+70.34	4 Dufresne Pond Road Δ 10°41'30" Lt. & Rt. D 3°37'01" R 1594.09 T 148.23 L 295.60 E 6.92 Bnk. Do Not Bank Rev. P.I. 16+99.09+ 16+89.23 Rev. P.C. 15+50.86 Rev. P.R.C. 18+46.46 Rev. P.I. 19+94.89+ 19+93.83 Rev. P.R.C. 18+46.46 Rev. P.T. 21+42.06	5 Ramp "E" curve no. 1 Δ 269°59'57.5" Rt. D 240.0 T 1130.97 E 1130.97 Bnk. 0.080 Ft./ft. P.C. 10+00.00 P.C.C. 21+30.97	6 Ramp "E" curve no. 2 Δ 46°39'00" Rt. D 23.722969° R 241.52 T 104.14 L 196.64 E 21.49 Bnk. 0.080 Ft./ft. P.I. 22+35.11+ 22+23.47 P.C.C. 21+30.97 P.T. 23+27.61	7 Ramp "C" curve Δ 17°59'00" Rt. D 4°00' R 1432.40 T 226.66 L 449.58 E 17.82 Bnk. 0.063 Ft./ft. P.I. 11+44.22+ 11+40.48 P.C. 9+17.56 P.T. 13+67.14	8 Ramp "D" curve no. 1 Δ 38°48'00" Rt. D 4°00' R 1432.40 T 476.49 L 920.00 E 77.17 Bnk. 0.063 Ft./ft. P.I. 24+76.49+ 24+43.51 P.C.C. 20+00.00 P.T. 29+20.00	9 Ramp "D" curve no. 2 Δ 68°05'00" Lt. D 13°30' R 424.41 T 410.45 L 652.47 E 166.0 Bnk. 0.069 Ft./ft. P.I. 36+41.90+ 34+73.47 P.C. 32+31.45 P.T. 38+83.92	10 CO. no. 2 curve no. 1 Δ 9°10'00" Rt. D 1°30' R 3819.72 T 306.21 L 611.11 E 12.25 Bnk. 0.040 Ft./ft.	11 (Rev. & Surv.) CO. no. 2 curve no. 2 Δ 9°08'55" Lt. D 1°30' R 3819.72 T 306.21 L 609.91 E 12.21 Bnk. 0.040 Ft./ft.	12 NB curve no. 2 Δ 30°42'43" Lt. Dc 2°16' Rc 2546.48 Ls 190.00 Os 2°8'15" Ac 26°26'13" p 0.58 k 95.00 Xc 189.97 Yc 2.32 Ts 794.48 Lc 1174.97 Es 94.87 Lt 126.67 St 63.34 Lc 189.99 Bnk.

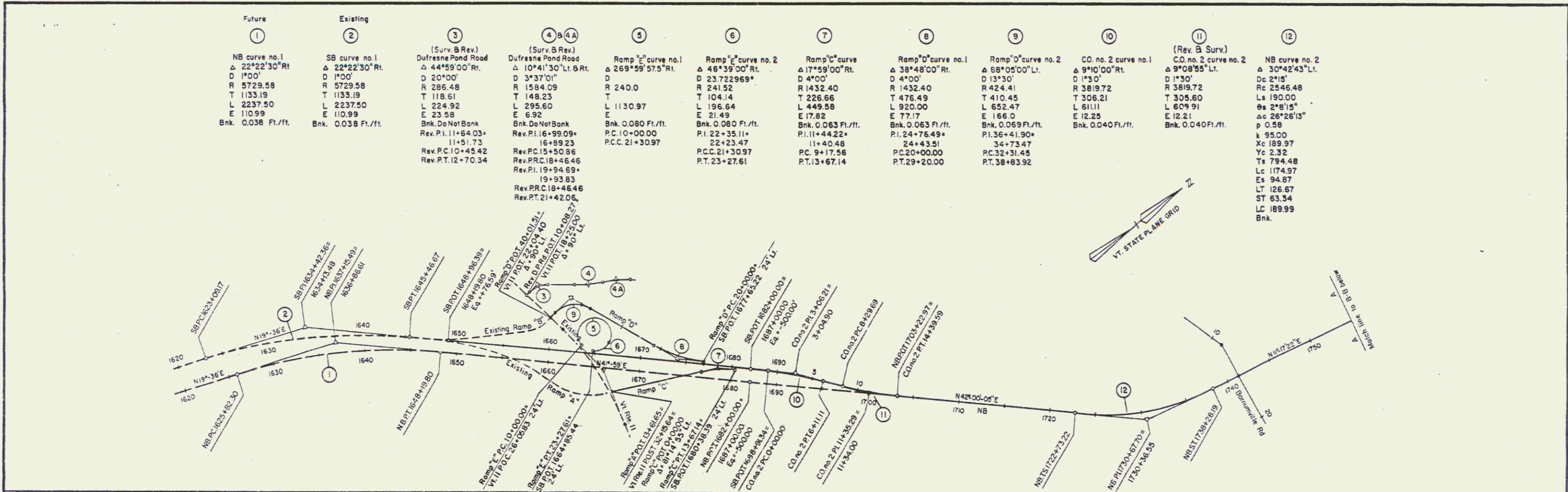

13 Δ 10°30' Lt D 2° R 2864.79 T 263.24 L 525.00 E 12.07	14 Δ 15°30' Rt D 2° R 2864.78 T 289.88 L 775.00 E 26.4	15 Surv. & Rev. Δ 57°14'30" Lt D 2° R 2864.79 T 1563.20 L 2861.94 E 388.74	16 Surv. Δ 44°30' Rt D 5° R 1432.40 L 112.50 E 115.24	17 Rev. Δ 44°30' Rt D 4° R 1432.40 T 586.01 L 112.50 E 115.24
---	--	---	---	--



JUL 25 1994

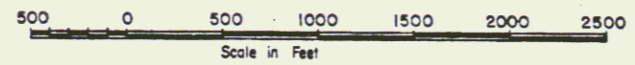

CONTRACT I
ALIGNMENT SHEET

SURVEYED BY Rod S. DATE 10-79
DRAWN BY Rod S. DATE 10-79
TRACED BY Rod S. DATE 10-79

MANCHESTER-DORSET
PROJ. RF NO. 019-2 (14)
SHEET 2 OF 44