

WEATHERSFIELD RS 0151(4)

- INDEX OF SHEETS
- TITLE SHEET
 - QUANTITY SHEETS
 - BLANK
 - SEQUENCE TO MAINTAIN TRAFFIC
 - CONSTRUCTION U/G.A. AND TRAFFIC SIGNAL LOCATIONS
 - ONE-WAY TEMPORARY TRAFFIC SIGNAL
 - VEHICLE LOAD DETAILING DETAILS
 - WEEKLY MEDIUM DUTY FOR TEMP. TRAFFIC CONTROL
 - ROADWAY TYPICAL & PROFILE
 - LAYOUT
 - PRELIMINARY INFORMATION
 - TYPICAL BRIDGE SECTION
 - ABUT. 1 DETAILS
 - ABUT. 2 DETAILS
 - ABUTMENT EXTENSIONS
 - ABUTMENT EXTENSIONS
 - WINGWALL REINFORCING DETAILS
 - APPROACH SLAB DETAILS
 - PIER 1 DETAILS
 - PIER 2 DETAILS
 - PIER SECTION VIEWS (TYP)
 - BEARING DETAILS
 - FRAMING PLAN
 - ELATED GIRDER DETAIL
 - BEARING STIFFENER DETAILS
 - ABUT. CROSS FRAME
 - CROSS FRAME DETAILS

- JOINT AND DOWNSPOUT DETAILS
- EXISTING DETAILS AT PIER JOINTS
- DETAILS AT PIER JOINT
- EXPANSION JOINT DETAILS
- DECK REINFORCING DETAILS
- BRIDGE RAIL AND CURB DETAILS
- SCUPPER DETAILS
- REINFORCING STEEL SCHEDULE
- N/L X-SECTIONS
- T.H. 70 X-SECTIONS
- 38-42 REFERENCE SHEETS

STANDARD SHEETS

B-1	10/25/85 R
B-5	12/06/71
B-13	12/14/71
E-3	2/03/86 R
E-9	2/03/86 R
E-7	2/03/86 R
E-7A	2/03/86 R
E-8	2/03/86 R
E-15	2/03/86 R
E-15b	2/03/86 R
E-19	2/03/86 R
E-19b	2/03/86 R
E-24A	2/03/86 R
E-29	2/03/86 R
E-31	2/03/86 R
E-36	2/03/86 R
E-50	2/03/86 R
G-1	10/31/85 R
G-1D	10/31/85 R
G-14	10/31/85 R
T-1	12/07/76 R
T-2	7/05/72
SB R4A 82	12/13/84 R
SD R4B 82	12/13/84 R
SCB-D1-75	9/14/81 R
SCB-D1-76	10/11/83 R
SCB-D5-73 B C D	1/03/79 R
SCB-D5-74	12/15/76 R

- CONVENTIONAL SIGNS
- COUNTY LINE
 - TOWN LINE
 - LIMITS OF ACCESS
 - POINT OF ACCESS
 - FENCE LINE
 - STONE WALL
 - TRAVELED WAY
 - GUARD RAIL
 - RAILROAD
 - SURVEY LINE
 - CULVERT
 - DWEE POLE
 - TELEPHONE POLE
 - TREES
 - CONTROL OF ACCESS
 - PROPERTY LINE
 - ROW TAKING LINE
 - SLOPE RIGHTS
 - TOP OF CUT
 - TOE OF SLOPE
- DATUM
VERTICAL NGVD 1929
HORIZONTAL N/A

STATE OF VERMONT
AGENCY OF TRANSPORTATION



PROPOSED IMPROVEMENT
TOWN OF WEATHERSFIELD
COUNTY OF WINDSOR
VERMONT RTE. 106 (F.A.S.)

IN THE TOWN OF WEATHERSFIELD, BEGINNING AT A POINT ON VT. ROUTE 106 WHICH IS 2.282 MILES NORTHERLY OF THE SPRINGFIELD, WEATHERSFIELD TOWN LINE AND EXTENDING NORTHERLY FOR 0.076 MILES

LENGTH OF ROADWAY 111.25 FEET = 0.021 MILES
LENGTH OF BRIDGE 288.78 FEET = 0.055 MILES
LENGTH OF PROJECT 400.00 FEET = 0.076 MILES

WORK TO CONSIST OF: REMOVING EXISTING CONCRETE DECK, WING WALLS, AND BACKWALLS AS REQUIRED; EXTEND PIERS, ADJUSTMENT CAP BEAMS, ERECT NEW OUTSIDE GIRDERS, AND CONSTRUCT APPROACH SLABS, NEW WINGS & BACK WALLS; REPAIR AND/OR REPLACE EXISTING STRUCTURAL STEEL; SANDBLAST & PAINT STRUCTURAL STEEL; CONSTRUCT NEW REINFORCED CONCRETE DECK WITH A WIDENED TYPICAL; AND PERFORM RELATED ROADWORK.

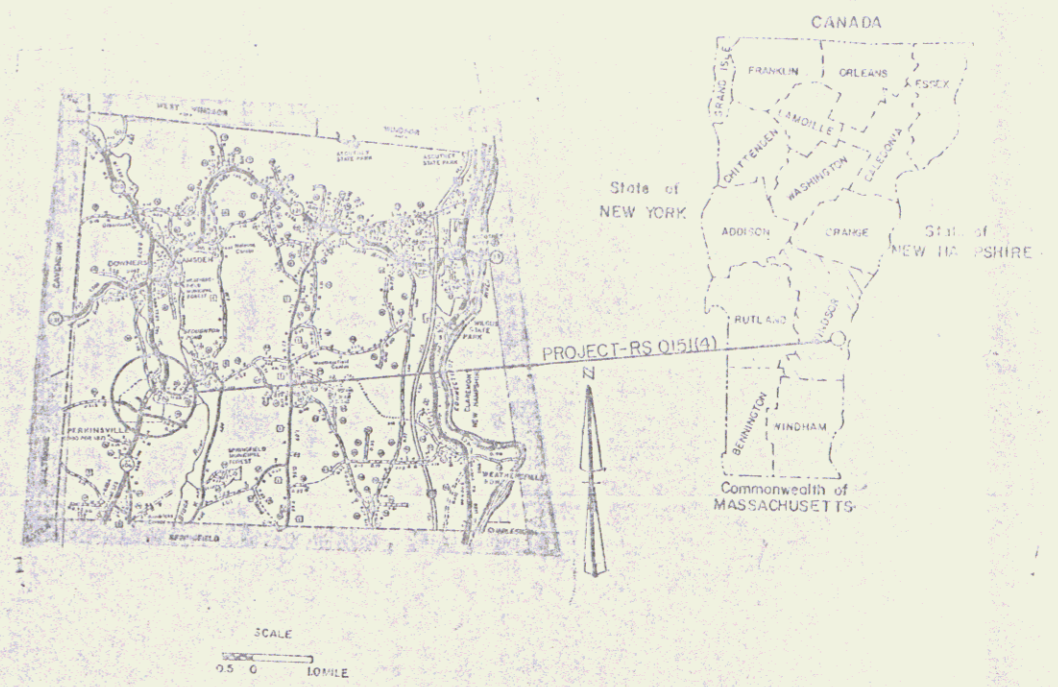

FOR RECORD PLANS ON MATERIAL SUPPLIERS SPECIFICATIONS

TRAFFIC DATA

ADT	1987	1997
DHV	2470	2910
D	345	410
V		56%
T	40 MPH	(DHV) 7%
T		(ADT) 6%

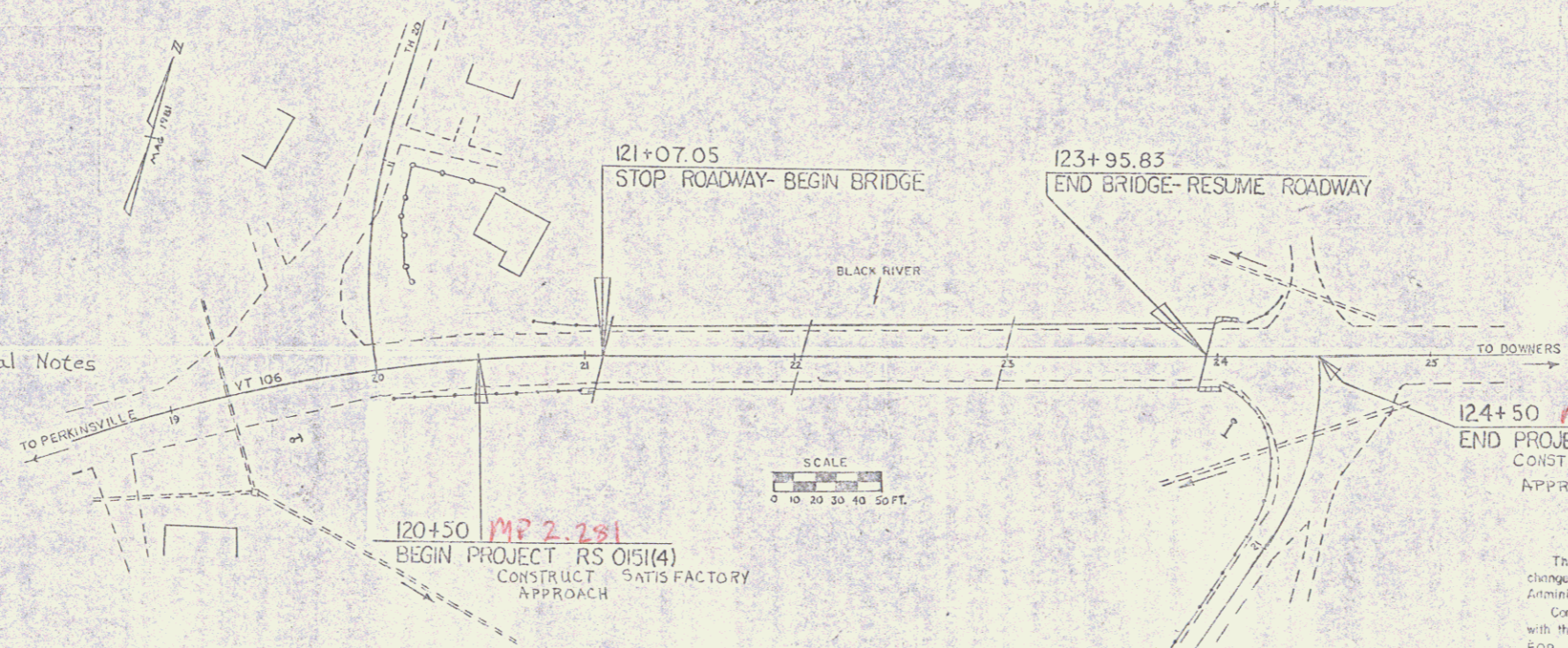

RIGHT-OF-WAY DIVISION
TOWN FILE
PERPETUAL
Rte. of VT # 106
(To Be Returned To R.O.W. Division)

AUG 15 1991
Pin # 778089
Date 8/15/1991

These plans are subject to such engineering changes as may be required by the Federal Highway Administration or the Director of Engineering and Construction. Construction is to be carried on in accordance with these plans and the Standard Specifications for Construction dated 1986.

for use on such revised specifications and special provisions as are incorporated in these plans.

SUBMITTED BY ORDER OF THE STATE TRANSPORTATION BOARD
APPROVED: *Donald B. Kelley* DATE 7/2/91
DIRECTOR ENGINEER & CONSTRUCTION
DEPARTMENT OF TRANSPORTATION
FEDERAL HIGHWAY ADMINISTRATION

APPROVED: _____ DATE _____
DIVISION ADMINISTRATOR

PROJECT: RS # 0151(4)
SHEET 0 OF 42 SHEETS

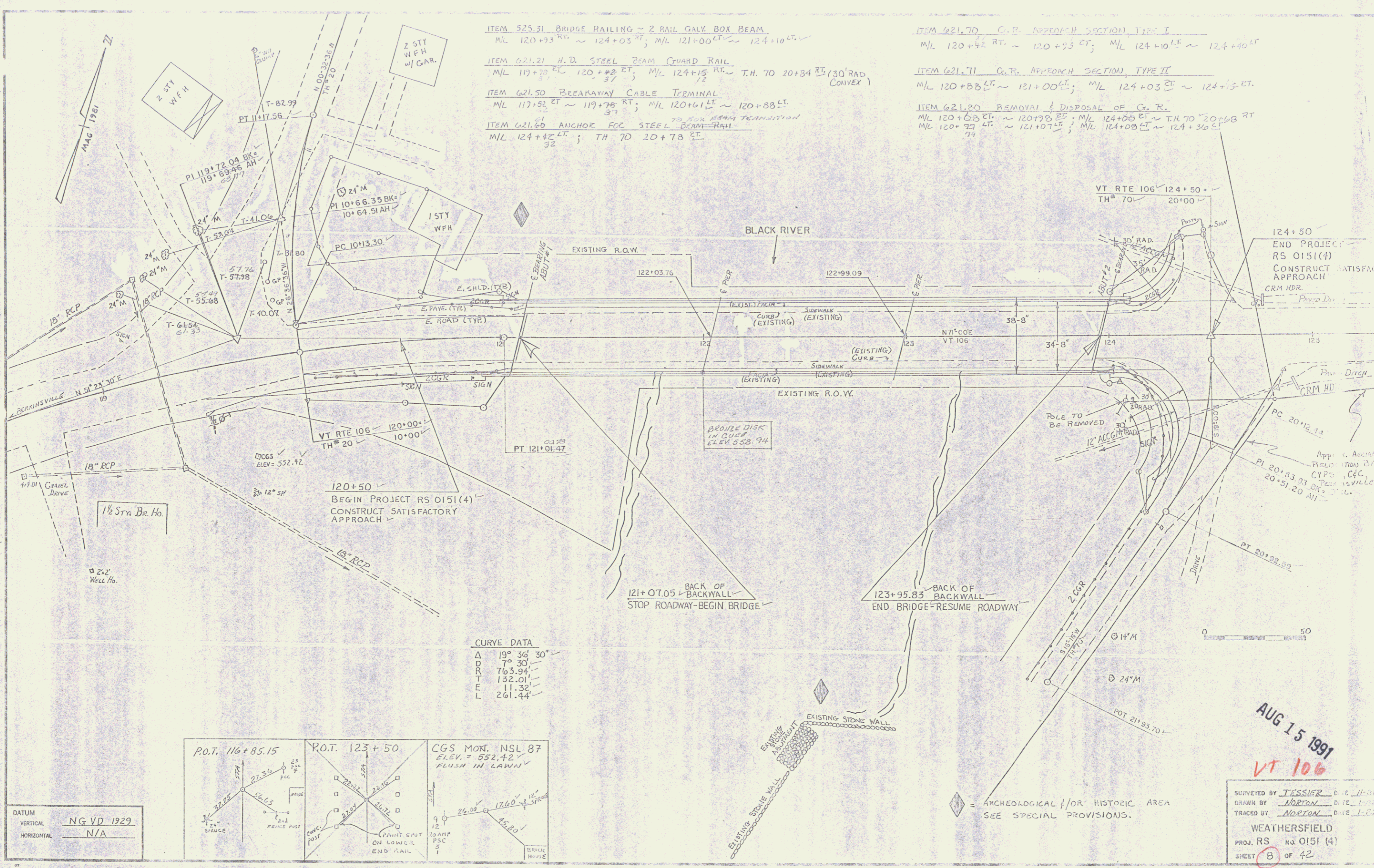

ITEM 525.31 BRIDGE RAILING ~ 2 RAIL GALV. BOX BEAM
 M/L 120+93 RT ~ 124+03 RT; M/L 121+00 LT ~ 124+10 LT

ITEM 621.21 H.D. STEEL BEAM GUARD RAIL
 M/L 119+78 EL ~ 120+42 RT; M/L 124+15 RT ~ T.H. 70 20+84 RT (30' RAD CONVEX)

ITEM 621.50 BREAKAWAY CABLE TERMINAL
 M/L 117+52 EL ~ 119+78 RT; M/L 120+61 LT ~ 120+88 LT

ITEM 621.60 ANCHOR FCC STEEL BEAM RAIL
 M/L 124+42 LT; T.H. 70 20+78 RT

ITEM 621.70 C.P. APPROACH SECTION TYPE I
 M/L 120+42 RT ~ 120+93 RT; M/L 124+10 LT ~ 124+40 LT

ITEM 621.71 C.P. APPROACH SECTION TYPE II
 M/L 120+88 LT ~ 121+00 LT; M/L 124+03 RT ~ 124+15 RT

ITEM 621.80 REMOVAL & DISPOSAL OF C.P.R.
 M/L 120+58 EL ~ 120+78 RT; M/L 124+06 EL ~ T.H. 70 20+68 RT
 M/L 120+73 LT ~ 121+07 LT; M/L 124+08 LT ~ 124+36 LT

CURVE DATA

Δ	19° 36' 30"
D	75.30'
R	763.94'
T	132.01'
E	11.32'
L	261.44'

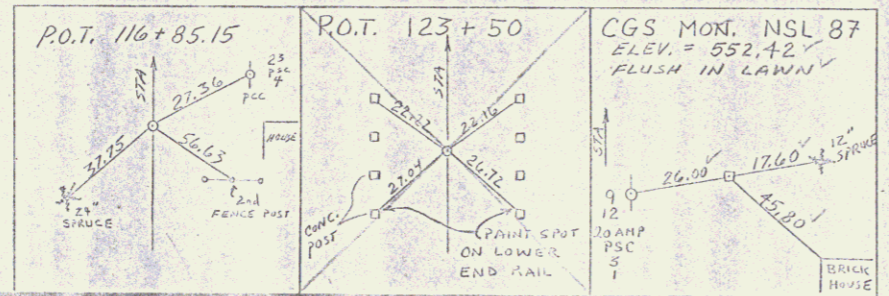

DATUM
 VERTICAL NGVD 1929
 HORIZONTAL N/A

AUG 15 1991
 VT 106

SUPPLIED BY JESSIE DATE 11-81
 DRAWN BY NORTON DATE 1-82
 TRACED BY NORTON DATE 1-82

WEATHERSFIELD
 PROJ. RS NO. 0151 (4)
 SHEET 8 OF 42