

INDEX OF SHEETS

- 1 TITLE
- 2-3 TYPICAL
- 4-5 DETAIL
- 6-8 LAYOUT
- 9-10 PROFILE

STATE OF VERMONT  
AGENCY OF TRANSPORTATION



PROPOSED IMPROVEMENT  
**TOWN OF TUNBRIDGE**  
COUNTY OF ORANGE  
**VT. RTE. 110**

FAS

BEGINNING AT A POINT ON VERMONT ROUTE 110 IN THE TOWN OF TUNBRIDGE 1.602 MILES NORTHERLY OF THE ROYALTON-TUNBRIDGE TOWN LINE AND EXTENDING NORTHERLY 0.268 MILES

LENGTH OF ROADWAY 9774.6 FT. = 1.865 MILES  
LENGTH OF BRIDGE 222.54 FT. = 0.418 MILES  
LENGTH OF PROJECT 10000 FT. = 1.883 MILES  
LENGTH OF R.O.W. PROJ. 13100.00 FT. = 2.489 MILES

R.O.W. PLANS

ALL DRIVES AS INDICATED ON PLANS ARE SUBJECT TO PERMITS PURSUANT TO TITLE 19, SECTION 43, V.S.A.

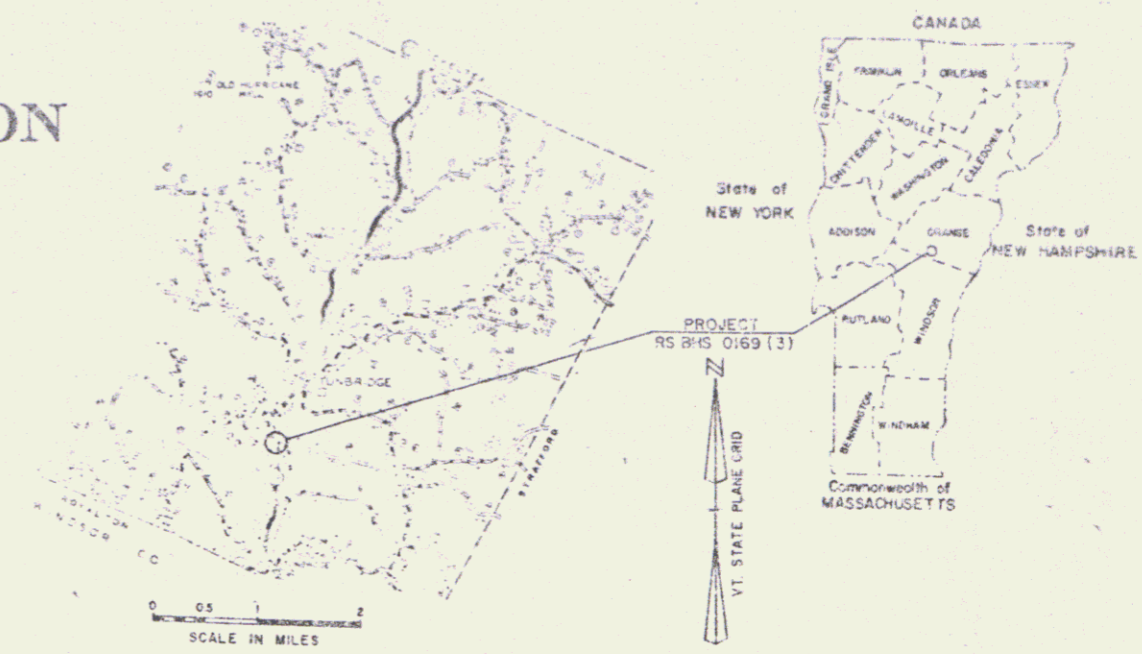

PROJECT DESCRIPTION

WORK TO BE PERFORMED UNDER THIS PROJECT INCLUDES REMOVAL OF EXISTING BRIDGE. NEW CONSTRUCTION CONSISTS OF BUILDING A NEW BRIDGE AND APPROACHES ON IMPROVED ALIGNMENT. APPROACH WORK CONSISTS OF GRADING, DRAINAGE, SUBBASE, PAVEMENT & GUARD RAIL.

CONVENTIONAL SIGNS

COUNTY LINE	---
TOWN LINE	---
LIMITS OF ACCESS	---
POINT OF ACCESS	X
FENCE LINE	---
STONE WALL	---
TRAVELED RD.	---
GUARD RAIL	---
RAILROAD	---
SURVEY LINE	---
CULVERT	---
POWER POLE	○
TELEPHONE POLE	○
TREES	○
CONTROL OF ACCESS	---
PROPERTY LINE	---
R.O.W. TAKING LINE	---
SLOPE RIGHTS	SR
TOP OF CUT	---
TOE OF SLOPE	---

DATUM  
VERTICAL 1970 1922  
HORIZONTAL N/A

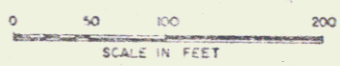
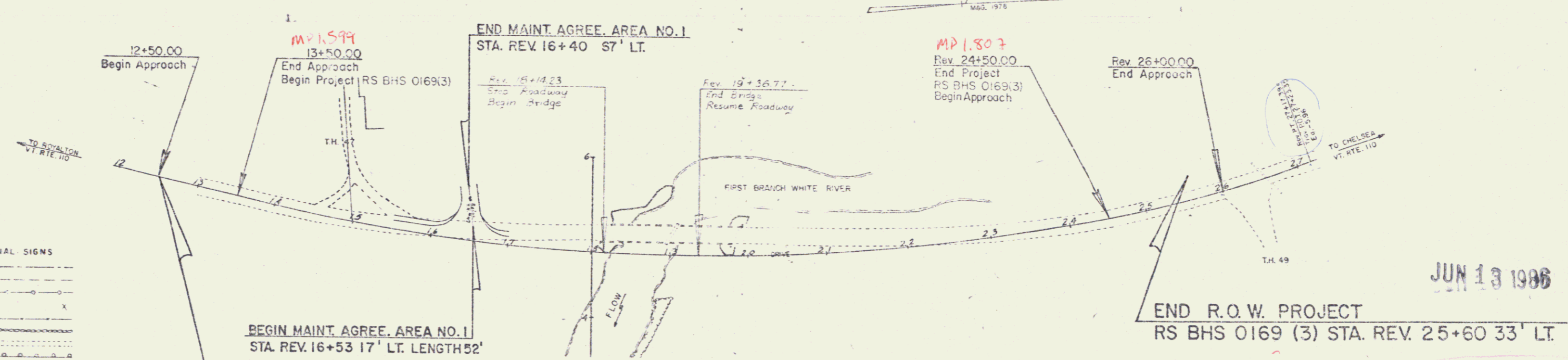

JUN 13 1986

END R.O.W. PROJECT  
RS BHS 0169 (3) STA. REV. 25+60 33' LT.

These plans are subject to such engineering changes as may be required by the Federal Highway Administration or the Director of Engineering and Construction.  
Construction is to be carried on in accordance with these plans and the Standard Specifications for Highway and Bridge Construction dated March, 1976, as approved by the Federal Highway Administration on October 27, 1976, for use on this project, including all subsequent revisions and such revised specifications and special provisions as are incorporated in those plans.

Submitted by ORDER OF THE STATE TRANSPORTATION BOARD  
Din# 77B035  
APPROVED: S. J. G. P. DATE 11-1-84  
DIRECTOR OF ENGINEERING AND CONSTRUCTION  
APPROVED: W. R. J. DATE 10-30-84  
CHIEF PROPERTY ADMINISTRATION  
PROJ. TUNBRIDGE  
NO. RS BHS 0169 (3)  
SHEET 1 OF 10  
D:G SRS 12/10/84

REMOVAL & DISPOSAL OF EXISTING  
GUARD RAIL  
REV. 15+52 RT - 17+00 LT

CONSTRUCT APPROACH  
Rev 16+58 Lt. T.H.#7 (Reto)

GUARD RAIL, STD. STEEL BEAM  
W/ WOOD POSTS, TYPE II  
REV. 16+02.5 - 17+00 Rt.

BREAKAWAY CABLE TERMINAL FOR GUARD RAIL,  
STD. ST. BEAM W/ WOOD POSTS, TYPE II  
LT. REV. 16+76.5 - 17+00  
RT. REV. 15+78 - 16+02.5

Rev. Curve Data  
Δ 25°14'36" LT  
P 2450.15  
D 2°20'19"  
T 548.77'  
L 1079.72'  
E 60.91'  
T-L 17.82'  
Banking 0.044 H/ft.

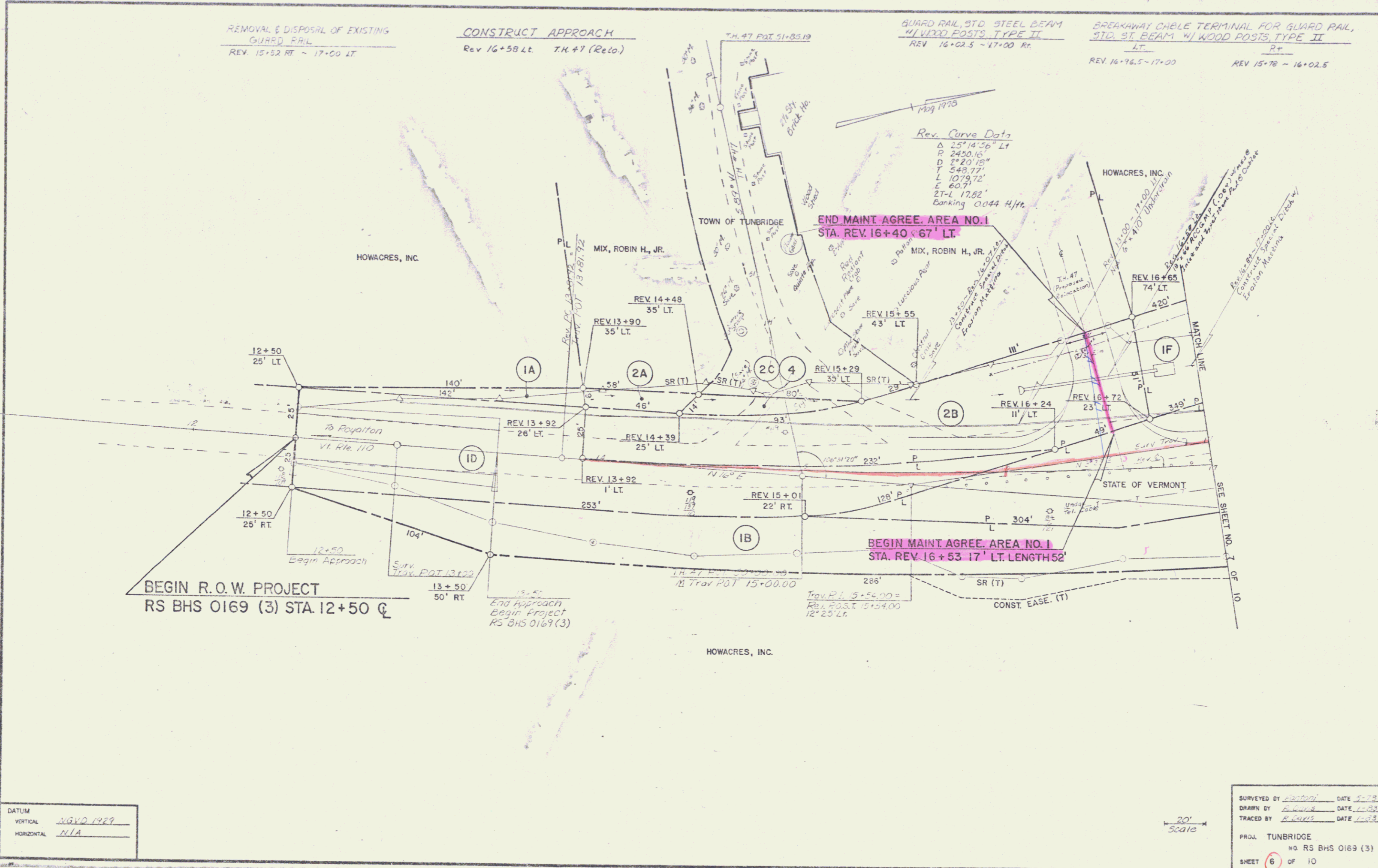

CONSTRUCT DRIVE  
REV 20+33 RT

STONE FILL, TYPE II

REMOVAL & REPAIR OF EXISTING 40' WIDE RAIL

GUARD RAIL, ASPHALT SECTION TYPE I

GUARD RAIL STD. STEEL BEAM  
W/ WOOD POSTS, TYPE II

BREAKAWAY CABLE TERMINAL FOR GUARD RAIL,  
STD. ST. BEAM W/ WOOD POSTS, TYPE II

REV 17+75-18+14	REV 21+45-22+00
REV 17+75-18+22	
REV 17+75-20+23	
REV 17+75-20+45	
REV 20+66-21+45	

REV 17+136-18+10	REV 17+365-17+88
REV 17+65-17+135	REV 17+387-19+88

REV 17+22-17+95	REV 17+0-17+95
REV 20+32-21+50	

REV 17+00-17+22	REV 17+85-20+115
-----------------	------------------

REV CURVE DATA

Δ 25°14'36" LT  
 R 243.016'  
 D 243.016'  
 T 545.77'  
 L 1073.72'  
 E 60.7'  
 ST-L 1782'  
 SUFFICIENCY 0.044 71.4%

HOWACRES, INC.

BM#2  
Chs. D  
ELEV 229.52

HOWE, JOHN A. & SHIRLEY A.

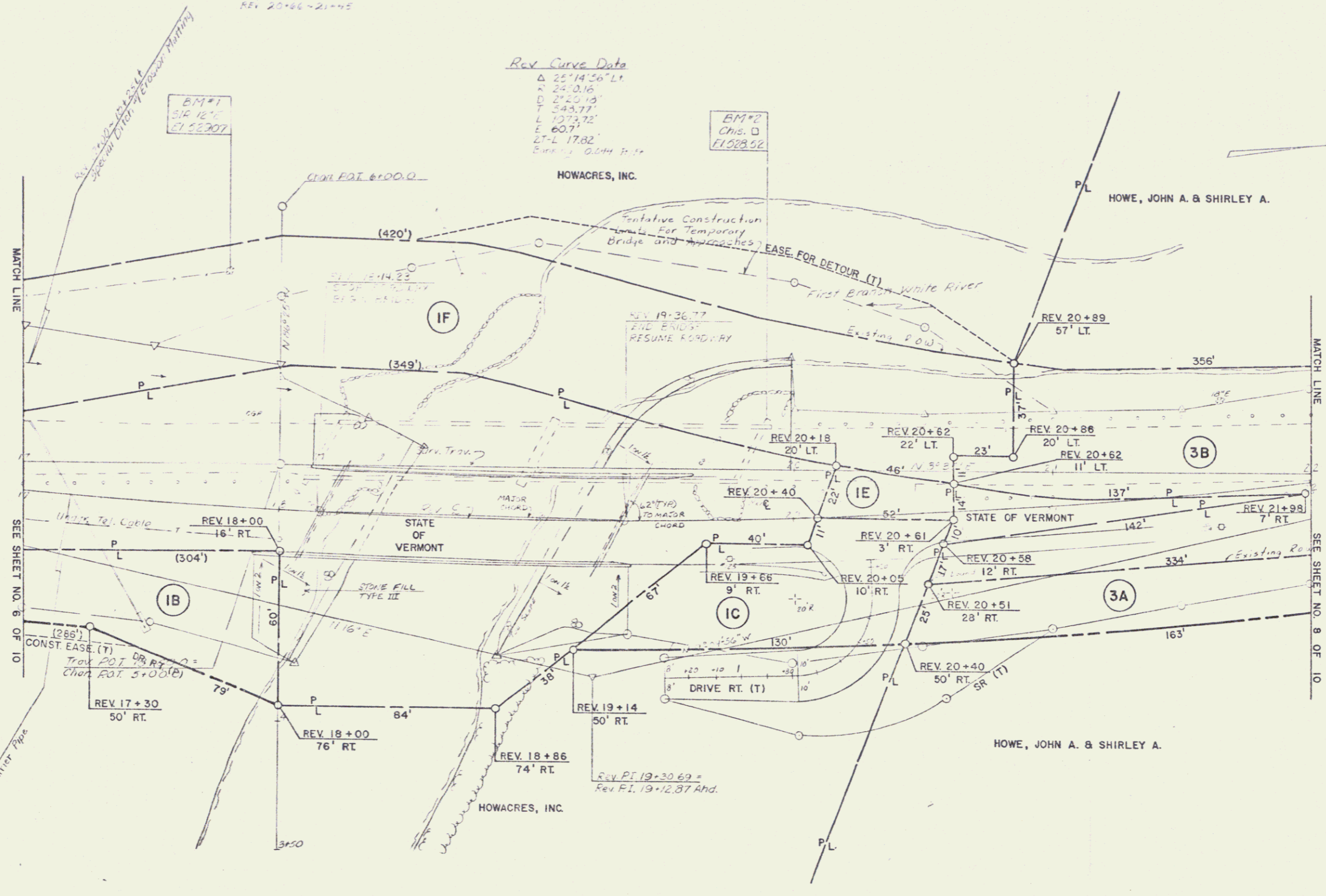

DATUM  
 VERTICAL NAD 83  
 HORIZONTAL NAD 83

20'  
 Scale

SURVEYED BY E. Davis DATE 1-88  
 DRAWN BY E. Davis DATE 1-88  
 TRACED BY E. Davis DATE 1-88  
 PROJ. TUNBRIDGE  
 NO. RS BHS 0169 (3)  
 SHEET 7 OF 10

STONE FILL, TYPE II

GUARD RAIL, STD. STEEL BEAM  
W/ WOOD POSTS, TYPE II  
REV. 22+00 - 23+01 LT.

BREAKAWAY CABLE TERMINAL FOR GUARD RAIL,  
STD. ST. BEAM W/ WOOD POSTS, TYPE II  
REV. 23+01 - 23+26 LT.

REMOVAL & DISPOSAL OF  
EXISTING GUARD RAIL  
REV. 22+00 - 22+30 LT.  
REV. 22+00 - 23+29 RT.

Rev. Curve Data

Δ 25° 45' 56" Lt.  
R 2450.16'  
D 24' 20" 18"  
T 548.77'  
L 1079.72'  
E 60.7'  
2T-L 17.82'  
Banking 0.044 ft/ft

Rev. Curve Data

Δ 0° 51' 04" Lt.  
R 1637.02'  
D 3' 30"  
T 128.13'  
L 259.75'  
E 5.01'  
2T-L 0.52'  
Banking 0.058 ft/ft

HOWE, JOHN A. & SHIRLEY A.

REV. 24+50  
End Project  
Begin Approach  
RS BHS 0169 (3)

REV. 26+00  
End Approach

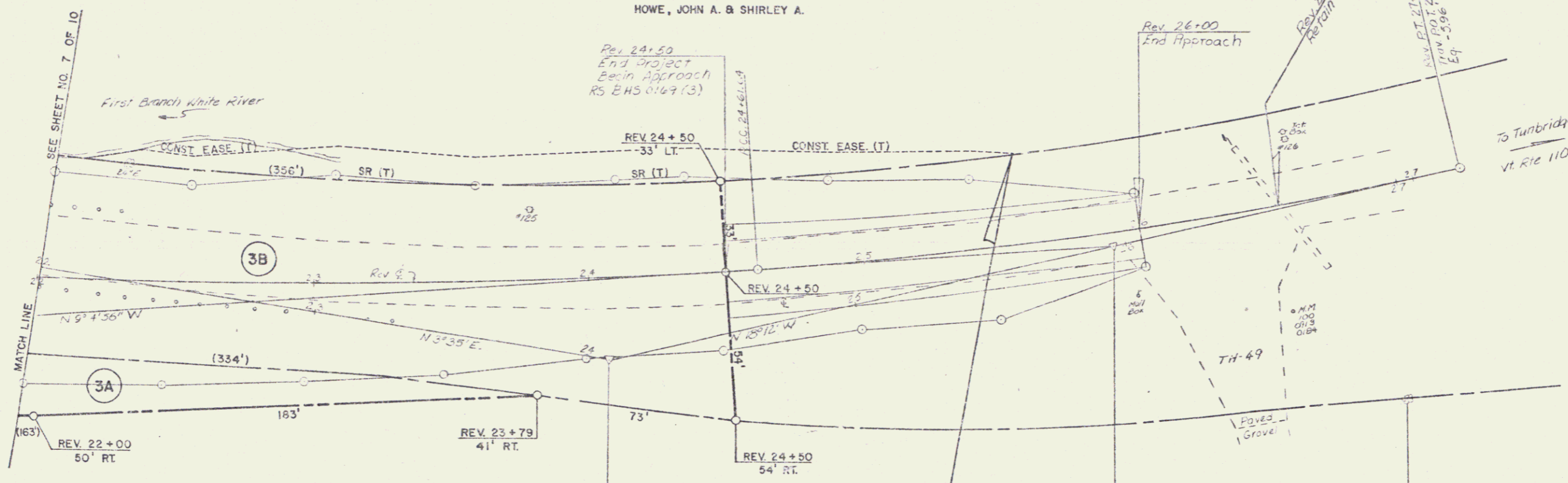

HOWE, JOHN A. & SHIRLEY A.

END R.O.W. PROJECT  
RS BHS 0169 (3) STA. REV. 25+60 33' LT.

DATUM  
VERTICAL M.S.L. 1929  
HORIZONTAL N/A

SURVEYED BY Enoch DATE 5-77  
DRAWN BY Enoch DATE 1-78  
TRACED BY Enoch DATE 1-78  
PROJ. TUNBRIDGE  
NO. RS BHS 0169 (3)  
SHEET 9 OF 10