

CONSTRUCT DRIVE
REV 20+33 RT

STONE FILL, TYPE II

REMOVAL & REPAIR OF EXISTING 40' WIDE RAIL

GUARD RAIL, ASPHALT SECTION TYPE I

GUARD RAIL STD. STEEL BEAM
W/ WOOD POSTS, TYPE II

BREAKAWAY CABLE TERMINAL FOR GUARD RAIL,
STD. ST. BEAM W/ WOOD POSTS, TYPE II

REV 17+75-18+14	REV 21+45-22+00
REV 17+75-18+22	
REV 17+75-20+23	
REV 17+75-22+45	
REV 20+66-21+45	

REV 17+36-18+10	REV 17+36.5-17+88
REV 17+65-17+135	REV 17+36.7-19+88

REV 17+22-17+95	REV 17+0-17+95
REV 20+32-21+50	

REV 17+00-17+22	REV 17+85-20+11.5
-----------------	-------------------

REV CURVE DATA

Δ 25°14'36" LT
 R 243.016'
 D 243.016'
 T 545.77'
 L 1073.72'
 E 60.7'
 ST-L 1782'
 SUFFICIENCY 0.044 7.14

HOWACRES, INC.

BM#2
Chs. D
ELEV 229.52

HOWE, JOHN A. & SHIRLEY A.

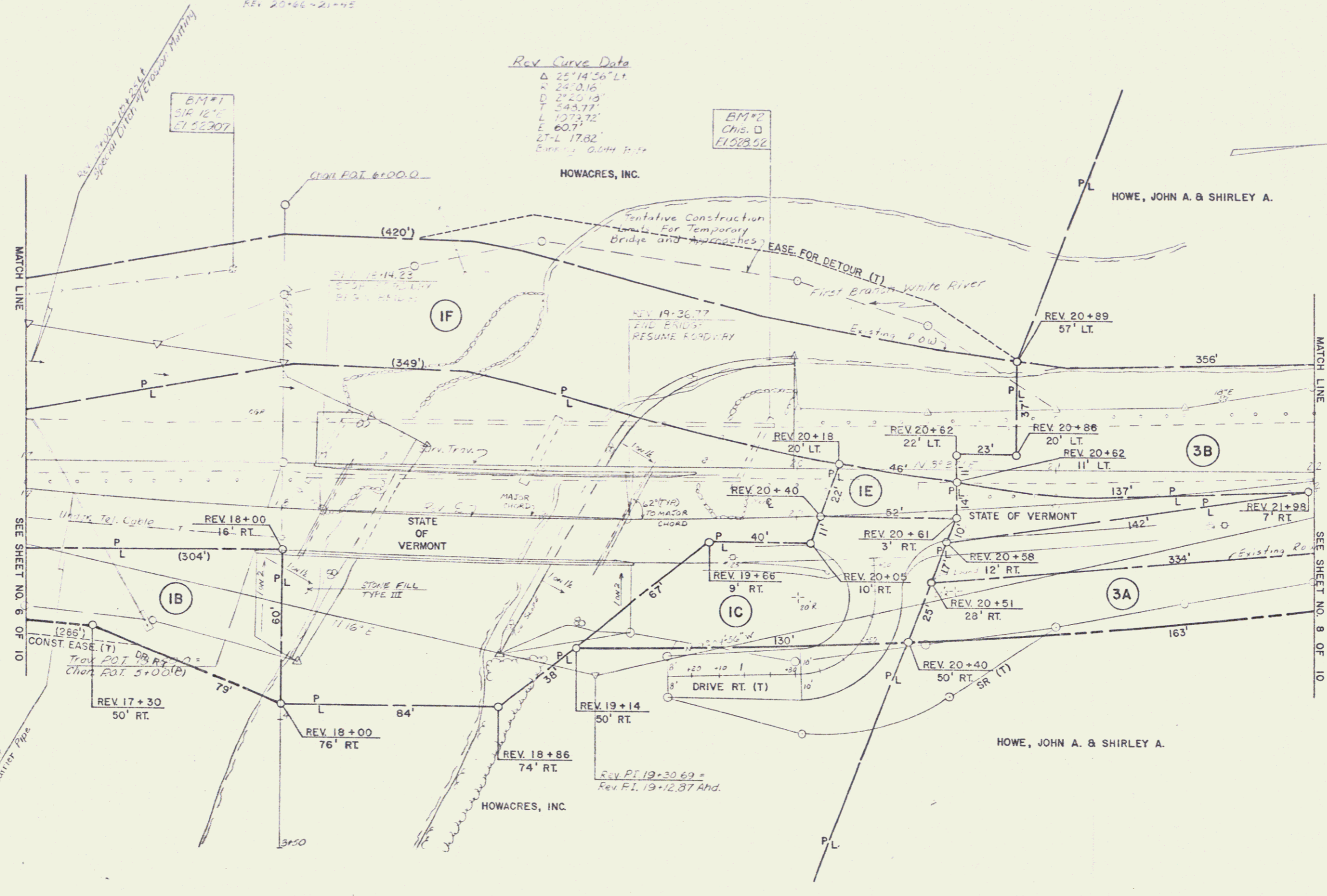

DATUM
 VERTICAL NAD 83
 HORIZONTAL NAD 83

20'
Scale

SURVEYED BY E. Davis DATE 1-88
 DRAWN BY E. Davis DATE 1-88
 TRACED BY E. Davis DATE 1-88
 PROJ. TUNBRIDGE
 NO. RS BHS 0169 (3)
 SHEET 7 OF 10