

INDEX OF SHEETS

1	TITLE PAGE
2	RIGHT-OF-WAY DETAILS
3	QUANTITY SHEET
4	PLAN
5	USE AND CHANNEL LINE PROFILE
6	SUPERSTRUCTURE DETAILS
7	ABUT #1 & TYPICAL ABUT SECTIONS
8	ABUT #2 & SUBSTRUCTURE REMOVAL DETAILS
9	APPROACH SLAB & MISC. DETAILS
10	REINFORCING SCHEDULE
11-14	ROADWAY X-SECTIONS
15-19	CHANNEL X-SECTIONS
20	STANDARDS E2
21	E3
22	E7
23	E7A
24	G14
25	G14
26	SB-EG-76 1-8-76
27	SCB-DI-75 4-3-75R
28	SCB-26-73 4-3-75R

RECORD PLANS-MATERIAL SUPPLIERS
 CONTRACTOR - BLOW & COTE INC., MORRISVILLE, VT.
 CONTRACT DATED - 13 JUNE 1979
 CONSTRUCTION BEGAN - 14 JUNE 1979
 COMPLETED - 15 NOVEMBER 1979
 ACCEPTED - 20 NOVEMBER 1979
 RESIDENT ENGINEER - RODERICK FULLER
 RECORD PLANS - RODERICK FULLER
 SUB-BASE OF GRAVEL - VARIN FIT, BOLTON, VT.
 GRANULAR BACKFILL FOR STRUCTURES - PALISADE'S PIT, MORTOWN, VT.
 PLANT MIXED BASE COURSE, BITUMINOUS CONCRETE PAVEMENT, EMULSIFIED ASPHALT - COOLEY ASPHALT PAVING CORP., BERLIN, VT.
 REINFORCING STEEL - K-ROSS BUILDING SUPPLY CENTER, LEBANON, N.H.
 CONCRETE - A & ANDERSON, BERLIN, VT.
 WATER REPELLENT - SONNEBORN BUILDING PRODUCTS, MASPETH, NY.
 SHEET MEMBRANE WATERPROOFING - W.R. GRACE CO., CAMBRIDGE, MASS.

STATE OF VERMONT
 DEPARTMENT OF HIGHWAYS

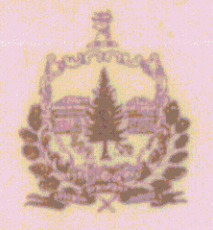

**PROPOSED IMPROVEMENT
 BRIDGE PROJECT**
TOWN OF MIDDLESEX
COUNTY OF WASHINGTON

ROUTE NO: US 2 BRIDGE NO: 52

PROJECT LOCATION: Beginning at a point on US 2 0.90 miles South of J-89 Middlesex Interchange and extending easterly along US 2 0.037 miles toward Montpelier.

PROJECT DESCRIPTION: The project consists of the removal of the superstructure, partial removal of the abutments, extending the abutments, constructing a new reinforced concrete deck and related roadway and channel work.

LENGTH OF STRUCTURE:	34.00 FEET
LENGTH OF PARTICIPATION ROADWAY:	266.00 FEET
LENGTH OF NON-PARTICIPATION ROADWAY:	0.00 FEET
LENGTH OF PROJECT:	300.00 FEET
LENGTH OF ROW PROJECT:	500.00 FEET

GENERAL NOTES:

- MAINTENANCE OF TRAFFIC DURING CONSTRUCTION SHALL BE PROVIDED BY A ONE WAY TEMPORARY BRIDGE WITH APPROACHES AS DIRECTED BY THE ENGINEER, MINIMUM WATERWAY 140 SQ. FT., SUGGESTED STRUCTURE: 20' X 7' BRIDGE.
- TRAFFIC CONTROL LIGHTS FOR THE ONE WAY TEMPORARY BRIDGE SHALL BE PROVIDED BY THE STATE OF VERMONT. SEE SPECIAL PROVISIONS FOR DETAILS.
- DESIGN SPEED 40 MPH
- TRAFFIC INFO: 1977 (EST) 1997 (EST)
 ADT OHV ADT OHV
 1760 240 2550 360
- BRIDGE IS DESIGNED FOR HS20 LIVE LOADING
- EXISTING GUARD RAIL SHALL BE REMOVED IN ACCORDANCE WITH SECTION 202, REMOVAL OF STRUCTURES AND OBSTRUCTIONS. PAYMENT TO BE MADE SUBSIDIARY TO OTHER PAY ITEMS
- ALL DISTURBED EARTH SURFACES AND EMBANKMENTS SHALL BE FERTILIZED, SEEDED AND MULCHED IN ACCORDANCE WITH SECTION 651, TURF ESTABLISHMENT. PAYMENT TO BE MADE SUBSIDIARY TO OTHER PAY ITEMS.
- FOR ADDITIONAL GENERAL NOTES SEE STANDARD SCB-DI-75

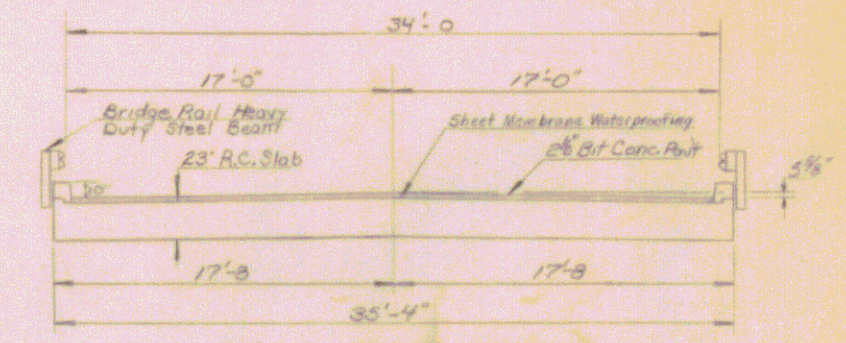
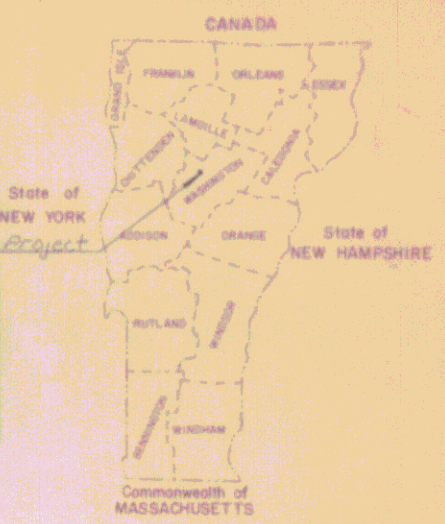
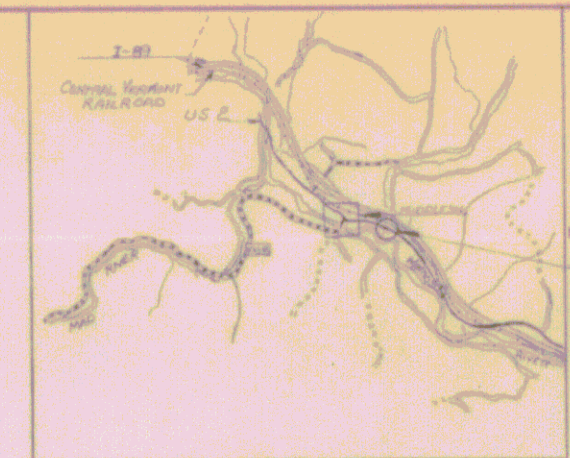

TYPICAL BRIDGE SECTION
 Scale: 1" = 5'-0"

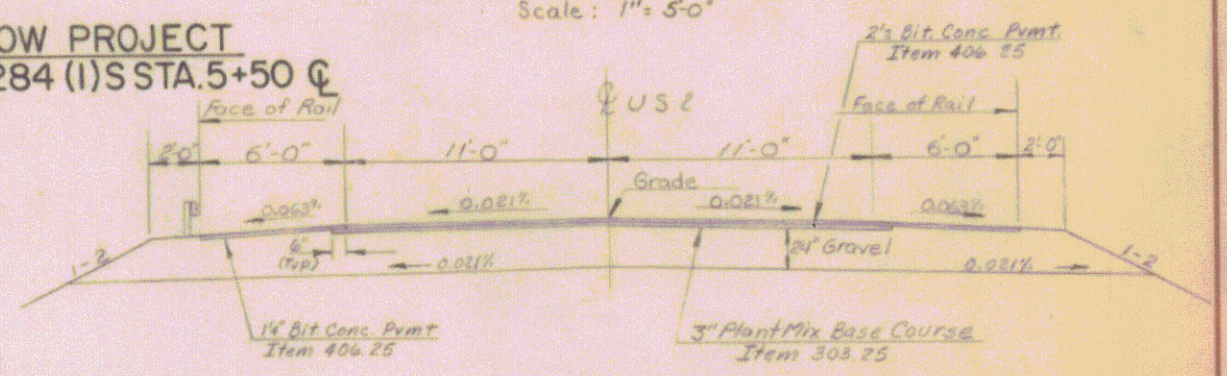

BUILT AS DESIGNED
 TYPICAL ROADWAY SECTION
 Scale: 1/4" = 1'-0"

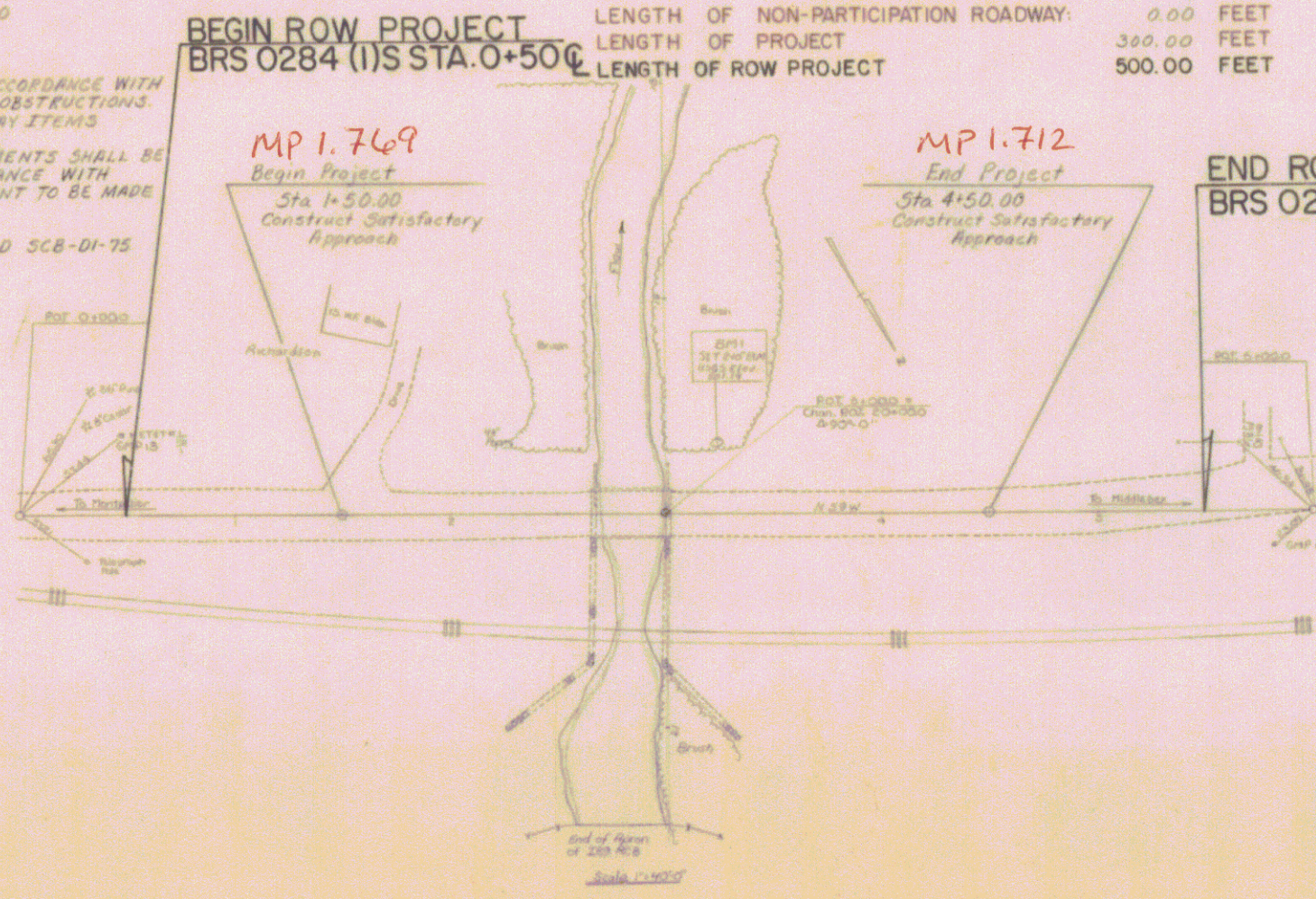

CONVENTIONAL SIGNS

COUNTY LINE	---
TOWN LINE	- - - -
LIMITS OF ACCESS	○
POINT OF ACCESS	X
FENCE LINE	=====
STONE WALL	-----
TRAVELED WAY
GUARD RAIL	-----
RAILROAD	=====
SURVEY LINE	-----
CULVERT	-----
POWER POLE	○
TELEPHONE POLE	○
TREES	○
F.A. CONST. IDENTIFICATION SIGNS	▲
PROPERTY LINE	-----
ROW TAKING LINE	-----
SLOPE RIGHTS	-----
TOP OF CUT	-----
TOE OF SLOPE	-----

PROJECT PROCESSED UNDER
 SECONDARY ROAD PLAN

SUBMITTED BY ORDER OF THE STATE HIGHWAY BOARD
 APPROVED: [Signature] 11-7-78
 DIRECTOR OF ENGINEERING & CONSTRUCTION

Pin # 770022
 APPROVED: [Signature]
 CHIEF PROPERTY ADMINISTRATION
 DATE 11-7-78

MIDDLESEX PROJECT BRS 0284 (1) 115
 SHEET 1 OF 28 SHEETS
 ROW 1 OF 4

STATE OF VERMONT
DEPARTMENT OF HIGHWAYS
RIGHT-OF-WAY PLANS
DETAIL SHEET

TABLE OF PROJECT PROPERTY ACQUISITION

PARCEL NO.	GRANTOR	SHEET NO.	BEGINNING STATION	ENDING STATION	TAKING	REM.	RIGHTS	TITLE TAKEN	DATE	TOWN OR CITY RECORDED	BK.	PG.	REMARKS
1	RICHARDSON, STANLEY E. & IDA N.	3	1+00 LT. 1+55 LT. 1+70 LT. 1+75 LT.	2+80 LT. 2+40 LT. 2+40 LT.	0.06A ±		SLOPE (T) (0.01A ±) DRIVE (T) CONST. EASE (T) (0.01A ±)	W.D.E.	2-23-79	MIDDLESEX	41	110-111	(1,880 S.F. ±) (810 S.F. ±) (870 S.F. ±)
2	SCRIBNER, STANLEY R. & CATHERINE J.	3	2+80 LT. 3+30 LT. 3+30 LT.	3+30 LT. 5+00 LT. 5+50 LT.	0.03 A ±		SLOPE (T) (0.02A ±) CONST. EASE (T) (0.04A ±)	W.D.	5-18-79	MIDDLESEX	41	182/4	(1,250 S.F. ±) (850 S.F. ±) (1,700 S.F. ±)
3	CENTRAL VERMONT RAILWAY, INC.	3	2+55 RT. 0+50 RT. 3+15 RT. 1+15 RT.	3+15 RT. 2+55 RT. 5+00 RT. 3+52 RT.			CHANNEL (P) (0.03A ±) SLOPE (T) (0.08A ±) SLOPE (T) (0.03A ±) GUARD RAIL (P)	RAILWAY AGREE.		MIDDLESEX			INSTALL & MAINTAIN STRUCTURE, STONE FILL & SLOPES (1,278 S.F. ±) (2,700 S.F. ±) (1,200 S.F. ±) INSTALL & MAINTAIN
4	GREEN MOUNTAIN POWER CORP.												UTILITY
5	NEW ENGLAND TELEPHONE & TELEGRAPH CO.												UTILITY

TABLE OF REVISIONS

REVISION NO.	SHEET NO.	DESCRIPTION OF REVISION	DATE	MADE BY	APPROVED BY

MADE BY: A.B.S. DATE 11/8/78
CHECKED BY: W.E.S. DATE 11/8/78

DR. RT - DRAINAGE RIGHT
DIT. RT - DITCHING RIGHT
CH. RT - CHANNEL RIGHT
DRIVE RT - DRIVE RIGHT
CAL. RT - CALVERT RIGHT
ⓓ - DEMOLITION OR REMOVAL
W - WATER SOURCES

----- PRESENT R.O.W.
---//---//--- TAKING WITHOUT ACCESS
---// P ---//--- TAKING WITHOUT ACCESS ALONG PROPERTY LINES
----- TAKING WITH ACCESS
(P) PERMANENT EASEMENT
(T) TEMPORARY EASEMENT

LEGEND
----- CONST. EASE. ----- CONST. EASEMENT
SR ----- SR ----- SLOPE RIGHTS
P ----- P ----- PROPERTY LINE
Δ ----- Δ ----- TOP OF CUT
○ ----- ○ ----- TOE OF SLOPE

APPROVED *Thomas P. Hayes* DATE 11-7-78
CHIEF OF PLANS & TITLES

PROJECT MIDDLESEX
NO. BRS 0284(115)
SHEET 2 OF 28

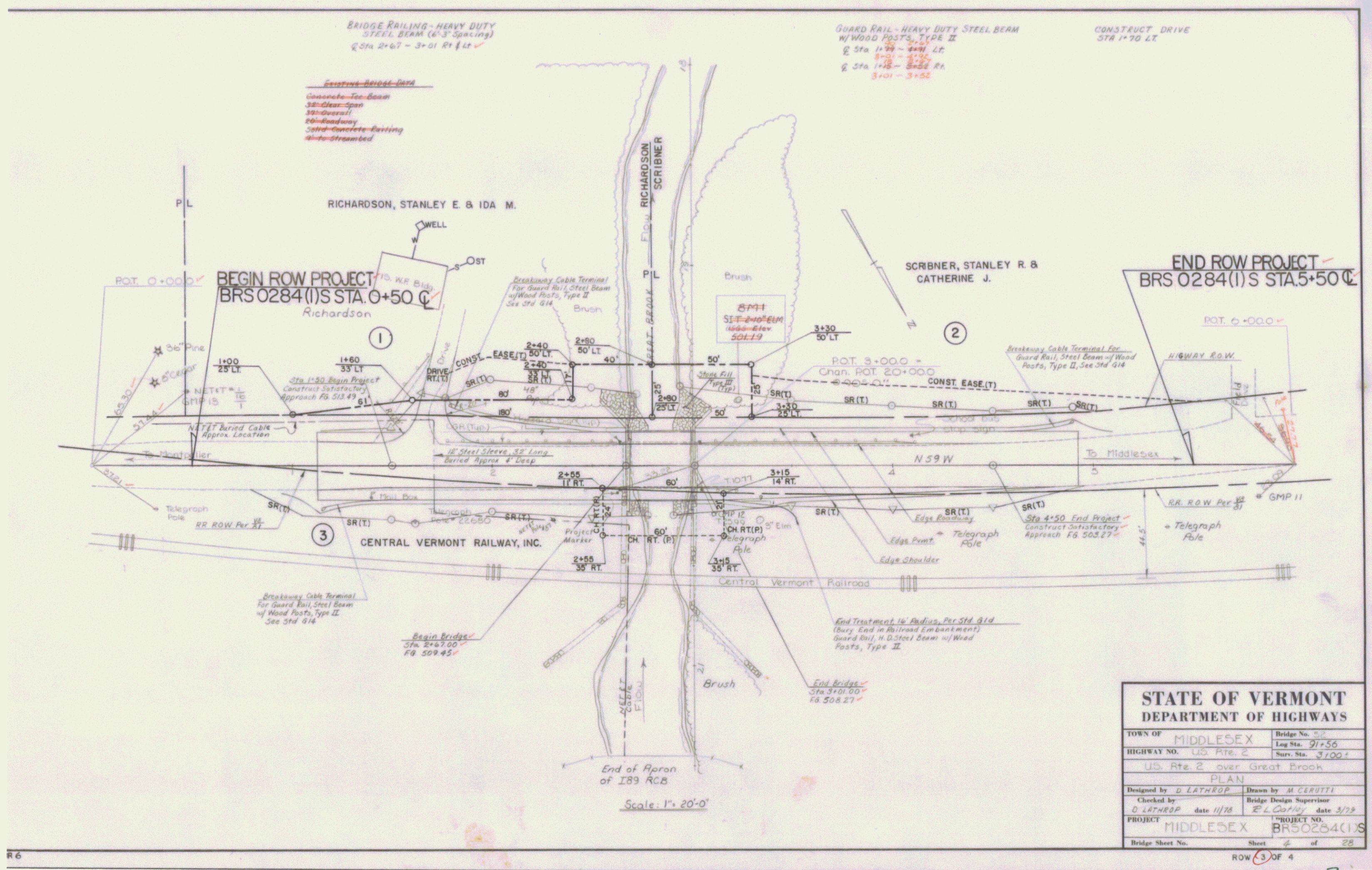

STATE OF VERMONT DEPARTMENT OF HIGHWAYS	
TOWN OF MIDDLESEX	Bridge No. 52
HIGHWAY NO. US Rte. 2	Log Sta. 91+56
US Rte. 2 over Great Brook	
PLAN	
Designed by D LATHROP	Drawn by M CERITTI
Checked by D LATHROP date 11/78	Bridge Design Supervisor E L Coffey date 3/79
PROJECT MIDDLESEX	PROJECT NO. BR50284(1)S
Bridge Sheet No.	Sheet 4 of 28

R 6

ROW 3 OF 4

3