

INDEX OF SHEETS

# STATE OF VERMONT DEPARTMENT OF HIGHWAYS



**POOR ORIGINAL COPY**  
**R.O.W. PLANS**

## PROPOSED IMPROVEMENT BRIDGE PROJECT

**TOWN OF JAMAICA**  
**COUNTY OF WINDHAM**

ROUTE NO: **VT. RTE 30** BRIDGE NO: 30

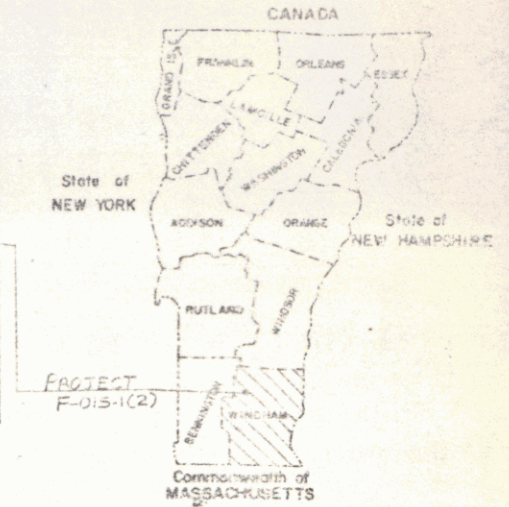

**P.O. 77B019**  
**Date: 01/24/1978**

### GENERAL NOTES:

1. The General Note pertaining to Specifications, Materials, and Construction is shown on Std. Dwg. 508-DI-7B. Other General Notes on the Standard, not otherwise shown or modified on these plans, are notes 2, 3, 4, 5, 7, 8, 9, 10, 11, and 14.
2. As designed the structure is capable of carrying an HS20-44 live load. The roadway is designed for 40 mph in the village.
3. The existing beams shall be re-positioned to the spacing as shown on the Typical Bridge Section. New diaphragms shall be erected and new bearings shall be placed. The existing structural steel shall be blast cleaned and painted according to Section 513 of the Standard Specifications with payment to be subsidiary to Painting, Blast Cleaning.

PROJECT LOCATION: Beginning 0.1 miles from the intersection of VERMONT 30 AND T.A. 1 in Jamaica Village and proceeding 0.057 miles northwesterly along Rte 30.

PROJECT DESCRIPTION: Remove existing concrete bridge deck, widen abutments, pier, and superstructure, construct new composite concrete deck and sidewalk with related roadway and channel work.

LENGTH OF STRUCTURE:	117.84 FEET
LENGTH OF PARTICIPATION ROADWAY:	182.16 FEET
LENGTH OF NON-PARTICIPATION ROADWAY:	---
LENGTH OF PROJECT:	300 FEET
LENGTH OF ROW PROJECT:	300 FEET

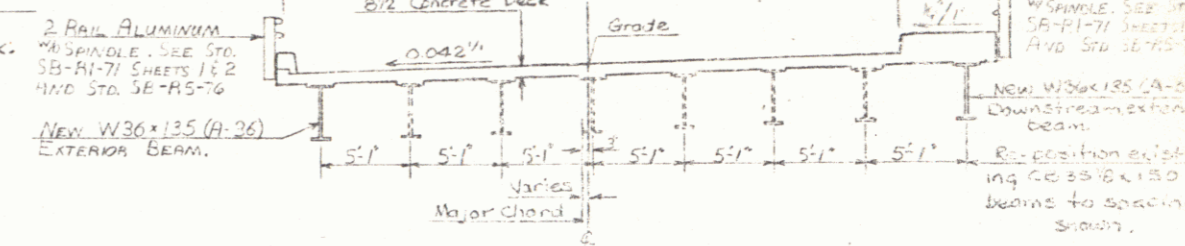

TYPICAL BRIDGE SECTION

SCALE 3/8" = 1'-0"

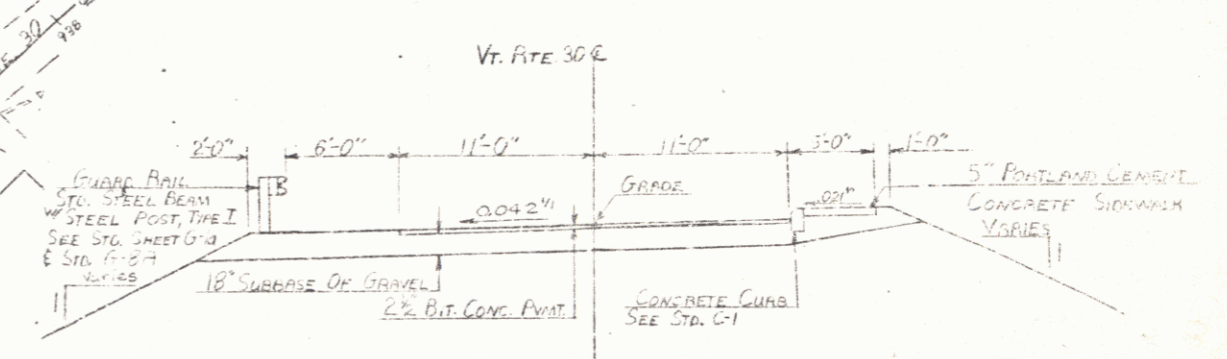

TYPICAL ROADWAY SECTION

SCALE 3/8" = 1'-0"

CONVENTIONAL SIGNS

COUNTY LINE	---
TOWN LINE	---
LIMITS OF ACCESS	---
POINT OF ACCESS	X
FENCE LINE	---
STONE WALL	---
TRAVELED WAY	---
GUARD RAIL	---
RAILROAD	---
SURVEY LINE	---
UTILITY	---
POWER POLE	---
TELEPHONE POLE	---
TREES	---
F.A. COAST IDENTIFICATION SWIRL	---
PROPERTY LINE	---
ROW TAKING LINE	---
SLOPE RIGHTS	---
TOP OF CUT	---
TOE OF SLOPE	---

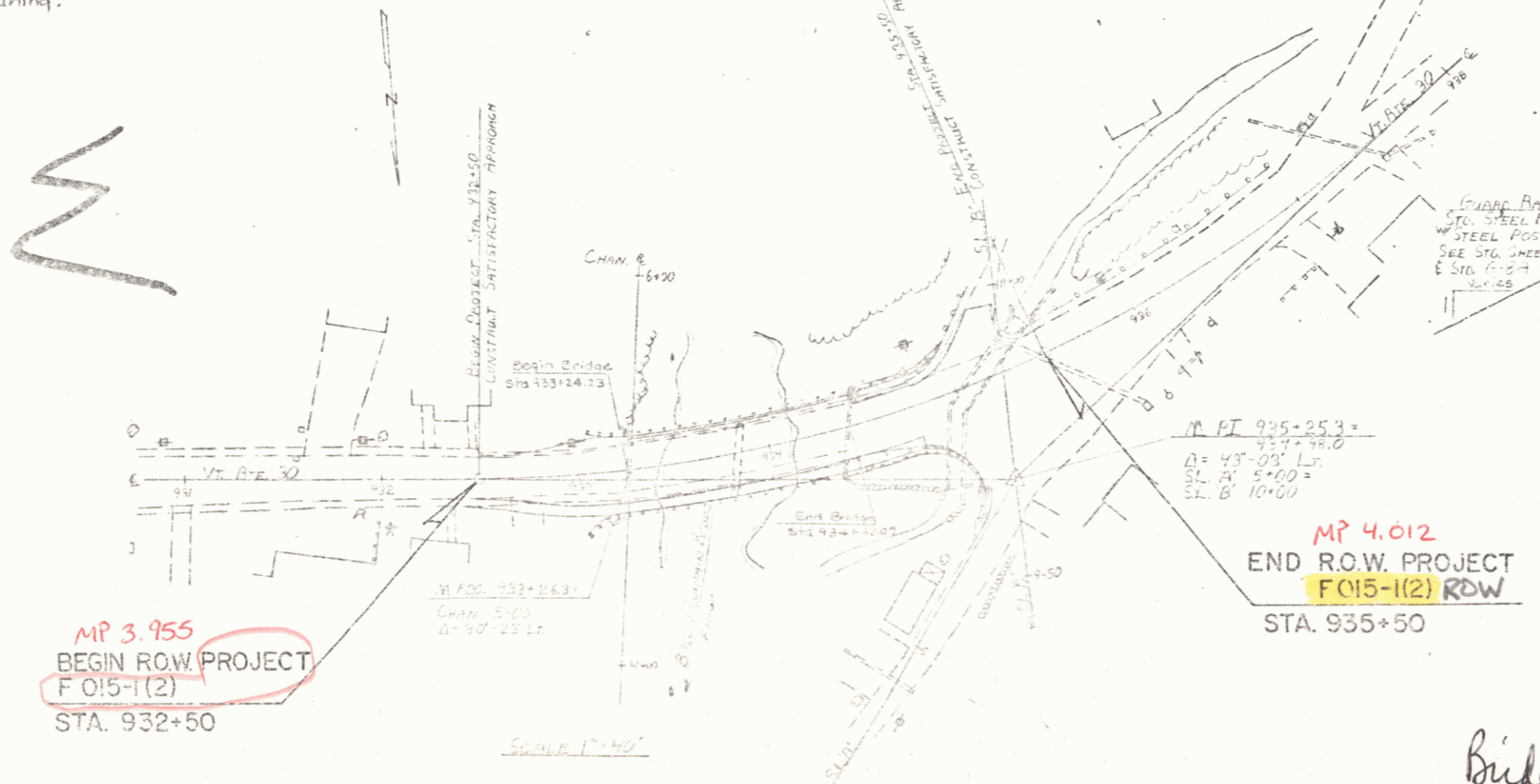

**MP 3.955**  
**BEGIN ROW PROJECT**  
**F 015-1(2)**  
**STA. 932+50**

**MP 4.012**  
**END R.O.W. PROJECT**  
**F 015-1(2) ROW**  
**STA. 935+50**

**RIGHT-OF-WAY DIVISION**  
**TOWN FILE**  
**PERPETUAL**  
**Town of VT 30**  
**(To Be Returned To R.O.W. Division)**

**Bridge # 30**  
**M.P. 3.84**

SUBMITTED BY ORDER OF THE STATE HIGHWAY BOARD

APPROVED: [Signature] DATE: 12-23-78

DEC 23 1981

PROJECT: JAMAICA

SHEET: 1 OF 4

STATE OF VERMONT  
DEPARTMENT OF HIGHWAYS  
RIGHT-OF-WAY PLANS  
DETAIL SHEET

TABLE OF PROJECT PROPERTY ACQUISITION

PARCEL NO.	GRANTOR	SHEET NO.	BEGINNING STATION	ENDING STATION	TAKING	REM.	RIGHTS	TITLE TAKEN	DATE	TOWN OR CITY RECORDED	BK.	PG.	REMARKS
1	TRUSTEES OF THE JAMAICA COMMUNITY CHURCH- LESSOR. BROOKS, JAMES C. & JOANNE L.-LESSEE	3	933+00 LT. 933+16 LT.	933+92 LT. 933+92 LT.	0.02A±		CONST. EASE. (T) (0.02A±)	W.D.O.E.	6/28/78	JAMAICA	45	23-25	(735 S.F.±) (760 S.F.±)
2	TRUSTEES OF THE JAMAICA COMMUNITY CHURCH- LESSOR. ROBINSON, RUTH C.-LESSEE.	3	933+88 LT. 933+92 LT. 935+15 LT.	934+13 LT. 935+00 LT.	0.01A±		CONST. EASE.(T) (0.02A±) DRIVE (T)	W.D.O.E.	6/16/78	JAMAICA	45	20-22	(340 S.F.±) (900 S.F.±)
3	TRUSTEES OF THE JAMAICA COMMUNITY CHURCH- LESSOR. LATTANZIO, GARRY & ELIZABETH-LESSEE	3	933+00 RT. 932+50 RT. 932+75 RT.	933+76 RT. 933+00 RT.	0.04A±		SLOPE (T) (115 S.F.±) DRIVE (T)	W.D.O.E.	7/18/78	JAMAICA	45	317-18	(1925 S.F.±)
4	NEW ENGLAND TELEPHONE & TELEGRAPH CO.												UTILITY
5	CENTRAL VERMONT PUBLIC SERVICE CORP.												UTILITY

TABLE OF REVISIONS

REVISION NO.	SHEET NO.	DESCRIPTION OF REVISION	DATE	MADE BY	APPROVED BY

DR. RT. -- DRAINAGE RIGHT  
DIT. RT. -- DITCHING RIGHT  
CH. RT. -- CHANNEL RIGHT  
DRIVE RT. -- DRIVE RIGHT  
CUL. RT. -- CULVERT RIGHT  
⊖ -- DEMOLITION OR REMOVAL  
W -- WATER SOURCES

DATE 1-23-78  
DATE 1-23-78

PRESENT R.O.W.  
--- TAKING WITHOUT ACCESS  
--- P --- TAKING WITHOUT ACCESS ALONG PROPERTY LINES  
--- TAKING WITH ACCESS  
(P) PERMANENT EASEMENT  
(T) TEMPORARY EASEMENT

LEGEND  
--- CONST. EASE. --- CONSTRUCTION EASEMENT  
--- SR --- SR --- SLOPE RIGHTS  
--- P --- P --- PROPERTY LINE  
--- Δ --- Δ --- Δ --- TOP OF CUT  
--- O --- O --- O --- TOE OF SLOPE

APPROVED *Thomas C. May* DATE 1-24-78  
CHIEF OF PLANS & TITLES

DEC 21 1981  
PROJECT JAMAICA  
NO. FO15-1 (2)  
SHEET 2 OF 4

APPROACH RAILING, 2-RAIL ALUMINUM  
 STA. 932+98 TO STA. 933+21 FT.  
 STA. 933+25 TO STA. 933+56 LT.  
 STA. 934+35 TO STA. 934+56 RT.  
 STA. 934+58 TO STA. 934+72 LT.  
 BRIDGE RAILING, 3-RAIL ALUMINUM W/ SPINDLES  
 STA. 933+21 TO STA. 934+35 FT.  
 BRIDGE RAILING, 2-RAIL ALUMINUM W/ SPINDLES  
 STA. 934+26 TO STA. 934+48 LT.  
 GUARD RAIL, STD. STEEL BEAM W/ STEEL POST, TYPE I  
 STA. 934+56 TO STA. 934+97 RT.  
 STA. 934+72 TO STA. 934+97 LT.

CONSTRUCT DRIVE  
 STA. 932+75 RT.  
 STA. 935+15 LT.

CURVE DATA  
 $\Delta = 43^{\circ}03' LT.$   
 $D = 8''$   
 $R = 716.5'$   
 $T = 283.7'$   
 $L = 538.1'$   
 $E = 53.7'$

POOR ORIGINAL COPY

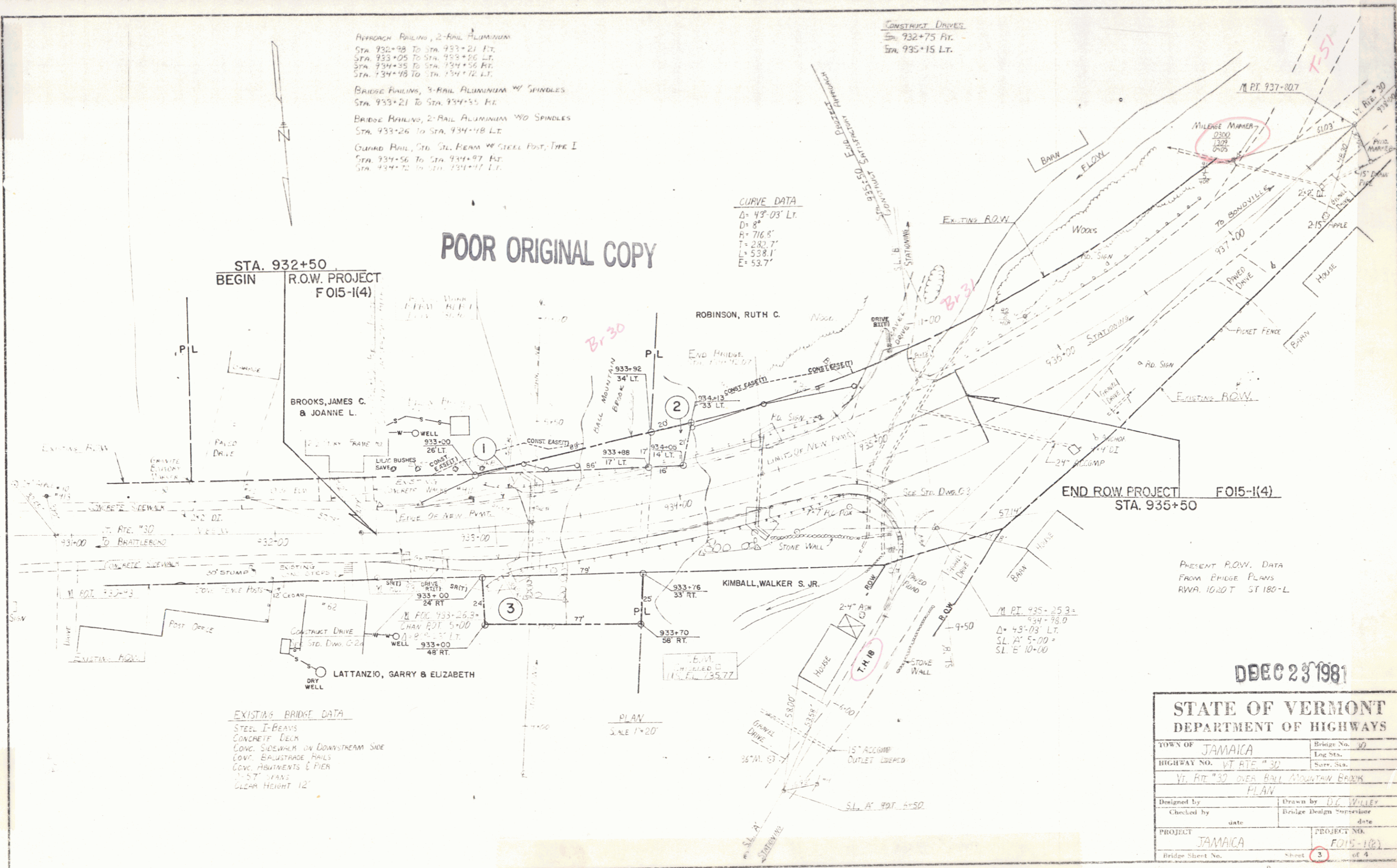

PRESENT R.O.W. DATA FROM BRIDGE PLANS RWA 1020T ST 180-L

DEC 23 1981

STATE OF VERMONT DEPARTMENT OF HIGHWAYS	
TOWN OF JAMAICA	Bridge No. 10
HIGHWAY NO. VT RTE #30	Eng. Sta. 934+98.0
VT. RTE #30 OVER BULL MOUNTAIN BROOK	Surv. Sta.
PLAN	
Designed by	Drawn by D.C. WILLEY
Checked by	Bridge Design Supervisor
date	date
PROJECT JAMAICA	PROJECT NO. FO15-1(4)
Bridge Sheet No.	Sheet 3 of 4